

FOR KCC USE:

"OWWO"

FORM C-1 7/91

FORM MUST BE TYPED

FORM MUST BE SIGNED

ALL BLANKS MUST BE FILLED

EFFECTIVE DATE: 9-28-94

State of Kansas

DISTRICT # 4

NOTICE OF INTENTION TO DRILL

15-051-01098-001

SGA? Yes No

Must be approved by the K.C.C. five (5) days prior to commencing well

Expected Spud Date November 03 1994
month day year

Spot S/2 - SW - NW Sec 4 Twp 13 S, Rg 16 XX East West

OPERATOR: License # 5252
Name: R.P. Nixon Operations, Inc.
Address: 207 West 12th Street
City/State/Zip: Hays, KS 67601
Contact Person: Dan Nixon
Phone: 913-628-3834

2970 feet from South / North line of Section
 4620 feet from East / West line of Section
IS SECTION XX REGULAR IRREGULAR?
(NOTE: Locate well on the Section Plat on Reverse Side)

CONTRACTOR: License #: 5655
Name: Shields Drlg.

County: Ellis
Lease Name: Beery OWWO Well #: 3
Field Name: Emmeram
Is this a Prorated/Spaced Field? yes XX no
Target Formation(s): LKC, Arbuckle
Nearest lease or unit boundary: 660
Ground Surface Elevation: old elev: 2006 KB feet MSL
Water well within one-quarter mile: yes XX no
Public water supply well within one mile: yes XX no
Depth to bottom of fresh water: 40' 330'
Depth to bottom of usable water: 650'
Surface Pipe by Alternate: 1 XX 2
Length of Surface Pipe set: 170' already set
Length of Conductor pipe required: none
Projected Total Depth: 3505'
Formation at Total Depth: Arbuckle
Water Source for Drilling Operations:
well farm pond XX other
DWR Permit #: _____
Will Cores Be Taken?: yes XX no
If yes, proposed zone: _____

Well Drilled For: Well Class: Type Equipment:
 Oil Enh Rec Infield Mud Rotary
Gas Storage Pool Ext. Air Rotary
 OWWO Disposal Wildcat Cable
Seismic; # of Holes Other
Other

If OWWO: old well information as follows:
Operator: Spencer Drlg.
Well Name: #1 Froelich
Comp. Date: 8/18/61 Old Total Depth 3505'

Directional, Deviated or Horizontal wellbore? yes XX no
If yes, true vertical depth: _____
Bottom Hole Location _____

AFFIDAVIT

The undersigned hereby affirms that the drilling, completion and eventual plugging of this well will comply with K.S.A. 55-101, et. seq.

It is agreed that the following minimum requirements will be met:

1. Notify the appropriate district office prior to spudding of well;
2. A copy of the approved notice of intent to drill shall be posted on each drilling rig;
3. The minimum amount of surface pipe as specified below shall be set by circulating cement to the top; in all cases surface pipe shall be set through all unconsolidated materials plus a minimum of 20 feet into the underlying formation;
4. If the well is dry hole, an agreement between the operator and the district office on plug length and placement is necessary prior to plugging;
5. The appropriate district office will be notified before well is either plugged or production casing is cemented;
6. IF AN ALTERNATE II COMPLETION, PRODUCTION PIPE SHALL BE CEMENTED FROM BELOW ANY USABLE WATER TO SURFACE WITHIN 120 DAYS OF SPUD DATE. IN ALL CASES, NOTIFY DISTRICT OFFICE PRIOR TO ANY CEMENTING.

I hereby certify that the statements made herein are true and to the best of my knowledge and belief.

Date: 9/20/94 Signature of Operator or Agent: [Signature] Title President

RECEIVED STATE CORPORATION COMMISSION SEP 21 1994 WICHITA, KANSAS

FOR KCC USE: OWWO
API # 15- 051-01098-00-01
Conductor pipe required NONE feet EXCEPTION CB
Minimum surface pipe required 170' feet per Alt. X
Approved by: CB 9-23-94
This authorization expires: 3-23-95
(This authorization void if drilling not started within 6 months of effective date.)
Spud date: _____ Agent: _____

REMEMBER TO:

- File Drill Pit Application (form CDP-1) with Intent to Drill;
- File Completion Form ACO-1 within 120 days of spud date;
- File acreage attribution plat according to field proration orders;
- Notify appropriate district office 48 hours prior to workover or re-entry;
- Submit plugging report (CP-4) after plugging is completed;
- Obtain written approval before disposing or injecting salt water.

Mail to: Conservation Division, 200 Colorado Derby Building, 202 W. First St., Wichita, Kansas 67202-1286.

IN ALL CASES PLOT THE INTENDED WELL ON THE PLAT BELOW

PLAT OF ACREAGE ATTRIBUTABLE TO A WELL IN A PRORATED OR SPACED FIELD

If the intended well is in a prorated or spaced field, please fully complete this side of the form. If the intended well is in a prorated or spaced field complete the plat below showing that the well will be properly located in relationship to other wells producing from the common source of supply. Please show all the wells within 1 mile of the boundaries of the proposed acreage attribution unit for gas wells and within 1/2 mile of the boundaries of the proposed acreage attribution unit for oil wells.

API NO. 15- _____
 OPERATOR _____
 LEASE _____
 WELL NUMBER _____
 FIELD _____

LOCATION OF WELL: COUNTY _____
 _____ feet from south/north line of section
 _____ feet from east/west line of section
 SECTION _____ TWP _____ RG _____

NUMBER OF ACRES ATTRIBUTABLE TO WELL _____
 QTR/QTR/QTR OF ACREAGE _____ - _____ - _____

IS SECTION _____ REGULAR or _____ IRREGULAR
IF SECTION IS IRREGULAR, LOCATE WELL FROM NEAREST CORNER BOUNDARY.

Section corner used: _____ NE _____ NW _____ SE _____ SW

PLAT

(Show location of the well and shade attributable acreage for prorated or spaced wells.)
 (Show footage to the nearest lease or unit boundary line.)

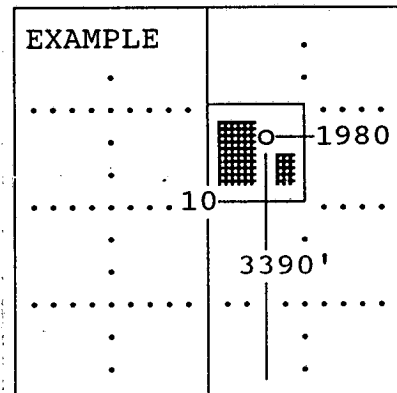
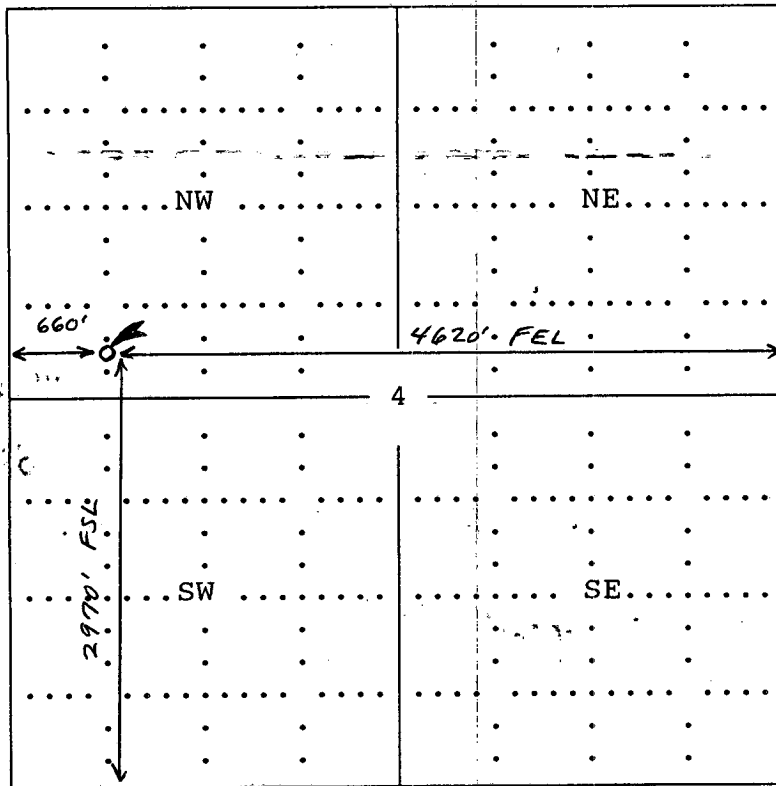

SEWARD CO.

In plotting the proposed location of the well, you must show:

- 1) The manner in which you are using the depicted plat by identifying section lines, i.e. 1 section, 1 section with 8 surrounding sections, 4 sections, etc.;
- 2) the distance of the proposed drilling location from the section's south/north and east/west; and
- 3) the distance to the nearest lease or unit boundary line.



Kansas Corporation Commission

Joan Finney, Governor Susan M. Seltsam, Chair F.S. Jack Alexander, Commissioner Rachel C. Lipman, Commissioner
Judith McConnell, Executive Director Brian Moline, General Counsel

September 22, 1994

file w/ Intent

R.P. Nixon Operations, Inc.
207 West 12th Street
Hays, KS 67601

15-051-01098-00-01

**RE: Table 2 Exception
Legal; 4-13-16W., Ellis County, Lease; Beery #3 "owwo"**

Dear Mr. Nixon,

Alternate 2 surface casing requirement for this location is 200' feet. 170' feet of surface casing was set in 1961. After review of this matter by technical staff, the exception to the Table 2 minimum requirement is granted, with the following stipulations;

1. Nixon Operations, Inc. shall use surface casing that is already in place.
2. If production casing is set, Nixon Operations, Inc. shall cement from 700' feet to surface.
3. The cementing from 700' feet to the surface shall be concurrent with the cementing of the production casing.
4. In the event that this well is a "non-productive dry hole", plugging shall be in accordance with K.C.C. regulations and District 4 requirements.

Please call Chris Bean, at the Wichita Office if there are any questions concerning this matter. The number is (316)-337-6200.

Very Sincerely Yours,

William R. Bryson, Director

cc: Chris Bean ✓
Don Butcher