

Notice: Fill out COMPLETELY and return to Conservation Division at the address below within 60 days from plugging date.

KANSAS CORPORATION COMMISSION
OIL & GAS CONSERVATION DIVISION
WELL PLUGGING RECORD
K.A.R. 82-3-117

Form CP-4
March 2009
Type or Print on this Form
Form must be Signed
All blanks must be Filled

OPERATOR: License #: 5135
Name: John O. Farmer, Inc.
Address 1: P.O. Box 352
Address 2: _____
City: Russell State: KS Zip: 67665 + 0.3.5.2
Contact Person: Marge Schulte
Phone: (785) 483-3145, Ext. 214
Type of Well: (Check one) Oil Well Gas Well OG D&A Cathodic
 Water Supply Well Other: _____ SWD Permit #: _____
 ENHR Permit #: _____ Gas Storage Permit #: _____
Is ACO-1 filed? Yes No If not, is well log attached? Yes No
Producing Formation(s): List All (If needed attach another sheet)
Lansing Depth to Top: 3734' Bottom: 3960' T.D. 3990'
_____ Depth to Top: _____ Bottom: _____ T.D. _____
_____ Depth to Top: _____ Bottom: _____ T.D. _____

API No. 15 - -065-20,979' 00 00
Spot Description: _____
NW NW SE Sec. 18 Twp. 9 S. R. 23 East West
2,310 Feet from North / South Line of Section
2,310 Feet from East / West Line of Section
Footages Calculated from Nearest Outside Section Corner:
 NE NW SE SW
County: Graham
Lease Name: Klenk Well #: 2
Date Well Completed: Dec., 1977
The plugging proposal was approved on: prior to plugging (Date)
by: District #4 (KCC District Agent's Name)
Plugging Commenced: 1:00 P.M., 11-5-10
Plugging Completed: 1:30 P.M., 11-5-10

Show depth and thickness of all water, oil and gas formations.

Oil, Gas or Water Records		Casing Record (Surface, Conductor & Production)			
Formation	Content	Casing	Size	Setting Depth	Pulled Out
Lansing	oil & water	surface	8-5/8"	217'	-0-
(perms. 3766-70', 3776-80', 3804-08', 3822-24', 3861-64', 3922-30')		production	5-1/2"	3989'	-0-

Describe in detail the manner in which the well is plugged, indicating where the mud fluid was placed and the method or methods used in introducing it into the hole. If cement or other plugs were used, state the character of same depth placed from (bottom), to (top) for each plug set.

Tubing @ 2500' - mixed 380 sks. 60/40 Pozmix, 4% gel w/450# hulls. Pulled tubing to 1250' - mixed 25 sks. cement - circulated to surface. Topped off 5-1/2" casing w/15 sks. cement. Hooked on backside - mixed 5 sks. cement - pressured to 200 PSIG.

TOTAL: 425 sks. 60/40 Pozmix, 4% gel & 450# hulls

RECEIVED

DEC 08 2010

KCC WICHITA

Plugging Contractor License #: 99996 Name: Allied Cementing Company, LLC.
Address 1: P.O. Box 31 Address 2: _____
City: Russell State: Kansas Zip: 67665 + 0.0.3.1
Phone: (785) 483-2627
Name of Party Responsible for Plugging Fees: John O. Farmer, Inc.
State of Kansas County, Russell, ss.
John O. Farmer III, President of John O. Farmer, Inc. Employee of Operator or Operator on above-described well,
(Print Name)
being first duly sworn on oath, says: That I have knowledge of the facts statements, and matters herein contained, and the log of the above-described well is as filed, and the same are true and correct, so help me God.
Signature: John O. Farmer III 12-6-10

IMPORTANT
Kans. Geo. Survey request
samples on this well.

KANSAS DRILLERS LOG

S. 18 T. 9S R. 23W^E_W

API No. 15 — 065 — 20,979
County Number

COPY

Loc. NW NW SE

County Graham

Operator
John O. Farmer, Inc.

Address
Box 352, Russell, Kansas 67665

Well No. 112 Lease Name KLENK "B"

Footage Location
330 feet from (N) line 330 feet from (W) line

Principal Contractor John O. Farmer, Inc. Geologist Sam Farmer

Spud Date 12-10-77 Total Depth 3990' P.B.T.D.

Date Completed 12-21-77 Oil Purchaser Mobil Oil Corp.

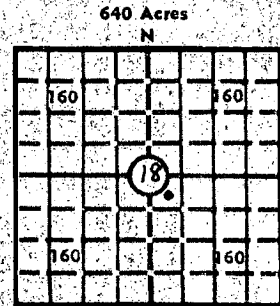

Locate well correctly
Elev.: Gr. 2398

DF 2401 KB 2403

CASING RECORD

Report of all strings set — surface, intermediate, production, etc.

Purpose of string	Size hole drilled	Size casing set (in O.D.)	Weight lbs./ft.	Setting depth	Type cement	Sacks	Type and percent additives
Surface	12-1/4	8-5/8	26	217	Common	160	
Production	7-7/8	5 1/2	10 1/2	3989	Common	150	
		DV Tool at 2055'					

LINER RECORD

PERFORATION RECORD

Top, ft.	Bottom, ft.	Sacks cement	Shots per ft.	Size & type	Depth interval
			4	DP Jets	3922-30

Size	Setting depth	Packer set at
2"	3987'	

ACID, FRACTURE, SHOT, CEMENT SQUEEZE RECORD

Amount and kind of material used	Depth interval treated
2500 gal. 15% HCL	3922-3930

RECEIVED
DEC 08 2010

INITIAL PRODUCTION

Date of first production <u>1-14-78</u>	Producing method (flowing, pumping, gas lift, etc.) <u>Pumping</u>				KCC WICHITA
RATE OF PRODUCTION PER 24 HOURS	Oil <u>50</u> bbls.	Gas <u>0</u> MCF	Water <u>0</u> bbls.	Gas-oil ratio <u>0</u> CFPB	
Disposition of gas (vented, used on lease or sold) <u>0</u>			Producing interval (s) <u>3922-3930</u>		

INSTRUCTIONS: As provided in KCC Rule 82-2-125, within 90 days after completion of a well, one completed copy of this Drillers Log shall be transmitted to the State Geological Survey of Kansas, 4150 Monroe Street, Wichita, Kansas 67209. Copies of this form are available from the Conservation Division, State Corporation Commission, 3830 So. Meridian (P.O. Box 17027), Wichita, Kansas 66217. Phone AC 316-522-2206. If confidential custody is desired, please note Rule 82-2-125. Drillers Logs will be on open file in the Oil and Gas Division, State Geological Survey of Kansas, Lawrence, Kansas 66044.

Operator: **John O. Farmer, Inc.** DESIGNATE TYPE OF COMP.: OIL, GAS, DRY-HOLE, SWDW, ETC.:

Well No. **1** Lease Name **KLENK "B"** Oil

S **18** T **9S** R **23W^E**

WELL LOG

Show all important zones of porosity and contents thereof; cored intervals, and all drill-stem tests, including depth interval tested; cushion used; time tool open; flowing and shut-in pressures, and recoveries.

SHOW GEOLOGICAL MARKERS, LOGS RUN, OR OTHER DESCRIPTIVE INFORMATION.

FORMATION DESCRIPTION, CONTENTS, ETC.	TOP	BOTTOM	NAME	DEPTH
Shale	217	1350	Log Tops:	
Shale & Sand	1350	1585		
Sand	1585	1795	Anhydrite	2050 (+ 353)
Red Bed	1795	2049	Heebner	3692 (-1289)
Anhydrite	2049	2084	Toronto	3718 (-1315)
Shale & Shells	2084	2520	Lansing	3734 (-1331)
Shale & Lime	2520	3420	B/KC	3960 (-1557)
Lime & Shale	3420	3635	T. D.	3991 (-1588)
Shale & Lime	3635	3735		
Lime & Shale	3735	3785		
Lime	3785	3890		
Lime & Shale	3890	3898		
Lime	3898	3940		
Lime & Shale	3940	3990		
<p>DST #1 3750-85 Tool Open 30-30-60-60; strong blow Rec: 310' gas; 435' heavy oil cut mud; 10' mud cut oil IFP: 94-134 FFP: 141-212 BHP: 745-745</p>				
<p>DST #2 3795-3837 Tool Open 30-30-60-60; strong blow Rec: 250' gas; 200' heavy oil cut mud IFP: 47-71 FFP: 79-110 BHP: 628-635</p>				
<p>DST #3 3874-94 Tool Open 30-30-60-60; strong blow Rec: 1440' gas; 1050' clean gassey oil; 10' mud cut oil (75% oil) IFP: 134-275 FFP: 275-393 BHP: 424-424</p>				
<p>DST #4 3915-40 Tool Open 30-30-60-60; Strong blow; Gas to surface 60 min. Rec: 2380' gassey oil IFP: 74-477 FFP: 501-767 BHP: 1152-1200</p>				

USE ADDITIONAL SHEETS, IF NECESSARY, TO COMPLETE WELL RECORD.

Date Received _____

 Signature
 President
 Title
 January 17, 1978
 Date

ALLIED CEMENTING CO., LLC. 035149A

REMIT TO P.O. BOX 31
RUSSELL, KANSAS 67665

SERVICE POINT:
DAKLEY

DATE <u>11-5-10</u>	SEC <u>18</u>	TWP <u>9S</u>	RANGE <u>20W-23W</u>	CALLED OUT	ON LOCATION <u>11:00 AM</u>	JOB START <u>1:00 PM</u>	JOB FINISH <u>1:30 PM</u>
LEASE <u>KLENK</u>	WELL # <u>2</u>	LOCATION <u>Well left south to Red Line</u>			COUNTY <u>GRAHAM</u>	STATE <u>KS</u>	
OLD OR NEW (Circle one) <u>OLD</u>				<u>H-W-2 1/2" - E INTO</u>			

COPY

CONTRACTOR POE SERVICES OWNER SAME

TYPE OF JOB old hole

HOLE SIZE 5 1/2" T.D. 2500' CEMENT AMOUNT ORDERED 500 HULLS

CASING SIZE 2 7/8" DEPTH 2500' 450 SKS 60/40 POZ 46 SKS

TUBING SIZE 2 7/8" DEPTH 2500' USE 4 25 SKS 60/40 POZ 46 SKS 500 HULLS

DRILL PIPE DEPTH 2500' 450 HULLS

TOOL DEPTH 2500'

PRES. MAX. MINIMUM COMMON 255 SKS @ 130 3442 50

MEAS. LINE SHOE JOINT POZ MIX 170 SKS @ 7 53 1283 50

CEMENT LEFT IN CSG. GEL 15 SKS @ 70 303 25

PERFS. CHLORIDE

DISPLACEMENT ASC

EQUIPMENT

PUMP TRUCK CEMENTER TERRY HULLS 500 @ 31 05 153 25

422 HELPER WAYNE @ 10 00 100 00

BULK TRUCK # 396 DRIVER LETT @ 10 00 100 00

BULK TRUCK # DRIVER KEVIN @

HANDLING 465 SKS @ 2 25 1046 25

MILEAGE 104 PER SK / mile 2325 25

TOTAL 8556 25

REMARKS:

Tubing AT 2500' MAX 380 SKS

CEMENT WITH 450 HULLS Pull Tubing TO 150' MAX 25 SKS CEMENT CIRCULATE TO SURFACE Top OFF 5' casing WITH 175 SKS CEMENT Hook on Back SINGLE MIX 55 SKS CEMENT Pressed To 200 PSI

DEPTH OF JOB 2500

PUMP TRUCK CHARGE 445 50

EXTRA FOOTAGE @

MILEAGE 5.0 mi @ N/C N/C

MANIFOLD @

CHARGE TO JOHN O. FARMER

TOTAL 445 50

STREET _____ CITY _____ STATE _____ ZIP _____

PLUG & FLOAT EQUIPMENT

To Allied Cementing Co., LLC:
You are hereby requested to rent cementing equipment and furnish cementer and helper(s) to assist owner or contractor to do work as is listed. The above work was done to satisfaction and supervision of owner agent or contractor. I have read and understand the "GENERAL TERMS AND CONDITIONS" listed on the reverse side.

SALES TAX (If Any) _____

TOTAL CHARGES _____

DISCOUNT _____ IF PAID IN 30 DAYS _____

PRINTED NAME _____ SIGNATURE [Signature]

RECEIVED
DEC 08 2010
KCC WICHITA