

EFFECTIVE DATE: 8-29-90

15-125-29341-0000

FORM MUST BE TYPED
FORM C-1 4/90

State of Kansas

FORM MUST BE SIGNED
ALL BLANKS MUST BE FILLED

NOTICE OF INTENTION TO DRILL

Must be approved by the K.C.C. five (5) days prior to commencing well

Expected Spud Date 8/30/90
month day year

ADP 5/2 NW SE Sec 27 Twp 33 S, Rg 14 East West

OPERATOR: License # 5675
Name: McPherson Drilling
Address: Rt. 2 Box 221
City/State/Zip: Cherryvale, KS 67335
Contact Person: Ron McPherson
Phone: 316-336-2662

1815 feet from South line of Section
1980 feet from East line of Section
(Note: Locate well on Section Plat on Reverse Side)

CONTRACTOR: License #: Same as above
Name: _____

County: Montgomery
Lease Name: Gullick Well #: M-8
Field Name: Wayside
Is this a Prorated Field? ... yes no
Target Formation(s): Wayside
Nearest lease or unit boundary: 1815
Ground Surface Elevation? NA feet MSL
Domestic well within 330 feet: ... yes no
Municipal well within one mile: ... yes no
Depth to bottom of fresh water: ? 80
Depth to bottom of usable water: ? 150
Surface Pipe by Alternate: ... 1 2
Length of Surface Pipe Planned to be set: 20 ft.
Length of Conductor pipe required: N/A
Projected Total Depth: 750 ft.
Formation at Total Depth: Wayside
Water Source for Drilling Operations:
... well ... farm pond ... other air
DWR Permit #: _____
Will Cores Be Taken? ... yes no
If yes, proposed zone: _____

Well Drilled For: Well Class: Type Equipment:
 Oil ... Inj Infield Mud Rotary
... Gas ... Storage ... Pool Ext. Air Rotary
... OWWO ... Disposal ... Wildcat ... Cable
... Seismic; ... # of Holes

If OWWO: old well information as follows:
Operator: _____
Well Name: _____
Comp. Date: _____ Old Total Depth _____

Directional, Deviated or Horizontal wellbore? ... yes no
If yes, total depth location: _____

AFFIDAVIT

The undersigned hereby affirms that the drilling, completion and eventual plugging of this well will comply with K.S.A. 55-101, et. seq.

It is agreed that the following minimum requirements will be met:

1. The appropriate district office shall be notified before setting surface pipe;
2. The minimum amount of surface pipe as specified above shall be set by circulating cement to the top; in all cases surface pipe shall be set through all unconsolidated materials plus a minimum of 20 feet into the underlying formation;
3. If the well is dry, a plugging proposal shall be submitted to the district office. An agreement between the operator and the district office on plug length and placement is necessary prior to plugging;
4. The appropriate district office will be notified before well is either plugged or production casing is cemented in;
5. If an Alternate II completion, production pipe shall be cemented from below any usable water to surface within 120 days of spud date. In all cases, notify district office prior to any cementing.

I hereby certify that the statements made herein are true and to the best of my knowledge and belief.

Date: 8/23/90 Signature of Operator or Agent: Nancy McPherson Title: As agent

FOR KCC USE:

API # 15- 125-29,341
 Conductor pipe required, N/A feet
 Minimum surface pipe required 80 feet per Alt. (2)
 Approved by: MW 8-24-90
 EFFECTIVE DATE: 8-29-90
 This authorization expires: 2-24-91
 (This authorization void if drilling not started within 6 months of effective date.)
 Spud date: _____ Agent: _____

RECEIVED
STATE CORPORATION COMMISSION

AUG 24 1990
08-24-90
CONSERVATION DIVISION
Wichita, Kansas

22
33
14

REMEMBER TO:

- File Drill Pit Application (form CDP-1) with Intent to Drill;
- File Completion Form ACO-1 within 120 days of spud date;
- File acreage attribution plat according to field proration orders;
- Notify appropriate district office 48 hours prior to workover or re-entry;
- Submit plugging report (CP-4) after plugging is completed;
- Obtain written approval before disposing or injecting salt water.

Mail to: Conservation Division, 200 Colorado Derby Building, 202 W. First St., Wichita, Kansas 67202-1286.

2200-146-21121

PLAT OF ACREAGE ATTRIBUTABLE TO A WELL

State Corporation Commission, Conservation Division
200 Colorado Derby Bldg. Wichita, Kansas 67202

OPERATOR McPherson Drilling Co.
LEASE Gullick
WELL NUMBER M-8
FIELD Wayside

LOCATION OF WELL:
1815 feet north of SE corner
1980 feet west of SE corner
Sec. 27 T 33 R 14 E
COUNTY Montgomery
IS SECTION x REGULAR IRREGULAR?
IF IRREGULAR, LOCATE WELL FROM NEAREST
CORNER BOUNDARY.

NO. OF ACRES ATTRIBUTABLE TO WELL 5
DESCRIPTION OF ACREAGE Apx. C S/2 NW SE

NOTE: If plat depicted is insufficient for your circumstances, you may attach your own scaled or surveyed plat.

PLAT

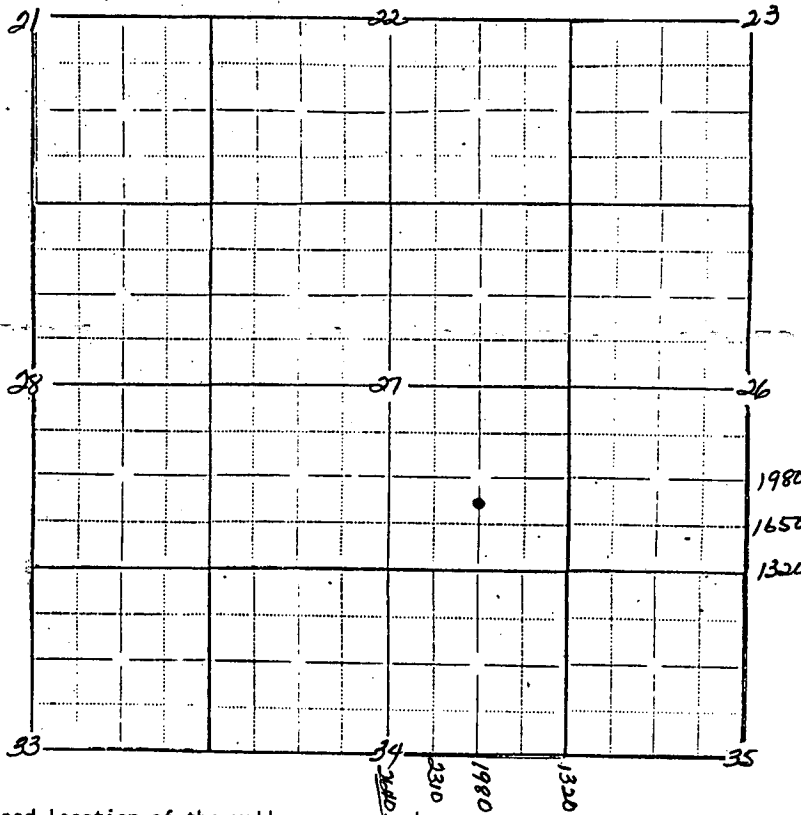

In plotting the proposed location of the well, you must show:

- 1) The manner in which you are using the depicted plat by identifying section lines, i.e. 1 section, 1 section with 8 surrounding partial sections, 4 sections, 16 sections, etc.;
- 2) the well's location relative to the location of other wells producing from the same common source of supply in adjoining drilling units, pursuant to K.A.R. 82-3-108, 82-3-207, 82-3-312, or special orders of the Commission;
- 3) the distance of the proposed drilling location from the section's east and south lines; and
- 4) the distance to the nearest lease or unit boundary line.

I hereby certify that the statements made herein are true and to the best of my knowledge and belief.

Signature of Operator or Agent Nancy McPherson
Date 8/23/90 Title As agent