

EFFECTIVE DATE 11-10-91

NOTICE OF INTENTION TO DRILL
must be approved by the K.C.C. five (5) days prior to commencing well

Expected Spud Date *Dist #4* November 14, 1991
month day year

NE SE NW Sec 24 Twp 13 S, Rg 22 West

3630 feet from South line of Section
2970 feet from East line of Section
(Note: Locate well on Section Plat on Reverse Side)

OPERATOR: License # 30160
Name: Clute Oil Corporation
Address: 444 Seventeenth St., Suite 608
City/State/Zip: Denver, CO 80202
Contact Person: Peter Clute
Phone: (303)623-6779

County: Trego
Lease Name: Rupp Well #: F-24
Field Name: UNNAMED

CONTRACTOR: License #: 8241
Name: Emphasis Oil Operations

Is this a Prorated Field? yes no
Target Formation(s): L/KC, Arbuckle
Nearest lease or unit boundary: 330 feet
Ground Surface Elevation: 2227 feet MSL

Well Drilled For: Well Class: Type Equipment:
 Oil ... Inj ... Infield Mud Rotary
... Gas ... Storage ... Pool Ext. ... Air Rotary
... OAWO ... Disposal Wildcat ... Cable
... Seismic; ... # of Holes

Domestic well within 330 feet: yes no
Municipal well within one mile: yes no
Depth to bottom of fresh water: 500' (est.)
Depth to bottom of usable water: 830'

If OAWO: old well information as follows:
Operator: _____
Well Name: _____
Comp. Date: _____ Old Total Depth _____

Surface Pipe by Alternate: 1 2
Length of Surface Pipe Planned to be set: 240'
Length of Conductor pipe required: 0'
Projected Total Depth: 4150'
Formation at Total Depth: Arbuckle
Water Source for Drilling Operations:
... well farm pond ... other

Directional, Deviated or Horizontal wellbore? yes no
If yes, total depth location: _____

DWR Permit #: _____
Will Cores Be Taken?: yes no
If yes, proposed zone: _____

AFFIDAVIT

The undersigned hereby affirms that the drilling, completion and eventual plugging of this well will comply with K.S.A. 55-101, et. seq.

It is agreed that the following minimum requirements will be met:

1. The appropriate district office shall be notified before setting surface pipe;
2. The minimum amount of surface pipe as specified above shall be set by circulating cement to the top; in all cases surface pipe shall be set through all unconsolidated materials plus a minimum of 20 feet into the underlying formation;
3. If the well is dry, a plugging proposal shall be submitted to the district office. An agreement between the operator and the district office on plug length and placement is necessary prior to plugging;
4. The appropriate district office will be notified before well is either plugged or production casing is cemented in;
5. If an Alternate II completion, production pipe shall be cemented from below any usable water to surface within 120 days of spud date. In all cases, notify district office prior to any cementing.

I hereby certify that the statements made herein are true and to the best of my knowledge and belief.

Date: 10/30/91 Signature of Operator or Agent: *Peter R. Clute* Title: President

FOR KCC USE:

API # 15- 195-22,100
 Conductor pipe required None feet
 Minimum surface pipe required 200 feet per Alt. # ②
 Approved by: mmw 11-5-91
 EFFECTIVE DATE: 11-10-91
 This authorization expires: 5-5-92
 (This authorization void if drilling not started within 6 months of effective date.)
 Spud date: _____ Agent: _____

RECEIVED
STATE CONSERVATION COMMISSION
11-04-91
NOV 4 1991

34
13
2200

REMEMBER TO:

- File Drill Pit Application (form CDP-1) with Intent to Drill;
- File Completion Form ACO-1 within 120 days of spud date;
- File acreage attribution plat according to field proration orders;
- Notify appropriate district office 48 hours prior to workover or re-entry;
- Submit plugging report (CP-4) after plugging is completed;
- Obtain written approval before disposing or injecting salt water.

PLAT OF ACREAGE ATTRIBUTABLE TO A WELL

State Corporation Commission, Conservation Division
200 Colorado Derby Bldg. Wichita, Kansas 67202

OPERATOR - Clute Oil Corporation
LEASE Rupp
WELL NUMBER F-24
FIELD _____

LOCATION OF WELL:
_____ 3630 feet north of SE corner
_____ 2960 feet west of SE corner
NE SE NW Sec. 24 T 13 S R 22 W EXW
COUNTY Trego

NO. OF ACRES ATTRIBUTABLE TO WELL 160
DESCRIPTION OF ACREAGE NW/4 Sec. 24

IS SECTION X REGULAR _____ IRREGULAR?
IF IRREGULAR, LOCATE WELL FROM NEAREST
CORNER BOUNDARY.

NOTE: If plat depicted is insufficient for your circumstances, you may attach your own scaled or surveyed plat.

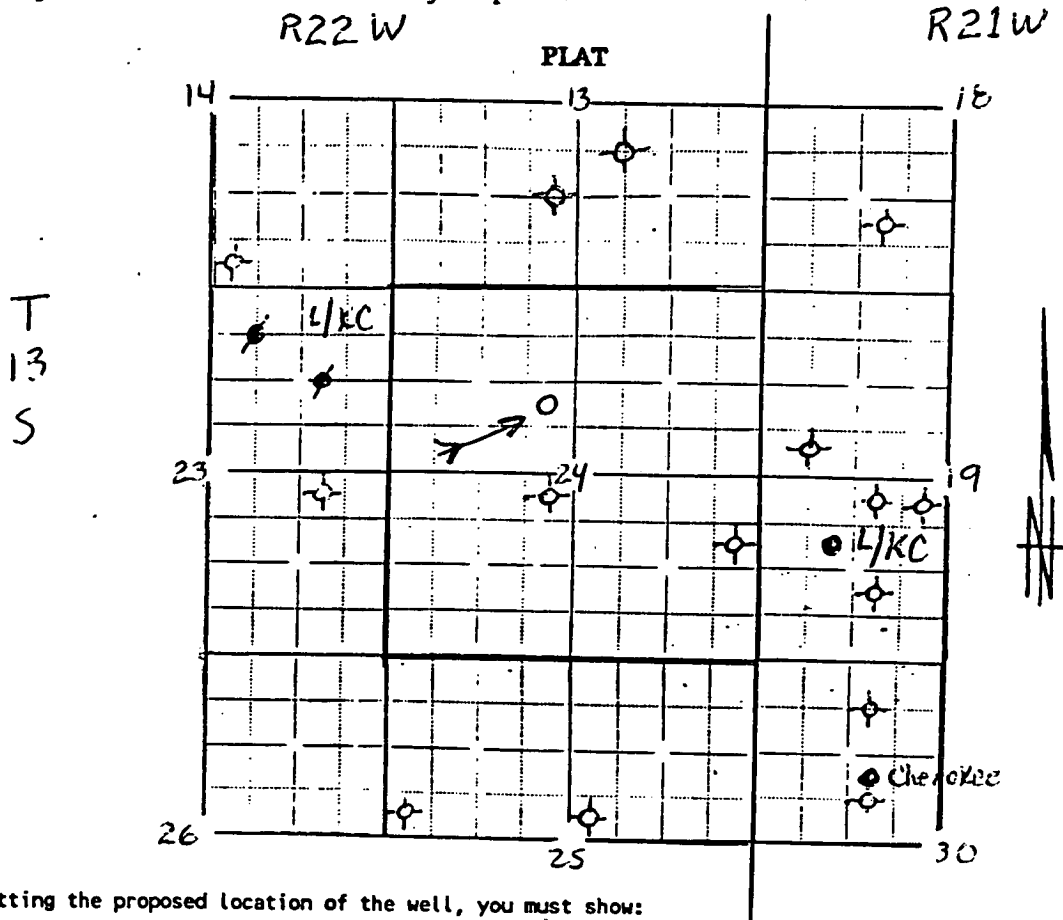

In plotting the proposed location of the well, you must show:

- 1) The manner in which you are using the depicted plat by identifying section lines, i.e. 1 section, 1 section with 8 surrounding partial sections, 4 sections, 16 sections, etc.;
- 2) the well's location relative to the location of other wells producing from the same common source of supply in adjoining drilling units, pursuant to K.A.R. 82-3-108, 82-3-207, 82-3-312, or special orders of the Commission;
- 3) the distance of the proposed drilling location from the section's east and south lines; and
- 4) the distance to the nearest lease or unit boundary line.

I hereby certify that the statements made herein are true and to the best of my knowledge and belief.

Signature of Operator or Agent Peter P. Clute
Date 10/30/91 Title President