

15-195-22204-00-00

For KCC Use: Effective Date: 10-31-2000 District # 4 SGA? Yes No

KANSAS CORPORATION COMMISSION OIL & GAS CONSERVATION DIVISION

Form C-1 September 1999 Form must be Typed Form must be Signed All blanks must be Filled

NOTICE OF INTENT TO DRILL

Must be approved by KCC five (5) days prior to commencing well

Expected Spud Date 10 31 2000 month day year

OPERATOR: License# 32705 Name: Raney Oil Company, LLC Address: 3425 Tam O'Shanter City/State/Zip: Lawrence, KS 66047 Contact Person: Thomas M. Raney Phone: 785-749-0672

CONTRACTOR: License# 30606 Name: Murfin Drilling Co., Inc.

Well Drilled For: Oil [X], Gas, OWWO, Seismic, Other; Well Class: Infield, Pool Ext., Wildcat, Other; Type Equipment: Mud Rotary [X], Air Rotary, Cable

If OWWO: old well information as follows:

Operator: Well Name: Original Completion Date: Original Total Depth: Directional, Deviated or Horizontal wellbore? Yes [] No [X] If Yes, true vertical depth: Bottom Hole Location: KCC DKT #:

Spot 143' S & 30' W of C E/2 - NE - SE Sec. 36 Twp. 13 s. R. 22 1837 feet from S/N Line of Section 360 feet from E/W Line of Section Is SECTION X Regular Irregular?

(Note: Locate well on the Section Plat on reverse side) County: Trego

Lease Name: Weber Well #: 3 Field Name: Cedar View NE

Is this a Prorated / Spaced Field? Yes [] No [X]

Target Formation(s): Cherokee

Nearest Lease or unit boundary: 360'

Ground Surface Elevation: 2347 feet MSL

Water well within one-quarter mile: Yes [] No [X]

Public water supply well within one mile: Yes [] No [X]

Depth to bottom of fresh water: 200 150'

Depth to bottom of usable water: 900

Surface Pipe by Alternate: 1 X 2

Length of Surface Pipe Planned to be set: 275'

Length of Conductor Pipe required: none

Projected Total Depth: 4200

Formation at Total Depth: Arbuckle

Water Source for Drilling Operations: Well Farm Pond Other X

DWR Permit #: (Note: Apply for Permit with DWR [])

Will Cores be taken? Yes [] No [X]

If Yes, proposed zone:

AFFIDAVIT

The undersigned hereby affirms that the drilling, completion and eventual plugging of this well will comply with K.S.A. 55-101, et. seq. It is agreed that the following minimum requirements will be met:

- 1. Notify the appropriate district office prior to spudding of well; 2. A copy of the approved notice of intent to drill shall be posted on each drilling rig; 3. The minimum amount of surface pipe as specified below shall be set by circulating cement to the top; in all cases surface pipe shall be set through all unconsolidated materials plus a minimum of 20 feet into the underlying formation. 4. If the well is dry hole, an agreement between the operator and the district office on plug length and placement is necessary prior to plugging; 5. The appropriate district office will be notified before well is either plugged or production casing is cemented in; 6. If an ALTERNATE II COMPLETION, production pipe shall be cemented from below any usable water to surface within 120 days of spud date. In all cases, NOTIFY district office prior to any cementing.

I hereby certify that the statements made herein are true and to the best of my knowledge and belief.

Date: 10/20/00 Signature of Operator or Agent: C. Scott Robinson Title: Agent

For KCC Use ONLY API # 15 - 195-22204-0000 Conductor pipe required NONE feet Minimum surface pipe required 200 feet per Alt. X (2) Approved by: JK 10-26-2000 This authorization expires: 4-26-2001 (This authorization void if drilling not started within 6 months of effective date.) Spud date: Agent:

Remember to:

- File Drill Pit Application (form CDP-1) with Intent to Drill; - File Completion Form ACO-1 within 120 days of spud date; - File acreage attribution plat according to field proration orders; - Notify appropriate district office 48 hours prior to workover or re-entry; - Submit plugging report (CP-4) after plugging is completed; - Obtain written approval before disposing or injecting salt water.

Mail to: KCC - Conservation Division, 130 S. Market - Room 2078, Wichita, Kansas 67202 10-23-00

36 13 22W

IN ALL CASES PLOT THE INTENDED WELL ON THE PLAT BELOW

Plat of acreage attributable to a well in a prorated or spaced field

If the intended well is in a prorated or spaced field, please fully complete this side of the form. If the intended well is in a prorated or spaced field complete the plat below showing that the well will be properly located in relationship to other wells producing from the common source of supply. Please show all the wells and within 1 mile of the boundaries of the proposed acreage attribution unit for gas wells and within 1/2 mile of the boundaries of the proposed acreage attribution unit for oil wells.

API No. 15 - _____
 Operator: _____
 Lease: _____
 Well Number: _____
 Field: _____
 Number of Acres attributable to well: _____
 QTR / QTR / QTR of acreage: _____ - _____ - _____

Location of Well: County: _____
 _____ feet from S / N (circle one) Line of Section
 _____ feet from E / W (circle one) Line of Section
 Sec. _____ Twp. _____ S. R. _____ East West

Is Section _____ Regular or _____ Irregular

If Section is Irregular, locate well from nearest corner boundary.
 Section corner used: ___NE ___NW ___SE ___SW

PLAT

*(Show location of the well and shade attributable acreage for prorated or spaced wells.)
 (Show footage to the nearest lease or unit boundary line.)*

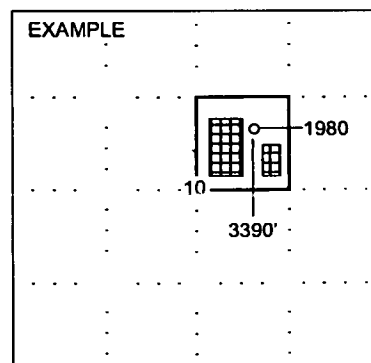
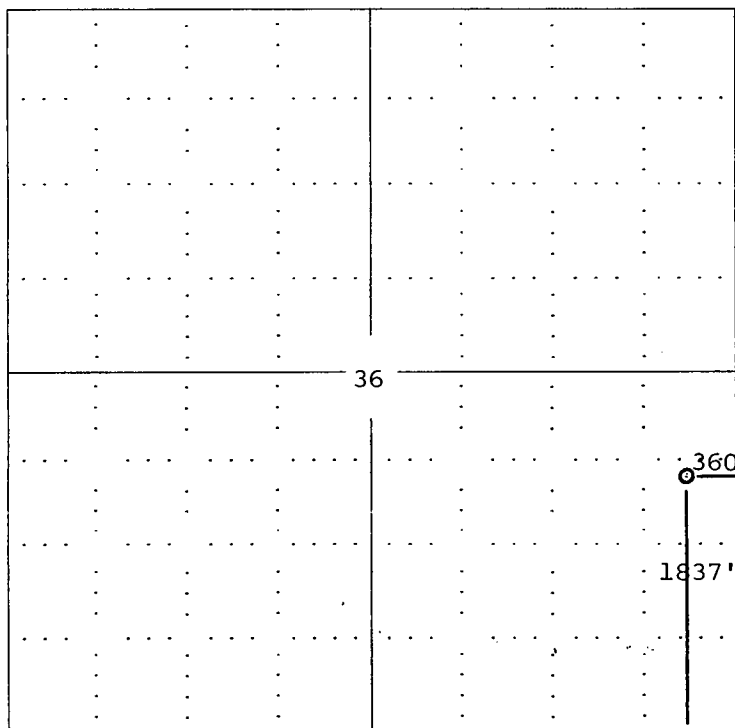

SEWARD CO.

NOTE: In all cases locate the spot of the proposed drilling locaton.

In plotting the proposed location of the well, you must show:

1. The manner in which you are using the depicted plat by identifying section lines, i.e. 1 section, 1 section with 8 surrounding sections, 4 sections, etc.
2. The distance of the proposed drilling location from the section's south / north and east / west.
3. The distance to the nearest lease or unit boundary line.
4. If proposed location is located within a prorated or spaced field a certificate of acreage attribution plat must be attached: (CO-7 for oil wells; CG-8 for gas wells):