

KANSAS CORPORATION COMMISSION
OIL & GAS CONSERVATION DIVISION

Form CP-1
March 2010
This Form must be Typed
Form must be Signed
All blanks must be Filled

WELL PLUGGING APPLICATION

Form KSONA-1, Certification of Compliance with the Kansas Surface Owner Notification Act,
MUST be submitted with this form.

OPERATOR: License #: 05721
Name: Glacier Petroleum, Inc.
Address 1: P. O. Box 577
Address 2: _____
City: Emporia State: KS Zip: 66801 + 0577
Contact Person: J. C. Hawes
Phone: (620) 342-1148

API No. 15 - 017-20430-00-00
If pre 1967, supply original completion date: _____
Spot Description: _____
C NE NW SW Sec. 36 Twp. 22 S. R. 9 East West
2,310 Feet from North / South Line of Section
4,290 Feet from East / West Line of Section
Footages Calculated from Nearest Outside Section Corner:
 NE NW SE SW
County: Chase
Lease Name: Roby Well #: 3A

Check One: Oil Well Gas Well OG D&A Cathodic Water Supply Well Other: _____
 SWD Permit #: _____ ENHR Permit #: _____ Gas Storage Permit #: _____

Conductor Casing Size: NA Set at: _____ Cemented with: _____ Sacks
Surface Casing Size: 8 5/8" Set at: 167 ft. Cemented with: 105 Sacks
Production Casing Size: 4 1/2" Set at: 2657 ft. Cemented with: 100 Sacks

List (ALL) Perforations and Bridge Plug Sets:

Perfs 2542 ft. to 2551 ft.

Elevation: 1625 ft (G.L. / K.B.) T.D.: 2587 ft. PBTD: 2573 ft. Anhydrite Depth: _____
(Stone Corral Formation)

Condition of Well: Good Poor Junk in Hole Casing Leak at: _____
(Interval)

Proposed Method of Plugging (attach a separate page if additional space is needed):

Set 50 ft. gravel and cement plug above top perf at 2542 ft. perf Douglas at approx 800 ft. and set 50 ft. plug, perf at 200 ft., circ cement to surface.

Is Well Log attached to this application? Yes No Is ACO-1 filed? Yes No

If ACO-1 not filed, explain why:

Plugging of this Well will be done in accordance with K.S.A. 55-101 et. seq. and the Rules and Regulations of the State Corporation Commission

Company Representative authorized to supervise plugging operations: Tom Throgmorton w/ Glacier Petroleum, Inc.

Address: P. O. Box 577 City: Emporia State: KS Zip: 66801 + 0577

Phone: (620) 342-1148

Plugging Contractor License #: 05721 Name: Glacier Petroleum, Inc.

Address 1: P. O. Box 577 Address 2: _____

City: Emporia State: KS Zip: 66801 + 0577

Phone: (620) 342-1148

Proposed Date of Plugging (if known): Unknown

Payment of the Plugging Fee (K.A.R. 82-3-118) will be guaranteed by Operator or Agent

Date: 5/23/11 Authorized Operator / Agent: _____
(Signature)

RECEIVED
MAY 24 2011

KANSAS CORPORATION COMMISSION
OIL & GAS CONSERVATION DIVISION

Form KSONA-1
July 2010
Form Must Be Typed
Form must be Signed
All blanks must be Filled

**CERTIFICATION OF COMPLIANCE WITH THE
KANSAS SURFACE OWNER NOTIFICATION ACT**

This form must be submitted with all Forms C-1 (Notice of Intent to Drill); CB-1 (Cathodic Protection Borehole Intent); T-1 (Request for Change of Operator Transfer of Injection or Surface Pit Permit); and CP-1 (Well Plugging Application). Any such form submitted without an accompanying Form KSONA-1 will be returned.

Select the corresponding form being filed: C-1 (Intent) CB-1 (Cathodic Protection Borehole Intent) T-1 (Transfer) CP-1 (Plugging Application)

OPERATOR: License # 05721
Name: Glacier Petroleum, Inc.
Address 1: P. O. Box 577
Address 2: _____
City: Emporia State: KS Zip: 66801 + 0577
Contact Person: J. C. Hawes
Phone: (620) 342-1148 Fax: (620) 342-9561
Email Address: _____

Well Location:
C NE NW SW Sec. 36 Twp. 22 S. R. 9 East West
County: Chase
Lease Name: Roby Well #: 3A

If filing a Form T-1 for multiple wells on a lease, enter the legal description of the lease below:

Surface Owner Information:

Name: Margaret Zenishek
Address 1: 7373 E. 29th St. N, Unit V104
Address 2: _____
City: Wichita State: KS Zip: 67226 + _____

When filing a Form T-1 involving multiple surface owners, attach an additional sheet listing all of the information to the left for each surface owner. Surface owner information can be found in the records of the register of deeds for the county, and in the real estate property tax records of the county treasurer.

If this form is being submitted with a Form C-1 (Intent) or CB-1 (Cathodic Protection Borehole Intent), you must supply the surface owners and the KCC with a plat showing the predicted locations of lease roads, tank batteries, pipelines, and electrical lines. The locations shown on the plat are preliminary non-binding estimates. The locations may be entered on the Form C-1 plat, Form CB-1 plat, or a separate plat may be submitted.

Select one of the following:

- I certify that, pursuant to the Kansas Surface Owner Notice Act (House Bill 2032), I have provided the following to the surface owner(s) of the land upon which the subject well is or will be located: 1) a copy of the Form C-1, Form CB-1, Form T-1, or Form CP-1 that I am filing in connection with this form; 2) if the form being filed is a Form C-1 or Form CB-1, the plat(s) required by this form; and 3) my operator name, address, phone number, fax, and email address.
- I have not provided this information to the surface owner(s). I acknowledge that, because I have not provided this information, the KCC will be required to send this information to the surface owner(s). To mitigate the additional cost of the KCC performing this task, I acknowledge that I am being charged a \$30.00 handling fee, payable to the KCC, which is enclosed with this form.

If choosing the second option, submit payment of the \$30.00 handling fee with this form. If the fee is not received with this form, the KSONA-1 form and the associated Form C-1, Form CB-1, Form T-1, or Form CP-1 will be returned.

I hereby certify that the statements made herein are true and correct to the best of my knowledge and belief.

Date: 5/23/11 Signature of Operator or Agent: _____ Title: _____

COPY

**RECEIVED
MAY 24 2011**



LAUGHLIN-SIMMONS & CO. OF KANSAS, INC.

OIL FIELD SURVEYING
1337 NORTH MERIDIAN, SUITE 2 (316) 943-5351
WICHITA, KANSAS 67203

KW1105846
INVOICE NO.

GLACIER PETROLEUM OPERATOR, 3 NO. Roby FARM

Greenwood COUNTY 36 22s 9e NE NW SW LOCATION

ELEVATION: 1625 gr



GLACIER PETROLEUM INC.
Box 577
Emporia, Kansas 66801

AUTHORIZED BY: Loren Martin

SCALE: 1" = 1000'

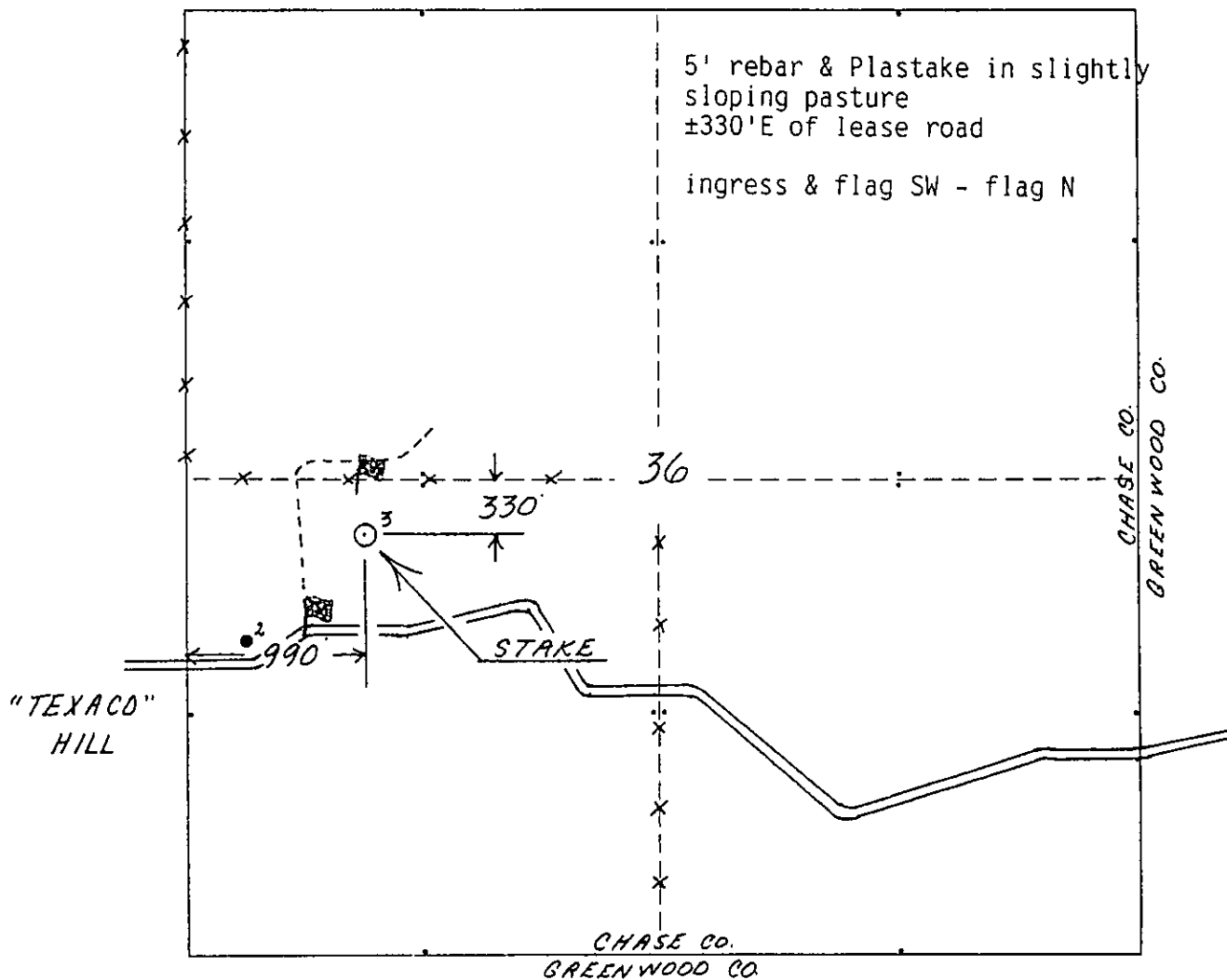

RECEIVED
MAY 24 2011

KCC WICHITA



CORPORATION COMMISSION

Sam Brownback, Governor, Mark Sievers, Chairman, Ward Loyd, Commissioner, Thomas E. Wright, Commissioner

NOTICE OF RECEIPT OF WELL PLUGGING APPLICATION (CP-1)

GLACIER PETROLEUM CO., INC.
825 COMMERCIAL ST
PO BOX 577
EMPORIA, KS 66801-2914

May 24, 2011

Re: ROBY #3A
API 15-017-20430-00-00
36-22S-9E, 2310 FSL 4290 FEL
CHASE COUNTY, KANSAS

Dear Operator:

This letter is to notify you that the Conservation Division has received your plugging proposal, form CP-1, for the above well and has reviewed the proposal for completeness. The central office will now forward your CP-1 to the district office listed below for review of the proposed plugging method. **Please contact the district office for approval of your proposed plugging method at least five (5) days before plugging the well, pursuant to K.A.R. 82-3-113(b). If a workover pit will be used during the plugging of the well it must be permitted. A CDP-1 form must be filed and approved prior to the use of the pit in accordance with K.A.R. 82-3-600.**

The Conservation Division's review of form CP-1, either in the central or district office, does not include an inquiry into well ownership or the filing operator's legal right to plug the well. This notice in no way constitutes authorization to plug the above well by persons not having legal rights of ownership or interest in the well.

This notice is void after November 20, 2011. The CP-1 filing does not bring the above well into compliance with K.A.R. 82-3-111 with regard to the Commission's temporary abandonment requirements.

Sincerely,

Steve Bond
Production Department Supervisor

District: #2
3450 N. Rock Road, Suite 601
Wichita, KS 67226
(316) 630-4000