

15-063-20136-00-00

STATE OF KANSAS
STATE CORPORATION COMMISSION

Form CP-4

Give All Information Completely
Make Required Affidavit
Mail or Deliver Report to:
Conservation Division
State Corporation Commission
P. O. Box 17027
Wichita, Kansas 67217
NORTH

WELL PLUGGING RECORD

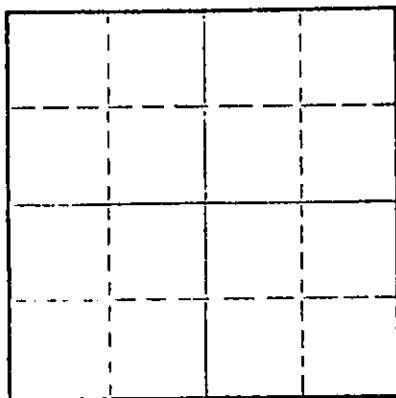

Locate well correctly on above
Section Plat

Gove County, Sec. 26 Twp. 13 Rge. (E) 26 (W)
Location as "NE/CNW/SW" or footage from lines NE NE
Lease Owner Abercrombie Drilling, Inc.
Lessee Name MEIER Well No. 1
Office Address 801 Union Center, Wichita, Ks. 67202
Character of Well (completed as Oil, Gas or Dry Hole) Dry Hole
Date well completed June 10, 1973
Application for plugging filed (verbally) June 10, 1973
Application for plugging approved (verbally) June 10, 1973
Plugging commenced June 10, 1973
Plugging completed June 10, 1973
Reason for abandonment of well or producing formation Dry Hole

If a producing well is abandoned, date of last production 10
Was permission obtained from the Conservation Division or its agents before plugging was commenced? Yes

Name of Conservation Agent who supervised plugging of this well Bill Nichols
Producing formation _____ Depth to top _____ Bottom _____ Total Depth of Well 4418 Feet
Show depth and thickness of all water, oil and gas formations.

OIL, GAS OR WATER RECORDS

CASING RECORD

FORMATION	CONTENT	FROM	TO	SIZE	PUT IN	PULLED OUT

Describe in detail the manner in which the well was plugged, indicating where the mud fluid was placed and the method or methods used in introducing it into the hole. If cement or other plugs were used, state the character of same and depth placed, from _____ feet to _____ feet for each plug set.

1st plug set at 925' w/110 cu. ft.
2nd plug set at 275' w/30 cu. ft.
3rd plug set at 40' w/10 cu. ft.
Job completed at 8:15 a.m. 6-10-73.

RECEIVED
STATE CORPORATION COMMISSION
JUN 13 1973
CONSERVATION DIVISION
Wichita, Kansas

(If additional description is necessary, use BACK of this sheet)

Name of Plugging Contractor Abercrombie Drilling, Inc.
Address 801 Union Center, Wichita, Kansas 67202

STATE OF KANSAS, COUNTY OF SEDGWICK, SS.
Jerry A. Langrehr (employee of owner) or (owner or operator) of the above-described well, being first duly sworn on oath, says: That I have knowledge of the facts, statements, and matters herein contained and the log of the above-described well as filed and that the same are true and correct. So help me God.

(Signature) Jerry A. Langrehr
801 Union Center, Wichita, Kansas 67202
(Address)

Subscribed and Sworn to before me this 12th day of June, 1973

My commission expires February 10, 1975
Beverly Mann Notary Public

This is to replace previous contractor's well log.

IMPORTANT
 Kans. Geo. Survey request
 samples on this well.

KANSAS DRILLERS LOG

S. 26 T. 13 R. 26^{XX}_W

Loc. NE NE

County Gove

API No. 15 — 063 — 20,186-00-00
County Number

Operator
Abercrombie Drilling, Inc.

Address 801 Union Center
Wichita, Kansas 67202

Well No. #1 Lease Name Meier

Footage Location
720 feet from (N) XX line 660 feet from (E) XX line

Principal Contractor Abercrombie Drilling, Inc. Geologist Jack K. Wharton

Spud Date May 31, 1973 Total Depth 4418' P.B.T.D.

Date Completed June 10, 1973 Oil Purchaser

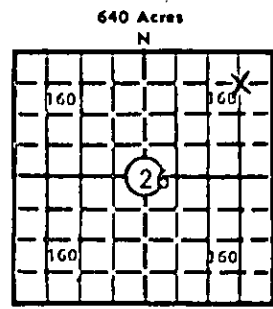

Locate well correctly
 Elev.: Gr. 2442
 DF 2448 KB 2450

CASING RECORD

Report of all strings set — surface, intermediate, production, etc.

Purpose of string	Size hole drilled	Size casing set (in O.D.)	Weight lbs/ft.	Setting depth	Type cement	Sacks	Type and percent additives
Surface Csg.	12 1/2"	8-5/8"	28#	252'	Common	170	2% gel

LINER RECORD

PERFORATION RECORD

Top, ft.	Bottom, ft.	Sacks cement	Shots per ft.	Size & type	Depth interval

TUBING RECORD

Size	Setting depth	Packer set at			

ACID, FRACTURE, SHOT, CEMENT SQUEEZE RECORD

Amount and kind of material used

RECEIVED
 STATE CORPORATION COMMISSION
 JUN 10 1973
 CONSERVATION DIVISION
 Wichita, Kansas

INITIAL PRODUCTION

Date of first production _____ Producing method (flowing, pumping, gas lift, etc.) _____

RATE OF PRODUCTION PER 24 HOURS	Oil _____ bbls.	Gas _____ MCF	Water _____ bbls.	Gas-oil ratio _____	CFPB _____
--	-----------------	---------------	-------------------	---------------------	------------

Disposition of gas (vented, used on lease or sold) _____ Producing interval (s) _____

INSTRUCTIONS: As provided in KCC Rule 82-2-125, within 90 days after completion of a well, one completed copy of this Drillers Log shall be transmitted to the State Geological Survey of Kansas, 4150 Monroe Street, Wichita, Kansas 67209. Copies of this form are available from the Conservation Division, State Corporation Commission, 3830 So. Meridian (P.O. Box 17027), Wichita, Kansas 66217. Phone AC 316-522-2206. If confidential custody is desired, please note Rule 82-2-125. Drillers Logs will be on open file in the Oil and Gas Division, State Geological Survey of Kansas, Lawrence, Kansas 66044.

Operator

Abercrombie Drilling, Inc.

15-063-20186-00-00

DESIGNATE TYPE OF COMP.: OIL, GAS, DRY HOLE, SWDW, ETC.:

Dry Hole

Well No.

1

Lease Name

Meier

S 26 T 13S R 26X W

WELL LOG

Show all important zones of porosity and contents thereof; corad intervals, and all drill-stem tests, including depth interval tested, cushion used, time tool open, flowing and shut-in pressures, and recoveries.

SHOW GEOLOGICAL MARKERS, LOGS RUN, OR OTHER DESCRIPTIVE INFORMATION.

FORMATION DESCRIPTION, CONTENTS, ETC.	TOP	BOTTOM	NAME	DEPTH
Clay & Sand	0	55	Anhydrite	1940
Shale & Lime	55	100	B/Anhydrite	1980
Shale	100	1500	Heebner	3687
Sand	1500	1565	Toronto	3713
Shale	1565	1934	Lansing	3728
Anhydrite	1934	1980	B/Kansas City	3995
Shale	1980	2530	Marmaton	4063
Lime & Shale	2530	3255	Pawnee Ls.	4441
Lime	3255	3505	Ft. Scott	4204
Lime & Shale	3505	3634	Cher. Sh.	4229
Lime	3634	4418	Miss.	4298
Total Depth		4418	Total Depth	4418

RECEIVED
STATE CORPORATION COMMISSION
JUN 13 1973
CONSERVATION DIVISION
Wichita, Kansas

USE ADDITIONAL SHEETS, IF NECESSARY, TO COMPLETE WELL RECORD.

Date Received

Jack K. Wharton
Signature
Jack K. Wharton
Geologist
Title

June 11, 1973

Date