

STATE OF KANSAS  
 STATE CORPORATION COMMISSION  
 CONSERVATION DIVISION  
 P. O. BOX 17027  
 WICHITA, KANSAS 67217

FORM CP-4

WELL PLUGGING RECORD

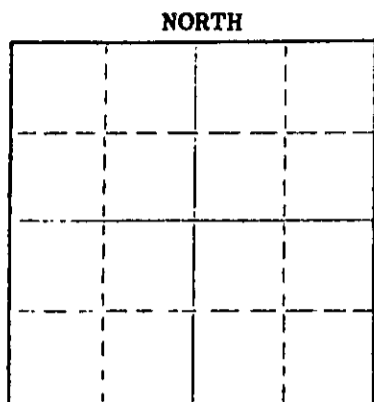

Locate well correctly on above Section Plat

Gove County, Sec. 36 Twp. 13S Rgc. (E) 29W (W)  
 Location as "NE/CNW&SW" or footage from lines C SE SE NE  
 Lease Owner Petroleum Inc.  
 Lease Name Hockersmith Well No. 1  
 Office Address Route 2, Great Bend, Kansas 67530  
 Character of Well (completed as Oil, Gas or Dry Hole) Dry hole  
 Date well completed 7-2 1976  
 Application for plugging filed 7-1 1976  
 Application for plugging approved 7-1 1976  
 Plugging commenced 7-1 1976  
 Plugging completed 7-2 1976  
 Reason for abandonment of well or producing formation Dry

If a producing well is abandoned, date of last production \_\_\_\_\_ 19\_\_\_\_  
 Was permission obtained from the Conservation Division or its agents before plugging was commenced? Yes

Name of Conservation Agent who supervised plugging of this well Gilbert Elthorze  
 Producing formation \_\_\_\_\_ Depth to top \_\_\_\_\_ Bottom \_\_\_\_\_ Total Depth of Well \_\_\_\_\_ Feet  
 Show depth and thickness of all water, oil and gas formations.

OIL, GAS OR WATER RECORDS

CASING RECORD

FORMATION	CONTENT	FROM	TO	SIZE	PUT IN	FULLER OUT
		0	208	8 5/8	200	None

Describe in detail the manner in which the well was plugged, indicating where the mud fluid was placed and the method or methods used in introducing it into the hole. If cement or other plugs were used, state the character of same and depth placed, from \_\_\_\_\_ feet to \_\_\_\_\_ feet for each plug set.

Plug: 70 sacks @ 1000  
 Plug @ 200 with 20 sacks  
 Bridge to hold kelly; plug 10 sacks to base cellar  
 Completed @ 11:00 AM 7-2-76 by Sun Cementing

(If additional description is necessary, use BACK of this sheet)  
 Name of Plugging Contractor DaMac Drilling Inc.  
 Address Box 1164, Great Bend, Kansas 67530

STATE OF Kansas COUNTY OF Barton, ss.

Martha J. McKown (employee of owner) or (owner or operator) of the above-described well, being first duly sworn on oath, says: That I have knowledge of the facts, statements, and matters herein contained and the log of the above-described well as filed and that the same are true and correct. So help me God.

DONALD SLOOF  
 STATE NOTARY PUBLIC  
 Barton County, Kansas  
 My Commission Expires  
 November 11, 1978

(Signature) Martha J. McKown  
Box 1164, Great Bend, Kansas 67530  
 (Address)

Subscribed and Sworn to before me this 12th day of July, 1976

My commission expires 11-11-78  
Ronald Sloof Notary Public.

07-14-76

15-063-20302-00-00

**KANSAS DRILLERS LOG**

API No. 15 — Gove County                      Number                     

S. 36 T. 13S R. 29W E  
 Loc. C SE SE NE  
 County Gove

Operator Petroleum, Inc.

Address Route 2, Great Bend, Kansas 67530

Well No. 1 Lease Name Hockersmith

Footage Location  
 feet from (N) (S) line                      feet from (E) (W) line                     

Principal Contractor DaMac Drilling, Inc. Geologist                     

Spud Date 6-23-76 Total Depth 4523 P.B.T.D.                     

Date Completed 7-2-76 Oil Purchaser                     

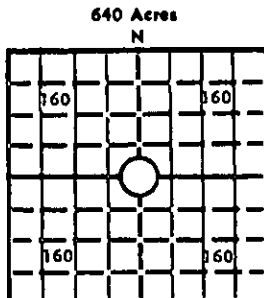

Elev.: Gr.                       
 DF                      KB                     

**CASING RECORD**

Report of all strings set — surface, intermediate, production, etc.

Purpose of string	Size hole drilled	Size casing set (in O.D.)	Weight lbs/ft.	Setting depth	Type cement	Sacks	Type and percent additives
Surface	12 1/4	8 5/8		208	Com & 3%CC	170	

**LINER RECORD**

**PERFORATION RECORD**

Top, ft.	Bottom, ft.	Sacks cement	Shots per ft.	Size & type	Depth interval

**TUBING RECORD**

Size	Setting depth	Packer set at

**ACID, FRACTURE, SHOT, CEMENT SQUEEZE RECORD**

Amount and kind of material used	Depth interval treated

**INITIAL PRODUCTION**

Date of first production <u>                    </u>		Producing method (flowing, pumping, gas lift, etc.) <u>                    </u>			
RATE OF PRODUCTION PER 24 HOURS	Oil <u>                    </u> bbls.	Gas <u>                    </u> MCF	Water <u>                    </u> bbls.	Gas-oil ratio <u>                    </u>	CFPB <u>                    </u>
Disposition of gas (vented, used on lease or sold) <u>                    </u>			Producing interval (s) <u>                    </u>		

INSTRUCTIONS: As provided in KCC Rule 82-2-125, within 90 days after completion of a well, one completed copy of this Drillers Log shall be transmitted to the State Geological Survey of Kansas, 4150 Monroe Street, Wichita, Kansas 67209. Copies of this form are available from the Conservation Division, State Corporation Commission, 3830 So. Meridian (P.O. Box 17027), Wichita, Kansas 66217. Phone AC 316-522-2206. If confidential custody

Petroleum, Inc.

STANDARD, INC.

Well No.

1

Lease Name

Hockersmith

Dry Hole

S 36 T 13S R 29W<sup>E</sup><sub>W</sub>

**WELL LOG**

Show all important zones of porosity and contents thereof; cored intervals, and all drill-stem tests, including depth interval tested, cushion used, time tool open, flowing and shut-in pressures, and recoveries.

SHOW GEOLOGICAL MARKERS, LOGS RUN, OR OTHER DESCRIPTIVE INFORMATION.

FORMATION DESCRIPTION, CONTENTS, ETC.

TOP

BOTTOM

NAME

DEPTH

Sand, Clay, & Shale

0

208

Red Bed & Shale

208

1360

Shale, Sand

1360

2023

Lime & Shale

2023

4278

Lime

4278

4523 RTD

USE ADDITIONAL SHEETS, IF NECESSARY, TO COMPLETE WELL RECORD.

Date Received

*Martha J. McKeown*  
Signature

Vice President

Title

July 12, 1976

Date