

STATE OF KANSAS
STATE CORPORATION COMMISSION

WELL PLUGGING RECORD

Give All Information Completely
Make Required Affidavit
Mail or Deliver Report to
Conservation Division
State Corporation Comm.
245 North Water
Wichita, KS 67202

Logan County, Sec. 29 Twp. 13S Rge. 35 E/W
Location as "NE/CNW/SW" or footage from lines
NW SE

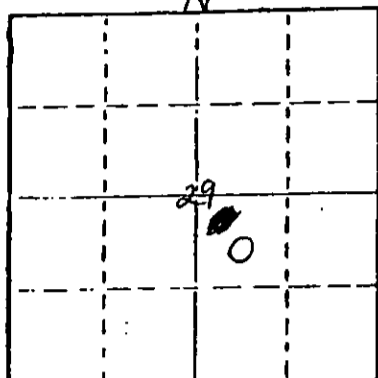

Locate well correctly on above
Section Plot

Lease Owner Abercrombie Drilling, Inc.
Lease Name REPSHIRE Well No. 1
Office Address 801 Union Center, Wichita, Kansas 67202
Character of Well (Completed as Oil, Gas or Dry Hole) Dry Hole

Date Well completed Oct. 4, 1977
Application for plugging filed (verbally) Oct. 4, 1977
Application for plugging approved (verbally) Oct. 4, 1977
Plugging commenced Oct. 4, 1977
Plugging completed Oct. 4, 1977

Reason for abandonment of well or producing formation
No commercial quantity of oil or gas encountered.
If a producing well is abandoned, date of last production
19

Was permission obtained from the Conservation Division or
its agents before plugging was commenced? Yes

Name of Conservation Agent who supervised plugging of this well Gilbert Balthazor
Producing formation _____ Depth to top _____ Bottom _____ Total Depth of Well 4575
Show depth and thickness of all water, oil and gas formations.

OIL, GAS OR WATER RECORDS

CASING RECORD

FORMATION	CONTENT	FROM	TO	SIZE	PUT IN	PULLED OUT

Describe in detail the manner in which the well was plugged, indicating where the mud fluid
was placed and the method or methods used in introducing it into the hold. If cement or other
plugs were used, state the character of same and depth placed, from _____ feet to
_____ feet for each plug set.

10-13-77

Set 1st plug at 1250' with 70 sacks
2nd plug at 240' with 20 sacks
3rd plug at 40' with 10 sacks

Cemented with 50/50 posmix, 6% gel.

(If additional description is necessary, use BACK of this sheet)

Name of Plugging Contractor Abercrombie Drilling, Inc.

STATE OF KANSAS COUNTY OF SEDGWICK ss.
Jack L. Partridge, Ass't. Secretary-Treasurer (employee of owner) or (owner or operator) of the above-described
well, being first duly sworn on oath, says: That I have knowledge of the facts, statements, and matters herein contained and the log of the
above-described well as filed and that the same are true and correct. So help me God.

(Signature) Jack L. Partridge
801 Union Center, Wichita, Kansas 67202
(Address)

Sworn to before me this 11th day of October, 1977

July 21, 1979

Sandra Richman
Sandra Richman Notary Public.

NOTARY PUBLIC
My commission expires

15-109-20092-00-00

KANSAS DRILLERS LOG

S. 29 T. 13S R. 35 ^{XK} W

API No. 15 _____
County _____ Number _____

Loc. NW SE

County Logan

Operator
Abercrombie Drilling, Inc.

Address
801 Union Center, Wichita, Kansas 67202

Well No. 1 Lease Name REPSHIRE

Footage Location
feet from (N) (S) line _____ feet from (E) (W) line _____

Principal Contractor Abercrombie Drilling, Inc. Geologist Orlin Phelps

Spud Date September 25, 1977 Total Depth 4575 P.B.T.D. _____

Date Completed October 4, 1977 Oil Purchaser NONE

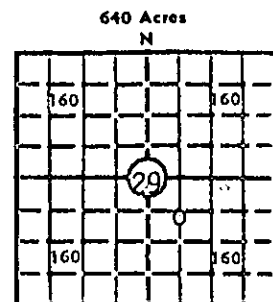

Elev.: Gr. 2961'

DF 2964' KB 2966'

CASING RECORD

Report of all strings set — surface, intermediate, production, etc.

Purpose of string	Size hole drilled	Size casing set (in O.D.)	Weight lbs/ft.	Setting depth	Type cement	Sacks	Type and percent additives
Surface	12 1/4"	8-5/8"	28#	252.92'	Common	200	2% gel 3% CaCl

LINER RECORD

PERFORATION RECORD

Top, ft.	Bottom, ft.	Sacks cement	Shots per ft.	Size & type	Depth Interval

TUBING RECORD

Size	Setting depth	Packer set at

ACID, FRACTURE, SHOT, CEMENT SQUEEZE RECORD

Amount and kind of material used	Depth interval treated

INITIAL PRODUCTION

Date of first production _____		Producing method (flowing, pumping, gas lift, etc.) _____			
RATE OF PRODUCTION PER 24 HOURS	Oil _____ bbls.	Gas _____ MCF	Water _____ bbls.	Gas-oil ratio _____ CFPB	
Disposition of gas (vented, used on lease or sold) _____			Producing interval (s) _____		

INSTRUCTIONS: As provided in KCC Rule 82-2-125, within 90 days after completion of a well, one completed copy of this Drillers Log shall be transmitted to the State Geological Survey of Kansas, 4150 Monroe Street, Wichita, Kansas 67209. Copies of this form are available from the Conservation Division, State Corporation Commission, 3830 So. Meridian (P.O. Box 17027), Wichita, Kansas 66217. Phone AC 316-522-2206. If confidential custody is desired, please note Rule 82-2-125. Drillers Logs will be on open file in the Oil and Gas Division, State Geological Survey of Kansas, Lawrence, Kansas 66044.

15-109-20092-00 00

DESIGNATE TYPE OF COMP.: OIL, GAS,
DRY HOLE, SWDW, ETC.:
Dry Hole

Operator
Abercrombie Drilling, Inc.

Well No. 1 Lease Name REPESHIRE

S 29 T 13S R 35 W

WELL LOG

Show all important zones of porosity and contents thereof; cored intervals, and all drill-stem tests, including depth interval tested, cushion used, time tool open, flowing and shut-in pressures, and recoveries.

SHOW GEOLOGICAL MARKERS, LOGS RUN, OR OTHER DESCRIPTIVE INFORMATION.

FORMATION DESCRIPTION, CONTENTS, ETC.	TOP	BOTTOM	NAME	DEPTH
Sand & shale	0	2351	SAMPLE TOPS:	
Anhydrite	2351	2378		
Shale & shells	2378	2518	Anhydrite	2351 (+615)
Shale & sand	2518	2934	B/Anhydrite	2378 (+588)
Shale	2934	3422	Heebner	3753 (-787)
Shale & Lime	3422	3905	Toronto	3779 (-813)
Lime	3905	4438	Lansing	3801 (-835)
Lime & sand	4438	4515	B/KC	4157 (-1191)
Lime	4515	4575	Pawnee	4269 (-1303)
Rotary Total Depth		4575	Fort Scott	4325 (-1359)
			Cher. Shale	4355 (-1389)
			Miss.	4545 (-1579)
			ELECTRIC LOG TOPS:	
			Anhydrite	2354 (+612)
			B/Anhydrite	2375 (+591)
			Heebner	3759 (-793)
			Toronto	3780 (-814)
			Lansing	3807 (-841)
			B/KC	4160 (-1194)
			Fort Scott	4327 (-1361)
			Cherokee	4357 (-1391)
			Miss	4544 (-1578)
			ELTD	4576 (-1610)
			RTD	4575 (-1609)

DST #1: (4318-4356) 30", 30", 30", 30".
Weak blow - 15". Recovered 20' mud.
IFP 42-42, IBHP 42, FFP 42-42, RBHP 42.
DST #2: (4354-4387) 30", 60", 90", 60".
Recovered 120' oil specked muddy water.
IFP 34-34
IBHP 1204, FFP 51-59

Temp. 118
Weak blow.
IFP 34-34

USE ADDITIONAL SHEETS, IF NECESSARY, TO COMPLETE WELL RECORD.

FBHP 1048 Temp 119
Date Received

Jack L. Partridge
Signature
Jack L. Partridge, Ass't. Secretary-Treasurer
Title
October 11, 1977
Date