

STATE CORPORATION COMMISSION OF KANSAS
OIL & GAS CONSERVATION DIVISION
WELL COMPLETION OR RECOMPLETION FORM
ACO-1 WELL HISTORY
DESCRIPTION OF WELL AND LEASE

API NO. 15-199-20,166-00-00
County Wallace
C NW SE Sec. 20 Twp 13S Rge. 39 East
West

Operator: License # 5806
Name Erbert Oil Company
Address 2904 N. State
City/State/Zip Iola, Kansas 66749

1980
1980
Ft North from Southeast Corner of Section
Ft West from Southeast Corner of Section
(Note: Locate well in section plat below)

Purchaser

Lease Name Dale Radiel Well # 1

Operator Contact Person Harold Erbert
Phone (316)-365-5150

Field Name

Producing Formation

Elevation: Ground 3389' KB 3394'

Contractor: License # 8241
Name Emphasis Oil Operations

Wellsite Geologist Ken Johnson
Phone (316)-682-7586

Designate Type of Completion
 New Well Re-Entry Workover
 Oil SWD Temp Abd
 Gas Inj Delayed Comp
 Dry Other (Core, Water Supply etc.)

RECEIVED
NOV 20 1988
11-29-1988
STATE CORPORATION COMMISSION
CONSERVATION DIVISION
Wichita, Kansas

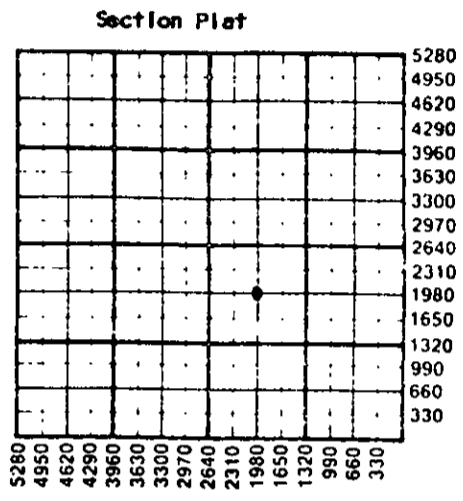

If ONWO: old well info as follows:
Operator
Well Name
Comp. Date Old Total Depth

WATER SUPPLY INFORMATION

Disposition of Produced Water: Disposal
Docket # Repressuring

WELL HISTORY
Drilling Method:
 Mud Rotary Air Rotary Cable
10/25/88 11/2/88 11-2-88
Spud Date Date Reached TD Completion Date
4800'
Total Depth PBTD

Questions on this portion of the ACO-1 call:
Water Resources Board (913) 296-3717

Source of Water:
Division of Water Resources Permit #

Groundwater.....Ft North from Southeast Corner
(Well)Ft West from Southeast Corner of
Sec Twp Rge East West

Surface Water..50..Ft North from Southeast Corner
(Stream, pond etc)..5230..Ft West from Southeast Corner
Sec 20 Twp 13S Rge 39 East X West

Other (explain).....
(purchased from city, R.W.D. #)

Amount of Surface Pipe Set and Cemented at 310 feet
Multiple Stage Cementing Collar Used? Yes No
If yes, show depth set.....feet
If alternate 2 completion, cement circulated
from.....feet depth to.....w/.....SX cmt
Cement Company Name
Invoice #

INSTRUCTIONS: This form shall be completed in triplicate and filed with the Kansas Corporation Commission, 200 Colorado Derby Building, Wichita, Kansas 67202, within 120 days of the spud date of any well. Rule 82-3-130, 82-3-107 and 82-3-106 apply. Information on side two of this form will be held confidential for a period of 12 months if requested in writing and submitted with the form. See rule 82-3-107 for confidentiality in excess of 12 months. One copy of all wireline logs and drillers time log shall be attached with this form. Submit CP-4 form with all plugged wells. Submit CP-111 form with all temporarily abandoned wells.

All requirements of the statutes, rules and regulations promulgated to regulate the oil and gas industry have been fully complied with and the statements herein are complete and correct to the best of my knowledge.

Signature Harold Erbert
Title Owner Date 11-28-88

Subscribed and sworn to before me this 28th day of NOVEMBER 1988
Notary Public L. D. Wilks
Date Commission Expires May 5, 1991

K.C.C. OFFICE USE ONLY
 Letter of Confidentiality Attached
 Wireline Log Received
 Drillers Timelog Received
Distribution
 KCC SWD/Rep NGA
 KGS Plug Other
(Specify)
11-29-88 41

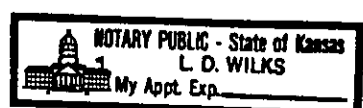

Sec 20 Twp 13Rge 39E

SIDE TWO

Operator Name Erbert Oil Company Lease Name Dale Radiel Well # 1

Sec. 20 Twp. 13S Rge. 29 East West County Wallace

WELL LOG

INSTRUCTIONS: Show important tops and base of formations penetrated. Detail all cores. Report all drill stem tests giving interval tested, time tool open and closed, flowing and shut-in pressures, whether shut-in pressure reached static level, hydrostatic pressures, bottom hole temperature, fluid recovery, and flow rates if gas to surface during test. Attach extra sheet if more space is needed. Attach copy of log.

Drill Stem Tests Taken Yes No
 Samples Sent to Geological Survey Yes No
 Cores Taken Yes No

Formation Description
 Log Sample

Name Top Bottom

CASING RECORD <input type="checkbox"/> New <input type="checkbox"/> Used										
Report all strings set-conductor, surface, intermediate, production, etc.										
Purpose of String	Size Hole Drilled	Size Casing Set (in O.D.)	Weight Lbs/Ft.	Setting Depth	Type of Cement	#Sacks Used	Type and Percent Additives			
.....			
.....			
.....			
PERFORATION RECORD				Acid, Fracture, Shot, Cement Squeeze Record						
Shots Per Foot	Specify Footage of Each Interval Perforated			(Amount and Kind of Material Used)		Depth				
.....				
.....				
.....				
.....				
TUBING RECORD				Liner Run <input type="checkbox"/> Yes <input type="checkbox"/> No						
Size	Set At	Packer at								
Date of First Production	Producing Method									
	<input type="checkbox"/> Flowing <input type="checkbox"/> Pumping <input type="checkbox"/> Gas Lift <input type="checkbox"/> Other (explain).....									
Estimated Production Per 24 Hours	Oil		Gas		Water		Gas-Oil Ratio		Gravity	
	Bbls		MCF		Bbls		CFPB			

METHOD OF COMPLETION

Production Interval

Disposition of gas: Vented Open Hole Perforation
 Sold Other (Specify)
 Used on Lease Dually Completed
 Commingled

* Amended

15-199-20166-00-00
SIDE TWO

Operator Name Erbert Oil Company Lease Name Dale Radcliff Well # 1

Twp. 20 N. Rge. 22 E. County Wallace

WELL LOG

INSTRUCTIONS: Show important tops and base of formations penetrated. Detail all cores. Report all drill stem tests giving interval tested, time tool open and closed, flowing and shut-in pressures, whether shut-in pressure reached static level, hydrostatic pressures, bottom hole temperature, fluid recovery, and flow rates up to surface during test. Attach extra sheet if more space is needed. Attach copy of log.

* Drill Stem Tests Taken Yes No
Samples Sent to Geological Survey Yes No
Cores Taken Yes No

Name	Formation Description	
	Top	Bottom
Anhydrite	2618	
Heebner	3901	
Lansing K.C	3938	
Marmaton	4329	
Morrow shale	4691	
T..D	4800	

CASING RECORD New Used

Report all strings set-conductor, surface, intermediate, production, etc.

Purpose of String	Size Hole Drilled	Size Casing Set (in O.D.)	Weight Lbs/Ft.	Setting Depth	Type of Cement	#Sacks Used	Type and Percent Additives
Surface	7-7/8	8-5/8	24#	310'	Common Pozmix Quickset	105 70 9 units	

PERFORATION RECORD

Shots Per Foot	Specify Footage of Each Interval Perforated	Acid, Fracture, Shot, Cement Squeeze Record (Amount and Kind of Material Used)	Depth

Size	Set At	Packer at	Liner Run <input type="checkbox"/> Yes <input type="checkbox"/> No

Date of First Production Producing Method Flowing Pumping Gas Lift Other (explain)

Estimated Production Per 24 Hours	Oil Bbls	Gas MCF	Water Bbls	Gas-Oil Ratio CFPB	Gravity

METHOD OF COMPLETION

Production Interval

Disposition of gas: Vented Sold Used on Lease Open Hole Perforation Other (Specify) Dually Completed Conmngled

nailed Nov 28, 88

SIDE ONE

STATE CORPORATION COMMISSION OF KANSAS
OIL & GAS CONSERVATION DIVISION
WELL COMPLETION OR RECOMPLETION FORM
ACO-1 WELL HISTORY
DESCRIPTION OF WELL AND LEASE

Operator: License # 5806
Name Erbert Oil Company
Address 2904 N. State
City/State/Zip Iola, Kansas 66749

Purchaser

Operator Contact Person Harold Erbert
Phone (316)-365-5150

Contractor: License # 8241
Name Emphasis Oil Operations

Well Site Geologist Ken Johnson
Phone (316)-682-7586

Designate Type of Completion
 New Well Re-Entry Workover
 Oil SWD Temp Abd
 Gas Inj Delayed Comp.
 Dry Other (Core, Water Supply etc.)

If OWWO: old well info as follows:
Operator
Well Name
Comp. Date Old Total Depth

WELL HISTORY

Drilling Method:
 Mid Rotary Air Rotary Cable
10/25/88 11/2/88
Spud Date Date Reached TD Completion Date
1800'
1' Depth PBD

Amount of Surface Pipe Set and Cemented at 310 feet
Multiple Stage Cementing Collar Used? Yes No
If yes, show depth set _____ feet
If alternate 2 completion, cement circulated
from _____ feet depth to _____ w/ _____ SX cmt
Cement Company Name
Invoice #

API NO. 15-199-20,166
County Wallace
C. NW SE Sec. 20 Twp. 13S Rge. 39 East
X West

1980 Ft North from Southeast Corner of Section
1980 Ft West from Southeast Corner of Section
(Note: Locate well in section plot below)

Lease Name Dale Radial Well # 1

Field Name

Producing Formation

Elevation: Ground 3389' KR 3394'

Section Plot

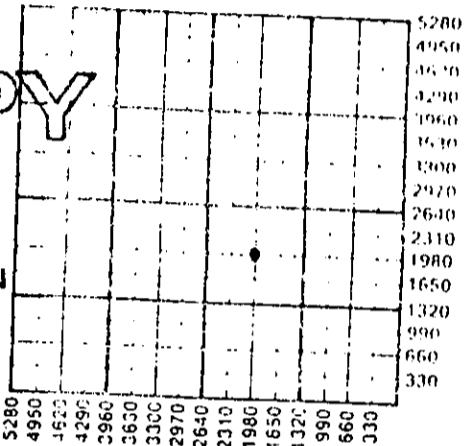

COPY

RECEIVED
STATE CORPORATION COMMISSION
OCT 15 1988

CONSERVATION DIVISION
Wichita, Kansas

WATER SUPPLY INFORMATION

Disposition of Produced Water: Disposal Repressuring
Docket #

Questions on this portion of the ACO-1 call:
Water Resources Board (913) 296-3717

Source of Water:
Division of Water Resources Permit #

Groundwater: Ft North from Southeast Corner (Well) Ft West from Southeast Corner of Sec Twp Rge East West

Surface Water: 50 Ft North from Southeast Corner (Stream, pond etc.) 5230 Ft West from Southeast Corner Sec 20 Twp 13S Rge 39 East X West

Other (explain) _____
(purchased from city, R.W.D. #)

INSTRUCTIONS: This form shall be completed in triplicate and filed with the Kansas Corporation Commission, 200 Colorado Derby Building, Wichita, Kansas 67202, within 120 days of the spud date of any well. Rule 82-3-130, 82-3-107 and 82-3-106 apply.

Information on side two of this form will be held confidential for a period of 12 months if requested in writing and submitted with the form. See rule 82-3-107 for confidentiality in excess of 12 months. One copy of all wireline logs and drillers time log shall be attached with this form. Submit CP-4 form with all plugged wells. Submit CP-111 form with all temporarily abandoned wells.

All requirements of the statutes, rules and regulations promulgated to regulate the oil and gas industry have been fully complied with and the statements herein are complete and correct to the best of my knowledge.

Signature Harold Erbert Date 11-28-88
Title Manager

Subscribed and sworn to before me this 28th day of NOVEMBER 1988
Notary Public L. D. Wilks
Date Commission Expires May 5, 1991

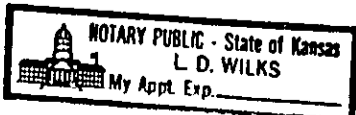

K.C.C. OFFICE USE ONLY
F Letter of Confidentiality Attached
C Wireline Log Received
C Drillers Time Log Received
Distribution
KCC SWD/Rep NGPA
KGS Plug Other
(Specify)