

AFFIDAVIT AND COMPLETION FORM

ACO-1

This form must be filed in triplicate with the Kansas Corporation Commission, 200 Colorado Derby Building, Wichita, Kansas 67202, within five days after the completion of the well, regardless of how the well was completed. Circle one: Oil, gas, dry, SWD, OWWO, injection. Please type. Complete ALL sections. Applications must be filed for dual completion, commingling, salt water disposal and injection. Attach wireline logs (i.e. electrical log, sonic log, gamma-ray neutron log, etc.) KCC#-(316) 263-3238.

OPERATOR Edward P. Leiker API NO. 15-051-20482-00-01
 ADDRESS Munjor Route Box 17 COUNTY Ellis
Hays, KS 67601 FIELD Engel or Leiker NW
 **CONTACT PERSON Edward P. Leiker LEASE Engel
 PHONE 913-625-5310

PURCHASER Permian WELL NO. 2-D OWWO
 ADDRESS _____ WELL LOCATION SE-SW-SW
330 Ft. from S Line and
990 Ft. from W Line of
 the 27 SEC. 14 TWP. 18 RGE. W
 S

DRILLING CONTRACTOR OWWO - Pro Chem ADDRESS Hays, KS

PLUGGING CONTRACTOR _____ ADDRESS _____

TOTAL DEPTH 3670 PBTD _____
 SPUD DATE Aug. 20, 1969 DATE COMPLETED Aug 1969
 ELEV: GR _____ DF _____ KB _____

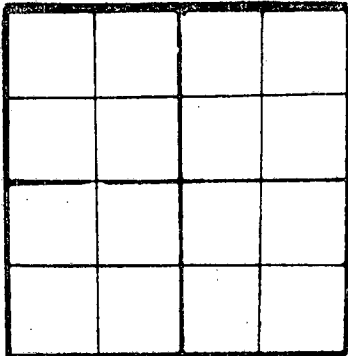

WELL 1/4
 PLAT W
 (Quarter) or (Full) Section - Please indicate.

KCC
 KGS
 MISC. _____

DRILLED WITH (CABLE) (ROTARY) (AIR) TOOLS
 Report of all strings set - surface, intermediate, production, etc. (New)/(Used) casing.

Purpose of string	Size hole drilled	Size casing set (in O.D.)	Weight lbs/ft.	Setting depth	Type cement	Sacks	Type and percent additives
Surface	12 3/4	8 5/8	24#	250	Common	150	
Casing	7 7/8	4 1/2	10#	3670	Common	150	

LINER RECORD			PERFORATION RECORD		
Top, ft.	Bottom, ft.	Sacks cement	Shots per ft.	Size & type	Depth interval
TUBING RECORD					
Size	Setting depth	Pecker set at			
2 3/8	3650		1 per ft	jets	3379-84 3414-3418

ACID, FRACTURE, SHOT, CEMENT SQUEEZE RECORD	
Amount and kind of material used	Depth interval treated
2000 gallon reg 15%	3379-84-3414-3418

TEST DATE:		PRODUCTION	
Date of first production <u>Jan. 1982</u>	Producing method (flowing, pumping, gas lift, etc.) <u>pumping</u>	A.P.I. Gravity	
RATE OF PRODUCTION PER 24 HOURS	Oil <u>1</u> bbls. MCF	Water <u>99</u> %	Gas-oil ratio
Disposition of gas (vented, used on lease or sold) <u>vent</u>		Producing interval (s) <u>KC</u>	

** The person who can be reached by phone regarding any questions concerning this information.
 A witnessed initial test by the Commission is required if the well produces more than 25 BOPD or is located in a Basic Order Pool.

28 1982 05-12-82
 CONSERVATION DIVISION
 Wichita Kansas

Name of lowest fresh water producing stratum Sand Depth 60
 Estimated height of cement behind pipe Surface

WELL LOG

Show all important zones of porosity and contents thereof; cored intervals, and all drill-stem tests, including depth interval tested, cushion used, time tool open, flowing and shut-in pressures, and recoveries.

SHOW GEOLOGICAL MARKERS, LOGS RUN, OR OTHER DESCRIPTIVE INFORMATION.

FORMATION DESCRIPTION, CONTENTS, ETC.	TOP	BOTTOM	NAME	DEPTH
Heeb	3290		Old Clinton Oil Company wash down	
10-00-14206-100-01 KC top	3334			
KC Base	3575			
Arb top	3668			
RTD	3674			

USE ADDITIONAL SHEETS, IF NECESSARY, TO COMPLETE WELL RECORD.

AFFIDAVIT

STATE OF Kansas, COUNTY OF Ellis SS,

Edward P. Leiker OF LAWFUL AGE, BEING FIRST DULY SWORN UPON HIS OATH, DEPOSES AND SAYS:

THAT HE IS _____ FOR _____ OPERATOR OF THE Engel LEASE, AND IS DULY AUTHORIZED TO MAKE THIS AFFIDAVIT FOR AND ON BEHALF OF SAID OPERATOR, THAT WELL NO. 2-D ON SAID LEASE HAS BEEN COMPLETED AS OF THE 10th DAY OF May 19 82, AND THAT ALL INFORMATION ENTERED HEREIN WITH RESPECT TO SAID WELL IS TRUE AND CORRECT.

FURTHER AFFIANT SAITH NOT.

(S) Edward P. Leiker

SUBSCRIBED AND SWORN TO BEFORE ME THIS 10th DAY OF May 19 82



Carol Harfmann
NOTARY PUBLIC

MY COMMISSION EXPIRES: 10-4-83

5861-21

AFFIDAVIT AND COMPLETION FORM

ACO-1

This form must be filed in triplicate with the Kansas Corporation Commission, 200 Colorado Derby Building, Wichita, Kansas 67202, within five days after the completion of the well, regardless of how the well was completed. Circle one: Oil, gas, dry, SWD, OWWO, injection. Please type. Complete ALL sections. Applications must be filed for dual completion, commingling, salt water disposal and injection. Attach wireline logs (i.e. electrical log, sonic log, gamma ray neutron log, etc.) KCC#-(316) 263-3238.

OPERATOR Edward P. Leiker
 ADDRESS Junior Route, Box 17
Hays, Kansas 67601

API NO. 15-051-20482-00-01-wash down
 COUNTY Ellis
 FIELD Engel
 LEASE Engel, Mary

**CONTACT PERSON Edward P. Leiker
 PHONE 913-625-5310

PURCHASER Permian Oil
 ADDRESS _____

WELL NO. 2-D OWWO
 WELL LOCATION SE - SW - SW
330 Ft. from S Line and
990 Ft. from W Line of
 the SW/4 SEC. 27 TWP. 14 RGE. 18

DRILLING CONTRACTOR Wash down - OWWD
Pro Chem
 ADDRESS Hays, Kansas

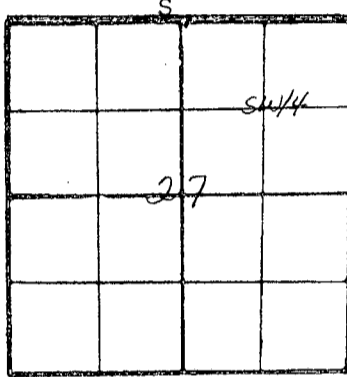

WELL PLAT
 (Quarter) or (Full) Section - Please indicate.

PLUGGING CONTRACTOR _____
 ADDRESS _____

TOTAL DEPTH 3675 PBTD _____
 SPUD DATE 10-28-81 DATE COMPLETED 10-31-81
 ELEV: GR _____ DF _____ KB 2065

KCC
 KGS
 MISC. _____

DRILLED WITH (CABLE) (ROTARY) (AIR) TOOLS
 Report of all strings set - surface, intermediate, production, etc. (New)/(Used) casing.

Purpose of string	Size hole drilled	Size casing set (in O.D.)	Weight lbs/ft.	Setting depth	Type cement	Sacks	Type and percent additives
Surface	13 3/4	8 5/8	24#	180	Common	125	Common OWWO
Casing	7 7/8	4 1/2	10 1/2#	3675	Common	125	Common

LINER RECORD			PERFORATION RECORD		
Top, ft.	Bottom, ft.	Sacks cement	Shots per ft.	Size & type	Depth interval

TUBING RECORD		
Size	Setting depth	Packer set at
2 3/8	3600	2 per ft

ACID, FRACTURE, SHOT, CEMENT SQUEEZE RECORD	
Amount and kind of material used	Depth interval treated
1000 gal 15% acid	3421-3380 - 1 mile
1000 gal 15% acid	3610-3614 - 4ft
	3628 to 3634

RECEIVED
 STATE CORPORATION COMMISSION
 MAY 12 1982
 CONSERVATION DIVISION
 WICHITA, KANSAS

TEST DATE:		PRODUCTION	
Date of first production	Producing method (flowing, pumping, gas lift)	A.P.I. Gravity	
January 28, 1982	Pumping		
RATE OF PRODUCTION PER 24 HOURS	Oil	Gas	Gas-oil ratio
	3 bbls.		
Disposition of gas (vented, used on lease or sold)		Produced in intervals	
vented		KC	

** The person who can be reached by phone regarding any questions concerning this information.
 A witnessed initial test by the Commission is required if the well produces more than 25 BOPD or is located in a Basic Order Pool.

Name of lowest fresh water producing stratum Sand & Shale Depth 50
 Estimated height of cement behind pipe Surface

WELL LOG

Show all important zones of porosity and contents thereof; cored intervals, and all drill-stem tests, including depth interval tested, cushion used, time tool open, flowing and shut-in pressures, and recoveries.

SHOW GEOLOGICAL MARKERS, LOGS RUN, OR OTHER DESCRIPTIVE INFORMATION.

FORMATION DESCRIPTION, CONTENTS, ETC.	TOP	BOTTOM	NAME	DEPTH
Old Wash Down . OWNO				
15-00-				
Heeb	3296			
KC Top	3340			
KC Base	3570			
TD	3675			

USE ADDITIONAL SHEETS, IF NECESSARY, TO COMPLETE WELL RECORD.

A F F I D A V I T

STATE OF Kansas, COUNTY OF Ellis SS,

Edward P. Leiker OF LAWFUL AGE, BEING FIRST DULY SWORN UPON HIS OATH, DEPOSES AND SAYS:

THAT HE IS _____ FOR _____ OPERATOR OF THE Engel, Mary LEASE, AND IS DULY AUTHORIZED TO MAKE THIS AFFIDAVIT FOR AND ON BEHALF OF SAID OPERATOR, THAT WELL NO. 2-D ON SAID LEASE HAS BEEN COMPLETED AS OF THE 10th DAY OF May 19 82; AND THAT ALL INFORMATION ENTERED HEREIN WITH RESPECT TO SAID WELL IS TRUE AND CORRECT.

FURTHER AFFIANT SAITH NOT.

(S) Edward Leiker

SUBSCRIBED AND SWORN TO BEFORE ME THIS 10th DAY OF May 19 82



Carol Harfmann
NOTARY PUBLIC

MY COMMISSION EXPIRES: 10-4-83