

STATE CORPORATION COMMISSION OF KANSAS
OIL & GAS CONSERVATION DIVISION
WELL COMPLETION OR RECOMPLETION FORM
ACO-1 WELL HISTORY
DESCRIPTION OF WELL AND LEASE

API NO. 15-051-21-656-00-01
County ELLIS
S.W. S.W. N.W. Sec 27. Twp 14S. Rge 12W. East West

Operator: License # 3070
Name R.L.R. Exploration
Address Box 1192
City/State/Zip Lawrence, Kansas 67601

330 Ft North from Southeast Corner of Section
380 Ft West from Southeast Corner of Section
(Note: Locate well in section plat below)

Purchaser

Lease Name Dnees Well # 1

Operator Contact Person P.A.V. Breit
Phone 913-625-7238

Field Name

Producing Formation No. 1 plug

Contractor: License # 5138
Name Jay L. Corp

Elevation: Ground 1997 KB 2002

Wellsite Geologist No. 1
Phone

Designate Type of Completion
New Well Re-Entry Workover
 Oil Gas Dry
SWD Inj Other (Core, Water Supply etc.)
Temp Abd Delayed Comp.

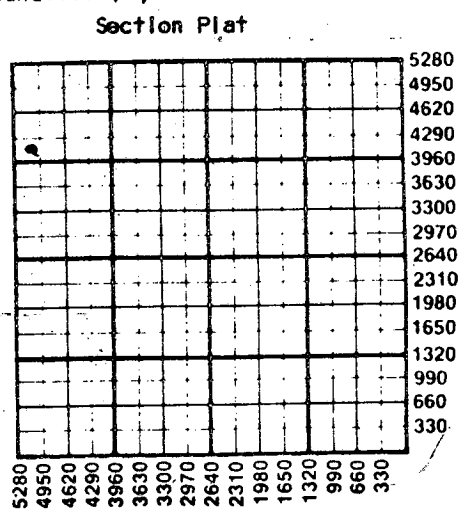

If ~~OWN~~ Old well info as follows:
Operator R.L.R. Exploration
Well Name Dnees No. 1
Comp. Date Plugged Old Total Depth 3653

WATER SUPPLY INFORMATION

Disposition of Produced Water: Disposal Repressuring
Docket #

WELL HISTORY

Drilling Method: Mud Rotary Air Rotary Cable
8-30-85 9-1-85 Plugged 10-21-85
Spud Date Date Reached TD Completion Date
3653 Nowe
Total Depth PBTD

Questions on this portion of the ACO-1 call:
Water Resources Board (913) 296-3717

Source of Water:
Division of Water Resources Permit #
Groundwater.....Ft North from Southeast Corner (Well)Ft West from Southeast Corner of Sec Twp Rge East West
Surface Water.....Ft North from Southeast Corner (Stream, pond etc).....Ft West from Southeast Corner Sec Twp Rge East West
Other (explain).....
(purchased from city, R.W.D. #)

Amount of Surface Pipe Set and Cemented at 1222 feet
Multiple Stage Cementing Collar Used? Yes No
If yes, show depth set.....feet
If alternate 2 completion, cement circulated from.....feet depth to.....w/.....SX cmt
Cement Company Name
Invoice #

INSTRUCTIONS: This form shall be completed in duplicate and filed with the Kansas Corporation Commission, 200 Colorado Derby Building, Wichita, Kansas 67202, within 90 days after completion or recompletion of any well. Rule 82-3-130 and 82-3-107 apply.
Information on side two of this form will be held confidential for a period of 12 months if requested in writing and submitted with the form. See rule 82-3-107 for confidentiality in excess of 12 months.
One copy of all wireline logs and drillers time log shall be attached with this form. Submit CP-4 form with all plugged wells. Submit CP-111 form with all temporarily abandoned wells.

All requirements of the statutes, rules and regulations promulgated to regulate the oil and gas industry have been fully complied with and the statements herein are complete and correct to the best of my knowledge.

Signature Ray Breit
Title Date 2-86

Subscribed and sworn to before me this 2 day of Jan 1986
Notary Public RALPH P. GOTTSCHALK State of Kansas
Date Commission Expires 3-21-88 My Appt. Exp.

K.C.C. OFFICE USE ONLY
F Letter of Confidentiality Attached
C Wireline Log Received
C Drillers Timelog Received
Distribution
 KCC SWD/Rep NGPA
 KGS Plug Other (Specify)
STATE CORPORATION COMMISSION
Form ACO-1 (7-84)

JAN 3 1986
01-03-86
CONSERVATION DIVISION
Wichita, Kansas

Sec 2 Twp 14 Rge 18 W

Operator Name R.R. Exploration Lease Name DAES OWN Well # 1

Sec. 22 Twp. 14 Rge. 17 East West County Ellis

WELL LOG

INSTRUCTIONS: Show important tops and base of formations penetrated. Detail all cores. Report all drill stem tests giving interval tested, time tool open and closed, flowing and shut-in pressures, whether shut-in pressure reached static level, hydrostatic pressures, bottom hole temperature, fluid recovery, and flow rates if gas to surface during test. Attach extra sheet if more space is needed. Attach copy of log.

Drill Stem Tests Taken Yes No
 Samples Sent to Geological Survey Yes No
 Cores Taken Yes No

Formation Description
 Log Sample

Name Top Bottom

Work Down

TOP 2961
 HEEB 3242
 LAWS 3291
 BKC 3518
 ARB 3624

CASING RECORD <input checked="" type="checkbox"/> New <input type="checkbox"/> Used							
Report all strings set-conductor, surface, intermediate, production, etc.							
Purpose of String	Size Hole Drilled	Size Casing Set (in O.D.)	Weight Lbs/Ft.	Setting Depth	Type of Cement	#Sacks Used	Type and Percent Additives
Production	17 1/2"	4 1/2"	15 #	3649	60/40	250	2906-EL
PERFORATION RECORD				Acid, Fracture, Shot, Cement Squeeze Record			
Shots Per Foot	Specify Footage of Each Interval Perforated			(Amount and Kind of Material Used)		Depth	
2	2960 - 3465			500 gal 15.79 acid			
2	3484 - 3494			1000 gal 15.79 acid			
TUBING RECORD				Liner Run <input type="checkbox"/> Yes <input type="checkbox"/> No			
Date of First Production	Producing Method						
None	<input type="checkbox"/> Flowing <input type="checkbox"/> Pumping <input type="checkbox"/> Gas Lift <input type="checkbox"/> Other (explain) <u>P.L.U.G.</u>						
Estimated Production Per 24 Hours	Oil	Gas	Water	Gas-Oil Ratio	Gravity		
	Bbls	MCF	Bbls	CFPB			

METHOD OF COMPLETION

Production Interval

Disposition of gas: Vented Open Hole Perforation
 Sold Other (Specify)
 Used on Lease Abnormally Completed
 Conmingled