

Notice: Fill out COMPLETELY and return to Conservation Division at the address below within 60 days from plugging date.

KANSAS CORPORATION COMMISSION  
OIL & GAS CONSERVATION DIVISION  
WELL PLUGGING RECORD  
K.A.R. 82-3-117

Form CP-4  
March 2009  
Type or Print on this Form  
Form must be Signed  
All blanks must be Filled

15-175-02033-00-00

OPERATOR: License #: 5817  
Name: Benson Mineral Group, Inc.  
Address 1: 1560 Broadway Suite 1900  
Address 2: \_\_\_\_\_  
City: Denver State: CO Zip: 80202  
Contact Person: James R. Perkins  
Phone: ( 620 ) 3742133  
Type of Well: (Check one)  Oil Well  Gas Well  OG  D&A  Cathodic  
 Water Supply Well  Other: \_\_\_\_\_  SWD Permit #: \_\_\_\_\_  
 ENHR Permit #: \_\_\_\_\_  Gas Storage Permit #: \_\_\_\_\_  
Is ACO-1 filed?  Yes  No If not, is well log attached?  Yes  No  
Producing Formation(s): List All (if needed attach another sheet)  
Bartlesville Depth to Top: 1025 Bottom: 1180 T.D. 1236  
\_\_\_\_\_ Depth to Top: \_\_\_\_\_ Bottom: \_\_\_\_\_ T.D. \_\_\_\_\_  
\_\_\_\_\_ Depth to Top: \_\_\_\_\_ Bottom: \_\_\_\_\_ T.D. \_\_\_\_\_

API No. 15 - no record  
Spot Description: \_\_\_\_\_  
SW - SW SW - SW Sec. 6 Twp. 34s. R. 16  East  West  
370 432 Feet from  North  South Line of Section  
100 513 Feet from  East  West Line of Section  
Footages Calculated from Nearest Outside Section Corner:  
 NE  NW  SE  SW  
County: Montgomery  
Lease Name: Hemphill Well #: 1  
Date Well Completed: 3-8-1947  
The plugging proposal was approved on: \_\_\_\_\_ (Date)  
by: Russell Hine (KCC District Agent's Name)  
Plugging Commenced: 12-16-09  
Plugging Completed: 12-21-09

Show depth and thickness of all water, oil and gas formations.

Oil, Gas or Water Records		Casing Record (Surface, Conductor & Production)			
Formation	Content	Casing	Size	Setting Depth	Pulled Out
Bartlesville	gas	20'	10"		0

Describe in detail the manner in which the well is plugged, indicating where the mud fluid was placed and the method or methods used in introducing cement or other plugs were used, state the character of same depth placed from (bottom), to (top) for each plug set.

finished out 2" tubing and 1" pipe. Washed welldown to 971. KCC man on depth. Logged well to find casing. There of 20' of 10" pipel Ran tubing down to 897' KCC Man on location oked depth. Pumped ge & 50' cement plug. pulled 10 jts tubing out (644'). Pumped get and pumped 100' cement plug, pulled 10 jts tubing out and pumped cement from 322 to surface. Pulled rest of tubing out and topped off with cement. Total cement used 15,980# abd 1259# gel.

RECEIVED  
FEB 1 2010  
KCC WICHITA

AR

Plugging Contractor License #: 34203 Name: Pirate Well Service  
Address 1: PO Box 7 Address 2: \_\_\_\_\_  
City: Howard State: Ks. Zip: 67349 + \_\_\_\_\_  
Phone: ( 620 ) 330-3666  
Name of Party Responsible for Plugging Fees: Benson Mineral Group, Inc.  
State of Kansas County, Elk, ss.  
James R. Perkins  Employee of Operator or  Operator on above-described well,  
affirmed (Print Name)  
being first duly sworn, says: That I have knowledge of the facts statements, and matters herein contained, and the log of the above-described well is as filed, and the same are true and correct, ~~to the best of my knowledge and belief~~  
Signature: James R. Perkins

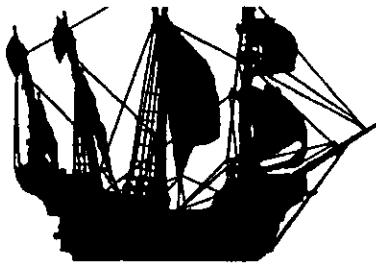

**INVOICE**  
 Pirate Well Service, LLC.  
 PO Box 7  
 747 E. Jefferson St.  
 Howard, KS 67349

Date 12/21/2009  
 Invoice # 373

Cell 620-330-3666  
 Home 620-374-2301  
 Fax 620-374-2301  
 kwardlow@sktc.net

**Bill To**  
 BMG

Terms Net 15

Due Date 1/5/2010

Description	Hours	Rate	Amount
Hemphill 1 (Plug well) 12/16/09 drive to well rig up, fish on 1st string of 2" pipe. Get hook on it & lay it out. Try to fish on 2nd string, no luck, have to get different fishing tool. 12/17/09 Run overshot over 1" pipe (about 4 times) got 7 jts out, started on 2" pipe (run about 12 times) got 19 1/2 jts out. Hook up swivel & get ready to wash well. 12/18/09 Run tubing & drill down, got to 971', lay out tubing. 12/21/09 wait on logging truck & log well, did not get down (only to 401'). run tubing in, had to wash & drill with tongs. Got to 897'. Pump gel & pump 50' plug, pull 10 jts (644') wait on water truck, finish pumping gel & pump 100' cement. Pull 10 jts & pump 322.73' plug, finish pulling pipe, clean up rig down.	29.5	120.00	3,540.00T
Pipe Dope	3	5.00	15.00T
tong usage	4	25.00	100.00T
Take trailer to yard & unload tubing.	1	55.00	55.00T

RECEIVED  
 FEB 01 2010  
 KCC WICHITA

**Subtotal** \$3,710.00  
**Sales Tax (5.3%)** \$196.63  
**Total** \$3,906.63

Make check payable to  
 Kevin Wardlow

**Balance Due** \$3,906.63

Thank you for  
 your business



**CONSOLIDATED**  
Oil Well Services, LLC

**REMIT TO**  
Consolidated Oil Well Services, LLC  
Dept. 970  
P.O. Box 4346  
Houston, TX 77210-4346

MAIN OFFICE  
P.O. Box 884  
Chanute, KS 66720  
620/431-9210 • 1-800/467-8676  
FAX 620/431-0012

INVOICE

Invoice # 232513

Invoice Date: 12/22/2009 Terms:

Page 1

BENSON MINERAL GROUP (2000)  
 BOX 707  
 HOWARD KS 67349  
 (620) 374-2133

HEMPHILL #1  
 22041  
 6-34-16  
 12/21/09

Part Number	Description	Qty	Unit Price	Total
1104	CLASS "A" CEMENT	15980.00	.1400	2237.20
1118B	PREMIUM GEL / BENTONITE	1250.00	.1600	200.00
1123	CITY WATER	13860.00	.0140	194.04
Description		Hours	Unit Price	Total
398	CEMENT PUMP	1.00	870.00	870.00
398	EQUIPMENT MILEAGE (ONE WAY)	40.00	3.45	138.00
398	MISC. PUMP (CEMENT TRUCK) MIT WASH	2.50	188.00	470.00
WASH-	WASH OR SWIVEL HEAD	1.00	94.00	94.00
NUNNE	WATER TRANSPORT (CEMENT)	7.50	105.00	787.50
518	MIN. BULK DELIVERY	1.00	300.00	300.00

RECEIVED  
FEB 2010  
KCC WICHITA  
RECEIVED  
DEC 23 2009  
BY: *Renal*

Parts:	2631.24	Freight:	.00	Tax:	139.45	AR	5430.19
Labor:	.00	Misc:	.00	Total:	5430.19		
Sublt:	.00	Supplies:	.00	Change:	.00		

Signed \_\_\_\_\_ Date \_\_\_\_\_

BARTLESVILLE, OK 918/338-0808    ELDORADO, KS 316/322-7022    EUREKA, KS 620/583-7664    GILLETTE, WY 307/686-4914    MCALESTER, OK 918/426-7667    OTTAWA, KS 785/242-4044    THAYER, KS 620/839-5269    WORLAND, WY 307/347-4577



**CONSOLIDATED**  
Oil Well Services, LLC

PO Box 884, Chanute, KS 66720  
620-431-9210 or 800-467-8676

# 232513

TICKET NUMBER 22041  
LOCATION Bartholomew, OK  
FOREMAN Kirk Jandart

**FIELD TICKET & TREATMENT REPORT**  
**CEMENT**

DATE	CUSTOMER #	WELL NAME & NUMBER	SECTION	TOWNSHIP	RANGE	COUNTY
12-21-09	1639	Hemp Hill #1	6	34	16	Marion
CUSTOMER Benson Mineral Group			TRUCK #	DRIVER	TRUCK #	DRIVER
MAILING ADDRESS			398	John		
CITY			518	Dusty		
STATE			Murphy's			
ZIP CODE						

JOB TYPE P+A HOLE SIZE \_\_\_\_\_ HOLE DEPTH \_\_\_\_\_ CASING SIZE & WEIGHT \_\_\_\_\_  
 CASING DEPTH \_\_\_\_\_ DRILL PIPE \_\_\_\_\_ TUBING 2 3/8 to 910' OTHER \_\_\_\_\_  
 SLURRY WEIGHT 14.5 SLURRY VOL \_\_\_\_\_ WATER gal/sk \_\_\_\_\_ CEMENT LEFT in CASING \_\_\_\_\_  
 DISPLACEMENT 3.2/2 DISPLACEMENT PSI \_\_\_\_\_ MIX PSI \_\_\_\_\_ RATE \_\_\_\_\_

REMARKS: Washed tubing down to 910', called hole & ran 50' plug on bottom. Rig pulled up to 680', ran 100' plug. Rig pulled up to 320', ran 140' end of cement to surface. Rig pulled tubing & tapped off. Shut down & washed up.

TOC on bottom plug, approx. 860'  
TOC on middle plug, " 540'  
Tap plug 320' to surface

ACCOUNT CODE	QUANTITY or UNITS	DESCRIPTION of SERVICES or PRODUCT	UNIT PRICE	TOTAL
5401	1	PUMP CHARGE (P+A)		870 <sup>00</sup>
5406	40	MILEAGE		138 <sup>00</sup>
5407	1	Bulk Trk		300 <sup>00</sup>
5611	1	Wash Head		94 <sup>00</sup>
5609	2.5 hrs	Pump Trk (Washing)		470 <sup>00</sup>
5501C	7.5 hrs	Transport		787 <sup>00</sup>
1104	15,980 <sup>00</sup>	Cement (Class A)	#	2,232 <sup>00</sup>
1118B	1250 <sup>00</sup>	Premium Gal	#	200 <sup>00</sup>
1123	13,860 gal	City Water	#	194 <sup>04</sup>
RECEIVED				
FEB 11 2010				
KCC WICHITA				
10% Discount \$543 <sup>00</sup>				
5.3%				
			SALES TAX	139 <sup>95</sup>
			ESTIMATED	
			TOTAL	5,490 <sup>19</sup>

Revin 3737

AUTHORIZATION

*[Signature]*

TITLE

DATE

**KANSAS DRILLERS LOG**

API No. 15 — N/A —                       
County Number

Operator  
Benson Mineral Group, Inc.

Address  
3200 Anaconda Tower, 555 17th St., Denver, CO

Well No.                      Lease Name  
Hemphill

Footage Location  
330' feet from 200' (S) line 100' feet from 00' (W) line

Principal Contractor Wycoff & Fitz Geologist                     

Spud Date N/A Total Depth 1236' P.B.T.D. 1235'

Date Completed 3/8/47 Oil Purchaser  
Union Gas Systems, Inc.

S. 6 T. 34S R. 16E E  
 W  
 Loc. SW SW SW  
 County Montgomery

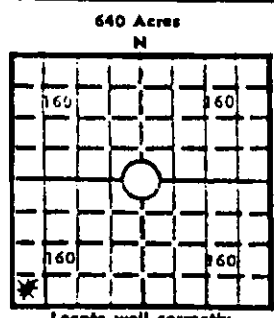

Elev.: Gr. 800  
 DF                      KB                     

**CASING RECORD**

Report of all strings set — surface, intermediate, production, etc.

Purpose of string	Size hole drilled	Size casing set (in O.D.)	Weight lbs/ft.	Setting depth	Type cement	Sacks	Type and percent additives
Prod. Csg.		10"		20'			
		8"		188'			
		6½"		1015'			

**LINER RECORD**

**PERFORATION RECORD**

Top, ft.	Bottom, ft.	Sacks cement	Shots per ft.	Size & type	Depth interval

Size	Setting depth	Packer set at

**ACID, FRACTURE, SHOT, CEMENT SQUEEZE RECORD**

Amount and kind of material used	Depth interval treated

RECEIVED  
 FEB 1 2010  
 KCC WICHITA

**INITIAL PRODUCTION**

Date of first production	Producing method (flowing, pumping, gas lift, etc.)				
<b>RATE OF PRODUCTION PER 24 HOURS</b>	Oil	Gas	Water	Gas-oil ratio	
	bbls.	MCF	bbls.	CFPB	
Disposition of gas (vented, used on lease or sold)			Producing interval(s)		

INSTRUCTIONS: As provided in KCC Rule 82-2-125, within 90 days after completion of a well, one completed copy of this Drillers Log shall be transmitted to the State Geological Survey of Kansas, 4150 Monroe Street, Wichita, Kansas 67209. Copies of this form are available from the Conservation Division, State Corporation Commission, 3830 So. Meridian (P.O. Box 17027), Wichita, Kansas 66217. Phone AC 316-522-2206. If confidential custody is desired, please note Rule 82-2-125. Drillers Logs will be on open file in the Oil and Gas Division, State Geological Survey of Kansas, Lawrence, Kansas 66044.