

For KCC Use: 9-6-2011  
 Effective Date: \_\_\_\_\_  
 District #: 3  
 SGA?  Yes  No

KANSAS CORPORATION COMMISSION  
 OIL & GAS CONSERVATION DIVISION  
**NOTICE OF INTENT TO DRILL**

Form C-1  
 March 2010  
**Form must be Typed**  
**Form must be Signed**  
**All blanks must be Filled**

*Must be approved by KCC five (5) days prior to commencing well*  
**Form KSONA-1, Certification of Compliance with the Kansas Surface Owner Notification Act, MUST be submitted with this form.**

Expected Spud Date: August 26, 2011  
month day year

OPERATOR: License# 34592  
 Name: Kansas Resource Exploration & Development, LLC  
 Address 1: 9393 W. 110th St., Suite 500  
 Address 2: \_\_\_\_\_  
 City: Overland Park State: KS Zip: 66210 + \_\_\_\_\_  
 Contact Person: Brad Kramer  
 Phone: (913) 669-2253

CONTRACTOR: License# 8509  
 Name: Evans Energy Development, Inc.

<input type="checkbox"/> Oil	<input checked="" type="checkbox"/> Enh Rec	<input checked="" type="checkbox"/> Infield	<input type="checkbox"/> Mud Rotary
<input type="checkbox"/> Gas	<input type="checkbox"/> Storage	<input type="checkbox"/> Pool Ext.	<input checked="" type="checkbox"/> Air Rotary
<input type="checkbox"/> Seismic ; _____ # of Holes	<input type="checkbox"/> Disposal	<input type="checkbox"/> Wildcat	<input type="checkbox"/> Cable
<input type="checkbox"/> Other: _____	<input type="checkbox"/> Other		

If OWWO: old well information as follows: \_\_\_\_\_

Operator: \_\_\_\_\_  
 Well Name: \_\_\_\_\_  
 Original Completion Date: \_\_\_\_\_ Original Total Depth: \_\_\_\_\_

Directional, Deviated or Horizontal wellbore?  Yes  No  
 If Yes, true vertical depth: \_\_\_\_\_  
 Bottom Hole Location: \_\_\_\_\_  
 KCC DKT #: \_\_\_\_\_

Spot Description: \_\_\_\_\_  
 NE - NW - SE - SW Sec. 14 Twp. 14 S. R. 22  E  W  
(0000) 3,633 feet from  N /  S Line of Section  
3,477 feet from  E /  W Line of Section

Is SECTION:  Regular  Irregular?  
 (Note: Locate well on the Section Plat on reverse side)  
 County: Johnson

Lease Name: Knabe D Well #: KRI-2  
 Field Name: Gardner  
 Is this a Prorated / Spaced Field?  Yes  No  
 Target Formation(s): Cherokee Group

Nearest Lease or unit boundary line (in footage): 908  
 Ground Surface Elevation: 1,030 Estimated \_\_\_\_\_ feet MSL  
 Water well within one-quarter mile:  Yes  No  
 Public water supply well within one mile:  Yes  No  
 Depth to bottom of fresh water: 200  
 Depth to bottom of usable water: 300  
 Surface Pipe by Alternate:  I  II  
 Length of Surface Pipe Planned to be set: 20'  
 Length of Conductor Pipe (if any): \_\_\_\_\_  
 Projected Total Depth: 900'  
 Formation at Total Depth: Bartlesville

Water Source for Drilling Operations:  
 Well  Farm Pond  Other: \_\_\_\_\_  
 DWR Permit #: \_\_\_\_\_

(Note: Apply for Permit with DWR   
 Will Cores be taken?  Yes  No  
 If Yes, proposed zone: \_\_\_\_\_

**AFFIDAVIT**

The undersigned hereby affirms that the drilling, completion and eventual plugging of this well will comply with K.S.A. 55 et. seq.  
 It is agreed that the following minimum requirements will be met:

1. Notify the appropriate district office **prior** to spudding of well;
2. A copy of the approved notice of intent to drill **shall be** posted on each drilling rig;
3. The minimum amount of surface pipe as specified below **shall be set** by circulating cement to the top; in all cases surface pipe **shall be set** through all unconsolidated materials plus a minimum of 20 feet into the underlying formation.
4. If the well is dry hole, an agreement between the operator and the district office on plug length and placement is necessary **prior to plugging**;
5. The appropriate district office will be notified before well is either plugged or production casing is cemented in;
6. If an ALTERNATE II COMPLETION, production pipe shall be cemented from below any usable water to surface within **120 DAYS** of spud date. Or pursuant to Appendix "B" - Eastern Kansas surface casing order #133,891-C, which applies to the KCC District 3 area, alternate II cementing must be completed within 30 days of the spud date or the well shall be plugged. **In all cases, NOTIFY district office** prior to any cementing.

I hereby certify that the statements made herein are true and to the best of my knowledge and belief.

Date: 7-29-11 Signature of Operator or Agent: [Signature] Title: Agent

**For KCC Use ONLY**  
 API # 15 - 091-23575-0000  
 Conductor pipe required None feet  
 Minimum surface pipe required 20 feet per ALT.  I  II  
 Approved by: [Signature]  
 This authorization expires: 9-1-2012  
(This authorization void if drilling not started within 12 months of approval date.)  
 Spud date: \_\_\_\_\_ Agent: \_\_\_\_\_

**Remember to:**

- File Certification of Compliance with the Kansas Surface Owner Notification Act (KSONA-1) with Intent to Drill;
- File Drill Pit Application (form CDP-1) with Intent to Drill;
- File Completion Form ACO-1 within 120 days of spud date;
- File acreage attribution plat according to field proration orders;
- Notify appropriate district office 48 hours prior to workover or re-entry;
- Submit plugging report (CP-4) after plugging is completed (within 60 days);
- Obtain written approval before disposing or injecting salt water.
- If well will not be drilled or permit has expired (See: authorized expiration date) please check the box below and return to the address below.

Well will not be drilled or Permit Expired Date: \_\_\_\_\_  
 Signature of Operator or Agent: \_\_\_\_\_

Mail to: KCC - Conservation Division,  
 130 S. Market - Room 2078, Wichita, Kansas 67202

RECEIVED  
 AUG 31 2011  
 KCC WICHITA

14  
 14  
 22  
 E  
 W

For KCC Use ONLY

API # 15 - 091-235750000

**IN ALL CASES PLOT THE INTENDED WELL ON THE PLAT BELOW**

In all cases, please fully complete this side of the form. Include items 1 through 5 at the bottom of this page.

Operator: Kansas Resource Exploration & Development, LLC

Lease: Knabe D

Well Number: KRI-2

Field: Gardner

Number of Acres attributable to well: \_\_\_\_\_

QTR/QTR/QTR/QTR of acreage: NE - NW - SE - NW

Location of Well: County: Johnson

3,633 feet from  N /  S Line of Section

3,477 feet from  E /  W Line of Section

Sec. 14 Twp. 14 S. R. 22  E  W

Is Section:  Regular or  Irregular

If Section is Irregular, locate well from nearest corner boundary.

Section corner used:  NE  NW  SE  SW

**PLAT**

Show location of the well. Show footage to the nearest lease or unit boundary line. Show the predicted locations of lease roads, tank batteries, pipelines and electrical lines, as required by the Kansas Surface Owner Notice Act (House Bill 2032).  
You may attach a separate plat if desired.

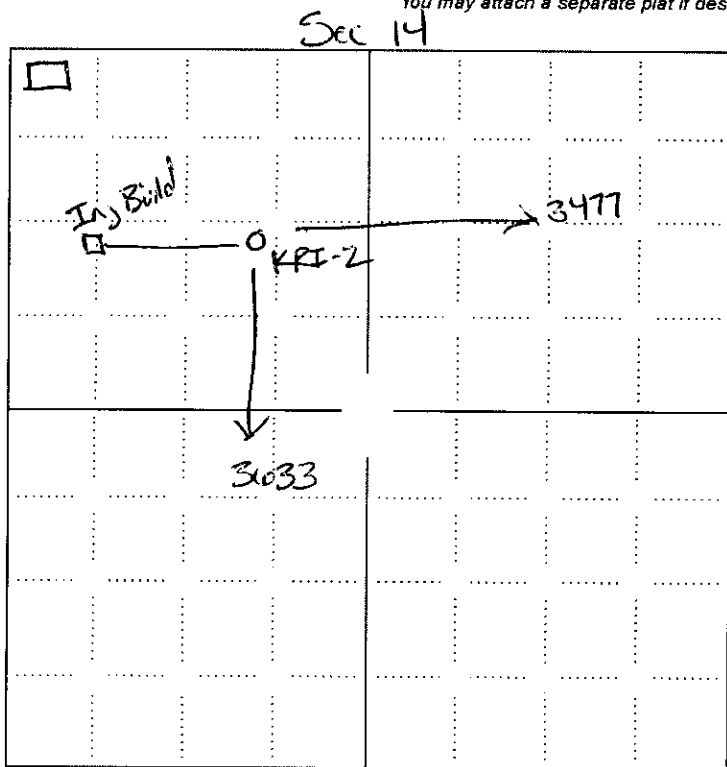

**LEGEND**

- Well Location
- Tank Battery Location
- Pipeline Location
- Electric Line Location
- Lease Road Location

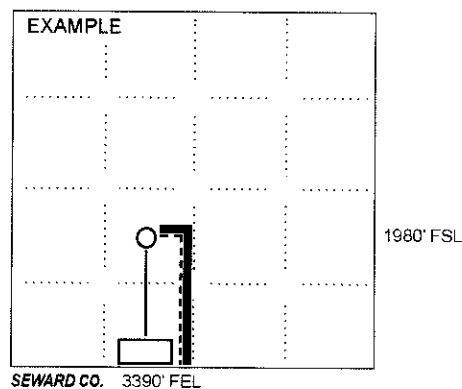

NOTE: In all cases locate the spot of the proposed drilling location.

**In plotting the proposed location of the well, you must show:**

1. The manner in which you are using the depicted plat by identifying section lines, i.e. 1 section, 1 section with 8 surrounding sections, 4 sections, etc.
2. The distance of the proposed drilling location from the south / north and east / west outside section lines.
3. The distance to the nearest lease or unit boundary line (in footage).
4. If proposed location is located within a prorated or spaced field a certificate of acreage attribution plat must be attached: (CO-7 for oil wells; CG-8 for gas wells).
5. The predicted locations of lease roads, tank batteries, pipelines, and electrical lines.

**RECEIVED**  
**AUG 31 2011**  
**KCC WICHITA**

15-091-23575-0000

KANSAS CORPORATION COMMISSION  
OIL & GAS CONSERVATION DIVISION

Form KSONA-1

July 2010

Form Must Be Typed

Form must be Signed

All blanks must be Filled

**CERTIFICATION OF COMPLIANCE WITH THE  
KANSAS SURFACE OWNER NOTIFICATION ACT**

*This form must be submitted with all Forms C-1 (Notice of Intent to Drill); CB-1 (Cathodic Protection Borehole Intent); T-1 (Request for Change of Operator Transfer of Injection or Surface Pit Permit); and CP-1 (Well Plugging Application). Any such form submitted without an accompanying Form KSONA-1 will be returned.*

Select the corresponding form being filed:  C-1 (Intent)  CB-1 (Cathodic Protection Borehole Intent)  T-1 (Transfer)  CP-1 (Plugging Application)

OPERATOR: License # 34592  
Name: Kansas Resource Exploration & Development, LLC  
Address 1: 9393 W. 110th St., Suite 500  
Address 2: \_\_\_\_\_  
City: Overland Park State: KS Zip: 66210 + \_\_\_\_\_  
Contact Person: Brad Kramer  
Phone: ( 913 ) 669-2253 Fax: ( 913 ) 451-6750  
Email Address: kramerbradley@yahoo.com

Well Location:  
NE NW SE NW Sec. 14 Twp. 14 S. R. 22  East  West  
County: Johnson  
Lease Name: Knabe D Well #: KRI-2

*If filing a Form T-1 for multiple wells on a lease, enter the legal description of the lease below:*

**Surface Owner Information:**

Name: Ronald & Susan Rushing  
Address 1: 661 N Pine Cir.  
Address 2: \_\_\_\_\_  
City: Gardner State: KS Zip: 66030 + \_\_\_\_\_

*When filing a Form T-1 involving multiple surface owners, attach an additional sheet listing all of the information to the left for each surface owner. Surface owner information can be found in the records of the register of deeds for the county, and in the real estate property tax records of the county treasurer.*

*If this form is being submitted with a Form C-1 (Intent) or CB-1 (Cathodic Protection Borehole Intent), you must supply the surface owners and the KCC with a plat showing the predicted locations of lease roads, tank batteries, pipelines, and electrical lines. The locations shown on the plat are preliminary non-binding estimates. The locations may be entered on the Form C-1 plat, Form CB-1 plat, or a separate plat may be submitted.*

**Select one of the following:**

- I certify that, pursuant to the Kansas Surface Owner Notice Act (House Bill 2032), I have provided the following to the surface owner(s) of the land upon which the subject well is or will be located: 1) a copy of the Form C-1, Form CB-1, Form T-1, or Form CP-1 that I am filing in connection with this form; 2) if the form being filed is a Form C-1 or Form CB-1, the plat(s) required by this form; and 3) my operator name, address, phone number, fax, and email address.
- I have not provided this information to the surface owner(s). I acknowledge that, because I have not provided this information, the KCC will be required to send this information to the surface owner(s). To mitigate the additional cost of the KCC performing this task, I acknowledge that I am being charged a \$30.00 handling fee, payable to the KCC, which is enclosed with this form.

*If choosing the second option, submit payment of the \$30.00 handling fee with this form. If the fee is not received with this form, the KSONA-1 form and the associated Form C-1, Form CB-1, Form T-1, or Form CP-1 will be returned.*

I hereby certify that the statements made herein are true and correct to the best of my knowledge and belief.

Date: 7-29-11 Signature of Operator or Agent: [Signature] Title: Agent

RECEIVED  
AUG 31 2011

KCC WICHITA

**KANSAS CORPORATION COMMISSION  
OIL & GAS CONSERVATION DIVISION  
APPLICATION FOR SURFACE PIT**

Form CDP-1  
May 2010  
Form must be Typed

*Submit in Duplicate*

Operator Name: <b>Kansas Resource Exploration &amp; Development, LLC</b>		License Number: <b>34592</b>
Operator Address: <b>9393 W. 110th St., Suite 500</b>		<b>Overland Park KS 66210</b>
Contact Person: <b>Brad Kramer</b>		Phone Number: <b>(913) 669-2253</b>
Lease Name & Well No.: <b>Knabe D KRI-2</b>		Pit Location (QQQQ): <b>NE - NW - SE - NW</b> Sec. <u>14</u> Twp. <u>14</u> R. <u>22</u> <input checked="" type="checkbox"/> East <input type="checkbox"/> West <u>3,633</u> Feet from <input type="checkbox"/> North / <input checked="" type="checkbox"/> South Line of Section <u>3,477</u> Feet from <input checked="" type="checkbox"/> East / <input type="checkbox"/> West Line of Section <b>Johnson</b> County
Type of Pit: <input type="checkbox"/> Emergency Pit <input type="checkbox"/> Burn Pit <input type="checkbox"/> Settling Pit <input checked="" type="checkbox"/> Drilling Pit <input type="checkbox"/> Workover Pit <input type="checkbox"/> Haul-Off Pit <small>(If WP Supply API No. or Year Drilled)</small>	Pit is: <input checked="" type="checkbox"/> Proposed <input type="checkbox"/> Existing If Existing, date constructed: _____ Pit capacity: <b>120</b> (bbls)	
Is the pit located in a Sensitive Ground Water Area? <input type="checkbox"/> Yes <input checked="" type="checkbox"/> No		Chloride concentration: _____ mg/l <small>(For Emergency Pits and Settling Pits only)</small>
Is the bottom below ground level? <input checked="" type="checkbox"/> Yes <input type="checkbox"/> No	Artificial Liner? <input type="checkbox"/> Yes <input checked="" type="checkbox"/> No	How is the pit lined if a plastic liner is not used? <b>Native Clay</b>
Pit dimensions (all but working pits): <u>15</u> Length (feet) <u>10</u> Width (feet) Depth from ground level to deepest point: <u>5</u> (feet)		<input type="checkbox"/> N/A: Steel Pits <input type="checkbox"/> No Pit
If the pit is lined give a brief description of the liner material, thickness and installation procedure.		Describe procedures for periodic maintenance and determining liner integrity, including any special monitoring.
Distance to nearest water well within one-mile of pit: <u>N/A</u> feet    Depth of water well _____ feet		Depth to shallowest fresh water _____ feet. Source of information: <input type="checkbox"/> measured <input type="checkbox"/> well owner <input type="checkbox"/> electric log <input checked="" type="checkbox"/> KDWR
<b>Emergency, Settling and Burn Pits ONLY:</b> Producing Formation: _____ Number of producing wells on lease: _____ Barrels of fluid produced daily: _____ Does the slope from the tank battery allow all spilled fluids to flow into the pit? <input type="checkbox"/> Yes <input type="checkbox"/> No		<b>Drilling, Workover and Haul-Off Pits ONLY:</b> Type of material utilized in drilling/workover: <u>Drilling Mud</u> Number of working pits to be utilized: <u>2</u> Abandonment procedure: <u>Air dry and backfill</u> Drill pits must be closed within 365 days of spud date.
I hereby certify that the above statements are true and correct to the best of my knowledge and belief.  <u>7-29-11</u> Date		<b>RECEIVED</b> <b>AUG 31 2011</b> <b>KCC WICHITA</b>
		<i>Signature of Applicant or Agent</i> <b>BK</b>

15-091-23575-00-00

<b>KCC OFFICE USE ONLY</b>			
Date Received: <u>8-31-11</u>	Permit Number: _____	Permit Date: <u>8-31-11</u>	Lease Inspection: <input type="checkbox"/> Yes <input checked="" type="checkbox"/> No
<input type="checkbox"/> Liner <input type="checkbox"/> Steel Pit <input type="checkbox"/> RFAC <input type="checkbox"/> RFAS			

Mail to: KCC - Conservation Division, 130 S. Market - Room 2078, Wichita, Kansas 67202

Conservation Division  
Finney State Office Building  
130 S. Market, Rm. 2078  
Wichita, KS 67202-3802



Phone: 316-337-6200  
Fax: 316-337-6211  
<http://kcc.ks.gov/>

Mark Sievers, Chairman  
Ward Loyd, Commissioner  
Thomas E. Wright, Commissioner

Sam Brownback, Governor

**NOTICE TO OPERATORS FILING INTENT TO DRILL  
FOR DISPOSAL OR ENHANCED RECOVERY  
INJECTION WELLS, (CLASS II INJECTION WELL)**

The attached approved Notice of Intent to Drill indicates the proposed well is to be used for injection. An approved "Intent to Drill" does not approve injection authority as a Class II Injection Well in Kansas.

Before any well is used for injection purposes, the operator must file an application for injection authority in accordance with K.A.R. 82-3-401 and provide notice in accordance with K.A.R. 82-3-402. The Conservation Division must issue a written permit granting the application before commencement of injection.

The Conservation Division requirements and restrictions associated with Class II Injection are identified in **K.A.R. 82-3-400 et seq** of our regulations. Associated regulations governing drilling, completion and injection applications may be found in K.A.R. 82-3-135, Table I, Table II, in the Cedar Hills Sandstone Moratorium, (Docket #156,397-C), and the Eastern Kansas Surface Casing Order, (Docket #133,891-C).

If you have questions regarding the approval of injection authority, an injection application may be filed as a "Design Approval" before actual drilling and completion of the well occurs. If you have any questions or concerns regarding Class II injection wells or regulations, call the Underground Injection Control Department at 316-337-6200.

Failure to obtain commission approval before beginning injection is punishable by a penalty, shut-in of the well or both.