

For KCC Use: 10-2-2011
 Effective Date: _____
 District # 3
 SGA? Yes No

KANSAS CORPORATION COMMISSION
 OIL & GAS CONSERVATION DIVISION

Form C-1
 March 2010
 Form must be Typed
 Form must be Signed
 All blanks must be Filled

NOTICE OF INTENT TO DRILL

Must be approved by KCC five (5) days prior to commencing well
 Form KSONA-1, Certification of Compliance with the Kansas Surface Owner Notification Act, MUST be submitted with this form.

Expected Spud Date: 10/03/2011
 month day year

OPERATOR: License# 6227 ✓
 Name: Kraft Oil LLC
 Address 1: 434 Iris Rd Sw
 Address 2: _____
 City: Gridley State: Ks Zip: 66852 + _____
 Contact Person: Thomas A. Kraft
 Phone: (620) 836-2091

CONTRACTOR: License# 33557
 Name: Skyy Drilling, LLC

Well Drilled For:	Well Class:	Type Equipment:
<input checked="" type="checkbox"/> Oil	<input checked="" type="checkbox"/> Infield	<input checked="" type="checkbox"/> Mud Rotary
<input type="checkbox"/> Gas	<input type="checkbox"/> Pool Ext.	<input type="checkbox"/> Air Rotary
<input type="checkbox"/> Enh Rec	<input type="checkbox"/> Wildcat	<input type="checkbox"/> Cable
<input type="checkbox"/> Storage	<input type="checkbox"/> Other	
<input type="checkbox"/> Disposal		
<input type="checkbox"/> Seismic ; # of Holes		
<input type="checkbox"/> Other: _____		

If OWWO: old well information as follows:
 Operator: _____
 Well Name: _____
 Original Completion Date: _____ Original Total Depth: _____

Directional, Deviated or Horizontal wellbore? Yes No
 If Yes, true vertical depth: _____
 Bottom Hole Location: _____
 KCC DKT #: _____

Spot Description: _____
NW - NE - SE - SW Sec. 26 Twp. 23 S. R. 14 E W
 (a/a/a/a) 1,140 feet from N / S Line of Section
3,100 feet from E / W Line of Section

Is SECTION: Regular Irregular?
 (Note: Locate well on the Section Plat on reverse side)

County: Woodson
 Lease Name: Watts (Rich B) Well #: 2
 Field Name: Winterschied

Is this a Prorated / Spaced Field? Yes No
 Target Formation(s): Mississippi

Nearest Lease or unit boundary line (in footage): 165' minimum
 Ground Surface Elevation: 1075 Es + 1115 feet MSL

Water well within one-quarter mile: Yes No
 Public water supply well within one mile: Yes No

Depth to bottom of fresh water: 20
 Depth to bottom of usable water: 150

Surface Pipe by Alternate: I II
 Length of Surface Pipe Planned to be set: 40
 Length of Conductor Pipe (if any): _____

Projected Total Depth: 1700
 Formation at Total Depth: Mississippi

Water Source for Drilling Operations:
 Well Farm Pond Other: _____
 DWR Permit #: _____

Will Cores be taken? Yes No
 If Yes, proposed zone: _____

AFFIDAVIT

The undersigned hereby affirms that the drilling, completion and eventual plugging of this well will comply with K.S.A. 55 et. seq.
 It is agreed that the following minimum requirements will be met:

1. Notify the appropriate district office **prior** to spudding of well;
2. A copy of the approved notice of intent to drill **shall be** posted on each drilling rig;
3. The minimum amount of surface pipe as specified below **shall be set** by circulating cement to the top; in all cases surface pipe **shall be set** through all unconsolidated materials plus a minimum of 20 feet into the underlying formation.
4. If the well is dry hole, an agreement between the operator and the district office on plug length and placement is necessary **prior to plugging**;
5. The appropriate district office will be notified before well is either plugged or production casing is cemented in;
6. If an ALTERNATE II COMPLETION, production pipe shall be cemented from below any usable water to surface within **120 DAYS** of spud date. Or pursuant to Appendix "B" - Eastern Kansas surface casing order #133,891-C, which applies to the KCC District 3 area, alternate II cementing must be completed within 30 days of the spud date or the well shall be plugged. **In all cases, NOTIFY district office** prior to any cementing.

I hereby certify that the statements made herein are true and to the best of my knowledge and belief.

Date: 09/23/2011 Signature of Operator or Agent: Thomas A. Kraft Title: Operator

For KCC Use ONLY
 API # 15 - 207-27951-0000
 Conductor pipe required None feet
 Minimum surface pipe required 40 feet per ALT. I II
 Approved by: Rum 9-27-2011
 This authorization expires: 9-27-2012
 (This authorization void if drilling not started within 12 months of approval date.)
 Spud date: _____ Agent: _____

Remember to:

- File Certification of Compliance with the Kansas Surface Owner Notification Act (KSONA-1) with Intent to Drill;
- File Drill Pit Application (form CDP-1) with Intent to Drill;
- File Completion Form ACO-1 within 120 days of spud date;
- File acreage attribution plat according to field proration orders;
- Notify appropriate district office 48 hours prior to workover or re-entry;
- Submit plugging report (CP-4) after plugging is completed (within 60 days);
- Obtain written approval before disposing or injecting salt water.
- If well will not be drilled or permit has expired (See: authorized expiration date) please check the box below and return to the address below.

Well will not be drilled or Permit Expired Date: _____
 Signature of Operator or Agent: _____

Mail to: KCC - Conservation Division,
 130 S. Market - Room 2078, Wichita, Kansas 67202

SEP 26 2011

KCC WICHITA

26
23
14
 E
 W

For KCC Use ONLY
 API # 15 - 207-27951-0000

IN ALL CASES PLOT THE INTENDED WELL ON THE PLAT BELOW

In all cases, please fully complete this side of the form. Include items 1 through 5 at the bottom of this page.

Operator: Kraft Oil LLC
 Lease: Watts (Rich B)
 Well Number: 2
 Field: Winterschied

Number of Acres attributable to well: _____
 QTR/QTR/QTR/QTR of acreage: NW - NE - SE - SW

Location of Well: County: Woodson
1,140 feet from N / S Line of Section
3,100 feet from E / W Line of Section
 Sec. 26 Twp. 23 S. R. 14 E W

Is Section: Regular or Irregular

If Section is Irregular, locate well from nearest corner boundary.

Section corner used: NE NW SE SW

PLAT

Show location of the well. Show footage to the nearest lease or unit boundary line. Show the predicted locations of lease roads, tank batteries, pipelines and electrical lines, as required by the Kansas Surface Owner Notice Act (House Bill 2032). You may attach a separate plat if desired.

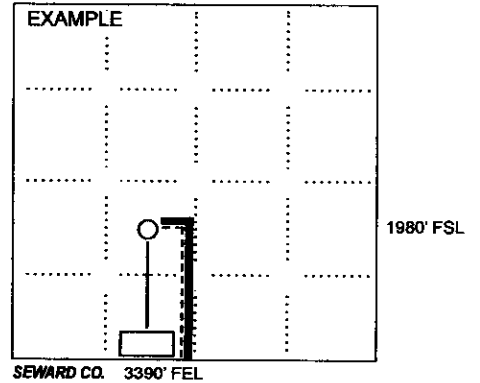
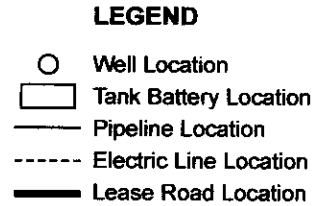
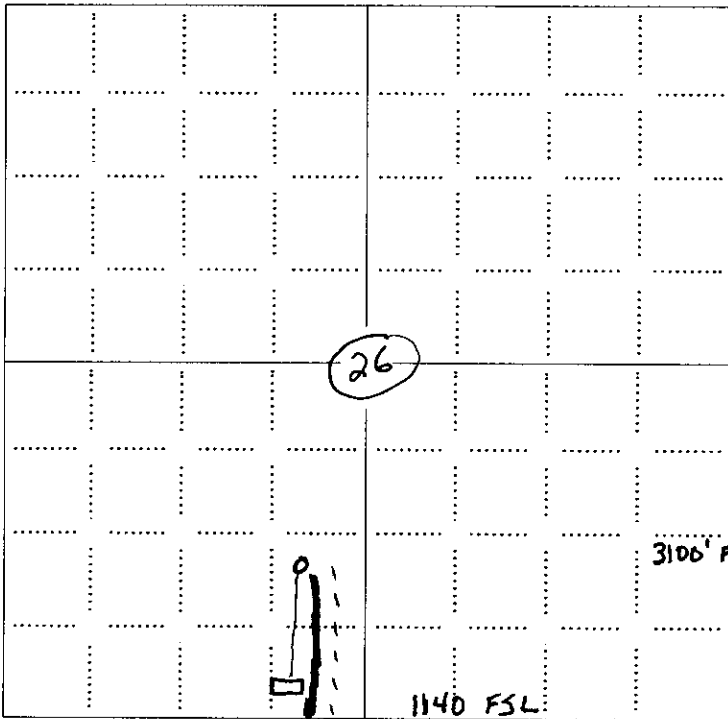

NOTE: In all cases locate the spot of the proposed drilling location.

Woodson

RECEIVED
 SEP 26 2011

KCC WICHITA

In plotting the proposed location of the well, you must show:

1. The manner in which you are using the depicted plat by identifying section lines, i.e. 1 section, 1 section with 8 surrounding sections, 4 sections, etc.
2. The distance of the proposed drilling location from the south / north and east / west outside section lines.
3. The distance to the nearest lease or unit boundary line (in footage).
4. If proposed location is located within a prorated or spaced field a certificate of acreage attribution plat must be attached: (CO-7 for oil wells; CG-8 for gas wells).
5. The predicted locations of lease roads, tank batteries, pipelines, and electrical lines.

15-207-27951-0000
KANSAS CORPORATION COMMISSION
OIL & GAS CONSERVATION DIVISION

Form KSONA-1
July 2010
Form Must Be Typed
Form must be Signed
All blanks must be Filled

**CERTIFICATION OF COMPLIANCE WITH THE
KANSAS SURFACE OWNER NOTIFICATION ACT**

This form must be submitted with all Forms C-1 (Notice of Intent to Drill); CB-1 (Cathodic Protection Borehole Intent); T-1 (Request for Change of Operator Transfer of Injection or Surface Pit Permit); and CP-1 (Well Plugging Application). Any such form submitted without an accompanying Form KSONA-1 will be returned.

Select the corresponding form being filed: C-1 (Intent) CB-1 (Cathodic Protection Borehole Intent) T-1 (Transfer) CP-1 (Plugging Application)

OPERATOR: License # 6227
Name: Kraft Oil LLC
Address 1: 434 Iris Rd Sw
Address 2: _____
City: Gridley State: Ks Zip: 66852 + _____
Contact Person: Thomas A. Kraft
Phone: (620) 836-2091 Fax: (_____) _____
Email Address: _____

Well Location:
NE SE SW Sec. 26 Twp. 23 S. R. 14 East West
County: Woodson
Lease Name: Watts (Rich B) Well #: 2

If filing a Form T-1 for multiple wells on a lease, enter the legal description of the lease below:

Surface Owner Information:

Name: Gail E. or Mary Ann Watts
Address 1: 1867 Grouse Rd
Address 2: _____
City: Gridley State: KS Zip: 66852 + _____

When filing a Form T-1 involving multiple surface owners, attach an additional sheet listing all of the information to the left for each surface owner. Surface owner information can be found in the records of the register of deeds for the county, and in the real estate property tax records of the county treasurer.

If this form is being submitted with a Form C-1 (Intent) or CB-1 (Cathodic Protection Borehole Intent), you must supply the surface owners and the KCC with a plat showing the predicted locations of lease roads, tank batteries, pipelines, and electrical lines. The locations shown on the plat are preliminary non-binding estimates. The locations may be entered on the Form C-1 plat, Form CB-1 plat, or a separate plat may be submitted.

Select one of the following:

I certify that, pursuant to the Kansas Surface Owner Notice Act (House Bill 2032), I have provided the following to the surface owner(s) of the land upon which the subject well is or will be located: 1) a copy of the Form C-1, Form CB-1, Form T-1, or Form CP-1 that I am filing in connection with this form; 2) if the form being filed is a Form C-1 or Form CB-1, the plat(s) required by this form; and 3) my operator name, address, phone number, fax, and email address.

I have not provided this information to the surface owner(s). I acknowledge that, because I have not provided this information, the KCC will be required to send this information to the surface owner(s). To mitigate the additional cost of the KCC performing this task, I acknowledge that I am being charged a \$30.00 handling fee, payable to the KCC, which is enclosed with this form.

If choosing the second option, submit payment of the \$30.00 handling fee with this form. If the fee is not received with this form, the KSONA-1 form and the associated Form C-1, Form CB-1, Form T-1, or Form CP-1 will be returned.

I hereby certify that the statements made herein are true and correct to the best of my knowledge and belief.

Date: 09/23/2011 Signature of Operator or Agent: Thomas A. Kraft Title: Operator

RECEIVED
SEP 26 2011
KCC WICHITA

**KANSAS CORPORATION COMMISSION
OIL & GAS CONSERVATION DIVISION
APPLICATION FOR SURFACE PIT**

Form CDP-1
May 2010
Form must be Typed

Submit in Duplicate

Operator Name: Kraft Oil LLC		License Number: 6227
Operator Address: 434 Iris Rd Sw		Gridley Ks 66852
Contact Person: Thomas A. Kraft		Phone Number: (620) 836-2091
Lease Name & Well No.: Watts (Rich B) 2		Pit Location (QQQQ): <u>NW - NE - SE - SW</u> Sec. <u>26</u> Twp. <u>23</u> R. <u>14</u> <input checked="" type="checkbox"/> East <input type="checkbox"/> West <u>1,140</u> Feet from <input type="checkbox"/> North / <input checked="" type="checkbox"/> South Line of Section <u>3,100</u> Feet from <input checked="" type="checkbox"/> East / <input type="checkbox"/> West Line of Section Woodson County
Type of Pit: <input type="checkbox"/> Emergency Pit <input type="checkbox"/> Burn Pit <input type="checkbox"/> Settling Pit <input checked="" type="checkbox"/> Drilling Pit <input type="checkbox"/> Workover Pit <input type="checkbox"/> Haul-Off Pit <small>(If WP Supply API No. or Year Drilled)</small>	Pit is: <input checked="" type="checkbox"/> Proposed <input type="checkbox"/> Existing If Existing, date constructed: _____ Pit capacity: _____ (bbbls)	
Is the pit located in a Sensitive Ground Water Area? <input type="checkbox"/> Yes <input checked="" type="checkbox"/> No		Chloride concentration: _____ mg/l <small>(For Emergency Pits and Settling Pits only)</small>
Is the bottom below ground level? <input checked="" type="checkbox"/> Yes <input type="checkbox"/> No	Artificial Liner? <input type="checkbox"/> Yes <input checked="" type="checkbox"/> No	How is the pit lined if a plastic liner is not used? Native Clay
Pit dimensions (all but working pits): <u>50</u> Length (feet) <u>10</u> Width (feet) <input type="checkbox"/> N/A: Steel Pits Depth from ground level to deepest point: <u>5</u> (feet) <input type="checkbox"/> No Pit		
If the pit is lined give a brief description of the liner material, thickness and installation procedure.		Describe procedures for periodic maintenance and determining liner integrity, including any special monitoring. Drilling company will mud up and maintain levels.
Distance to nearest water well within one-mile of pit: <u>N/A</u> feet Depth of water well _____ feet	Depth to shallowest fresh water _____ feet. Source of information: <input type="checkbox"/> measured <input type="checkbox"/> well owner <input type="checkbox"/> electric log <input type="checkbox"/> KDWR	
Emergency, Settling and Burn Pits ONLY: Producing Formation: _____ Number of producing wells on lease: _____ Barrels of fluid produced daily: _____ Does the slope from the tank battery allow all spilled fluids to flow into the pit? <input type="checkbox"/> Yes <input type="checkbox"/> No	Drilling, Workover and Haul-Off Pits ONLY: Type of material utilized in drilling/workover: <u>Drilling mud</u> Number of working pits to be utilized: <u>1</u> Abandonment procedure: <u>Let air dry and backfill.</u> Drill pits must be closed within 365 days of spud date.	

I hereby certify that the above statements are true and correct to the best of my knowledge and belief.

09/23/2011
Date

Thomas A. Kraft
Signature of Applicant or Agent

15-207-27951-0000
RECEIVED
SEP 26 2011
KCC WICHITA

KCC OFFICE USE ONLY			
Date Received: <u>9-26-11</u>	Permit Number: _____	Permit Date: <u>9-27-11</u>	Lease Inspection: <input checked="" type="checkbox"/> Yes <input type="checkbox"/> No
		<input type="checkbox"/> Liner <input type="checkbox"/> Steel Pit <input checked="" type="checkbox"/> RFAC <input type="checkbox"/> RFAS	

Mail to: KCC - Conservation Division, 130 S. Market - Room 2078, Wichita, Kansas 67202

September 27, 2011

Kraft Oil LLC
434 Iris Rd SW
Gridley, KS 66852

RE: Drilling Pit Application
Watts (Rich B) Lease Well No. 2
SW/4 Sec. 26-23S-14E
Woodson County, Kansas

Dear Sir or Madam:

District staff has inspected the above referenced location and has determined that the reserve pit shall be constructed **without slots**, the bottom shall be flat and reasonably level, and the free fluids must be removed. The fluids are to be removed from the reserve pit immediately after drilling operations have ceased.

If production casing is set all completion fluids shall be removed from the working pits daily. NO completion fluids or non-exempt wastes shall be placed in the reserve pit.

The fluids should be taken to an authorized disposal well. Please call the District Office at (620) 432-2300 when the fluids have been removed. Please file form CDP-5 (August 2004), Exploration and Production Waste Transfer, within 30 days of fluid removal. Conservation division forms are available through our office and on the KCC web site:
www.kcc.state.ks.us/conservation/forms.

A copy of this letter should be posted in the doghouse along with the approved Intent to Drill.

If you have any questions or concerns please feel free to contact the undersigned at the above address.

Sincerely,

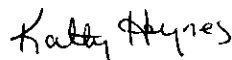

Kathy Haynes
Environmental Protection and Remediation Department

cc: File