

STATE CORPORATION COMMISSION OF KANSAS  
OIL & GAS CONSERVATION DIVISION  
WELL COMPLETION OR RECOMPLETION FORM  
ACO-1 WELL HISTORY  
DESCRIPTION OF WELL AND LEASE

Operator: License # ..... 6113 .....  
Name .. Landmark Oil Exploration Inc .....  
Address .250.N..Water..#308.....  
.....Wichita..KS.67202.....  
City/State/Zip .....

Purchaser.....NA.....

Operator Contact Person .. Jeff Wood .....  
Phone ..... 316-265-8181 .....

Contractor: License # ..... 5883 .....  
Name ... Warrior Drilling Co. ....

Wellsite Geologist .. Robert E. O'Dell .....  
Phone..... (316 721-2175) .....

Designate Type of Completion  
 New Well     Re-Entry     Workover  
  
 Oil                       SWD                       Temp Abd  
 Gas                       Inj                       Delayed Comp.  
 Dry                       Other (Core, Water Supply etc.)

If **OWNO**: old well info as follows:  
Operator .....

WELL HISTORY

Drilling Method:  
 Mud Rotary     Air Rotary     Cable  
  
8-25-88                      9-05-88                      9-06-88  
Spud Date                      Date Reached TD                      Completion Date  
  
4700'                      NA  
Total Depth                      PBTD

Amount of Surface Pipe Set and Cemented at 268' feet  
Multiple Stage Cementing Collar Used? Yes  No  
If yes, show depth set.....NA.....feet  
If alternate 2 completion, cement circulated  
from...NA.....feet depth to...NA.....w/.....SX cmt  
Cement Company Name .....NA.....  
Invoice # .....NA.....  
*AIT II DEA*

API NO. 15-..... 171-20,374-00-00 .....  
County..... Scott .....  
NE SE Sec 16 Twp 19S Rge 33 East  
1960  
1980  
660 Ft North from Southeast Corner of Section  
660 Ft West from Southeast Corner of Section  
(Note: Locate well in section plat below)

Lease Name..... HUTCHINS ..... Well #.. 1-16  
Field Name..... NA .....  
Producing Formation..... NA .....  
Elevation: Ground..... 2963 ..... KB..... 2968

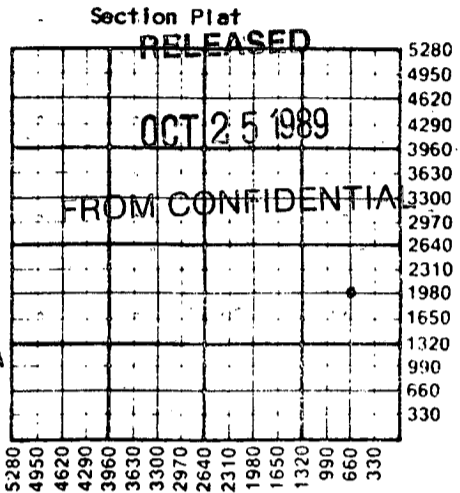

WATER SUPPLY INFORMATION

Disposition of Produced Water:                       Disposal  
Docket # .....                       Repressuring

Questions on this portion of the ACO-1 call:

Water Resources Board (913) 296-3717

Source of Water:                      well drilled in 1960  
Division of Water Resources Permit #.....

Groundwater.....Ft North from Southeast Corner  
(Well)                      .....Ft West from Southeast Corner of  
NE/4    Sec 16 Twp 19S Rge 33    East  West  
  
 Surface Water.....Ft North from Southeast Corner  
(Stream, pond etc).....Ft West from Southeast Corner  
Sec    Twp    Rge    East    West  
  
 Other (explain).....  
(purchased from city, R.W.D. #)

INSTRUCTIONS: This form shall be completed in triplicate and filed with the Kansas Corporation Commission, 200 Colorado Derby Building, Wichita, Kansas 67202, within 120 days of the spud date of any well. Rule 82-3-130, 82-3-107 and 82-3-106 apply.  
Information on side two of this form will be held confidential for a period of 12 months if requested in writing and submitted with the form. See rule 82-3-107 for confidentiality in excess of 12 months.  
One copy of all wireline logs and drillers time log shall be attached with this form. Submit CP-4 form with all plugged wells. Submit CP-111 form with all temporarily abandoned wells.

All requirements of the statutes, rules and regulations promulgated to regulate the oil and gas industry have been fully complied with and the statements herein are complete and correct to the best of my knowledge.

Signature .....  
Jeffrey R. Wood  
Title..... President ..... Date ..... 09/19/88

Subscribed and sworn to before me this .. 19th day of .. September ..  
19 88 ..  
Notary Public.....  
Karri Wolken  
Date Commission Expires..... Dec 21, 1991



K.C.C. OFFICE USE ONLY  
 Letter of Confidentiality Attached  
 Wireline Log Received  
 Drillers Timelog Received  
**Distribution**  
 KCC                       SWD/Rep                       NGPA  
 KGS                       Plug                       Other  
(Specify)  
.....  
.....

Sec 16 Twp 19 Rge 33

Operator Name ..... Landmark Oil Exploration, Inc ..... Lease Name ..... HUTCHINS ..... Well # ..... 1-16

Sec. 16 ..... Twp. 19S ..... Rge. 33 .....  East  West County ..... SCOTT .....

WELL LOG

INSTRUCTIONS: Show important tops and base of formations penetrated. Detail all cores. Report all drill stem tests giving interval tested, time tool open and closed, flowing and shut-in pressures, whether shut-in pressure reached static level, hydrostatic pressures, bottom hole temperature, fluid recovery, and flow rates if gas to surface during test. Attach extra sheet if more space is needed. Attach copy of log.

Drill Stem Tests Taken  Yes  No  
 Samples Sent to Geological Survey  Yes  No  
 Cores Taken  Yes  No

Formation Description  
 Log  Sample

DST #1 3906-3930, 60-45-45-60. Rec. 200' mw with a show of oil. FP 32-74/96-117#. SIP 951-909#.  
 DST #2 4163-4183, 30-45-45-60. Rec. 45' mud with a show of oil. FP 32-43/43-53#. SIP 1109-1088#.  
 DST #3 4337-4352, 30-45-30-45. Rec. 10' sl ocm. FP 32-32/32-32#. SIP 85-85#.  
 DST #4 4568-4640, 30-45-45-60. Rec. 15' mud, 20' sl ocm. FP 53-64/64-64#. SIP 773-657#.

| Name         | Top   | Bottom  |
|--------------|-------|---------|
| B. Anhydrite | 2213' | (+755)  |
| Heebner      | 3829' | (-861)  |
| Lansing      | 3877' | (-909)  |
| Stark        | 4172' | (-1204) |
| Marmaton     | 4323' | (-1355) |
| Mississippi  | 4637' | (-1669) |
| LTD          | 4700' | (-1732) |

RELEASED

OCT 25 1989

FROM CONFIDENTIAL

| CASING RECORD <input checked="" type="checkbox"/> New <input type="checkbox"/> Used |   |                           |                |   |  |             |                            |
|---|---|---------------------------|----------------|---|--|-------------|----------------------------|
| Report all strings set-conductor, surface, intermediate, production, etc.           |   |                           |                |   |  |             |                            |
| Purpose of String   | Size Hole Drilled   | Size Casing Set (in O.D.) | Weight Lbs/Ft. | Setting Depth                               | Type of Cement   | #Sacks Used | Type and Percent Additives |
| Surface   | 12 1/4"   | 8 5/8"                    | 20#            | 268'  | 60/40  | 180         | 3% cc. 2% gel              |
| PERFORATION RECORD  |   |                           |                | Acid, Fracture, Shot, Cement Squeeze Record |  |             |                            |
| Shots Per Foot  | Specify Footage of Each Interval Perforated   |                           |                | (Amount and Kind of Material Used)          |  | Depth       |                            |
| TUBING RECORD   |   |                           |                | Liner Run                                   | <input type="checkbox"/> Yes <input type="checkbox"/> No |             |                            |
| Date of First Production  | Producing Method <input type="checkbox"/> Flowing <input type="checkbox"/> Pumping <input type="checkbox"/> Gas Lift <input type="checkbox"/> Other (explain) ..... |                           |                |   |  |             |                            |
| Estimated Production Per 24 Hours   | Oil   | Gas                       | Water          | Gas-Oil Ratio                               | Gravity  |             |                            |
|   | bbls  | MCF                       | Bbls           | CFPB  |  |             |                            |

METHOD OF COMPLETION

Production Interval

Disposition of gas:  Vented  Open Hole  Perforation  
 Sold  Other (Specify) .....  
 Used on Lease  Dually Completed .....  
 Commingled .....