

**CORRECTED INTENT TO DRILL

15-051-24676-0000 Correction

FORM MUST BE TYPED

State of Kansas

FORM MUST BE SIGNED

FORM C-1 4/90

EFFECTIVE DATE: 8-5-90

NOTICE OF INTENTION TO DRILL

ALL BLANKS MUST BE FILLED

Must be approved by the K.C.C. five (5) days prior to commencing well

Expected Spud Date 08/07/90 month day year

S/2 NW Sec 20 Twp 14 S, Rg 18W East West

OPERATOR: License # 03919 Name: Challenger Exploration Address: P.O. Box 1112 City/State/Zip: Hays, Kansas 67601 Contact Person: Vincent J. Werth Phone: 913-628-2685

3630' feet from South line of Section 3160' feet from East line of Section (Note: Locate well on Section Plat on Reverse Side)

CONTRACTOR: License #: 3194 Name: Tri United, Inc.

County: Ellis Lease Name: Rohr Well #: #1 Field Name: Unknown Is this a Prorated Field? yes XX no Target Formation(s): Arbuckle Nearest lease or unit boundary: 330 Ground Surface Elevation: 2055 APX feet MSL Domestic well within 330 feet: yes XX no Municipal well within one mile: yes XX no Depth to bottom of fresh water: 450' Depth to bottom of usable water: 480' Surface Pipe by Alternate: 1 XX 2 Length of Surface Pipe Planned to be set: 250 Length of Conductor pipe required: ***** Projected Total Depth: 3650 Formation at Total Depth: Arbuckle Water Source for Drilling Operations: well farm pond XX other DWR Permit #: Will Cores Be Taken?: yes XX no If yes, proposed zone:

Well Drilled For: Well Class: Type Equipment:

XX Oil ... Inj XX Infield XX Mud Rotary ... Gas ... Storage ... Pool Ext. ... Air Rotary ... OWWD ... Disposal ... Wildcat ... Cable ... Seismic; ... # of Holes

If OWWD: old well information as follows: Operator: Well Name: Comp. Date: Old Total Depth

Directional, Deviated or Horizontal wellbore? yes XX no If yes, total depth location:

WAS: 330 FSL

AFFIDAVIT

IS: 3630 FSL

The undersigned hereby affirms that the drilling, completion and eventual plugging of this well will comply with K.S.A. 55-101, et. seq.

It is agreed that the following minimum requirements will be met:

- 1. The appropriate district office shall be notified before setting surface pipe;
2. The minimum amount of surface pipe as specified above shall be set by circulating cement to the top; in all cases surface pipe shall be set through all unconsolidated materials plus a minimum of 20 feet into the underlying formation;
3. If the well is dry, a plugging proposal shall be submitted to the district office. An agreement between the operator and the district office on plug length and placement is necessary prior to plugging;
4. The appropriate district office will be notified before well is either plugged or production casing is cemented in;
5. If an Alternate II completion, production pipe shall be cemented from below any usable water to surface within 120 days of spud date. In all cases, notify district office prior to any cementing.

I hereby certify that the statements made herein are true and to the best of my knowledge and belief.

Date: 10-17-90 Signature of Operator or Agent: Linda M. Brown Challenger Exploration Title: Accountant

FOR KCC USE: API # 15-051-24,676-00-00 Conductor pipe required None feet Minimum surface pipe required 250 feet per Alt. Approved by: Effective DATE: 8-5-90 This authorization expires: 1-31-91 (This authorization void if drilling not started within 6 months of effective date.) Spud date: Agent:

RECEIVED STATE CORPORATION COMMISSION OCT 19 1990 10-19-90 CONSERVATION DIVISION Wichita, Kansas

20 14 1865

REMEMBER TO:

- File Drill Pit Application (form CDP-1) with Intent to Drill;
- File Completion Form ACO-1 within 120 days of spud date;
- File acreage attribution plat according to field proration orders;
- Notify appropriate district office 48 hours prior to workover or re-entry;
- Submit plugging report (CP-4) after plugging is completed;
- Obtain written approval before disposing or injecting salt water.

Mail to: Conservation Division, 200 Colorado Derby Building, 202 W. First St., Wichita, Kansas 67202-1286.

PLAT OF ACREAGE ATTRIBUTABLE TO A WELL

State Corporation Commission, Conservation Division
200 Colorado Derby Bldg. Wichita, Kansas 67202

OPERATOR Challenger Exploration LOCATION OF WELL: S/2 NW Sec. 20-14-18W
 LEASE Rohr #1 3630' feet north of SE corner
 WELL NUMBER #1 3160' feet west of SE corner
 FIELD Unknown S/2 NW Sec. 20 T 14 R 18 NE/W
 COUNTY Ellis
 NO. OF ACRES ATTRIBUTABLE TO WELL 160 IS SECTION xx REGULAR IRREGULAR?
 IF IRREGULAR, LOCATE WELL FROM NEAREST
 DESCRIPTION OF ACREAGE _____ CORNER BOUNDARY.

NOTE: If plat depicted is insufficient for your circumstances, you may attach your own scaled or surveyed plat.

PLAT

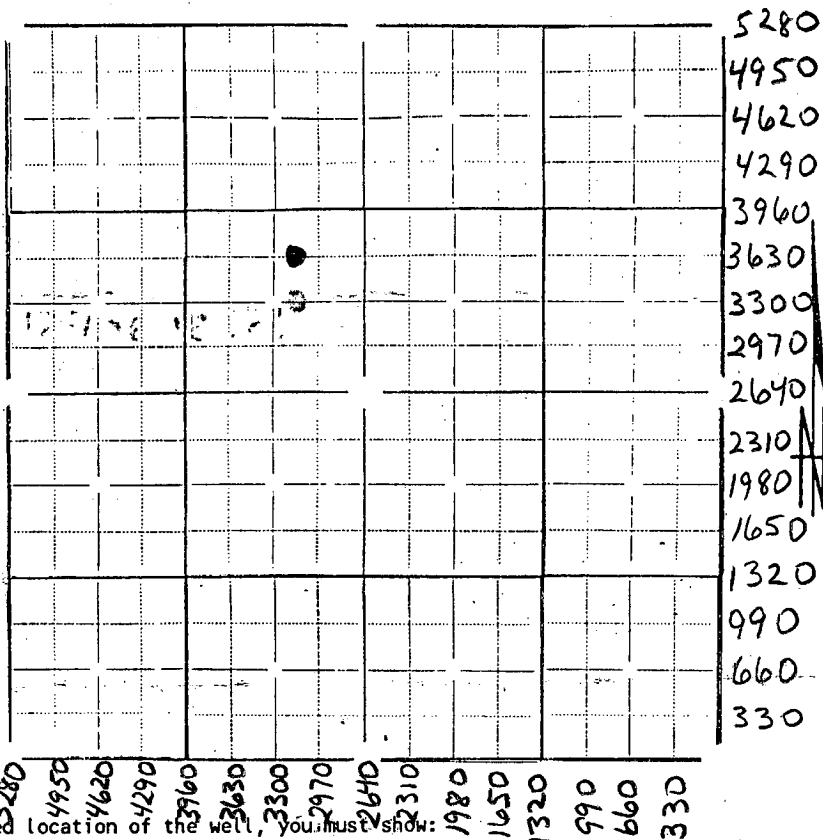

In plotting the proposed location of the well, you must show:

- 1) The manner in which you are using the depicted plat by identifying section lines, i.e. 1 section, 1 section with 8 surrounding partial sections, 4 sections, 16 sections, etc.;
- 2) the well's location relative to the location of other wells producing from the same common source of supply in adjoining drilling units, pursuant to K.A.R. 82-3-108, 82-3-207, 82-3-312, or special orders of the Commission;
- 3) *OP. 11-01* the distance of the proposed drilling location from the section's east and south lines; and
- 4) the distance to the nearest lease or unit boundary line.

I hereby certify that the statements made herein are true and to the best of my knowledge and belief.

Signature of Operator or Agent Linda Brown

Date 10-17-90 Title Accountant