

15-071-20714-00-00

FORM MUST BE TYPED

FORM MUST BE SIGNED

ALL BLANKS MUST BE FILLED

EFFECTIVE DATE: 10-4-99

DISTRICT # 1

State of Kansas

NOTICE OF INTENTION TO DRILL

Must be approved by the K.C.C. five (5) days prior to commencing well.

SGA? Yes No

Expected Spud Date November 1, 1999

Spot SW NE Sec 34 Twp 18S S, Rg 40 East West

OPERATOR: License # 32340
Name: Bluegrass Energy, Inc.
Address: 5727 S. Lewis Suite 260
City/State/Zip: Tulsa, OK 74105
Contact Person: Mark Repasky
Phone: 918-743-8060

1980 feet from South / North line of Section
1980 feet from East / West line of Section
IS SECTION X REGULAR IRREGULAR
(GREELEY)
County: Greeley
Lease Name: Clift "B" Well #: 2-34
Field Name: Bradshaw

CONTRACTOR: License #: ADVKS ON ACO-1
Name: unknown

Is this a Prorated/Spaced Field? yes X no
Target Formation(s): Chase
Nearest lease or unit boundary: 1980
Ground Surface Elevation: 3577 feet MSL
Water well within one-quarter mile: yes X no
Public water supply well within one mile: yes X no
Depth to bottom of fresh water: 220
Depth to bottom of usable water: 1400 1480
Surface Pipe by Alternate: 1 X 2
Length of Surface Pipe Planned to be set: 300
Length of Conductor pipe required: none
Projected Total Depth: 3000
Formation at Total Depth: Lower Ft. Riley
Water Source for Drilling Operations: well X farm pond other

Table with columns: Well Drilled For, Well Class, Type Equipment. Rows include Oil, Gas, GWO, Seismic, etc.

Directional, Deviated or Horizontal wellbore? yes X no
If yes, true vertical depth:
Bottom Hole Location:

Will Cores Be Taken? yes X no
If yes, proposed zone:

AFFIDAVIT

I, the undersigned hereby affirms that the drilling, completion and eventual plugging of this well will comply with K.S.A. 55-101, et seq. It is agreed that the following minimum requirements will be met:

- 1. Notify the appropriate district office prior to spudding of well;
2. A copy of the approved notice of intent to drill shall be posted on each drilling rig;
3. The minimum amount of surface pipe as specified below shall be set by circulating cement to the top;
4. If the well is dry hole, an agreement between the operator and the district office on plug length and placement is necessary prior to plugging;
5. The appropriate district office will be notified before well is either plugged or production casing is cemented in;
6. IF AN ALTERNATE II COMPLETION, PRODUCTION PIPE SHALL BE CEMENTED FROM BELOW ANY USABLE WATER TO SURFACE WITHIN 120 DAYS OF SPUD DATE. IN ALL CASES, NOTIFY DISTRICT OFFICE PRIOR TO ANY CEMENTING.

I hereby certify that the statements made herein are true and to the best of my knowledge and belief.

Date: 9/24/99 Signature of Operator or Agent: Philip Wade Title: President

FOR KCC USE: API # 15- 071-207140000
Conductor pipe required NONE feet
Minimum surface pipe required 240 feet per Alt. X(2)
Approved by: JK 9-29-99
This authorization expires: 3-29-2000
Spud date: Agent:

18 REVIEWED
KANSAS CORP COMM
1999 SEP 29 P 12:17
9-29-99

- MEMBER TO:
- File Drill Pit Application (form CDP-1) with Intent to Drill;
- File Completion Form ACO-1 within 120 days of spud date;
- File acreage attribution plat according to field prororation orders;
- Notify appropriate district office 48 hours prior to workover or re-entry;
- Submit plugging report (CP-4) after plugging is completed;
- Obtain written approval before disposing or injecting salt water.

Mail to: KCC - Conservation Division, 130 S. Market - Room 2078, Wichita, Kansas 67202.

**IN ALL CASES PLOT THE INTENDED WELL ON THE PLAT BELOW**

**PLAT OF ACREAGE ATTRIBUTABLE TO A WELL IN A PRORATED OR SPACED FIELD**

If the intended well is in a prorated or spaced field, please fully complete this side of the form. If the intended well is in a prorated or spaced field complete the plat below showing that the well will be properly located in relationship to other wells producing from the common source of supply. Please show all the wells within 1 mile of the boundaries of the proposed acreage attribution unit for gas wells and within 1/2 mile of the boundaries of the proposed acreage attribution unit for oil wells.

API NO. 15- \_\_\_\_\_  
 OPERATOR Bluegrass Energy, Inc.  
 LEASE Clift B  
 WELL NUMBER 2 34  
 FIELD Bradshaw

LOCATION OF WELL: COUNTY Greeley  
 \_\_\_\_\_ feet from ~~source~~ north line of section  
1980 feet from east/~~west~~ line of section  
 SECTION 34 TWP 18S RG 40W

NUMBER OF ACRES ATTRIBUTABLE TO WELL 640  
 QTR/QTR/QTR OF ACREAGE \_\_\_\_\_

IS SECTION X REGULAR or \_\_\_\_\_ IRREGULAR  
**IF SECTION IS IRREGULAR, LOCATE WELL FROM NEAREST CORNER BOUNDARY.**

Section corner used: \_\_\_\_\_ NE \_\_\_\_\_ NW \_\_\_\_\_ SE \_\_\_\_\_ SW

**PLAT**

(Show location of the well and shade attributable acreage for prorated or spaced wells.)  
 (Show footage to the nearest lease or unit boundary line.)

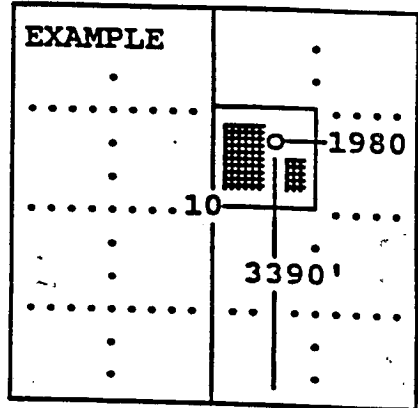
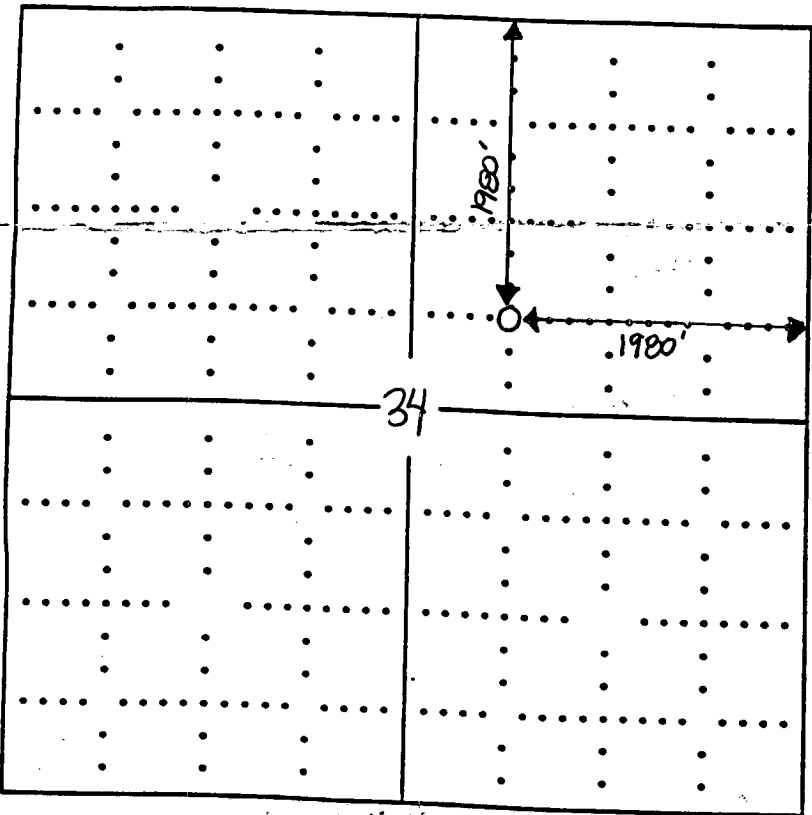

SEWARD CO.

**When plotting the proposed location of the well, you must show:**

- 1) The manner in which you are using the depicted plat by identifying section lines, i.e. 1 section, 1 section with 8 surrounding sections, 4 sections, etc.;
- 2) the distance of the proposed drilling location from the section's south/north and east/west; and
- 3) the distance to the nearest lease or unit boundary line.