

FOR KCC USE:

FORM C-1 7/91

EFFECTIVE DATE: 12-10-91

15-071-20555-00-00 P.O.

FORM MUST BE TYPED

FORM MUST BE SIGNED

ALL BLANKS MUST BE FILLED

DISTRICT # 1
SSA? Yes X No

State of Kansas
NOTICE OF INTENTION TO DRILL

Must be approved by the K.C.C. five (5) days prior to commencing well

Expected Spud Date December 10 1991
month day year

NE SE NE Sec 17 Twp 18 S Rg 42 East West

OPERATOR: License # 3317
Name: BEARD OIL COMPANY
Address: 5600 North May Avenue, Suite 200
City/State/Zip: Oklahoma City, OK 73112
Contact Person: Ivan D. Allred, Jr.
Phone: (405) 842-2333

3526 feet from South line of Section
130 feet from East line of Section
IS SECTION X REGULAR IRREGULAR?

(NOTE: Locate well on the Section Plat on Reverse Side)
County: Greeley
Lease Name: BOUNDS Well #: 1-17
Field Name: Wildcat

CONTRACTOR: License # 3032 30606
Name: Murfin Drilling Company, Inc.

Is this a Prorated/Spaced Field? yes X no
Target Formation(s): Mississippi Lime
Nearest lease or unit boundary: 434
Ground Surface Elevation: 3824 feet MSW

Well Drilled For: Well Class: Type Equipment:
X Oil Enh Rec Infield X Mud Rotary
Gas Storage Pool Ext Air Rotary
OWWO Disposal X Wildcat Cable
Seismic: # of Holes Other

Water well within one-quarter mile: X yes no
Public water supply well within one mile: yes X no
Depth to bottom of fresh water: 240
Depth to bottom of usable water: 1900 1650

If OWWO: old well information as follows:
Operator:
Well Name:
Comp. Date: Old Total Depth

Surface Pipe by Alternate: 1 X 2
Length of Surface Pipe Planned to be set: 350
Length of Conductor pipe required: NA

Directional, Deviated or Horizontal wellbore? yes X no
If yes, true vertical depth:
Bottom Hole Location:

Projected Total Depth: 5400
Formation at Total Depth: Mississippi Lime
Water Source for Drilling Operations:
... well ... farm pond X ... other

DWR Permit #:
Will Cores Be Taken? yes X no
If yes, proposed zone:

AFFIDAVIT

The undersigned hereby affirms that the drilling, completion and eventual plugging of this well will comply with K.S.A. 55-101, et. seq.
It is agreed that the following minimum requirements will be met:

1. Notify the appropriate district office prior to spudding of well;
2. A copy of the approved notice of intent to drill shall be posted on each drilling rig;
3. The minimum amount of surface pipe as specified below shall be set by circulating cement to the top; in all cases surface pipe shall be set through all unconsolidated materials plus a minimum of 20 feet into the underlying formation;
4. If the well is dry hole, an agreement between the operator and the district office on plug length and placement is necessary prior to plugging;
5. The appropriate district office will be notified before well is either plugged or production casing is cemented in;
6. IF AN ALTERNATE II COMPLETION, PRODUCTION PIPE SHALL BE CEMENTED FROM BELOW ANY USABLE WATER TO SURFACE WITHIN 120 DAYS OF SPUD DATE. IN ALL CASES, NOTIFY DISTRICT OFFICE PRIOR TO ANY CEMENTING.

I hereby certify that the statements made herein are true and to the best of my knowledge and belief.
Date: 12-2-91 Signature of Operator or Agent: Title: Vice President

RECEIVED
KANSAS CORPORATION COMMISSION
DEC 4 1991
CONSERVATION DIVISION
WICHITA, KS

FOR KCC USE:
API # 15- 071-20555-0000
Conductor pipe required None feet
Minimum surface pipe required 300 feet per Alt. # 2
Approved by: MLW 12-5-91
This authorization expires: 6-5-92
(This authorization void if drilling not started within 6 months of effective date.)
Spud date: Agent:

REMEMBER TO:

- File Drill Pit Application (form CDP-1) with Intent to Drill;
- File Completion Form ACO-1 within 120 days of spud date;
- File acreage attribution plat according to field proration orders;
- Notify appropriate district office 48 hours prior to workover or re-entry;
- Submit plugging report (CP-4) after plugging is completed;
- Obtain written approval before disposing or injecting salt water.

Mail to: Conservation Division, 200 Colorado Derby Building, 202 W. First St., Wichita, Kansas 67202-1286.

12
18
42

IN ALL CASES PLOT THE INTENDED WELL ON THE PLAT BELOW

PLAT OF ACREAGE ATTRIBUTABLE TO A WELL IN A PRORATED OR SPACED FIELD

If the intended well is in a prorated or spaced field, please fully complete this side of the form. If the intended well is in a prorated or spaced field complete the plat below showing that the well will be properly located in relationship to other wells producing from the common source of supply. Please show all the wells within 1 mile of the boundaries of the proposed acreage attribution unit for gas wells and within 1/2 mile of the boundaries of the proposed acreage attribution unit for oil wells.

API NO. 15- _____
 OPERATOR BEARD OIL COMPANY LOCATION OF WELL: COUNTY Greeley
 LEASE BOUNDS 3526 feet from south/~~west~~ line of section
 WELL NUMBER 1-17 130 feet from east/~~west~~ line of section
 FIELD Wildcat SECTION 17 TWP 18S RG 42W

NUMBER OF ACRES ATTRIBUTABLE TO WELL _____ IS SECTION X REGULAR or _____ IRREGULAR
 QTR/QTR/QTR OF ACREAGE E/2 - SE - NE IF SECTION IS IRREGULAR, LOCATE WELL FROM NEAREST CORNER BOUNDARY.
 Sec. 17 and W/2 SW NW Sec. 16
 (Declaraton of Pooled Unit) Section corner used: NE NW SE SW

PLAT

(Show location of the well and shade attributable acreage for prorated or spaced wells.)
 (Show footage to the nearest lease or unit boundary line.)

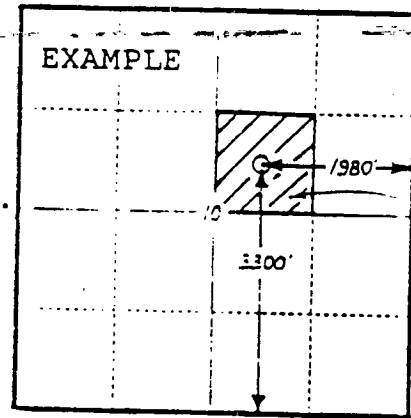
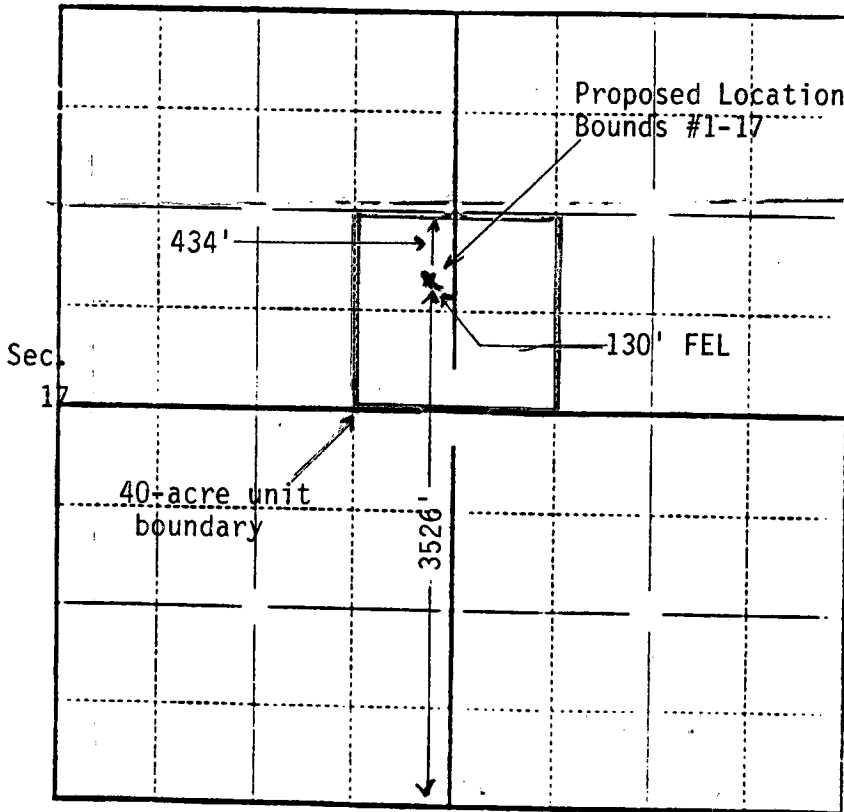

40 ACRES

In plotting the proposed location of the well, you must show:

- 1) The manner in which you are using the depicted plat by identifying section lines, i.e. 1 section, 1 section with 8 surrounding sections, 4 sections, etc.;
- 2) the distance of the proposed drilling location from the section's south/north and east/west lines; and
- 3) the distance to the nearest lease or unit boundary line.

RECEIVED
 OCT 1 1951
 DEPARTMENT OF REVENUE
 DENVER, COLORADO