

WELL PLUGGING RECORD

NE NE 1/4 Ellsworth
 County. Sec. 19 Twp. 14 Rge. 9 (E) (W)
 Location as "NE/CNW/SW" or footage from lines 330 East 330 North
 Lease Owner Ehrlich Drilling Co
 Lease Name Wapat #1 Well No. 1
 Office Address Wilson Kansas
 Character of Well (completed as Oil, Gas or Dry Hole)
 Date well completed _____ 19____
 Application for plugging filed Nov-16 1971
 Application for plugging approved _____ 1971
 Plugging commenced 2 P.M. Nov-17 1971
 Plugging completed 4 P.M. Nov 17 1971
 Reason for abandonment of well or producing formation _____

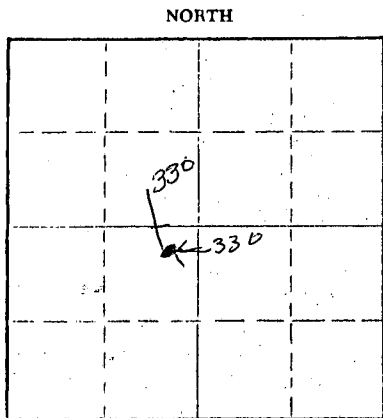

Locate well correctly on above Section Plat

If a producing well is abandoned, date of last production _____ 19____
 Was permission obtained from the Conservation Division or its agents before plugging was commenced? _____

Name of Conservation Agent who supervised plugging of this well S. Joman
 Producing formation _____ Depth to top _____ Bottom _____ Total Depth of Well 3161 Feet
 Show depth and thickness of all water, oil and gas formations.

| OIL, GAS OR WATER RECORDS | | | | | CASING RECORD | |
|---------------------------|---------|------|----|------|---------------|------------|
| FORMATION | CONTENT | FROM | TO | SIZE | PUT IN | PULLED OUT |
| | | | | | | |
| | | | | | | |
| | | | | | | |
| | | | | | | |
| | | | | | | |
| | | | | | | |
| | | | | | | |
| | | | | | | |
| | | | | | | |
| | | | | | | |

Describe in detail the manner in which the well was plugged, indicating where the mud fluid was placed and the method or methods used in introducing it into the hole. If cement or other plugs were used, state the character of same and depth placed, from _____ feet to _____ feet for each plug set.

Fluid at 250 ft. from top
Set Plug 26 ft. 1 Sack Hull's
30 Sack Cement. Mix by Hand. & Pump
Pumped thru to 35 ft. from top
Set Plug 40 ft. 1 Sack Hull's
15 Sack. Mixed by Hand. & Pumped
2 Sack Cement. 1 Sack Hull's Pat Hole

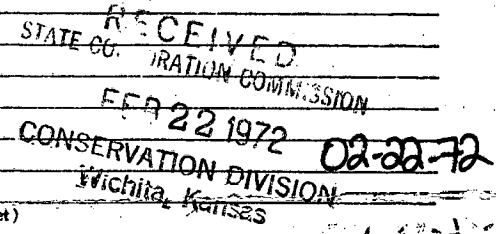

(If additional description is necessary, use BACK of this sheet)
 Name of Plugging Contractor _____
 Address _____

STATE OF KANSAS, COUNTY OF ELLSWORTH, ss.
Ehrlich Drilling Co., Julius Ehrlich, Partner (sole owner) or (owner or operator) of the above-described well, being first duly sworn on oath, says: That I have knowledge of the facts, statements, and matters herein contained and the log of the above-described well as filed and that the same are true and correct. So help me God.

(Signature) Julius Ehrlich
Wilson, Kansas 67490
 (Address)

SUBSCRIBED AND SWORN to before me this 17th day of February, 1972
B. R. Frevert
 My commission expires February 22, 1972
B. R. Frevert Notary Public.

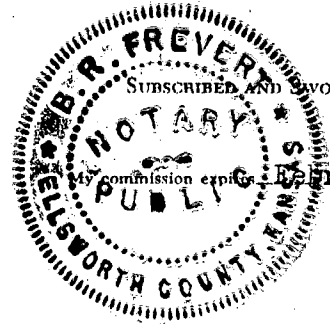

NO. 1 ADOLPH VOPAT

Well Log:

Location: The center NE $\frac{1}{4}$, NE $\frac{1}{4}$ of SW $\frac{1}{4}$ of Section 19, Commenced: Sept. 29, 1971
Township 14 South, Range 9 West of 6 th P.M.
Ellsworth County, Kansas

Operator: ~~Ehrlich Drilling Company~~ Jim Ehrlich Completed: October 17,
P. O. Box 173 Tom Ehrlich 1971
Wilson, Kansas 67490

Contractor: Ehrlich Drilling Company Elevation: None surveyed
P. O. Box 173 but estimated
Wilson, Kansas 67490 at 1665 K. B.

Casing: 160 feet of 8 - 5/8ths cemented with Production: D & A
100 sacks of common cement with Dowell
pump truck.

RECEIVED
STATE CORPORATION COMMISSION
MAR 9 1972
CONSERVATION DIVISION
Wichita, Kansas

- * * * L O G * * * -

(Figures indicate bottom of formation except where indicated otherwise)

| | | | |
|--------------------------------|------|--|------|
| Sappa & Grand Island formation | 54 | TOPEKA LIME top | 2376 |
| Dakota | 140 | Wilson Creek, | |
| Kiowa | 260 | Topeka lime top of | |
| Harper silt | 420 | KGS log | 2416 |
| Ninnescah shale | 590 | HEEBNER SHALE top | 2672 |
| Hutchinson salt top | 860 | Toronto lime top | 2692 |
| " " base | 1220 | Iatan top | 2773 |
| Herington lime top | 1220 | LANSING LIME top | 2797 |
| Towanda lime top | 1340 | Wilson pay zone top | 2818 |
| Ft. Riley lime top | 1370 | HERTHA LIME BASE | 3072 |
| Neva lime top | 1720 | Simpson shale top | 3140 |
| Foraker lime top | 1835 | ARBUCKLE DOLOMITE | |
| | | top | 3154 |
| Grandhaven lime top | 2045 | Total depth of | |
| First Tarkio sand top | 2051 | the well | 3169 |
| Dover lime top | 2069 | | |
| Second Tarkio Section | | From 2818 to 2824 feet with soft | |
| (Root Shale of KGS) | 2084 | small grain oolitic to oolitic | |
| Tarkio lime top | | light tan limestone with a fair | |
| (Stotler lime of KGS) | 2130 | odor was recovered with the oolitic | |
| Third Tarkio sand | | not too contiguous and 95% barren. | |
| (Pillsbury of KGS log) | 2159 | | |
| Elmont lime top | 2194 | From 2826 to 2831 feet, recovered | |
| Howard lime top | 2336 | larger grain light gray-tan oolitic | |
| | | limestone (95%) and oolitic (05%) | |
| The Wilson Creek (Topeka lime) | | and a show of free live oil with 95% | |
| from 2417 to 2421 feet was not | | barren. | |
| developed into dolomitic line | | | |
| and had no shows whatsoever. | | A drill-stem-test from 2814 to 2832 feet | |

for 3 hours and closed for 2 hours. It had a fair blow throughout with a one inch head. Recovered 125 feet of muddy water and 45 feet of drilling mud and a few specks of oil on top of test tool. The initial and final bottom hole pressures were 1085 to 985 lbs. The flow pressures were 20 and 70 lbs respectively and a temperature of 102 degrees. No electric or open hole logs were run.

The undersigned, EHRlich DRILLING COMPANY, hereby certifies that the above log is a true and correct log of the formations encountered in the drilling of the above well as reflected by daily drilling reports, and sample examination.

EHRlich DRILLING COMPANY

By:

Richard B. Schmidt
Richard B. Schmidt, geologist for

Tom and Jim Ehrlich