

15.171.20215.0000

500
Form CP-4
Rev. 12-15-80

STATE OF KANSAS
STATE CORPORATION COMMISSION
200 Colorado Derby Bldg.
Wichita, Kansas 67202

RECEIVED
STATE CORPORATION COMMISSION
12-23-81
DEC 23 1981

WELL PLUGGING RECORD

Give All Information Completely
Make Required Affidavit

COUNTY Scott SEC. 1 TWP. 20S RGE. 33W E/W
Location as in quarters or footage from lines: Conservation Division
Wichita, Kansas

Lease Owner M.L. Brown Co.
Lease Name PATTON 'C' Well No. 1
Office Address 200 Sutton Place, Wichita, KS 67202
Character of Well (Completed as Oil, Gas or Dry Hole): Dry Hole
Date Well Completed 12/09/81
Application for plugging filed 12/09/81
Plugging commenced 12/09/81
Plugging completed 12/09/81

Locate Well
correctly on above
Section Platt.

Reason for abandonment of well or producing formation
No commercial quantity of oil or gas encountered.

Was permission obtained from the Conservation Division or it's
Agent's before plugging was commenced? YES

Name of Conservation Agent who supervised plugging of this well Clarence Thomas, Jr.

Producing formation _____ Depth to top _____ bottom _____ T.D. 4950'

Show depth and thickness of all water, oil and gas formations.

OIL, GAS OR WATER RECORDS Casing Record

Formation	Content	From	To	Size	Put in	Pulled Out

Describe in detail the manner in which the well was plugged, indicating where the mud fluid was placed and the method or methods used in introducing it into the hold. If cement or other plugs were used, state the character of same and depth placed, from _____ feet to _____ feet for each plug set.

Set 1st plug @ 875' with 70 sx.
Set 2nd plug @ 570' with 40 sx.
Set 3rd plug @ 40' Sol. Bridge with 10 sx.
5 sx. in Rathole.
50-50 posmix, 2% gel, 3% c.c.
Plug was down @ 7:30 a.m., 12/09/81

(If additional description is necessary, use BACK of this sheet)

Name of Plugging Contractor Abercrombie Drilling, Inc.

STATE OF Kansas COUNTY OF Sedgwick, ss.
Jack L. Partridge, Vice Pres. (employee of owner) or (owner or operator) of the
above-described well, being first duly sworn on oath, says: That I have knowledge of the
facts, statements, and matters herein contained and the log of the above-described well as
filed and that the same are true and correct. So help me God.

(Signature) Jack L. Partridge
801 Union Center, Wichita, KS
(Address)

SUBSCRIBED AND SWORN TO before me this 11th day of December, 1981

My Commission expires: 7-13-85

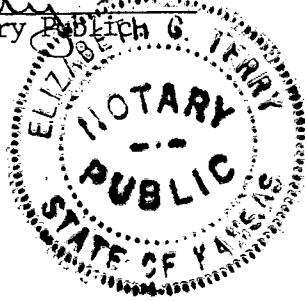
Elizabeth G. Terry
Elizabeth G. Terry Notary Public

KANSAS

WELL COMPLETION REPORT AND DRILLER'S LOG

API No. 15 - 171 - 20,215 - 0000
County Number

S. 1 T. 20S R. 33W E

Loc. C NW NW

County Scott

Operator The Maurice L. Brown Company

Address 200 Sutton Bldg., Wichita, Kansas 67202

Well No. 1 Lease Name Patton C

Footage Location 660 feet from (N) line 660 feet from (W) line

Principal Contractor Abercrombie Drilling Co. Geologist Ray Palmer

Spud Date 11-24-81 Date Completed 12-9-81 Total Depth 4950' P.B.T.D.

Directional Deviation Oil and/or Gas Purchaser P & A

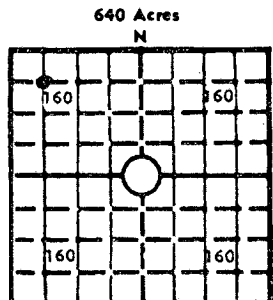

Locate well correctly

Elev.: Gr. 2950'

DF KB 2955'

CASING RECORD

Report of all strings set - surface, intermediate, production, etc.

Table with 8 columns: Purpose of string, Size hole drilled, Size casing set (in O.D.), Weight lbs./ft., Setting depth, Type cement, Sacks, Type and percent additives. Row 1: Surface, 12 1/4", 8-5/8", 24#, 602.13', HLC Class H, 300, 3%CC, 1/4#Flo/sx.

LINER RECORD

PERFORATION RECORD

Tables for Liner Record and Perforation Record. Liner Record columns: Top, ft., Bottom, ft., Sacks cement. Perforation Record columns: Shots per ft., Size & type, Depth interval.

ACID, FRACTURE, SHOT, CEMENT SQUEEZE RECORD

Amount and kind of material used

RECEIVED STATE CORPORATION COMMISSION DEC 7 1981 CONSERVATION DIVISION Wichita, Kansas

INITIAL PRODUCTION

Table for Initial Production with columns: Date of first production, Producing method, Rate of production per 24 hours (Oil, Gas, Water), Gas-oil ratio, Disposition of gas, Producing interval(s).

INSTRUCTIONS: As provided in KCC Rule 82-2-125, within 90 days after completion of a well, one completed copy of this Drillers Log shall be transmitted to the State Geological Survey of Kansas, 4150 Monroe Street, Wichita, Kansas 67209.

Operator

The Maurice L. Brown Company

DESIGNATE TYPE OF COMP.: OIL, GAS,
DRY HOLE, SWDW, ETC.:
Dry hole

Well No.

1

Lease Name

Patton "C"

S 1 T 20S R 33 W

WELL LOG

Show all important zones of porosity and contents thereof; cored intervals, and all drill-stem tests, including depth interval tested, cushion used, time tool open, flowing and shut-in pressures, and recoveries.

SHOW GEOLOGICAL MARKERS, LOGS RUN,
OR OTHER DESCRIPTIVE INFORMATION.

FORMATION DESCRIPTION, CONTENTS, ETC.

TOP

BOTTOM

NAME

DEPTH

See attached sheets

RECEIVED
STATE CORPORATION COMMISSION

DEC 17 1981

CONSERVATION DIVISION
Wichita, Kansas

USE ADDITIONAL SHEETS, IF NECESSARY, TO COMPLETE WELL RECORD

Date Received

John W. ...

Signature

Drilling Manager

Title

12-15-81

Date

GEOLOGICAL REPORT
NO. 1 PATTON 'C'
PAGE TWO

REMARKS:

All measurements are from Kelly Bushing (2955'). Both RTD and LTD were 4950' (-1995').

One foot drilling time was plotted from 3600' to TD. Ten foot samples were saved from 3600' to TD.

Two drill stem tests were taken covering Morrow and Mississippian zones.

FORMATIONS:

The following are the depths and datums of formation tops encountered as determined by sample and electrical/nuclear log analysis.

<u>Formation</u>	<u>Sample</u>	<u>Log</u>	<u>Datum</u>
Heebner	3835	3835	- 880
Toronto	3853	3855	- 900
Lansing	3880	3879	- 924
Wyandotte	3971	3971	-1016
Iola	4067	4068	-1113
Drum	4100	4100	-1145
Westerville	4137	4137	-1182
Dennis	4168	4168	-1213
Swope	4231	4232	-1277
Hertha	4264	4265	-1310
Base Kansas City	4300	4298	-1343
Marmaton	4320	4321	-1366
Beymer	4396	4397	-1442
Johnson	4424	4425	-1470
Cherokee	4439	4440	-1485
Morrow Shale	4588	4588	-1633
Morrow Sand	4604	4603	-1648
Mississippian	4620	4620	-1665
'C' ?	-	-	-
'D' ?	4692	4696	-1739
'X' ?	4820	4820	-1865
Spergen	4851	4854	-1899
Upper Ø	4861	4864	-1909
Lower Ø	4879	4879	-1924
TD	4950	4950	-1995

RECEIVED
STATE CORPORATION COMMISSION

DEC 17 1981

CONSERVATION DIVISION
Wichita, Kansas

GEOLOGICAL REPORT
NO. 1 PATTON 'C'
PAGE THREE

DRILL STEM TESTS:

A geological log is included with this report and is considered a part of it. Refer to it for sample descriptions. The following are drill stem test results.

Morrow, 4588 (4588 EL)
Mississippian, 4620 (4620 EL)

DST NO. 1
4580-4654 feet

Open 60 minutes, very weak blow. Shut-in
60 minutes. ~~Open 60 minutes, no blow.~~
Shut-in 90 minutes.
Recovered 10 feet of drilling mud.

Initial Hydrostatic Head	2491 psi
Initial Flow Pressure	29-59 psi
Initial Shut-in Pressure	789 psi
Final Flow Pressure	59-59 psi
Final Shut-in Pressure	760 psi
Final Hydrostatic Head	2462 psi
Temperature	122°

Mississippian (D?), 4693 (4696 EL)

DST NO. 2
4676-4826 feet

Open 90 minutes, very weak blow increased
throughout to 3 $\frac{1}{2}$ ". Shut-in 60 minutes.
Open 90 minutes, very weak blow increased
slightly throughout. Shut-in 120 minutes.
Recovered 210 feet of watery drilling mud.

Straddle Test,
log measurements

Initial Hydrostatic Head	2377 psi
Initial Flow Pressure	59-117 psi
Initial Shut-in Pressure	1137 psi
Final Flow Pressure	88-147 psi
Final Shut-in Pressure	1108 psi
Final Hydrostatic Head	2377 psi
Temperature	-

RECOMMENDATIONS AND CONCLUSIONS:

The following is a structural comparison of the No. 1 Patton 'C' to the M. L. Brown No.'s 1 and 2 Patton 'B', C NW NW and C SW NW, respectively, of Sec 36-T19S-R33W.

RECEIVED
STATE CORPORATION COMMISSION

DEC 17 1981

CONSERVATION DIVISION
Wichita, Kansas