

15-185-01567-00-00

WELL PLUGGING RECORD

FORMATION PLUGGING RECORD

Strike out upper line when reporting plugging off formations.

STATE OF KANSAS STATE CORPORATION COMMISSION

Give All Information Completely Make Required Affidavit Mail or Deliver Report to: Conservation Division State Corporation Commission, 800 Biting Building, Wichita, Kansas

SEP 24 1937

Stafford County. Sec. 23 Twp. 25S Rge. (E) 14 (W)

Location as "NE 1/4 NW 1/4 SW 1/4" or footage from lines 440' from S & W lines of lease

Lease Owner Skelly Oil Company

Lease Name Emma J. Kipp Well No. 1

Office Address Box 740, Hutchinson, Kansas

Character of Well (Completed as Oil, Gas or Dry Hole) Dry Hole

Date, well completed Sept. 10, 1937

Application for plugging filed Sept. 14, 1937

Application for plugging approved Sept. 15, 1937

Plugging Commenced Sept. 15, 1937

Plugging Completed Sept. 15, 1937

Reason for abandonment of well or producing formation Dry Hole

If a producing well is abandoned, date of last production 1937

Was permission obtained from the Conservation Division or its agents before plugging was commenced? Yes

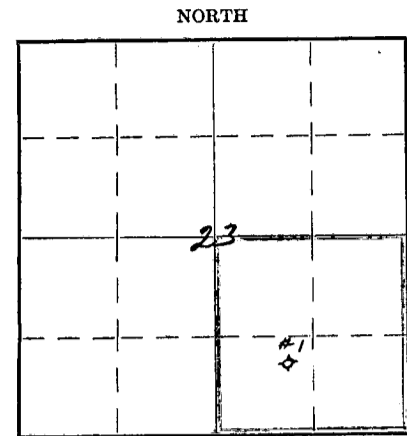

Locate well correctly on above Section Plat

Name of Conservation Agent who supervised plugging of this well C. T. Alexander

Producing formation Depth to top Bottom Total Depth of Well 3811' Feet

Show depth and thickness of all water, oil and gas formations.

OIL, GAS OR WATER RECORDS

CASING RECORD

Table with 7 columns: Formation, Content, From, To, Size, Put In, Pulled Out. Row 1: Kansas City Lime, Dry, 3750, 3811, 13"OD, 846'0", None.

Describe in detail the manner in which the well was plugged, indicating where the mud fluid was placed and the method or methods used in introducing it into the hole. If cement or other plugs were used, state the character of same and depth placed, from...feet to...feet for each plug set.

Plugged back with 130 sacks of cement from 3811' to 3550'

Filled hole with mud laden fluid from 3550' to 250'

Bridged hole with rock at 250'

Plugged back with 10 sacks of cement from 250' to 200' in 13"OD casing

Bridged hole with rock at 10'

Plugged back with 10 sacks of cement from 10' to 6'

Filled cellar with surface soil & rock from 6' to surface

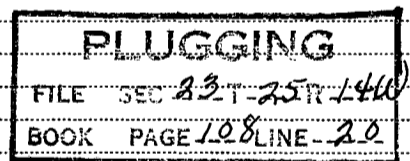

(If additional description is necessary use BACK of this sheet)

Correspondence regarding this well should be addressed to Skelly Oil Company Address Box 740, Hutchinson, Kansas

STATE OF Kansas, COUNTY OF Reno ss.

(employee of owner) or (owner or operator) of the above-described well, being first duly sworn on oath, says: That I have knowledge of the facts, statements, and matters herein contained and the log of the above-described well as filed and that the same are true and correct. So help me God.

(Signature) [Handwritten Signature]

(Address)

SUBSCRIBED AND SWORN to before me this 23 day of Sept, 1937

My commission expires June 22 1941



[Handwritten Signature] Notary Public.

15-185-01567-00-00

RECORD OF FORMATIONS

FORMATION	TOP	BOTTOM	REMARKS
			Indicate Casing Points, Describe Shows of Oil, Gas and Water, etc.
Sand & gravel	0	226	
Red rock	226	400	
Lime	400	440	
Red rock	440	795	
Lime & red rock	795	825	
Lime & anhydrite	825	860	
Shale	860	879	
Red rock	879	940	
Lime	940	950	
Red rock	950	1130	
Shale	1130	1380	
Shells	1380	1490	
Red & grey shale	1490	1640	
Salt	1640	1700	
Shale	1700	1750	
Lime	1750	1810	
Shale	1810	1830	
Lime	1830	2045	
Shale	2045	2060	
Broken lime	2060	2120	
Lime	2120	2140	
Shale	2140	2170	
Lime	2170	2200	
Broken lime	2200	2265	
Lime	2265	2630	
Broken lime	2630	2645	
Lime	2645	2770	
Lime & chert	2770	2785	
Lime	2785	2845	
Shale	2845	2950	
Lime	2950	3060	
Shale	3060	3080	
Lime	3080	3090	
Shale	3090	3190	
Lime	3190	3205	
Shale	3205	3285	
Lime	3285	3360	
Shale	3360	3400	
Lime	3400	3535	
Shale	3535	3540	
Lime	3540	3560	
Shale	3560	3565	
Lime	3565	3630	
Shale	3630	3695	
S.L.M.	3695	3697 $\frac{1}{2}$	

SEP 17 1937

Set & cemented 13"OD Lapweld Steel casing at 849' w/ 750 sacks of cement.

**PLUGGING**  
 FILE SEC 237-25R 146  
 BOOK PAGE 108 LINE 20

Base Mt. Oread Lime - 3520'

CORED: 3697 $\frac{1}{2}$ ' to 3710 $\frac{1}{2}$ ' - RECOVERED 13'  
 All dark grey shale

Reamed coredhole from 3697 $\frac{1}{2}$ ' to 3710 $\frac{1}{2}$ '

Drilled:

Dark grey shale	3710 $\frac{1}{2}$	3750
Grey & brown crystalline lime	3750	3760
Brown & grey oolitic lime	3760	3765
Lime	3765	3811

Top Lansing Lime - 3750'  
 No saturation  
 Dry hole

TOTAL DEPTH 3811'