

EFFECTIVE DATE: 2-1-92
DISTRICT # 4
SEAL Yes

State of Kansas
NOTICE OF INTENTION TO DRILL

FORM MUST BE SIGNED
ALL BLANKS MUST BE FILLED

Must be approved by the K.C.C. five (5) days prior to commencing well

Expected Spud Date: Feb. 1, 1992
month day year

Spot 30' N & 245' E
NE SW SW Sec 13 Twp 14S Rg 16E East West

OPERATOR: License # 6284
Name: Vonfeldt Oil Operations, Inc.
Address: 524 St. John
City/State/Zip: Russell, KS 67665
Contact Person: Roy Vonfeldt
Phone: 913/483-6446

1020' feet from South/North line of Section
4045' feet from East/West line of Section
IS SECTION X REGULAR IRREGULAR

(NOTE: Locate well on the Section Plat on Reverse Side)
County: Ellis
Lease Name: Hammerschmidt B Well #: 1
Field Name:
Is this a Prorated/Spaced Field? yes X no
Target Formation(s): Arbuckle
Nearest lease or unit boundary: 1020'
Ground Surface Elevation: 1870' NA feet MSL
Water well within one-quarter mile: yes X no
Public water supply well within one mile: yes X no
Depth to bottom of fresh water: 325'
Depth to bottom of usable water: 450'
Surface Pipe by Alternate: 1 X 2
Length of Surface Pipe Planned to be set: 250'
Length of Conductor pipe required: N/A
Projected Total Depth: 3500'
Formation at Total Depth: Arbuckle
Water Source for Drilling Operations:
... well X farm pond ... other
D&R Permit #:
Will Cores be Taken?: yes X no
If yes, proposed zone:

CONTRACTOR: License # 9481
Name: Vonfeldt Drilling Company

Well Drilled For: Well Class: Type Equipment:
X Oil Enh Rec X Infield X Mud Rotary
Gas Storage Pool Ext Air Rotary
O&W Disposal Wildcat Cable
Seismic # of Holes Other

If O&W: old well information as follows:
Operator:
Well Name:
Comp. Date: Old Total Depth

Directional, Deviated or Horizontal wellbore? yes X no
If yes, true vertical depth:
Bottom Hole Location:

AFFIDAVIT

The undersigned hereby affirms that the drilling, completion and eventual plugging of this well will comply with K.S.A. 55-101, et. seq.
It is agreed that the following minimum requirements will be met:

- 1. Notify the appropriate district office prior to spudding of well;
- 2. A copy of the approved notice of intent to drill shall be posted on each drilling rig;
- 3. The minimum amount of surface pipe as specified below shall be set by circulating cement to the top; in all cases surface pipe shall be set through all unconsolidated materials plus a minimum of 20 feet into the underlying formation;
- 4. If the well is dry hole, an agreement between the operator and the district office on plug length and placement is necessary prior to plugging;
- 5. The appropriate district office will be notified before well is either plugged or production casing is cemented in;
- 6. IF AN ALTERNATE IS COMPLETION, PRODUCTION PIPE SHALL BE CEMENTED FROM BELOW ANY USABLE WATER TO SURFACE WITHIN 120 DAYS OF SPUD DATE. IN ALL CASES, NOTIFY DISTRICT OFFICE PRIOR TO ANY CEMENTING.

I hereby certify that the statements made herein are true and to the best of my knowledge and belief.
Date: 1/20/92 Signature of Operator or Agent: Roy Vonfeldt Title: Agent

RECEIVED
KANSAS CORPORATION COMMISSION
JAN 27 1992

FOR KCC USE:
API # 15- 051-24780-00-00
Conductor pipe required None feet
Minimum surface pipe required 200 feet per Alt. #2
Approved by: MM/1-27-92
This authorization expires: 7-27-92
(This authorization void if drilling not started within 6 months of effective date.)
Spud date: _____ Agent: _____

RECEIVED
STATE CORPORATION COMMISSION
JAN 22 1992
01-22-92
CONSERVATION DIVISION
Wichita, Kansas

REMEMBER TO:

- File Drill Pit Application (form CDP-1) with Intent to Drill;
 - File Completion Form ACO-1 within 120 days of spud date;
 - File acreage attribution plat according to field prorations orders;
 - Notify appropriate district office 48 hours prior to workover or re-entry;
 - Submit plugging report (CP-4) after plugging is completed;
 - Obtain written approval before disposing or injecting salt water.
- Mail to: Conservation Division, 200 Colorado Berby Building, 202 W. First St., Wichita, Kansas 67202-1286.

13
14
16W

IN ALL CASES PLOT THE INTENDED WELL ON THE PLAT BELOW

PLAT OF ACREAGE ATTRIBUTABLE TO A WELL IN A PRORATED OR SPACED FIELD

If the intended well is in a prorated or spaced field, please fully complete this side of the form. If the intended well is in a prorated or spaced field complete the plat below showing that the well will be properly located in relationship to other wells producing from the common source of supply. Please show all the wells within 1 mile of the boundaries of the proposed acreage attribution unit for gas wells and within 1/2 mile of the boundaries of the proposed acreage attribution unit for oil wells.

API NO. 15- _____
 OPERATOR Vonfeldt Oil Operations, Inc. LOCATION OF WELL: COUNTY Ellis
 LEASE Hammerschmidt B 1020' feet from south/north line of section
 WELL NUMBER #1 1235' feet from east/west line of section
 FIELD - SECTION 13 TWP 14S RG 16W

NUMBER OF ACRES ATTRIBUTABLE TO WELL 10 IS SECTION X REGULAR or IRREGULAR
 QTR/QTR/QTR OF ACREAGE NE-NE- SW - SW **IF SECTION IS IRREGULAR, LOCATE WELL FROM NEAREST CORNER BOUNDARY.**

Section corner used: NE NW SE SW
PLAT

(Show location of the well and shade attributable acreage for prorated or spaced wells.)
 (Show footage to the nearest lease or unit boundary line.)

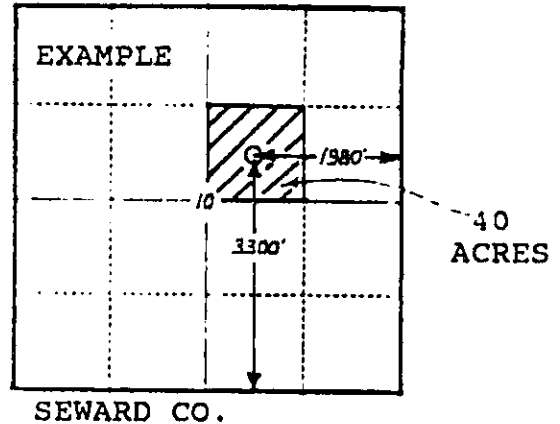
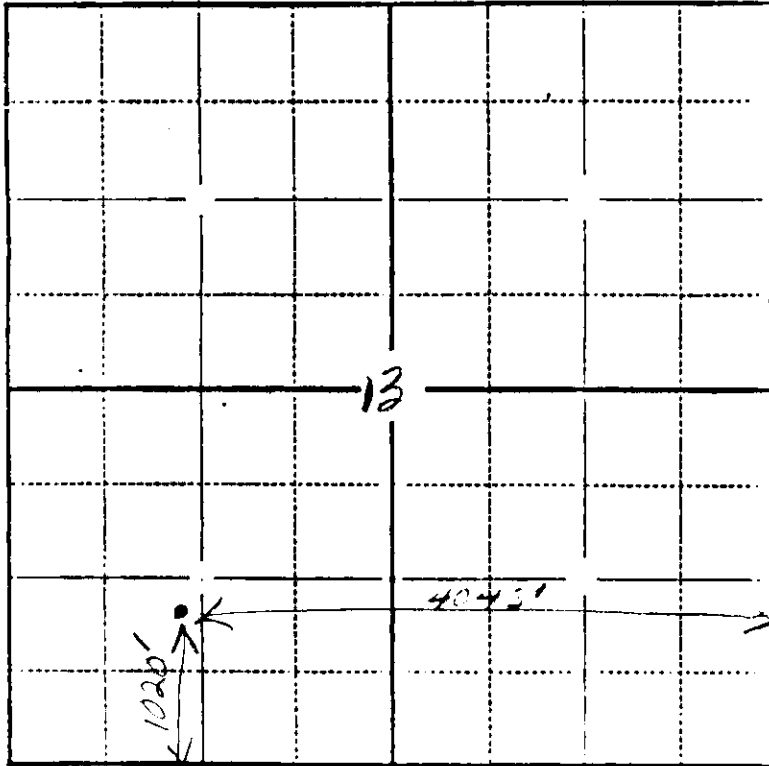

In plotting the proposed location of the well, you must show:

- 1) The manner in which you are using the depicted plat by identifying section lines, i.e. 1 section, 1 section with 8 surrounding sections, 4 sections, etc.;
- 2) the distance of the proposed drilling location from the section's south/north and east/west lines; and
- 3) the distance to the nearest lease or unit boundary line.