

EFFECTIVE DATE: 2-10-91

15-063-21376-00-00

FORM MUST BE TYPED  
FORM C-1 4/90

State of Kansas

FORM MUST BE SIGNED  
ALL BLANKS MUST BE FILLED

NOTICE OF INTENTION TO DRILL

Must be approved by the K.C.C. five (5) days prior to commencing well

Expected Spud Date 2 month 12 day 91 year

SE SE NE Sec 8 Twp 14 S, Rg 27 East  West

OPERATOR: License # 4767  
Name: Ritchie Exploration, Inc.  
Address: 125 N. Market, Suite 1000  
City/State/Zip: Wichita, KS 67202  
Contact Person: Rocky Miflord  
Phone: 316/267-4375

2970 feet from South line of Section  
330 feet from East line of Section  
(Note: Locate well on Section Plat on Reverse Side)

CONTRACTOR: License #: 5420  
Name: White & Ellis Drilling Co.

County: Gove  
Lease Name: D. Patterson Well #: 1  
Field Name: wildcat  
Is this a Prorated Field? ... yes  ... no  
Target Formation(s): L/KC, Marmaton, Miss.  
Nearest lease or unit boundary: 330'  
Ground Surface Elevation: 2541' est. feet MSL  
Domestic well within 330 feet: ... yes  ... no  
Municipal well within one mile: ... yes  ... no  
Depth to bottom of fresh water: 200' 100'  
Depth to bottom of usable water: 1100'  
Surface Pipe by Alternate: ... 1  ... 2  
Length of Surface Pipe Planned to be set: 240'  
Length of Conductor pipe required: none  
Projected Total Depth: 4400'  
Formation at Total Depth: Mississippian  
Water Source for Drilling Operations:  
... well ... farm pond  other

Well Drilled For: Well Class: Type Equipment:  
 Oil ... Inj ... Infield  Mud Rotary  
... Gas ... Storage ... Pool Ext. ... Air Rotary  
... OWMO ... Disposal  Wildcat ... Cable  
... Seismic; ... # of Holes

If OWMO: old well information as follows:  
Operator: \_\_\_\_\_  
Well Name: \_\_\_\_\_  
Comp. Date: \_\_\_\_\_ Old Total Depth \_\_\_\_\_

Directional, Deviated or Horizontal wellbore? ... yes  no  
If yes, total depth location: \_\_\_\_\_

AFFIDAVIT

The undersigned hereby affirms that the drilling, completion and eventual plugging of this well will comply with K.S.A. 55-101, et. seq.

- It is agreed that the following minimum requirements will be met:
1. The appropriate district office shall be notified before setting surface pipe;
  2. The minimum amount of surface pipe as specified above shall be set by circulating cement to the top; in all cases surface pipe shall be set through all unconsolidated materials plus a minimum of 20 feet into the underlying formation;
  3. If the well is dry, a plugging proposal shall be submitted to the district office. An agreement between the operator and the district office on plug length and placement is necessary prior to plugging;
  4. The appropriate district office will be notified before well is either plugged or production casing is cemented in;
  5. If an Alternate II completion, production pipe shall be cemented from below any usable water to surface within 120 days of spud date. In all cases, notify district office prior to any cementing.

I hereby certify that the statements made herein are true and to the best of my knowledge and belief.  
Date: 2/05/91 Signature of Operator or Agent: Kenneth J. Hanks Title: Geologist

FOR KCC USE:  
API # 15- 063-21376  
Conductor pipe required 1000 feet  
Minimum surface pipe required 200 feet per Alt. (2)  
Approved by: MW 2-5-91  
EFFECTIVE DATE: 2-10-91  
This authorization expires: 8-5-91  
(This authorization void if drilling not started within 6 months of effective date.)  
Spud date: \_\_\_\_\_ Agent: \_\_\_\_\_

W  
E  
I  
C  
H  
I  
T  
A

RECEIVED  
STATE CORPORATION COMMISSION  
FEB 5 1991  
02-05-91  
CONSERVATION DIVISION  
Wichita, Kansas

14  
07M

REMEMBER TO:

- File Drill Pit Application (form CDP-1) with Intent to Drill;
- File Completion Form ACO-1 within 120 days of spud date;
- File acreage attribution plat according to field proration orders;
- Notify appropriate district office 48 hours prior to workover or re-entry;
- Submit plugging report (CP-4) after plugging is completed;
- Obtain written approval before disposing or injecting salt water.

PLAT OF ACREAGE ATTRIBUTABLE TO A WELL

State Corporation Commission, Conservation Division  
 200 Colorado Derby Bldg. Wichita, Kansas 67202

OPERATOR Ritchie Exploration, Inc. LOCATION OF WELL:  
 LEASE D. Patterson 2970 feet north of SE corner  
 WELL NUMBER 1 330 feet west of SE corner  
 FIELD wildcat Sec. 8 T 14S R 27 E/W  
 COUNTY Gove  
 NO. OF ACRES ATTRIBUTABLE TO WELL 10 IS SECTION X REGULAR IRREGULAR?  
 DESCRIPTION OF ACREAGE \_\_\_\_\_ IF IRREGULAR, LOCATE WELL FROM NEAREST  
 CORNER BOUNDARY.

NOTE: If plat depicted is insufficient for your circumstances, you may attach your own scaled or surveyed plat.

PLAT

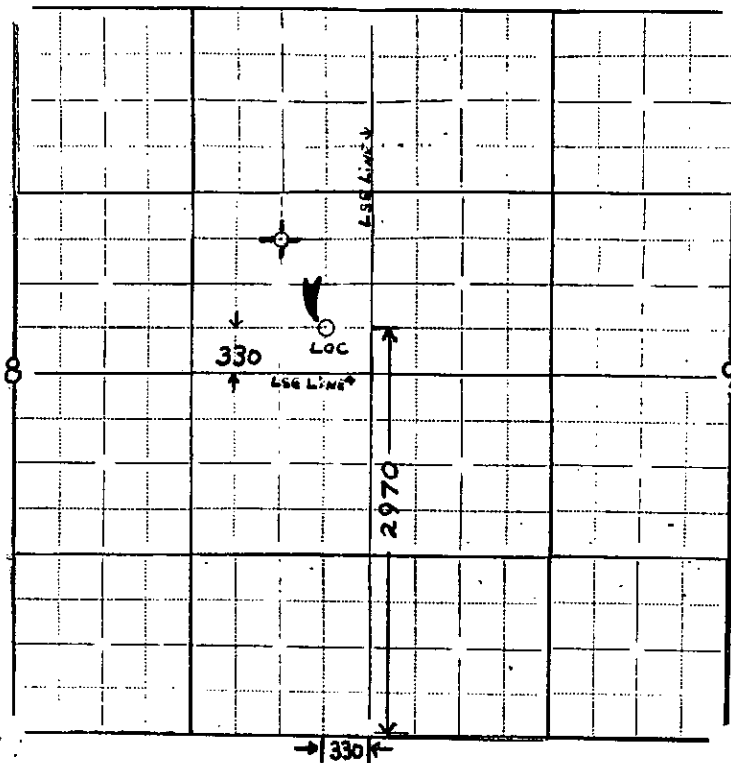

In plotting the proposed location of the well, you must show:

- 1) The manner in which you are using the depicted plat by identifying section lines, i.e. 1 section, 1 section with 8 surrounding partial sections, 4 sections, 16 sections, etc.;
- 2) the well's location relative to the location of other wells producing from the same common source of supply, in adjoining drilling units, pursuant to K.A.R. 82-3-108, 82-3-207, 82-3-312, or special orders of the Commission;
- 3) the distance of the proposed drilling location from the section's east and south lines; and
- 4) the distance to the nearest lease or unit boundary line.

I hereby certify that the statements made herein are true and to the best of my knowledge and belief.

Signature of Operator or Agent Kevin S. Kessler

Date 2/05/91 Title Geologist