

EFFECTIVE DATE: 9-4-91

NOTICE OF INTENTION TO DRILL

ALL BLANKS MUST BE FILLED

Must be approved by the K.C.C. five (5) days prior to commencing well

15-063-21405-00-00  
East

Expected Spud Date September 3 1991  
month day year

C. SE NW Sec 22 Twp 14 S, Rg 27 X West

OPERATOR: License # 30269  
Name: Argent Energy, Inc.  
Address: 110 South Main, Suite 510  
City/State/Zip: Wichita KS 67202-3745  
Contact Person: James C. Remsberg  
Phone: 316/262-5111

3300 feet from South line of Section  
3300 feet from East line of Section  
(Note: Locate well on Section Plat on Reverse Side)

CONTRACTOR: License #: 30606  
Name: Murfin Drilling

County: Gove  
Lease Name: Richardson Well #: 1  
Field Name: unnamed

Well Drilled For: Well Class: Type Equipment:  
 Oil ... Inj ... Infield  Mud Rotary  
 Gas ... Storage ... Pool Ext. ... Air Rotary  
 OAWO ... Disposal  Wildcat ... Cable  
 Seismic; ... # of Holes

Is this a Prorated Field? ... yes  no  
Target Formation(s): Mississippian  
Nearest lease or unit boundary: 660'  
Ground Surface Elevation: 2484 feet MSL  
Domestic well within 330 feet: ... yes  no  
Municipal well within one mile: ... yes  no  
Depth to bottom of fresh water: 200' 100'  
Depth to bottom of usable water: 1060'

If OAWO: old well information as follows:  
Operator: .....  
Well Name: .....  
Comp. Date: ..... Old Total Depth .....

Surface Pipe by Alternate: ... 1  2  
Length of Surface Pipe Planned to be set: 250  
Length of Conductor pipe required: none  
Projected Total Depth: 4400'  
Formation at Total Depth: Mississippian

Directional, Deviated or Horizontal wellbore? .... yes  no  
If yes, total depth location: .....

Water Source for Drilling Operations:  
... well .... farm pond  other  
DWR Permit #: .....  
Will Cores Be Taken?: ... yes  no  
If yes, proposed zone: .....

AFFIDAVIT

The undersigned hereby affirms that the drilling, completion and eventual plugging of this well will comply with K.S.A. 55-101, et. seq.

- It is agreed that the following minimum requirements will be met:
1. The appropriate district office shall be notified before setting surface pipe;
  2. The minimum amount of surface pipe as specified above shall be set by circulating cement to the top; in all cases surface pipe shall be set through all unconsolidated materials plus a minimum of 20 feet into the underlying formation;
  3. If the well is dry, a plugging proposal shall be submitted to the district office. An agreement between the operator and the district office on plug length and placement is necessary prior to plugging;
  4. The appropriate district office will be notified before well is either plugged or production casing is cemented in;
  5. If an Alternate II completion, production pipe shall be cemented from below any usable water to surface within 120 days of spud date. In all cases, notify district office prior to any cementing.

I hereby certify that the statements made herein are true and to the best of my knowledge and belief.

Date: August 30, 1991 Signature of Operator or Agent: James C. Remsberg President  
James C. Remsberg Title: .....

FOR KCC USE:  
API # 15- 063-21405  
Conductor pipe required None feet  
Minimum surface pipe required 300 feet per Alt. (2)  
Approved by: James C. Remsberg  
EFFECTIVE DATE: 9-4-91  
This authorization expires: 2-29-92  
(This authorization void if drilling not started within 6 months of effective date.)  
Spud date: \_\_\_\_\_ Agent: \_\_\_\_\_

RCWD  
08-30-91  
22  
14  
27

REMEMBER TO:

- File Drill Pit Application (form CDP-1) with Intent to Drill;
- File Completion Form ACO-1 within 120 days of spud date;
- File acreage attribution plat according to field prorations orders;
- Notify appropriate district office 48 hours prior to workover or re-entry;
- Submit plugging report (CP-4) after plugging is completed;
- Obtain written approval before disposing or injecting salt water.

PLAT OF ACREAGE ATTRIBUTABLE TO A WELL

State Corporation Commission, Conservation Division  
200 Colorado Derby Bldg. Wichita, Kansas 67202

STANDARD FORM NO. 300 (11-78)

OPERATOR Argent Energy, Inc. LOCATION OF WELL:  
 LEASE Richardson 3300 feet north of SE corner  
 WELL NUMBER 1 3300 feet west of SE corner  
 FIELD unnamed NW/4 Sec. 22 T 14S R 27 E/W  
 COUNTY Gove  
 NO. OF ACRES ATTRIBUTABLE TO WELL 40 IS SECTION X REGULAR IRREGULAR?  
 DESCRIPTION OF ACREAGE SE-NW IF IRREGULAR, LOCATE WELL FROM NEAREST  
 CORNER BOUNDARY.

NOTE: If plat depicted is insufficient for your circumstances, you may attach your own scaled or surveyed plat.

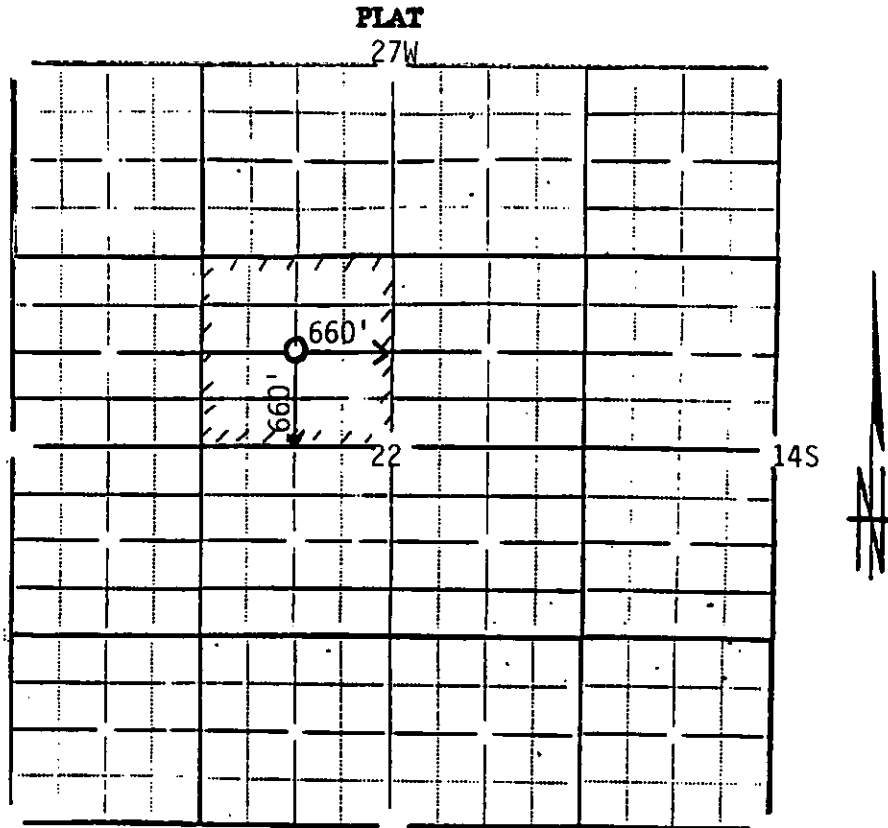

In plotting the proposed location of the well, you must show:

- 1) The manner in which you are using the depicted plat by identifying section lines, i.e. 1 section, 1 section with 8 surrounding partial sections, 4 sections, 16 sections, etc.;
- 2) the well's location relative to the location of other wells producing from the same common source of supply in adjoining drilling units, pursuant to K.A.R. 82-3-108, 82-3-207, 82-3-312, or special orders of the Commission;
- 3) the distance of the proposed drilling location from the section's east and south lines; and
- 4) the distance to the nearest lease or unit boundary line.

I hereby certify that the statements made herein are true and to the best of my knowledge and belief.

Signature of Operator or Agent James C. Remisberg  
 James C. Remisberg  
 Date August 30, 1991 Title President