

STATE OF KANSAS
STATE CORPORATION COMMISSION
CONSERVATION DIVISION
P. O. BOX 17027
WICHITA, KANSAS 67217

WELL PLUGGING RECORD

Scott County, Sec. 36 Twp. 16S Rge. ~~31~~ (W)

Location as "NE/CNWxSWx" or footage from lines NE SW

Lease Owner Abercrombie Drlg./Beren Corporation

Lease Name GRAVES Well No. #1

Office Address 801 Union Center, Wichita, Kansas

Character of Well (completed as Oil, Gas or Dry Hole) Dry Hole

Date well completed June 12 19 75

Application for plugging filed (verbally) June 12 19 75

Application for plugging approved (verbally) June 12 19 75

Plugging commenced June 12 19 75

Plugging completed June 12 19 75

Reason for abandonment of well or producing formation No commercial quantity of oil or gas encountered.

If a producing well is abandoned, date of last production 19

Was permission obtained from the Conservation Division or its agents before plugging was commenced? Yes

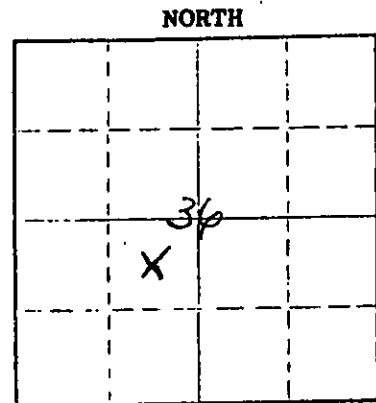

Locate well correctly on above Section Plat

Name of Conservation Agent who supervised plugging of this well Gilbert Balthazor

Producing formation Depth to top Bottom Total Depth of Well 4670'

Show depth and thickness of all water, oil and gas formations.

OIL, GAS OR WATER RECORDS

CASING RECORD

FORMATION	CONTENT	FROM	TO	SIZE	PUT IN	PULLED OUT
				8 5/8"	212'	None

Describe in detail the manner in which the well was plugged, indicating where the mud fluid was placed and the method or methods used in introducing it into the bore. If cement or other plugs were used, state the character of same and depth placed, from feet to feet for each plug set.

1st Plug Set @ 600' w/50 sx.
2nd Plug Set @ 240' w/35 sx.
3rd Plug Set @ 40' w/10 sx.
Plugged rat hole w/5 sx.

(If additional description is necessary, use BACK of this sheet)

Name of Plugging Contractor Abercrombie Drilling, Inc.

Address 801 Union Center, Wichita, Kansas 67202

STATE OF KANSAS COUNTY OF SEDGWICK ss.

Jerry A. Langrehr-Exec. V.P. (employee of owner) or (owner or operator) of the above-described well, being first duly sworn on oath, says: That I have knowledge of the facts, statements, and matters herein contained and the log of the above-described well as filed and that the same are true and correct. So help me God.

(Signature) Jerry A. Langrehr
801 Union Center, Wichita, Kansas 67202
(Address)

Subscribed and Sworn to before me this 17th day of June 19 75

My commission expires April 8, 1978

Nancy E. Haner
Notary Public.

RECEIVED
STATE CORPORATION COMMISSION

JUN 18 1975
6-18-75
CONSERVATION DIVISION
Wichita, Kansas

KANSAS DRILLERS LOG

API No. 15 — 171 — 20,076-6000
County Number

S. 36 T16S R. 31 ^K W

Loc. NE SW

County Scott

Operator

Abercrombie Drlg./Beren Corporation

Address

801 Union Center, Wichita, Kansas 67202

Well No.

#1

Lease Name

GRAVES

Footage Location

1980 feet from (N) (S) line

1980 feet from (E) (W) line

Principal Contractor

Abercrombie Drilling, Inc.

Geologist

Max Houston

Spud Date

June 3, 1975

Total Depth

4670'

P.B.T.D.

Date Completed

June 12, 1975

Oil Purchaser

None

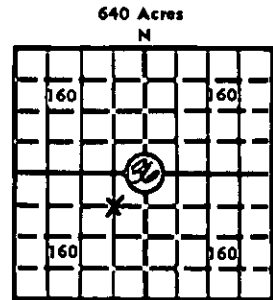

Locate well correctly

Elev.: Gr. 2902

DF 2905 KB 2907

CASING RECORD

Report of all strings set — surface, intermediate, production, etc.

Purpose of string	Size hole drilled	Size casing set (in O.D.)	Weight lbs/ft.	Setting depth	Type cement	Sacks	Type and percent additives
Surface	12-1/4"	8-5/8"		212'	Sunset	165	None

LINER RECORD

PERFORATION RECORD

Top, ft.	Bottom, ft.	Sacks cement	Shots per ft.	Size & type	Depth interval

TUBING RECORD

Size	Setting depth	Packer set at

ACID, FRACTURE, SHOT, CEMENT SQUEEZE RECORD

Amount and kind of material used

RECEIVED
 STATE CORPORATION COMMISSION
 Depth interval treated

JUN 18 1975

CONSERVATION DIVISION
 Wichita, Kansas

INITIAL PRODUCTION

Date of first production		Producing method (flowing, pumping, gas lift, etc.)			
RATE OF PRODUCTION PER 24 HOURS	Oil	Gas	Water	Gas-oil ratio	
	bbls.	MCF	bbls.	CFPB	
Disposition of gas (vented, used on lease or sold)			Producing interval(s)		

INSTRUCTIONS: As provided in KCC Rule 82-2-125, within 90 days after completion of a well, one completed copy of this Drillers Log shall be transmitted to the State Geological Survey of Kansas, 4150 Monroe Street, Wichita, Kansas 67209. Copies of this form are available from the Conservation Division, State Corporation Commission, 3830 So. Meridian (P.O. Box 17027), Wichita, Kansas 66217. Phone AC 316-522-2206. If confidential custody is desired, please note Rule 82-2-125. Drillers Logs will be on an open file in the Oil and Gas Division, State Geological Survey of Kansas, Lawrence, Kansas 66044.

Operator **Abercrombie Drilling/ Beren Corporation** DESIGNATE TYPE OF COMP.: OIL, GAS, DRY HOLE, SWDW, ETC.:

Well No. **#1** Lease Name **GRAVES** DRY HOLE

S 36 T 16 R 31 ^K/_W

WELL LOG

Show all important zones of porosity and contents thereof; cored intervals, and all drill-stem tests, including depth interval tested, cushion used, time tool open, flowing and shut-in pressures, and recoveries.

SHOW GEOLOGICAL MARKERS, LOGS RUN, OR OTHER DESCRIPTIVE INFORMATION.

FORMATION DESCRIPTION, CONTENTS, ETC.	TOP	BOTTOM	NAME	DEPTH
Surface Dirt & Sand	0	195	<u>ELECTRIC LOG TOPS.</u>	
Shale	195	600		
Shale & Sand	600	1400	Anhydrite	2316
Shale	1400	1764	B/Anhydrite	2340
Shale & Sand	1764	2383	Heebner	3943
Shale	2383	2885	Toronto	3961
Shale & Lime	2885	3390	Lansing	3980
Lime & Shale	3390	3885	B/Kansas City	4357
Lime	3885	4670	Marmaton	4377
Rotary Total Depth		4670	Fort Scott	4520
			Cherokee	4542
			Cherokee Sand	4618
			Mississippian	4631
			ELTD	4666
No Drill Stem Tests Run				
Plugged and Abandoned June 12, 1975.				

USE ADDITIONAL SHEETS, IF NECESSARY, TO COMPLETE WELL RECORD.

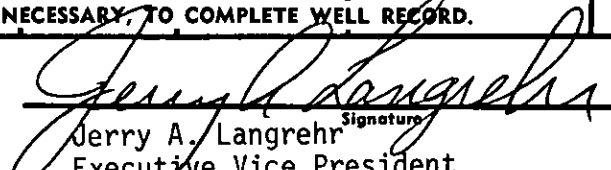
Date Received	 Jerry A. Langrehr <small>Signature</small> Executive Vice President June 17, 1975 <small>Title</small>
	Date