

WELL PLUGGING RECORD

Give All Information Completely
Make Required Affidavit
Mail or Deliver Report to:
Conservation Division
State Corporation Commission
211 No. Broadway
Wichita, Kansas

Stafford County. Sec. 18 Twp. 25 Rge. 14 (E) (W) X
Location as "NE/CNW&SW" or footage from lines C SW SW

Lease Owner Petroleum Inc.
Lease Name Wilson "W" Well No. #1
Office Address _____
Character of Well (completed as Oil, Gas or Dry Hole) _____
Date well completed _____ 19____
Application for plugging filed _____ 19____
Application for plugging approved _____ 19____
Plugging commenced 7-29-63 _____ 19____
Plugging completed 8-8-63 _____ 19____
Reason for abandonment of well or producing formation _____

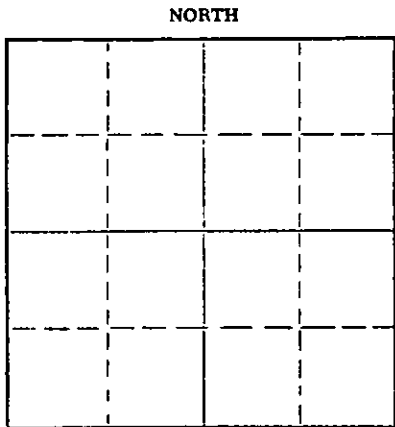

Locate well correctly on above
Section Plat

If a producing well is abandoned, date of last production _____ 19____
Was permission obtained from the Conservation Division or its agents before plugging was com-
menced? _____

Name of Conservation Agent who supervised plugging of this well Archie Elving
Producing formation _____ Depth to top _____ Bottom _____ Total Depth of Well 4480' Feet
Show depth and thickness of all water, oil and gas formations.

OIL, GAS OR WATER RECORDS

CASING RECORD

FORMATION	CONTENT	FROM	TO	SIZE	PUT IN	PULLED OUT

Describe in detail the manner in which the well was plugged, indicating where the mud fluid was placed and the method or methods used in introducing it into the hole. If cement or other plugs were used, state the character of same and depth placed, from _____ feet to _____ feet for each plug set.

Sanded back to 4190', mixed and dumped 5 sacks cement with dump bailer.
Squeeze well. Pumped in 10 sacks jel and 70 sacks cement.

STATE CORPORATION COMMISSION

AUG 12 1963
8-12-63

CONSERVATION DIVISION
WICHITA, KANSAS

(If additional description is necessary, use BACK of this sheet)

Name of Plugging Contractor Southwest Casing Pulling Co., Inc.
Address Box 364, Great Bend, Kansas

STATE OF Kansas, COUNTY OF Barton, ss.
Southwest Casing Pulling Co., Inc. (employee of owner) or (owner or operator) of the above-described well, being first duly sworn on oath, says: That I have knowledge of the facts, statements, and matters herein contained and the log of the above-described well as filed and that the same are true and correct. So help me God.

(Signature) W. C. Spencer
Box 364, Great Bend, Kansas
(Address)

SUBSCRIBED AND SWORN TO before me this 10 day of August, 1963

My commission expires 24 October - 1964
 Sidney D. Miller
Notary Public.

Give All Information Completely
Make Required Affidavit
Mail or Deliver Report to:
Conservation Division
State Corporation Commission
211 No. Broadway
Wichita, Kansas

WELL PLUGGING RECORD

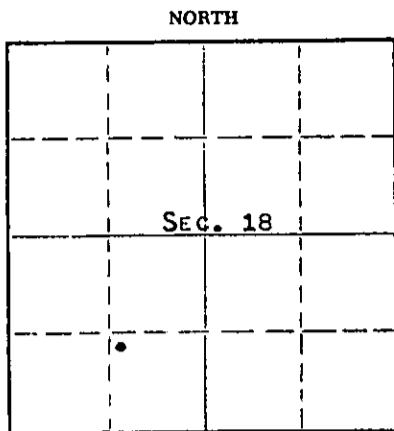

Locate well correctly on above Section Plat

STAFFORD County. Sec. 18 Twp. 25S Rge. 14W (X) (W)
APP. C SW SW
Location as "NE/CNW/SW" or footage from lines
Lease Owner PETROLEUM, INC.,
Lease Name WILSON "W" Well No. 1
Office Address ROUTE 2, GREAT BEND, KANSAS
Character of Well (completed as Oil, Gas or Dry Hole) OIL
Date well completed OCTOBER 14, 1961
Application for plugging filed JULY 29 1963
Application for plugging approved JULY 30 1963
Plugging commenced JULY 30 1963
Plugging completed AUGUST 8 1963
Reason for abandonment of well or producing formation DEPLETION OF PRODUCIBLE FORMATIONS
If a producing well is abandoned, date of last production MAY 23 1963
Was permission obtained from the Conservation Division or its agents before plugging was commenced? YES

Name of Conservation Agent who supervised plugging of this well ARCHIE ELVING
Producing formation MISSISSIPPI Depth to top 4201 Bottom — Total Depth of Well 4480 Feet
Show depth and thickness of all water, oil and gas formations.

OIL, GAS OR WATER RECORDS

CASING RECORD

FORMATION	CONTENT	FROM	TO	SIZE	PUT IN	PULLED OUT
MISSISSIPPI	WATER & SMALL AMOUNT OF OIL	4202	4214	8-5/8"	225	NONE
				5-1/2"	4315'	3294'

Describe in detail the manner in which the well was plugged, indicating where the mud fluid was placed and the method or methods used in introducing it into the hole. If cement or other plugs were used, state the character of same and depth placed, from _____ feet to _____ feet for each plug set.

PLUGGED BACK T.D. 4253'

FILLED HOLE WITH CRUSHED ROCK FROM 4253' TO 4190', PLACED 5 SACKS CEMENT ONTO CRUSHED ROCK TO 4130', GLOBE CEMENTING COMPANY SQUEEZED WITH 10 SACKS GEL AND 70 SACKS CEMENT.

RECEIVED
STATE CORPORATION COMMISSION

AUG 12 1963

CONSERVATION DIVISION
Wichita, Kansas

(If additional description is necessary, use BACK of this sheet)
Name of Plugging Contractor SOUTHWEST CASING PULLING COMPANY, INC.,
Address BOX 364, GREAT BEND, KANSAS

STATE OF KANSAS, COUNTY OF BARTON, ss.
DON SEARLE (employee of owner) or (~~NOTARY PUBLIC~~) of the above-described well, being first duly sworn on oath, says: That I have knowledge of the facts, statements, and matters herein contained and the log of the above-described well as filed and that the same are true and correct. So help me God. DON SEARLE, DIST. PROD. SUPT.
(Signature) *Don Searle*
ROUTE 2, GREAT BEND, KANSAS
(Address)

SUBSCRIBED AND SWORN TO before me this 13TH day of AUGUST, 19 63

Archie J. Wilcox
Notary Public.

My commission expires APRIL 14, 1967

15-185-01126-00-00
WELL LOG

COMPANY PETROLEUM, INCORPORATED

SEC. 18 T. 25S R. 14W

FARM WILSON "W" NO. 1

LOC. Approx. C-SW, SW

TOTAL DEPTH 4480'

COUNTY STAFFORD CO., KANSAS

COMM. September 9, 1961 COMP. September 24, 1961

CONTRACTOR GARVEY DRILLING COMPANY

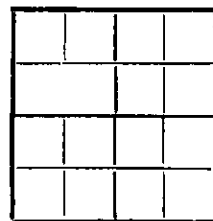

CASING 8-5/8" @ 255' w/250 sax.
5 1/2" @ 4315' w/150 sax.

ELEVATION 1992' DF

PRODUCTION Mississippi

FIGURES INDICATE BOTTOM OF FORMATIONS

55	Surface sand
215	Shale & sand
256	Shale
785	Red bed & shale
890	Lime & shale
1350	Shale
1540	Shale & lime
1830	Lime & shale
2015	Shale & lime
3595	Lime & shale
3690	Lime
3750	Lime & shale
3988	Lime
4018	Lime & shale
4086	Lime
4145	Lime & shale
4200	Lime
4222	Cherty lime
4290	Lime
4312	Cherty lime
4345	Lime
4400	Cherty lime
4480	Lime
4480	T. D.

RECEIVED
STATE CORPORATION COMMISSION
AUG 14 1963
CONSERVATION DIVISION
Wichita, Kansas

State of KANSAS }
County of BARTON } ss

I, VERNE A. MORRIS of GARVEY DRILLING COMPANY

upon oath state the above and foregoing is a true and correct copy of the log of the #1 WILSON well.

Subscribed and sworn to before me this 3rd day of October 1961

My Commission Expires: April 14, 1963

Verne A. Morris
Arthur J. Nile
NOTARY PUBLIC