

Owwo

For KCC Use: 10-19-2011
Effective Date: _____
District # 1
SGA? Yes No

KANSAS CORPORATION COMMISSION
OIL & GAS CONSERVATION DIVISION

Form C-1
March 2010

Form must be Typed
Form must be Signed
All blanks must be Filled

NOTICE OF INTENT TO DRILL

Must be approved by KCC five (5) days prior to commencing well
Form KSONA-1, Certification of Compliance with the Kansas Surface Owner Notification Act, MUST be submitted with this form.

Expected Spud Date: _____
month day year

OPERATOR: License# 4058
Name: American Warrior Inc.
Address 1: P.O. Box 399
Address 2: _____
City: Garden City State: Ks. Zip: 67846 + _____
Contact Person: Jody Smith
Phone: 620-275-2963

CONTRACTOR: License# 4058
Name: American Warrior Inc.

Well Drilled For: Oil Gas Enh Rec Storage Disposal Seismic: _____ # of Holes Other: _____
Well Class: Infield Pool Ext. Wildcat Other
Type Equipment: Mud Rotary Air Rotary Cable

If OWWO: old well information as follows:
Operator: Rains and Williams Oil Co.
Well Name: Mcqueen
Original Completion Date: 5/2/81 Original Total Depth: 4896'

Directional, Deviated or Horizontal wellbore? Yes No
If Yes, true vertical depth: _____
Bottom Hole Location: _____
KCC DKT #: _____

Spot Description: _____
C - SE - SW - Sec. 5 Twp. 24 S. R. 29 E W
660 feet from N / S Line of Section
3,300 feet from E / W Line of Section

Is SECTION: Regular Irregular?
(Note: Locate well on the Section Plat on reverse side)

County: Gray
Lease Name: Mcqueen Well #. 1
Field Name: Mcqueen
Is this a Prorated / Spaced Field? Yes No
Target Formation(s): Morrow

Nearest Lease or unit boundary line (in footage): 660
Ground Surface Elevation: 2795 feet MSL
Water well within one-quarter mile: Yes No
Public water supply well within one mile: Yes No

Depth to bottom of fresh water: 240-190
Depth to bottom of usable water: 1050-1100
Surface Pipe by Alternate: I II
Length of Surface Pipe Planned to be set: 520
Length of Conductor Pipe (if any): _____
Projected Total Depth: 4896'
Formation at Total Depth: Morrow

Water Source for Drilling Operations: Well Farm Pond Other: _____
DWR Permit #: _____

(Note: Apply for Permit with DWR)
Will Cores be taken? Yes No
If Yes, proposed zone: _____

AFFIDAVIT

The undersigned hereby affirms that the drilling, completion and eventual plugging of this well will comply with K.S.A. 55 et. seq.
It is agreed that the following minimum requirements will be met:

1. Notify the appropriate district office **prior** to spudding of well;
2. A copy of the approved notice of intent to drill **shall be** posted on each drilling rig;
3. The minimum amount of surface pipe as specified below **shall be set** by circulating cement to the top; in all cases surface pipe **shall be set** through all unconsolidated materials plus a minimum of 20 feet into the underlying formation.
4. If the well is dry hole, an agreement between the operator and the district office on plug length and placement is necessary **prior to plugging**;
5. The appropriate district office will be notified before well is either plugged or production casing is cemented in;
6. If an ALTERNATE II COMPLETION, production pipe shall be cemented from below any usable water to surface within **120 DAYS** of spud date.
Or pursuant to Appendix "B" - Eastern Kansas surface casing order #133,891-C, which applies to the KCC District 3 area, alternate II cementing must be completed within 30 days of the spud date or the well shall be plugged. **In all cases, NOTIFY district office** prior to any cementing.

I hereby certify that the statements made herein are true and to the best of my knowledge and belief.

Date: 10/4/11 Signature of Operator or Agent: [Signature] Title: Foreman

For KCC Use ONLY
API # 15 - 069-20021-00-02
Conductor pipe required None feet
Minimum surface pipe required 520 feet per ALT. I II
Approved by: [Signature] 10-14-2011
This authorization expires: 10-14-2012
(This authorization void if drilling not started within 12 months of approval date.)
Spud date: _____ Agent: _____

Remember to:
- File Certification of Compliance with the Kansas Surface Owner Notification Act (KSONA-1) with Intent to Drill;
- File Drill Pit Application (form CDP-1) with Intent to Drill;
- File Completion Form ACO-1 within 120 days of spud date;
- File acreage attribution plat according to field proration orders;
- Notify appropriate district office 48 hours prior to workover or re-entry;
- Submit plugging report (CP-4) after plugging is completed (within 60 days);
- Obtain written approval before disposing or injecting salt water.
- If well will not be drilled or permit has expired (See: authorized expiration date) please check the box below and return to the address below.
 Well will not be drilled or Permit Expired Date: _____
Signature of Operator or Agent: _____

Mail to: KCC - Conservation Division,
130 S. Market - Room 2078, Wichita, Kansas 67202

RECEIVED
OCT 06 2011
KCC WICHITA

5
24
29
 E W

For KCC Use ONLY

API # 15 - 069-20021-00-02

IN ALL CASES PLOT THE INTENDED WELL ON THE PLAT BELOW

In all cases, please fully complete this side of the form. Include items 1 through 5 at the bottom of this page.

Operator: American Warrior Inc.
 Lease: Mcqueen
 Well Number: 1
 Field: Mcqueen

Number of Acres attributable to well: _____
 QTR/QTR/QTR/QTR of acreage: C - SE - SW - _____

Location of Well: County: Gray
 _____ feet from N / S Line of Section
660
 _____ feet from E / W Line of Section
3,300
 Sec. 5 Twp. 24 S. R. 29 E W

Is Section: Regular or Irregular

If Section is Irregular, locate well from nearest corner boundary.

Section corner used: NE NW SE SW

PLAT

Show location of the well. Show footage to the nearest lease or unit boundary line. Show the predicted locations of lease roads, tank batteries, pipelines and electrical lines, as required by the Kansas Surface Owner Notice Act (House Bill 2032). You may attach a separate plat if desired.

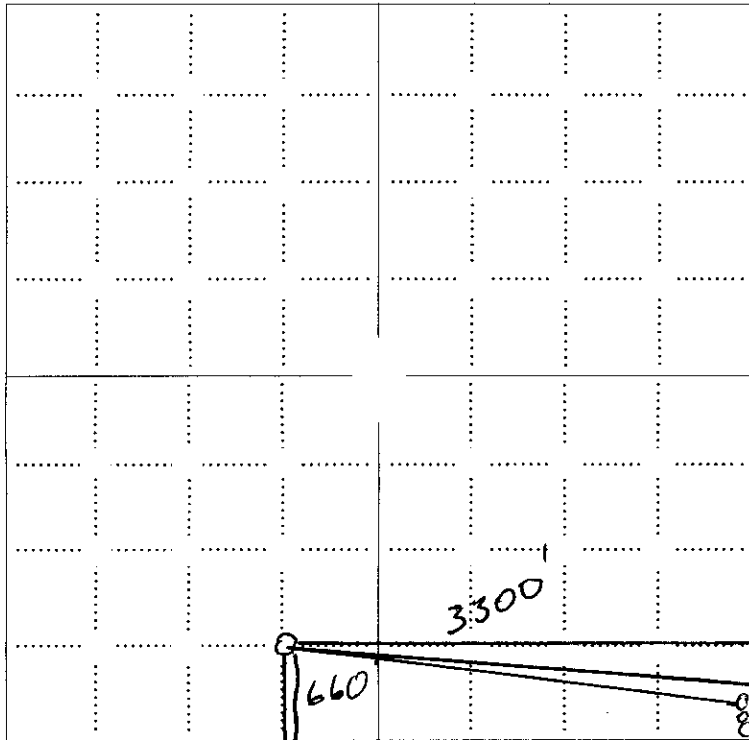

NOTE: In all cases locate the spot of the proposed drilling location.

In plotting the proposed location of the well, you must show:

1. The manner in which you are using the depicted plat by identifying section lines, i.e. 1 section, 1 section with 8 surrounding sections, 4 sections, etc.
2. The distance of the proposed drilling location from the south / north and east / west outside section lines.
3. The distance to the nearest lease or unit boundary line (in footage).
4. If proposed location is located within a prorated or spaced field a certificate of acreage attribution plat must be attached: (CO-7 for oil wells; CG-8 for gas wells).
5. The predicted locations of lease roads, tank batteries, pipelines, and electrical lines.

LEGEND

- Well Location
- Tank Battery Location
- Pipeline Location
- Electric Line Location
- Lease Road Location

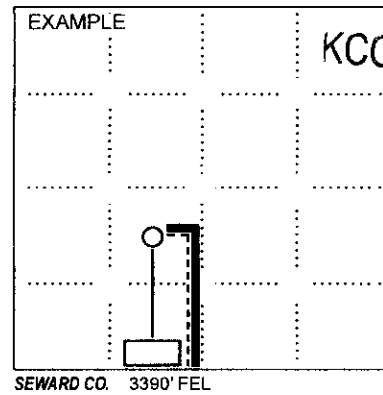

RECEIVED
 OCT 13 2011
 KCC WICHITA

RECEIVED
 OCT 06 2011
 KCC WICHITA

KANSAS CORPORATION COMMISSION
OIL & GAS CONSERVATION DIVISION

Form KSONA-1
July 2010
Form Must Be Typed
Form must be Signed
All blanks must be Filled

**CERTIFICATION OF COMPLIANCE WITH THE
KANSAS SURFACE OWNER NOTIFICATION ACT**

15-069-20021-0002

This form must be submitted with all Forms C-1 (Notice of Intent to Drill); CB-1 (Cathodic Protection Borehole Intent); T-1 (Request for Change of Operator Transfer of Injection or Surface Pit Permit); and CP-1 (Well Plugging Application). Any such form submitted without an accompanying Form KSONA-1 will be returned.

Select the corresponding form being filed: C-1 (Intent) CB-1 (Cathodic Protection Borehole Intent) T-1 (Transfer) CP-1 (Plugging Application)

OPERATOR: License # 4058
Name: American Warrior Inc.
Address 1: P.O. Box 399
Address 2:
City: Garden City State: Ks. Zip: 67846 +
Contact Person: Jody Smith
Phone: (620) 275-2963 Fax: (620) 275-5067
Email Address: jsmith@pmtank.com

Well Location:
C SE SW Sec. 5 Twp. 24 S. R. 29 East West
County: Gray
Lease Name: Mcqueen Well #: 1

If filing a Form T-1 for multiple wells on a lease, enter the legal description of the lease below:

RECEIVED
OCT 13 2011

Surface Owner Information:

Name: Cecil O'Brate
Address 1: P.O. Box 399
Address 2:
City: Garden City State: Ks. Zip: 67846 +

When filing a Form T-1 involving multiple surface owners, attach an additional sheet listing all of the information to the left for each surface owner. Surface owner information can be found in the records of the register of deeds for the county, and in the real estate property tax records of the county treasurer.

KCC WICHITA

If this form is being submitted with a Form C-1 (Intent) or CB-1 (Cathodic Protection Borehole Intent), you must supply the surface owners and the KCC with a plat showing the predicted locations of lease roads, tank batteries, pipelines, and electrical lines. The locations shown on the plat are preliminary non-binding estimates. The locations may be entered on the Form C-1 plat, Form CB-1 plat, or a separate plat may be submitted.

Select one of the following:

I certify that, pursuant to the Kansas Surface Owner Notice Act (House Bill 2032), I have provided the following to the surface owner(s) of the land upon which the subject well is or will be located: 1) a copy of the Form C-1, Form CB-1, Form T-1, or Form CP-1 that I am filing in connection with this form; 2) if the form being filed is a Form C-1 or Form CB-1, the plat(s) required by this form; and 3) my operator name, address, phone number, fax, and email address.

I have not provided this information to the surface owner(s). I acknowledge that, because I have not provided this information, the KCC will be required to send this information to the surface owner(s). To mitigate the additional cost of the KCC performing this task, I acknowledge that I am being charged a \$30.00 handling fee, payable to the KCC, which is enclosed with this form.

If choosing the second option, submit payment of the \$30.00 handling fee with this form. If the fee is not received with this form, the KSONA-1 form and the associated Form C-1, Form CB-1, Form T-1, or Form CP-1 will be returned.

I hereby certify that the statements made herein are true and correct to the best of my knowledge and belief.

Date: 10/4/11 Signature of Operator or Agent: [Signature] Title: Foreman

RECEIVED
OCT 06 2011

KCC WICHITA

KANSAS CORPORATION COMMISSION
OIL & GAS CONSERVATION DIVISION

Form CDP-1
May 2010
Form must be Typed

APPLICATION FOR SURFACE PIT

Submit in Duplicate

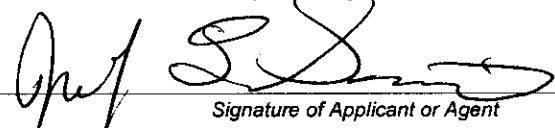
Operator Name: American Warrior Inc.		License Number: 4058
Operator Address: P.O. Box 399		Garden City Ks. 67846
Contact Person: Jody Smith		Phone Number: 620-275-2963
Lease Name & Well No.: Mcqueen 1		Pit Location (QQQQ): C SE SW
Type of Pit: <input type="checkbox"/> Emergency Pit <input type="checkbox"/> Burn Pit <input type="checkbox"/> Settling Pit <input type="checkbox"/> Drilling Pit <input type="checkbox"/> Workover Pit <input type="checkbox"/> Haul-Off Pit <small>(If WP Supply API No. or Year Drilled)</small>	Pit is: <input checked="" type="checkbox"/> Proposed <input type="checkbox"/> Existing If Existing, date constructed: _____ Pit capacity: 80 (bbls)	Sec. 5 Twp. 24 R. 29 <input type="checkbox"/> East <input checked="" type="checkbox"/> West 660 Feet from <input type="checkbox"/> North / <input checked="" type="checkbox"/> South Line of Section 3,300 Feet from <input checked="" type="checkbox"/> East / <input type="checkbox"/> West Line of Section Gray County
Is the pit located in a Sensitive Ground Water Area? <input type="checkbox"/> Yes <input checked="" type="checkbox"/> No		Chloride concentration: 23,000 mg/l <small>(For Emergency Pits and Settling Pits only)</small>
Is the bottom below ground level? <input checked="" type="checkbox"/> Yes <input type="checkbox"/> No	Artificial Liner? <input checked="" type="checkbox"/> Yes <input type="checkbox"/> No	How is the pit lined if a plastic liner is not used?
Pit dimensions (all but working pits): 20 Length (feet) 8 Width (feet) <input type="checkbox"/> N/A: Steel Pits Depth from ground level to deepest point: 6 (feet) <input type="checkbox"/> No Pit		
If the pit is lined give a brief description of the liner material, thickness and installation procedure. 7MM		Describe procedures for periodic maintenance and determining liner integrity, including any special monitoring. RECEIVED OCT 13 2011 KCC WICHITA
Distance to nearest water well within one-mile of pit: 660 feet Depth of water well 240 feet		Depth to shallowest fresh water 190 feet. Source of information: <input type="checkbox"/> measured <input checked="" type="checkbox"/> well owner <input type="checkbox"/> electric log <input type="checkbox"/> KDWR
Emergency, Settling and Burn Pits ONLY: Producing Formation: _____ Number of producing wells on lease: _____ Barrels of fluid produced daily: _____ Does the slope from the tank battery allow all spilled fluids to flow into the pit? <input type="checkbox"/> Yes <input type="checkbox"/> No		Drilling, Workover and Haul-Off Pits ONLY: Type of material utilized in drilling/workover: Drilling Mud Number of working pits to be utilized: 1 Abandonment procedure: Let dry and backfill Drill pits must be closed within 365 days of spud date.
I hereby certify that the above statements are true and correct to the best of my knowledge and belief. 10/4/11 Date  Signature of Applicant or Agent RECEIVED OCT 06 2011 KCC WICHITA		

KCC OFFICE USE ONLY

Liner Steel Pit RFAC RFAS

Date Received: **10-13-11** Permit Number: _____ Permit Date: **10-13-11** Lease Inspection: Yes No

Mail to: KCC - Conservation Division, 130 S. Market - Room 2078, Wichita, Kansas 67202

15-069-20021-0002

STATE OF KANSAS
STATE CORPORATION COMMISSION
200 Colorado Derby Building
Wichita, Kansas 67202

WELL PLUGGING RECORD
K.A.R.-82-3-117

API NUMBER 15-069-20,021 ⁰⁰⁰¹ ~~A~~

LEASE NAME McQUEEN

WELL NUMBER #1 (OWWO)

SPOT LOCATION SE SW

SEC. 5 TWP. 24 RGE. 29 (X) or (W)

COUNTY Gray

Date Well Completed 5-2-81

Plugging Commenced 10-30-85

Plugging Completed 10-30-85

TYPE OR PRINT
NOTICE: Fill out completely
and return to Cons. Div.
office within 30 days.

LEASE OPERATOR Rains & Williamson Oil Co., Inc.

ADDRESS 435 Page Court, 220 West Douglas, Wichita, KS 67202

PHONE # (316) 265-9686 OPERATORS LICENSE NO. 5146

Character of Well Oil
(Oil, Gas, D&A, SWD, Input, Water Supply Well)

Did you notify the KCC/KDHE Joint District Office prior to plugging this well? Yes

Which KCC/KDHE Joint Office did you notify? Dodge City

Is ACO-1 filed? Yes If not, is well log attached? _____

Producing formation Morrow Sand Depth to top 4740 bottom 4768 T.D. 4896

Show depth and thickness of all water, oil and gas formations.

OIL, GAS OR WATER RECORDS | CASING RECORD

Formation	Content	From	To	Size	Put In	Pulled out
	4764 - 4768			4 1/2"	4906'	None

Describe in detail the manner in which the well was plugged, indicating where the mud fluid was placed and the method or methods used in introducing it into the hole. If cement or other plugs were used state, the character of same and depth placed, from feet to feet each set.

Allied Cement Service, down 4 1/2" casing with 20 sx. 60-40 poz., 1 sx. hulls, 17 sx. gel, 160 sx. 60-40 poz. Shut in at 100# Pressure. Down 8 5/8" casing with 30 sx. 60-40 poz., Shut in at 250#. Plug down @ 12:45 p.m. 10-30-85. State Plugger Richard Lacey

(If additional description is necessary, use BACK of this form.)

Name of Plugging Contractor Paul Stephens License No. 682
Address P.O. Box 166, Pratt, Kansas 67124

STATE OF Kansas COUNTY OF Sedgwick, ss.

Wilson Rains, President of Rains & Williamson Oil Co. (employee of operator) or (operator) of above-described well, being first duly sworn on oath, says: That I have knowledge of the facts, statements, and matters herein contained and the log of the above-described well as filed that the same are true and correct, so help me God.

(Signature) Wilson Rains

(Address) 435 Page Court, 220 W. Douglas Wichita, Kansas 67202

SUBSCRIBED AND SWORN TO before me this 31 day of October, 19 85

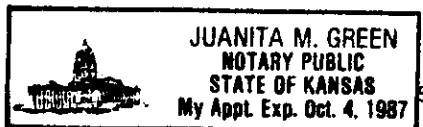

Juanita M. Green
Notary Public
Juanita M. Green

My Commission expires: 10-4-87