

For KCC Use: Effective Date: 10-19-2011  
District # \_\_\_\_\_  
SGA?  Yes  No

KANSAS CORPORATION COMMISSION  
OIL & GAS CONSERVATION DIVISION

Form C-1  
March 2010  
Form must be Typed  
Form must be Signed  
All blanks must be Filled

NOTICE OF INTENT TO DRILL

Must be approved by KCC five (5) days prior to commencing well  
Form KSONA-1, Certification of Compliance with the Kansas Surface Owner Notification Act, MUST be submitted with this form.

Expected Spud Date: October 19, 2011  
month day year

OPERATOR: License# 8653  
Name: Petroleum Technologies, Inc.  
Address 1: 801 W 47th Street  
Address 2: Suite 412  
City: Kansas City State: MO Zip: 64112 + 1253  
Contact Person: Alan J. Seaton  
Phone: 816-531-6904

CONTRACTOR: License# 8509  
Name: Evans Energy Development Inc.

Spot Description:  
NE - NE - SE - NE Sec. 32 Twp. 14 S. R. 22  E  W  
(Q/Q/Q/Q) 3,836 feet from  N /  S Line of Section  
170 feet from  E /  W Line of Section

Is SECTION:  Regular  Irregular?

(Note: Locate well on the Section Plat on reverse side)

County: Johnson  
Lease Name: REITZ Well #: 35

Field Name: Edgerton Northeast  
Is this a Prorated / Spaced Field?  Yes  No

Target Formation(s): Bartlesville Sand  
Nearest Lease or unit boundary line (in footage): 170'

Ground Surface Elevation: 984' feet MSL

Water well within one-quarter mile:  Yes  No

Public water supply well within one mile:  Yes  No

Depth to bottom of fresh water: 150'

Depth to bottom of usable water: 300'

Surface Pipe by Alternate:  I  II

Length of Surface Pipe Planned to be set: 20'

Length of Conductor Pipe (if any): N/A

Projected Total Depth: 900'

Formation at Total Depth: Cherokee

Water Source for Drilling Operations:  Well  Farm Pond  Other:

DWR Permit #: \_\_\_\_\_

(Note: Apply for Permit with DWR)

Will Cores be taken?  Yes  No

If Yes, proposed zone: \_\_\_\_\_

Well Drilled For:  Oil  Gas  Seismic  Other: \_\_\_\_\_  
Well Class:  Enh Rec  Storage  Disposal  # of Holes \_\_\_\_\_  
Well Class:  Infield  Pool Ext.  Wildcat  Other \_\_\_\_\_  
Type Equipment:  Mud Rotary  Air Rotary  Cable

If OWWO: old well information as follows:  
Operator: \_\_\_\_\_  
Well Name: \_\_\_\_\_  
Original Completion Date: \_\_\_\_\_ Original Total Depth: \_\_\_\_\_

Directional, Deviated or Horizontal wellbore?  Yes  No  
If Yes, true vertical depth: \_\_\_\_\_  
Bottom Hole Location: \_\_\_\_\_  
KCC DKT #: \_\_\_\_\_

AFFIDAVIT

The undersigned hereby affirms that the drilling, completion and eventual plugging of this well will comply with K.S.A. 55 et. seq.  
It is agreed that the following minimum requirements will be met:

1. Notify the appropriate district office **prior** to spudding of well;
2. A copy of the approved notice of intent to drill **shall be** posted on each drilling rig;
3. The minimum amount of surface pipe as specified below **shall be set** by circulating cement to the top; in all cases surface pipe **shall be set** through all unconsolidated materials plus a minimum of 20 feet into the underlying formation.
4. If the well is dry hole, an agreement between the operator and the district office on plug length and placement is necessary **prior to plugging**;
5. The appropriate district office will be notified before well is either plugged or production casing is cemented in;
6. If an ALTERNATE II COMPLETION, production pipe shall be cemented from below any usable water to surface within **120 DAYS** of spud date. Or pursuant to Appendix "B" - Eastern Kansas surface casing order #133,891-C, which applies to the KCC District 3 area, alternate II cementing must be completed within 30 days of the spud date or the well shall be plugged. **In all cases, NOTIFY district office** prior to any cementing.

I hereby certify that the statements made herein are true and to the best of my knowledge and belief.

Date: October 12, 2011 Signature of Operator or Agent: \_\_\_\_\_ Title: President

For KCC Use ONLY  
API # 15 - 091-23673-0000  
Conductor pipe required None feet  
Minimum surface pipe required 20 feet per ALT.  I  II  
Approved by: Perm 10-14-2011  
This authorization expires: 10-14-2012  
(This authorization void if drilling not started within 12 months of approval date.)  
Spud date: \_\_\_\_\_ Agent: \_\_\_\_\_

Remember to:

- File Certification of Compliance with the Kansas Surface Owner Notification Act (KSONA-1) with Intent to Drill;
- File Drill Pit Application (form CDP-1) with Intent to Drill;
- File Completion Form ACO-1 within 120 days of spud date;
- File acreage attribution plat according to field proration orders;
- Notify appropriate district office 48 hours prior to workover or re-entry;
- Submit plugging report (CP-4) after plugging is completed (within 60 days);
- Obtain written approval before disposing or injecting salt water.
- If well will not be drilled or permit has expired (See: authorized expiration date) please check the box below and return to the address below.

Well will not be drilled or Permit Expired Date: \_\_\_\_\_  
Signature of Operator or Agent: \_\_\_\_\_

Mail to: KCC - Conservation Division,  
130 S. Market - Room 2078, Wichita, Kansas 67202

RECEIVED  
OCT 13 2011  
KCC WICHITA

32  
14  
22  
 E  W

For KCC Use ONLY  
 API # 15 - 091-23673-0000

**IN ALL CASES PLOT THE INTENDED WELL ON THE PLAT BELOW**

In all cases, please fully complete this side of the form. Include items 1 through 5 at the bottom of this page.

Operator: Petroleum Technologies, Inc.  
 Lease: REITZ  
 Well Number: 35  
 Field: Edgerton Northeast  
 Number of Acres attributable to well: 2.6  
 QTR/QTR/QTR/QTR of acreage: NE - NE - SE - NE

Location of Well: County: Johnson  
3,836 feet from  N /  S Line of Section  
170 feet from  E /  W Line of Section  
 Sec. 32 Twp. 14 S. R. 22  E  W

Is Section:  Regular or  Irregular

If Section is Irregular, locate well from nearest corner boundary.

Section corner used:  NE  NW  SE  SW

**PLAT**

Show location of the well. Show footage to the nearest lease or unit boundary line. Show the predicted locations of lease roads, tank batteries, pipelines and electrical lines, as required by the Kansas Surface Owner Notice Act (House Bill 2032).

You may attach a separate plat if desired.

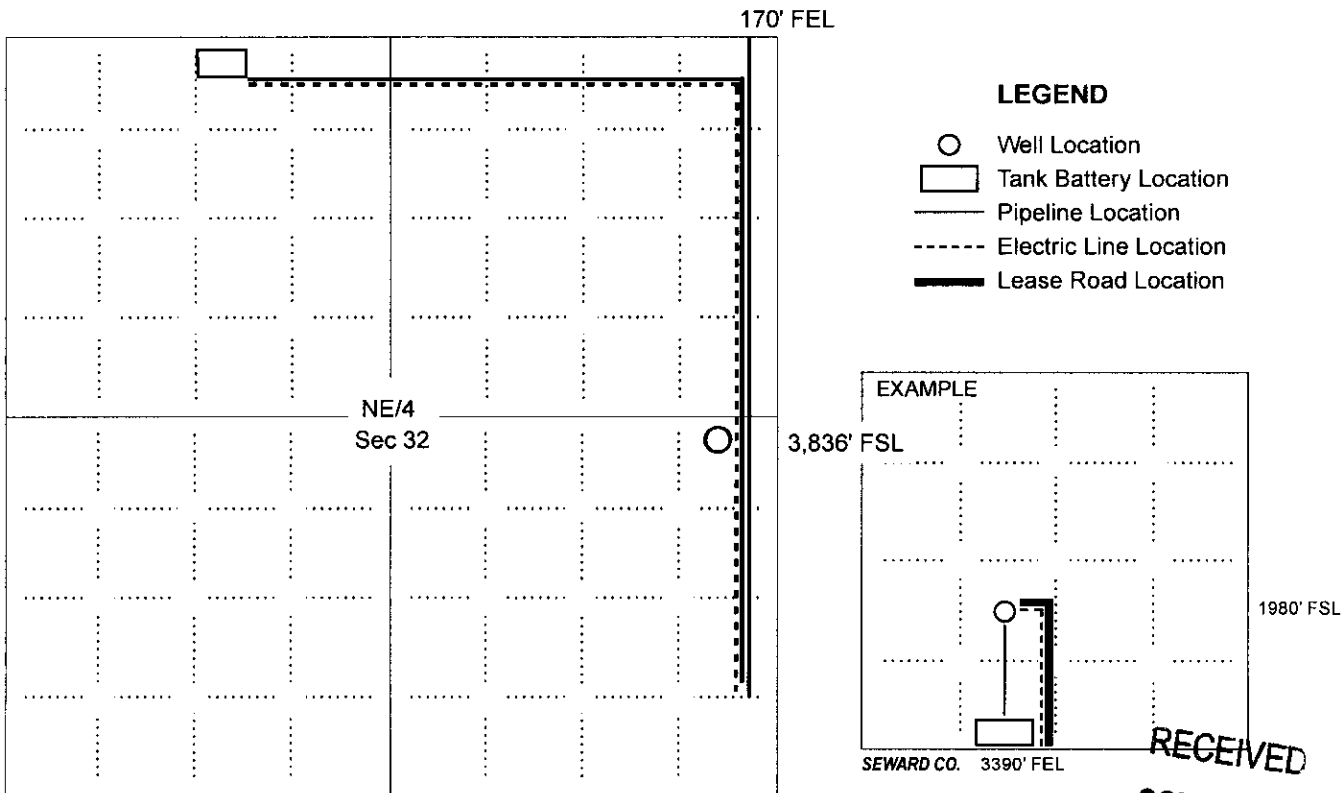

NOTE: In all cases locate the spot of the proposed drilling location.

In plotting the proposed location of the well, you must show:

1. The manner in which you are using the depicted plat by identifying section lines, i.e. 1 section, 1 section with 8 surrounding sections, 4 sections, etc.
2. The distance of the proposed drilling location from the south / north and east / west outside section lines.
3. The distance to the nearest lease or unit boundary line (in footage).
4. If proposed location is located within a prorated or spaced field a certificate of acreage attribution plat must be attached: (C0-7 for oil wells; CG-8 for gas wells).
5. The predicted locations of lease roads, tank batteries, pipelines, and electrical lines.

RECEIVED  
 OCT 13 2011  
 KCC WICHITA

KANSAS CORPORATION COMMISSION  
OIL & GAS CONSERVATION DIVISION

Form KSONA-1  
July 2010  
Form Must Be Typed  
Form must be Signed  
All blanks must be Filled

CERTIFICATION OF COMPLIANCE WITH THE  
KANSAS SURFACE OWNER NOTIFICATION ACT

15-09123673-0000

This form must be submitted with all Forms C-1 (Notice of Intent to Drill); CB-1 (Cathodic Protection Borehole Intent); T-1 (Request for Change of Operator Transfer of Injection or Surface Pit Permit); and CP-1 (Well Plugging Application). Any such form submitted without an accompanying Form KSONA-1 will be returned.

Select the corresponding form being filed:  C-1 (Intent)  CB-1 (Cathodic Protection Borehole Intent)  T-1 (Transfer)  CP-1 (Plugging Application)

OPERATOR: License # 8653  
Name: Petroleum Technologies, Inc.  
Address 1: 801 W 47th Street  
Address 2: Suite 412  
City: Kansas City State: MO Zip: 64112 + 1253  
Contact Person: Alan J. Seaton  
Phone: ( 816 ) 531-6904 Fax: ( 816 ) 531-6905  
Email Address: ajseaton@swbell.net

Well Location:  
NE NE SE NE Sec. 32 Twp. 14 S. R. 22  East  West  
County: Johnson  
Lease Name: REITZ Well #: 35

If filing a Form T-1 for multiple wells on a lease, enter the legal description of the lease below:

Surface Owner Information:

Name: Engelmann Farms LLC  
Address 1: 2000 W. 68th St.  
Address 2: \_\_\_\_\_  
City: Mission Hills State: KS Zip: 66021 + \_\_\_\_\_

When filing a Form T-1 involving multiple surface owners, attach an additional sheet listing all of the information to the left for each surface owner. Surface owner information can be found in the records of the register of deeds for the county, and in the real estate property tax records of the county treasurer.

If this form is being submitted with a Form C-1 (Intent) or CB-1 (Cathodic Protection Borehole Intent), you must supply the surface owners and the KCC with a plat showing the predicted locations of lease roads, tank batteries, pipelines, and electrical lines. The locations shown on the plat are preliminary non-binding estimates. The locations may be entered on the Form C-1 plat, Form CB-1 plat, or a separate plat may be submitted.

Select one of the following:

- I certify that, pursuant to the Kansas Surface Owner Notice Act (House Bill 2032), I have provided the following to the surface owner(s) of the land upon which the subject well is or will be located: 1) a copy of the Form C-1, Form CB-1, Form T-1, or Form CP-1 that I am filing in connection with this form; 2) if the form being filed is a Form C-1 or Form CB-1, the plat(s) required by this form; and 3) my operator name, address, phone number, fax, and email address.
- I have not provided this information to the surface owner(s). I acknowledge that, because I have not provided this information, the KCC will be required to send this information to the surface owner(s). To mitigate the additional cost of the KCC performing this task, I acknowledge that I am being charged a \$30.00 handling fee, payable to the KCC, which is enclosed with this form.

If choosing the second option, submit payment of the \$30.00 handling fee with this form. If the fee is not received with this form, the KSONA-1 form and the associated Form C-1, Form CB-1, Form T-1, or Form CP-1 will be returned.

I hereby certify that the statements made herein are true and correct to the best of my knowledge and belief.

Date: October 12, 2011 Signature of Operator or Agent: \_\_\_\_\_ Title: President

RECEIVED

OCT 13 2011

KCC WICHITA



# PETROLEUM TECHNOLOGIES, INC.

15-091-23673-0000

October 12, 2011

Kansas Corporation Commission  
Conservation Division  
130 S. Market, Room 2078  
Wichita, Kansas 67202

To whom it may concern:

Enclosed please find 6 - C-1's Notice of Intent to Drill Forms, along with all attachments. Also enclosed are copies of the two closest water well records. The water well record for the NE quarter of section 32 does not exist in this quarter section, according to the farmer no well and no house existed on this property. We used the other water well record enclosed as closest water well within one mile.

Sincerely,  
Petroleum Technologies, Inc.

Alan J. Seaton  
President

Enclosures

RECEIVED  
OCT 13 2011  
KCC WICHITA

Doesn't Exist

USE TYPEWRITER OR BALL POINT PEN-PRESS FIRMLY, PRINT CLEARLY.

WATER WELL RECORD  
KSA 82a-1201-1215

Kansas Department of Health and Environment-Division of Environment  
(Water Well Contractors)  
Topeka, Kansas-66620

1. Location of well:		County Johnson	Fraction SE 1/4 NE 1/4 1/4	Section number 32	Township number T 14 S	Range number R 22 E/W
2. Distance and direction from nearest town or city: IN, 1/2 E. 3/4 N OF EASTSIDE OF EDGERTON, KS.				3. Owner of well: HS. ALTMAN R.R. or street: City, state, zip code: EDGERTON, KS 66021		
4. Locate with "X" in section below:		Sketch map:		6. Bore hole dia. 6 1/2 in. Completion date 5/30/76 Well depth 217 ft. 7. <input checked="" type="checkbox"/> Cable tool <input type="checkbox"/> Rotary <input type="checkbox"/> Driven <input type="checkbox"/> Dug <input type="checkbox"/> Hollow rod <input type="checkbox"/> Jetted <input type="checkbox"/> Bored <input type="checkbox"/> Reverse rotary 8. Use: <input checked="" type="checkbox"/> Domestic <input type="checkbox"/> Public supply <input type="checkbox"/> Industry <input type="checkbox"/> Irrigation <input type="checkbox"/> Air conditioning <input type="checkbox"/> Stock <input type="checkbox"/> Lawn <input type="checkbox"/> Oil field water <input type="checkbox"/> Other 9. Casing: Material PLTS Height: Above or below Threaded <input type="checkbox"/> Welded <input type="checkbox"/> Surface <input type="checkbox"/> In. RMP <input type="checkbox"/> PVC <input checked="" type="checkbox"/> Weight <input type="checkbox"/> lbs./ft. Dia. 5 in. to 2 1/2 ft. depth Well Thickness: inches or Dia. <input type="checkbox"/> in. to <input type="checkbox"/> ft. depth page No.		
		N W E S 1 Mile 1 Mile				
5. Type and color of material				From	To	
Soil & Joint Clay				14	0	14
Blue Lime				3	14	17
Hard Sandy Gray Shale				6	17	23
White Lime				22	23	45
Black Sslae				5	45	50
Blue Lime- possible water				8	50	58
Hard Gray Shale				5	58	63
Blue Lime				24	63	87
Gray Shale				1	87	88
Red Shale				5	88	93
Gray Sand				14	93	107
Blue Lime				7	107	115
White Lime				12	115	127
Gray Shale				15	127	142
Blue Lime				16	142	158
Gray Shale (Use a second sheet if needed)				12	158	170
18. Elevation:		19. Remarks:				
Topography: <input type="checkbox"/> Hill <input checked="" type="checkbox"/> Slope <input type="checkbox"/> Upland <input type="checkbox"/> Valley		10. Screens: Manufacturer's name JESS + Type LOWELL Dia. 5 Slot/gauze 1/4 Hole length 20' Set between 190 50 ft. and 70 ft. 190 210 ft. and 210 ft. Gravel pack? <input checked="" type="checkbox"/> Size range of material 11. Static water level: 50 ft. below land surface Date 5/25/76 12. Pumping level below land surfaces: _____ ft. after _____ hrs. pumping _____ g.p.m. _____ ft. after _____ hrs. pumping _____ g.p.m. Estimated maximum yield 170 g.p.m. 13. Water sample submitted: _____ mo./day/yr. Yes <input checked="" type="checkbox"/> No <input type="checkbox"/> Date 14. Well head completion: <input checked="" type="checkbox"/> Pitless adapter _____ inches above grade 15. Well grouted? <input checked="" type="checkbox"/> YES With: _____ Neat cement <input checked="" type="checkbox"/> Bentonite _____ Concrete Depth: From _____ ft. to _____ ft. 16. Nearest source of possible contamination: ft. 100' Direction SW Type SEPTIC TANK Well disinfected upon completion? <input checked="" type="checkbox"/> Yes <input type="checkbox"/> No 17. Pump: Not installed Manufacturer's name Red Jacket Model number _____ HP 3/4 Volts 230 Length of drop pipe 212 ft. capacity 5 g.p.m. Type: <input checked="" type="checkbox"/> Submersible _____ Turbine <input type="checkbox"/> Jet _____ Reciprocating <input type="checkbox"/> Centrifugal _____ Other				
20. Water well contractor's certification: This well was drilled under my jurisdiction and this report is true to the best of my knowledge and belief. NO SWANK WATER WELL DRILL! 107 Business name PR I PRINCETON KS License No. Address _____ Date 5/31/76 Signed George H. Swank _____ Authorized representative						

Forward the white, blue and pink copies to the Department of Health and Environment

RECEIVED

Form WWC-5

OCT 13 2011

MI-1023

KCC WICHITA

USE TYPEWRITER OR BALL POINT PEN—PRESS FIRMLY, PRINT CLEARLY.

WATER WELL RECORD  
KSA 82a-1201-1215

Kansas Department of Health and Environment—Division of Environment  
(Water well Contractors)  
Topeka, Kansas 66620

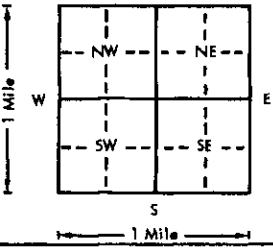
1. Location of well:	County	Fraction 1/4 1/4 1/4	Section number	Township number T	Range number S R	E/W
2. Distance and direction from nearest town or city: Street address of well location if in city:			3. Owner of well: <u>H.S. Altman</u> R.R. or street: City, state, zip code: <u>Edgerton, Kansas 66021</u>			
4. Locate with "X" in section below: 			Sketch map:  <b>PAGE 2</b>			6. Bore hole dia. <u>6 1/4</u> in. Completion date <u>5/30/76</u> Well depth <u>217</u> ft.
5. Type and color of material			From	To	7. <input checked="" type="checkbox"/> Cable tool <input type="checkbox"/> Rotary <input type="checkbox"/> Driven <input type="checkbox"/> Dug <input type="checkbox"/> Hollow rod <input type="checkbox"/> Jetted <input type="checkbox"/> Bored <input type="checkbox"/> Reverse rotary	
White Lime			6	170	176	8. Use: <input checked="" type="checkbox"/> Domestic <input type="checkbox"/> Public supply <input type="checkbox"/> Industry <input type="checkbox"/> Irrigation <input type="checkbox"/> Air conditioning <input type="checkbox"/> Stock <input type="checkbox"/> Lawn <input type="checkbox"/> Oil field water <input type="checkbox"/> Other
Blue Lime			9	176	185	9. Casing: Material _____ Height: Above or below Threaded _____ Welded <input checked="" type="checkbox"/> Surface _____ in. RMP _____ PVC _____ Weight _____ lbs./ft. Dia. <u>2</u> in. to <u>2 1/2</u> ft. depth   Wall Thickness: inches or Dia. _____ in. to _____ ft. depth   gage No. _____
White Lime			8	185	193	10. Screen: Manufacturer's name _____ Type _____ Dia. _____ Slot/gauze _____ Length _____ Set between _____ ft. and _____ ft. _____ ft. and _____ ft. Gravel pack? _____ Size range of material _____
Gray Shale			8	193	205	11. Static water level: _____ mo./day/yr. _____ ft. below land surface Date _____
White Lime			12	205	217	12. Pumping level below land surfaces: _____ ft. after _____ hrs. pumping _____ g.p.m. _____ ft. after _____ hrs. pumping _____ g.p.m. Estimated maximum yield _____ g.p.m.
Gray Shale				217		13. Water sample submitted: _____ mo./day/yr. Yes _____ No _____ Date _____
						14. Well head completion: <input checked="" type="checkbox"/> Pitless adapter _____ inches above grade
						15. Well grouted? With: _____ Neat cement <input checked="" type="checkbox"/> Bentonite _____ Concrete _____ Depth: From _____ ft. to _____ ft.
						16. Nearest source of possible contamination: ft. _____ Direction _____ Type _____ Well disinfected upon completion? <input checked="" type="checkbox"/> Yes _____ No
						17. Pump: _____ Not installed Manufacturer's name <u>Red Jacket</u> Model number _____ HP _____ Volts _____ Length of drop pipe _____ ft. capacity _____ g.p.m. Type: <input type="checkbox"/> Submersible _____ Turbine _____ <input type="checkbox"/> Jet _____ Reciprocating _____ <input type="checkbox"/> Centrifugal _____ Other _____
(Use a second sheet if needed)						20. Water well contractor's certification: This well was drilled under my jurisdiction and this report is true to the best of my knowledge and belief. Business name _____ License No. <u>107</u> Address _____ Signed <u>George H. Swank</u> Date <u>5/31/76</u> Authorized representative
18. Elevation:  Topography: <input type="checkbox"/> Hill <input type="checkbox"/> Slope <input type="checkbox"/> Upland <input type="checkbox"/> Valley	19. Remarks:					

Forward the white, blue and pink copies to the Department of Health and Environment

Form WWC-5

RECEIVED  
OCT 13 2011  
KCC WICHITA

USE TYPEWRITER OR BALL POINT PEN-PRESS FIRMLY, PRINT CLEARLY.

Point Ch

WATER WELL RECORD  
KSA 82a-1201-1215

Kansas Department of Health and Environment-Division of Environment  
(Water well Contractors)  
Topeka, Kansas 66620

1. Location of well:		County <b>Johnson</b>	Section <b>1</b>	Section number <b>33</b>	Township number <b>T 14</b>	Range number <b>(S) R 22 E</b>	E/W																																									
2. Distance and direction from nearest town or city: <b>2 1/2 mi. SW Gardner, Ks</b>			3. Owner of well: <b>Royl K. Wilson</b>																																													
Street address of well location if in city:			R.R. or street: <b>12920 W. 96th</b>																																													
			City, state, zip code: <b>Lenexa, Ks, 66215</b>																																													
5. Type and color of material <table border="1"> <thead> <tr> <th>Material</th> <th>From</th> <th>To</th> </tr> </thead> <tbody> <tr><td>surface</td><td>0</td><td>4</td></tr> <tr><td>lime</td><td>4</td><td>12</td></tr> <tr><td>shale (dark)</td><td>12</td><td>18</td></tr> <tr><td>lime</td><td>18</td><td>29</td></tr> <tr><td>shale (med. grey)</td><td>29</td><td>36</td></tr> <tr><td>lime (med. grey)</td><td>36</td><td>57</td></tr> <tr><td>shale (greenish grey)</td><td>57</td><td>74</td></tr> <tr><td>lime</td><td>74</td><td>105</td></tr> <tr><td>shale (med. grey)</td><td>105</td><td>130</td></tr> <tr><td>lime (lt. grey)</td><td>130</td><td>134</td></tr> <tr><td>shale (dk. gummy)</td><td>134</td><td>138</td></tr> <tr><td>lime</td><td>138</td><td>145</td></tr> <tr><td>lime</td><td>145</td><td>149</td></tr> </tbody> </table>		Material	From	To	surface	0	4	lime	4	12	shale (dark)	12	18	lime	18	29	shale (med. grey)	29	36	lime (med. grey)	36	57	shale (greenish grey)	57	74	lime	74	105	shale (med. grey)	105	130	lime (lt. grey)	130	134	shale (dk. gummy)	134	138	lime	138	145	lime	145	149	Sketch map: 		6. Bore hole dia. <b>8 1/2</b> in. Completion date _____ Well depth <b>149</b> ft. <b>8-5-76</b>		
Material	From	To																																														
surface	0	4																																														
lime	4	12																																														
shale (dark)	12	18																																														
lime	18	29																																														
shale (med. grey)	29	36																																														
lime (med. grey)	36	57																																														
shale (greenish grey)	57	74																																														
lime	74	105																																														
shale (med. grey)	105	130																																														
lime (lt. grey)	130	134																																														
shale (dk. gummy)	134	138																																														
lime	138	145																																														
lime	145	149																																														
7. <input checked="" type="checkbox"/> Cable tool <input type="checkbox"/> Rotary <input type="checkbox"/> Driven <input type="checkbox"/> Dug <input type="checkbox"/> Hollow rod <input type="checkbox"/> Jettied <input type="checkbox"/> Bored <input type="checkbox"/> Reverse rotary		8. Use: <input checked="" type="checkbox"/> Domestic <input type="checkbox"/> Public supply <input type="checkbox"/> Industry <input type="checkbox"/> Irrigation <input type="checkbox"/> Air conditioning <input type="checkbox"/> Stock <input type="checkbox"/> Lawn <input type="checkbox"/> Oil field water <input type="checkbox"/> Other																																														
9. Casing: Material <b>Plastic</b> Height: Above or below Threaded _____ Welded <input checked="" type="checkbox"/> Surface <b>12</b> in. RMP _____ PVC <input checked="" type="checkbox"/> Weight <b>2.980</b> lbs./ft. Dia. <b>6</b> in. to <b>149</b> ft. depth; Wall Thickness: inches or Dia. _____ in. to _____ ft. depth; Gauge No. <b>1/4</b>		10. Screens: Manufacturer's name _____ <input checked="" type="checkbox"/> Robin Tech Type <b>Plastic</b> Dia. <input checked="" type="checkbox"/> <b>6"</b> Slot/gauze <b>drill/slot</b> Dia. <input checked="" type="checkbox"/> <b>1/19"</b> Set between <b>30</b> ft. and <b>149</b> ft. _____ ft. and _____ ft. Gravel pack? <b>yes</b> size range of material <b>1/8-1/4</b>																																														
11. Static water level: _____ mo./day/yr. <b>40</b> ft. below land surface Date <b>8-5-76</b>		12. Pumping level below land surfaces: _____ ft. after _____ hrs. pumping _____ g.p.m. _____ ft. after _____ hrs. pumping _____ g.p.m. Estimated maximum yield <b>1 GPM</b> g.p.m.																																														
13. Water sample submitted: _____ mo./day/yr. Yes <input checked="" type="checkbox"/> No <input type="checkbox"/> Date _____		14. Well head completion: <input checked="" type="checkbox"/> Pitless adapter _____ inches above grade																																														
15. Well grouted? <b>yes</b> With: <input checked="" type="checkbox"/> Neat cement <input type="checkbox"/> Bentonite <input type="checkbox"/> Concrete Depth: From <b>5</b> ft. to <b>25</b> ft.		16. Nearest source of possible contamination: ft. <b>100</b> Direction <b>SE</b> Type <b>septic</b> Well disinfected upon completion? <input checked="" type="checkbox"/> Yes <input type="checkbox"/> No																																														
17. Pump: <input checked="" type="checkbox"/> Not installed Manufacturer's name _____ Model number _____ HP _____ Volts _____ Length of drop pipe _____ ft. capacity _____ g.p.m. Type: <input type="checkbox"/> Submersible <input type="checkbox"/> Turbine <input type="checkbox"/> Jet <input type="checkbox"/> Reciprocating <input type="checkbox"/> Centrifugal <input type="checkbox"/> Other		18. Elevation: <b>980</b> Topography: <input type="checkbox"/> Hill <input checked="" type="checkbox"/> Slope <input type="checkbox"/> Upland <input type="checkbox"/> Valley																																														
19. Remarks: <b>Customer is aware of State regulation and is aware of concrete platform around top of well.</b> <input checked="" type="checkbox"/> <b>RK Wilson</b>		20. Water well contractor's certification: This well was drilled under my jurisdiction and this report is true to the best of my knowledge and belief. <b>F.E. Young Drilling 240</b> Business name License No. _____ Address <b>6355 Robinhood Ln.</b> Signed <b>F.E. Young</b> Date <b>10-3-76</b> Authorized representative																																														

Forward the white, blue and pink copies to the Department of Health and Environment

Form WWC-3

RECEIVED

OCT 13 2011

KCC WICHITA

M1-1023

17  
22  
33  
SUS  
1/4 1/4 1/4

KANSAS CORPORATION COMMISSION  
OIL & GAS CONSERVATION DIVISION

Form CDP-1  
May 2010  
Form must be Typed

APPLICATION FOR SURFACE PIT

Submit in Duplicate

Operator Name: <b>Petroleum Technologies, Inc.</b>		License Number: <b>8653</b>
Operator Address: <b>801 W 47th Street</b>		<b>Suite 412 Kansas City MO 64112</b>
Contact Person: <b>Alan J. Seaton</b>		Phone Number: <b>816-531-6904</b>
Lease Name & Well No.: <b>REITZ 35</b>		Pit Location (QQQQ): <b>NE - NE - SE - NE</b>
Type of Pit: <input type="checkbox"/> Emergency Pit <input type="checkbox"/> Burn Pit <input type="checkbox"/> Settling Pit <input checked="" type="checkbox"/> Drilling Pit <input type="checkbox"/> Workover Pit <input type="checkbox"/> Haul-Off Pit <i>(If WP Supply API No. or Year Drilled)</i>	Pit is: <input checked="" type="checkbox"/> Proposed <input type="checkbox"/> Existing If Existing, date constructed: _____ Pit capacity: <b>77</b> (bbls)	Sec. <b>32</b> Twp. <b>14</b> R. <b>22</b> <input checked="" type="checkbox"/> East <input type="checkbox"/> West <b>3,836</b> Feet from <input type="checkbox"/> North / <input checked="" type="checkbox"/> South Line of Section <b>170</b> Feet from <input checked="" type="checkbox"/> East / <input type="checkbox"/> West Line of Section <b>Johnson</b> County
Is the pit located in a Sensitive Ground Water Area? <input type="checkbox"/> Yes <input checked="" type="checkbox"/> No		Chloride concentration: _____ mg/l <i>(For Emergency Pits and Settling Pits only)</i>
Is the bottom below ground level? <input checked="" type="checkbox"/> Yes <input type="checkbox"/> No	Artificial Liner? <input type="checkbox"/> Yes <input checked="" type="checkbox"/> No	How is the pit lined if a plastic liner is not used? <b>Native Clay</b>
Pit dimensions (all but working pits): <b>12</b> Length (feet) <b>6</b> Width (feet) <input type="checkbox"/> N/A: Steel Pits Depth from ground level to deepest point: <b>6</b> (feet) <input type="checkbox"/> No Pit		
If the pit is lined give a brief description of the liner material, thickness and installation procedure.		Describe procedures for periodic maintenance and determining liner integrity, including any special monitoring.
Distance to nearest water well within one-mile of pit: <b>3950</b> feet    Depth of water well <b>149</b> feet		Depth to shallowest fresh water <b>150</b> feet. Source of information: <input type="checkbox"/> measured <input checked="" type="checkbox"/> well owner <input type="checkbox"/> electric log <input type="checkbox"/> KDWR
<b>Emergency, Settling and Burn Pits ONLY:</b> Producing Formation: _____ Number of producing wells on lease: _____ Barrels of fluid produced daily: _____ Does the slope from the tank battery allow all spilled fluids to flow into the pit? <input type="checkbox"/> Yes <input type="checkbox"/> No		<b>Drilling, Workover and Haul-Off Pits ONLY:</b> Type of material utilized in drilling/workover: <b>fresh water</b> Number of working pits to be utilized: <b>1</b> Abandonment procedure: <b>air dry and backfill</b> Drill pits must be closed within 365 days of spud date.
I hereby certify that the above statements are true and correct to the best of my knowledge and belief.		
<b>October 12, 2011</b> Date		 Signature of Applicant or Agent

15-091-23673-00700

RECEIVED  
OCT 13 2011

KCC WICHITA

<b>KCC OFFICE USE ONLY</b>			
Date Received: <b>10-13-11</b>	Permit Number: _____	Permit Date: <b>10-13-11</b>	Lease Inspection: <input checked="" type="checkbox"/> Yes <input type="checkbox"/> No
<input type="checkbox"/> Liner <input type="checkbox"/> Steel Pit <input checked="" type="checkbox"/> LRFAC <input type="checkbox"/> RFAS			

Mail to: KCC - Conservation Division, 130 S. Market - Room 2078, Wichita, Kansas 67202



October 13, 2011

Petroleum Technologies, Inc.  
801 W 47<sup>th</sup> St Ste 412  
Kansas City, MO 64112-1253

RE: Drilling Pit Application  
Reitz Lease Well No. 35  
NE/4 Sec. 32-14S-22E  
Johnson County, Kansas

Dear Sir or Madam:

District staff has inspected the above referenced location and has determined that the reserve pit shall be constructed **without slots**, the bottom shall be flat and reasonably level, and the free fluids must be removed. The fluids are to be removed from the reserve pit immediately after drilling operations have ceased.

**If production casing is set all completion fluids shall be removed from the working pits daily. NO completion fluids or non-exempt wastes shall be placed in the reserve pit.**

The fluids should be taken to an authorized disposal well. Please call the District Office at (620) 432-2300 when the fluids have been removed. Please file form CDP-5 (August 2004), Exploration and Production Waste Transfer, within 30 days of fluid removal. Conservation division forms are available through our office and on the KCC web site:  
[www.kcc.state.ks.us/conservation/forms](http://www.kcc.state.ks.us/conservation/forms).

**A copy of this letter should be posted in the doghouse along with the approved Intent to Drill.**

If you have any questions or concerns please feel free to contact the undersigned at the above address.

Sincerely,

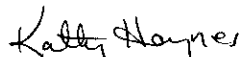

Kathy Haynes  
Environmental Protection and Remediation Department

cc: File