

For KCC Use: 10-24-2011  
Effective Date: \_\_\_\_\_  
District # 3  
SGA?  Yes  No

KANSAS CORPORATION COMMISSION  
OIL & GAS CONSERVATION DIVISION

Form C-1  
March 2010  
Form must be Typed  
Form must be Signed  
All blanks must be Filled

**NOTICE OF INTENT TO DRILL**

Must be approved by KCC five (5) days prior to commencing well  
Form KSONA-1, Certification of Compliance with the Kansas Surface Owner Notification Act, MUST be submitted with this form.

Expected Spud Date: October 22, 2011  
month day year

OPERATOR: License# 8653  
Name: Petroleum Technologies, Inc.  
Address 1: 801 W 47th Street  
Address 2: Suite 412  
City: Kansas City State: MO Zip: 64112 + 1253  
Contact Person: Alan J. Seaton  
Phone: 816-531-6904

CONTRACTOR: License# 8509  
Name: Evans Energy Development Inc.

Well Drilled For:  Oil  Gas  Seismic; # of Holes \_\_\_\_\_  
 Enh Rec  Storage  Disposal  
Well Class:  Infield  Pool Ext.  Wildcat  Other \_\_\_\_\_  
Type Equipment:  Mud Rotary  Air Rotary  Cable

If OWVO: old well information as follows:  
Operator: \_\_\_\_\_  
Well Name: \_\_\_\_\_  
Original Completion Date: \_\_\_\_\_ Original Total Depth: \_\_\_\_\_

Directional, Deviated or Horizontal wellbore?  Yes  No  
If Yes, true vertical depth: \_\_\_\_\_  
Bottom Hole Location: \_\_\_\_\_  
KCC DKT #: \_\_\_\_\_

Spot Description: \_\_\_\_\_  
SW - SE - NE - NE Sec. 32 Twp. 14 S. R. 22  E  W  
(Q/Q/Q) 4,244 feet from  N /  S Line of Section  
595 feet from  E /  W Line of Section

Is SECTION:  Regular  Irregular?  
(Note: Locate well on the Section Plat on reverse side)

County: Johnson  
Lease Name: REITZ Well #: 28  
Field Name: Edgerton Northeast

Is this a Prorated / Spaced Field?  Yes  No  
Target Formation(s): Bartlesville Sand

Nearest Lease or unit boundary line (in footage): 595'  
Ground Surface Elevation: 985' feet MSL

Water well within one-quarter mile:  Yes  No  
Public water supply well within one mile:  Yes  No

Depth to bottom of fresh water: 150'  
Depth to bottom of usable water: 300'

Surface Pipe by Alternate:  I  II  
Length of Surface Pipe Planned to be set: 20'

Length of Conductor Pipe (if any): N/A  
Projected Total Depth: 900'

Formation at Total Depth: Cherokee

Water Source for Drilling Operations:  
 Well  Farm Pond  Other: \_\_\_\_\_

DWR Permit #: \_\_\_\_\_  
(Note: Apply for Permit with DWR )

Will Cores be taken?  Yes  No  
If Yes, proposed zone: \_\_\_\_\_

**AFFIDAVIT**

The undersigned hereby affirms that the drilling, completion and eventual plugging of this well will comply with K.S.A. 55 et. seq.  
It is agreed that the following minimum requirements will be met:

1. Notify the appropriate district office **prior** to spudding of well;
2. A copy of the approved notice of intent to drill **shall be posted** on each drilling rig;
3. The minimum amount of surface pipe as specified below **shall be set** by circulating cement to the top; in all cases surface pipe **shall be set** through all unconsolidated materials plus a minimum of 20 feet into the underlying formation.
4. If the well is dry hole, an agreement between the operator and the district office on plug length and placement is necessary **prior to plugging**;
5. The appropriate district office will be notified before well is either plugged or production casing is cemented in;
6. If an ALTERNATE II COMPLETION, production pipe shall be cemented from below any usable water to surface within **120 DAYS** of spud date. Or pursuant to Appendix "B" - Eastern Kansas surface casing order #133,891-C, which applies to the KCC District 3 area, alternate II cementing must be completed within 30 days of the spud date or the well shall be plugged. **In all cases, NOTIFY district office** prior to any cementing.

I hereby certify that the statements made herein are true and to the best of my knowledge and belief.

Date: October 14, 2011 Signature of Operator or Agent: \_\_\_\_\_ Title: President

For KCC Use ONLY  
API # 15 - 091-23695-0000  
Conductor pipe required None feet  
Minimum surface pipe required 20 feet per ALT.  I  II  
Approved by: [Signature] 10-19-2011  
This authorization expires: 10-19-2012  
(This authorization void if drilling not started within 12 months of approval date.)  
Spud date: \_\_\_\_\_ Agent: \_\_\_\_\_

**Remember to:**

- File Certification of Compliance with the Kansas Surface Owner Notification Act (KSONA-1) with Intent to Drill;
- File Drill Pit Application (form CDP-1) with Intent to Drill;
- File Completion Form ACO-1 within 120 days of spud date;
- File acreage attribution plat according to field proration orders; OCT 17 2011
- Notify appropriate district office 48 hours prior to workover or re-entry;
- Submit plugging report (CP-4) after plugging is completed (within 90 days);
- Obtain written approval before disposing or injecting salt water.
- If well will not be drilled or permit has expired (See: authorized expiration date) please check the box below and return to the address below.

Well will not be drilled or Permit Expired Date: \_\_\_\_\_  
Signature of Operator or Agent: \_\_\_\_\_

Mail to: KCC - Conservation Division,  
130 S. Market - Room 2078, Wichita, Kansas 67202

RECEIVED  
OCT 17 2011  
KCC WICHITA  
32  
11  
29  
E  
W

For KCC Use ONLY

API # 15 - 091-236950000

**IN ALL CASES PLOT THE INTENDED WELL ON THE PLAT BELOW**

In all cases, please fully complete this side of the form. Include items 1 through 5 at the bottom of this page.

Operator: Petroleum Technologies, Inc.  
 Lease: REITZ  
 Well Number: 28  
 Field: Edgerton Northeast  
 Number of Acres attributable to well: 2.6  
 QTR/QTR/QTR/QTR of acreage: SW - SE - NE - NE

Location of Well: County: Johnson  
4,244 feet from  N /  S Line of Section  
595 feet from  E /  W Line of Section  
 Sec. 32 Twp. 14 S. R. 22  E  W

Is Section:  Regular or  Irregular

If Section is Irregular, locate well from nearest corner boundary.

Section corner used:  NE  NW  SE  SW

**PLAT**

Show location of the well. Show footage to the nearest lease or unit boundary line. Show the predicted locations of lease roads, tank batteries, pipelines and electrical lines, as required by the Kansas Surface Owner Notice Act (House Bill 2032). You may attach a separate plat if desired.

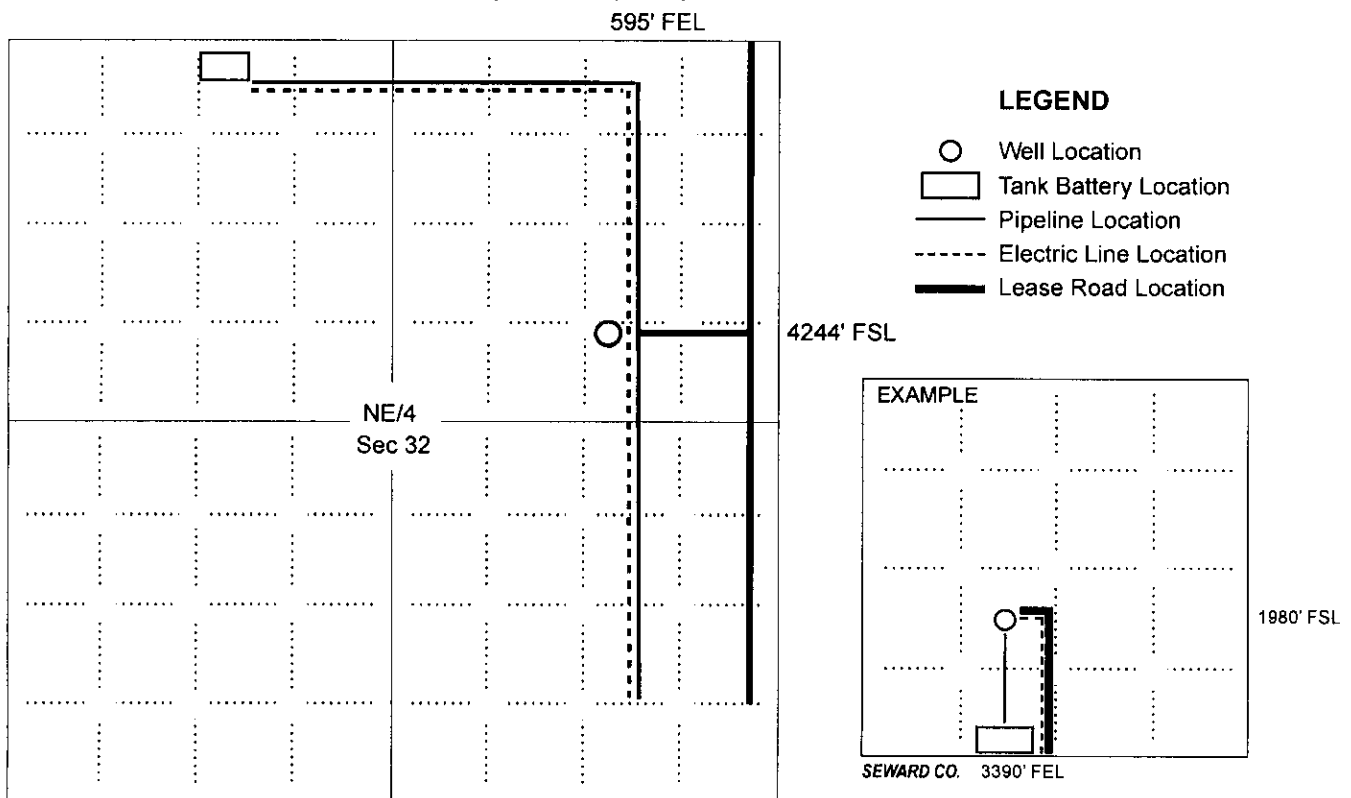

**NOTE: In all cases locate the spot of the proposed drilling location.**

**In plotting the proposed location of the well, you must show:**

1. The manner in which you are using the depicted plat by identifying section lines, i.e. 1 section, 1 section with 8 surrounding sections, 4 sections, etc.
2. The distance of the proposed drilling location from the south / north and east / west outside section lines.
3. The distance to the nearest lease or unit boundary line (in footage).
4. If proposed location is located within a prorated or spaced field a certificate of acreage attribution plat must be attached: (CO-7 for oil wells; CG-8 for gas wells).
5. The predicted locations of lease roads, tank batteries, pipelines, and electrical lines.

RECEIVED

OCT 17 2011

KCC WICHITA

KANSAS CORPORATION COMMISSION  
OIL & GAS CONSERVATION DIVISION

Form KSONA-1  
July 2010  
Form Must Be Typed  
Form must be Signed  
All blanks must be Filled

CERTIFICATION OF COMPLIANCE WITH THE  
KANSAS SURFACE OWNER NOTIFICATION ACT

15-091-23695-0000

This form must be submitted with all Forms C-1 (Notice of Intent to Drill); CB-1 (Cathodic Protection Borehole Intent); T-1 (Request for Change of Operator Transfer of Injection or Surface Pit Permit); and CP-1 (Well Plugging Application). Any such form submitted without an accompanying Form KSONA-1 will be returned.

Select the corresponding form being filed:  C-1 (Intent)  CB-1 (Cathodic Protection Borehole Intent)  T-1 (Transfer)  CP-1 (Plugging Application)

OPERATOR: License # 8653  
Name: Petroleum Technologies, Inc.  
Address 1: 801 W 47th Street  
Address 2: Suite 412  
City: Kansas City State: MO Zip: 64112 + 1253  
Contact Person: Alan J. Seaton  
Phone: ( 816 ) 531-6904 Fax: ( 816 ) 531-6905  
Email Address: ajseaton@swbell.net

Well Location:  
SW SE NE NE Sec. 32 Twp. 14 S. R. 22  East  West  
County: Johnson  
Lease Name: REITZ Well #: 28

If filing a Form T-1 for multiple wells on a lease, enter the legal description of the lease below:

Surface Owner Information:

Name: Engelmann Farms LLC  
Address 1: 2000 W. 68th St.  
Address 2: \_\_\_\_\_  
City: Mission Hills State: KS Zip: 66021 + \_\_\_\_\_

When filing a Form T-1 involving multiple surface owners, attach an additional sheet listing all of the information to the left for each surface owner. Surface owner information can be found in the records of the register of deeds for the county, and in the real estate property tax records of the county treasurer.

If this form is being submitted with a Form C-1 (Intent) or CB-1 (Cathodic Protection Borehole Intent), you must supply the surface owners and the KCC with a plat showing the predicted locations of lease roads, tank batteries, pipelines, and electrical lines. The locations shown on the plat are preliminary non-binding estimates. The locations may be entered on the Form C-1 plat, Form CB-1 plat, or a separate plat may be submitted.

Select one of the following:

- I certify that, pursuant to the Kansas Surface Owner Notice Act (House Bill 2032), I have provided the following to the surface owner(s) of the land upon which the subject well is or will be located: 1) a copy of the Form C-1, Form CB-1, Form T-1, or Form CP-1 that I am filing in connection with this form; 2) if the form being filed is a Form C-1 or Form CB-1, the plat(s) required by this form; and 3) my operator name, address, phone number, fax, and email address.
- I have not provided this information to the surface owner(s). I acknowledge that, because I have not provided this information, the KCC will be required to send this information to the surface owner(s). To mitigate the additional cost of the KCC performing this task, I acknowledge that I am being charged a \$30.00 handling fee, payable to the KCC, which is enclosed with this form.

If choosing the second option, submit payment of the \$30.00 handling fee with this form. If the fee is not received with this form, the KSONA-1 form and the associated Form C-1, Form CB-1, Form T-1, or Form CP-1 will be returned.

I hereby certify that the statements made herein are true and correct to the best of my knowledge and belief.

Date: October 14, 2011 Signature of Operator or Agent: [Signature] Title: President

RECEIVED

OCT 17 2011

KCC WICHITA

**KANSAS CORPORATION COMMISSION  
OIL & GAS CONSERVATION DIVISION  
APPLICATION FOR SURFACE PIT**

Form CDP-1  
May 2010  
Form must be Typed

*Submit in Duplicate*

Operator Name: <b>Petroleum Technologies, Inc.</b>		License Number: <b>8653</b>
Operator Address: <b>801 W 47th Street</b>		<b>Suite 412</b>
		<b>Kansas City MO 64112</b>
Contact Person: <b>Alan J. Seaton</b>		Phone Number: <b>816-531-6904</b>
Lease Name & Well No.: <b>REITZ 28</b>		Pit Location (QQQQ): <b>SW SE NE NE</b>
Type of Pit: <input type="checkbox"/> Emergency Pit <input type="checkbox"/> Burn Pit <input type="checkbox"/> Settling Pit <input checked="" type="checkbox"/> Drilling Pit <input type="checkbox"/> Workover Pit <input type="checkbox"/> Haul-Off Pit <small>(If WP Supply API No. or Year Drilled)</small>	Pit is: <input checked="" type="checkbox"/> Proposed <input type="checkbox"/> Existing If Existing, date constructed: _____ Pit capacity: <b>77</b> (bbls)	Sec. <b>32</b> Twp. <b>14</b> R. <b>22</b> <input checked="" type="checkbox"/> East <input type="checkbox"/> West <b>4,244</b> Feet from <input type="checkbox"/> North / <input checked="" type="checkbox"/> South Line of Section <b>595</b> Feet from <input checked="" type="checkbox"/> East / <input type="checkbox"/> West Line of Section <b>Johnson</b> County
Is the pit located in a Sensitive Ground Water Area? <input type="checkbox"/> Yes <input checked="" type="checkbox"/> No		Chloride concentration: _____ mg/l <small>(For Emergency Pits and Settling Pits only)</small>
Is the bottom below ground level? <input checked="" type="checkbox"/> Yes <input type="checkbox"/> No	Artificial Liner? <input type="checkbox"/> Yes <input checked="" type="checkbox"/> No	How is the pit lined if a plastic liner is not used? <b>Native Clay</b>
Pit dimensions (all but working pits): <b>12</b> Length (feet) <b>6</b> Width (feet) Depth from ground level to deepest point: <b>6</b> (feet)		<input type="checkbox"/> N/A: Steel Pits <input type="checkbox"/> No Pit
If the pit is lined give a brief description of the liner material, thickness and installation procedure.		Describe procedures for periodic maintenance and determining liner integrity, including any special monitoring.
Distance to nearest water well within one-mile of pit: <b>4510</b> feet    Depth of water well <b>149</b> feet		Depth to shallowest fresh water <b>150</b> feet. Source of information: <input type="checkbox"/> measured <input checked="" type="checkbox"/> well owner <input type="checkbox"/> electric log <input type="checkbox"/> KDWR
<b>Emergency, Settling and Burn Pits ONLY:</b> Producing Formation: _____ Number of producing wells on lease: _____ Barrels of fluid produced daily: _____ Does the slope from the tank battery allow all spilled fluids to flow into the pit? <input type="checkbox"/> Yes <input type="checkbox"/> No		<b>Drilling, Workover and Haul-Off Pits ONLY:</b> Type of material utilized in drilling/workover: <b>fresh water</b> Number of working pits to be utilized: <b>1</b> Abandonment procedure: <b>air dry and backfill</b> Drill pits must be closed within 365 days of spud date.
I hereby certify that the above statements are true and correct to the best of my knowledge and belief.		<b>RECEIVED</b> <b>OCT 17 2011</b> <b>KCC WICHITA</b>
<b>October 14, 2011</b> Date	 Signature of Applicant or Agent	
<b>KCC OFFICE USE ONLY</b>		
Date Received: <b>10-17-11</b>	Permit Number: _____	Permit Date: <b>10-18-11</b> Lease Inspection: <input checked="" type="checkbox"/> Yes <input checked="" type="checkbox"/> No

15-091-23695-0000

Conservation Division  
Finney State Office Building  
130 S. Market, Rm. 2078  
Wichita, KS 67202-3802



Phone: 316-337-6200  
Fax: 316-337-6211  
<http://kcc.ks.gov/>

Mark Sievers, Chairman  
Ward Loyd, Commissioner  
Thomas E. Wright, Commissioner

Sam Brownback, Governor

October 18, 2011

Petroleum Technologies, Inc.  
801 W 47<sup>th</sup> St Ste 412  
Kansas City, MO 64112-1253

RE: Drilling Pit Application  
Reitz Lease Well No. 28  
NE/4 Sec. 32-14S-22E  
Johnson County, Kansas

Dear Sir or Madam:

District staff has inspected the above referenced location and has determined that the reserve pit shall be constructed **without slots**, the bottom shall be flat and reasonably level, and the free fluids must be removed. The fluids are to be removed from the reserve pit immediately after drilling operations have ceased.

**If production casing is set all completion fluids shall be removed from the working pits daily. NO completion fluids or non-exempt wastes shall be placed in the reserve pit.**

The fluids should be taken to an authorized disposal well. Please call the District Office at (620) 432-2300 when the fluids have been removed. Please file form CDP-5 (August 2004), Exploration and Production Waste Transfer, within 30 days of fluid removal. Conservation division forms are available through our office and on the KCC web site:  
[www.kcc.state.ks.us/conservation/forms](http://www.kcc.state.ks.us/conservation/forms).

**A copy of this letter should be posted in the doghouse along with the approved Intent to Drill.**

If you have any questions or concerns please feel free to contact the undersigned at the above address.

Sincerely,

Kathy Haynes  
Environmental Protection and Remediation Department

cc: File



# PETROLEUM TECHNOLOGIES, INC.

15-091-23695-00-00

October 14, 2011

Kansas Corporation Commission  
Conservation Division  
130 S. Market, Room 2078  
Wichita, Kansas 67202

Rick:

Enclosed please find 11 - Notice of Intent to Drill Forms (C-1's), along with all attachments. Also enclosed are copies of the two closest water well records. The water well record for the NE quarter of section 32 does not exist in this quarter section, according to the farmer no well and no house existed on this property. We used the other water well record enclosed as closest water well within one mile.

Sincerely,  
Petroleum Technologies, Inc.

Alan J. Seaton  
President

Enclosures

RECEIVED  
OCT 17 2011  
KCC WICHITA



Doesn't Exist  
in this quarter H.S.

USE TYPEWRITER OR BALL  
POINT PEN-PRESS FIRMLY,  
PRINT CLEARLY.

WATER WELL RECORD  
KSA 82a-1201-1215

Kansas Department of Health and  
Environment-Division of Environment  
(Water well Contractors)  
Topeka, Kansas 66620

1. Location of well:		County <b>Johnson</b>	Fraction <b>SE 1/4 NE 1/4</b> 1/4	Section number <b>32</b>	Township number <b>T 14</b>	Range number <b>S R 22 E/W</b>
2. Distance and direction from nearest town or city: Street address of well location if in city:			3. Owner of well: <b>H.S. ALTMAN</b> R.R. or street: City, state, zip code: <b>EDGERTON, KS 66021</b>			
4. Locate with "X" in section below:		Sketch map:			6. Bore hole dia. <b>5</b> in. Completion date <b>5/30/76</b> Well depth <b>217</b> ft.	
					7. <input checked="" type="checkbox"/> Cable tool <input type="checkbox"/> Rotary <input type="checkbox"/> Driven <input type="checkbox"/> Dug <input type="checkbox"/> Hollow rod <input type="checkbox"/> Jetted <input type="checkbox"/> Bored <input type="checkbox"/> Reverse rotary	
5. Type and color of material		From	To	8. Use: <input checked="" type="checkbox"/> Domestic <input type="checkbox"/> Public supply <input type="checkbox"/> Industry <input type="checkbox"/> Irrigation <input type="checkbox"/> Air conditioning <input type="checkbox"/> Stock <input type="checkbox"/> Lawn <input type="checkbox"/> Oil field water <input type="checkbox"/> Other		
Soil & Joint Clay		14	6	14	9. Casing: Material <b>PLTS</b> Height: Above or below Threaded <input type="checkbox"/> Welded <input type="checkbox"/> Surface <input type="checkbox"/> in. RMP <input type="checkbox"/> PVC <input checked="" type="checkbox"/> Weight <input type="checkbox"/> lbs./ft. Dia. <b>5</b> in. to <b>217</b> ft. depth Wall Thickness: inches or Dia. <input type="checkbox"/> in. to <input type="checkbox"/> ft. depth gage No. <input type="checkbox"/>	
Blue Lime		3	14	17	10. Screen: Manufacturer's name <b>JESS +</b> <b>LOWELL</b> Type <b>PLASTIC</b> Dia. <b>5</b> Slot/gauze <b>1/4 HOLE</b> Length <b>20'</b> Set between <b>50</b> ft. and <b>70</b> ft. <b>190</b> ft. and <b>210</b> ft. Gravel pack? <input checked="" type="checkbox"/> Size range of material <input type="checkbox"/>	
Hard Sandy Gray Shale		6	17	23	11. Static water level: <input type="checkbox"/> mo./day/yr. <b>50</b> ft. below land surface Date <b>5/25/76</b>	
White Lime		22	23	45	12. Pumping level below land surfaces: ft. after <input type="checkbox"/> hrs. pumping <input type="checkbox"/> g.p.m. ft. after <input type="checkbox"/> hrs. pumping <input type="checkbox"/> g.p.m. Estimated maximum yield <b>1 TO 2</b> g.p.m.	
Black Slale		5	45	50	13. Water sample submitted: <input type="checkbox"/> Yes <input checked="" type="checkbox"/> No Date <input type="checkbox"/>	
Blue Lime- possible water		8	50	58	14. Well head completion: <input checked="" type="checkbox"/> Pitless adapter <input type="checkbox"/> Inches above grade	
Hard Gray Shale		5	58	63	15. Well grouted? <b>YES</b> With: <input type="checkbox"/> Neat cement <input checked="" type="checkbox"/> Bentonite <input type="checkbox"/> Concrete Depth: From <input type="checkbox"/> ft. to <input type="checkbox"/> ft.	
Blue Lime		24	63	87	16. Nearest source of possible contamination: ft. <b>100'</b> Direction <b>SW</b> Type <b>SEPTIC TANK</b> Well disinfected upon completion? <input checked="" type="checkbox"/> Yes <input type="checkbox"/> No	
Red Shale		1	87	88	17. Pump: <input type="checkbox"/> Not installed Manufacturer's name <b>Red Jacket</b> Model number <input type="checkbox"/> HP <b>3/4</b> Volts <b>230</b> Length of drop pipe <b>212</b> ft. capacity <b>5</b> g.p.m. Type: <input checked="" type="checkbox"/> Submersible <input type="checkbox"/> Turbine <input type="checkbox"/> Jet <input type="checkbox"/> Reciprocating <input type="checkbox"/> Centrifugal <input type="checkbox"/> Other	
Gray Sand		14	93	107	20. Water well contractor's certification: This well was drilled under my jurisdiction and this report is true to the best of my knowledge and belief. <b>NO</b> <b>SWANK WATER WELL DRILL' 107</b> Business name <b>PRINCE TON KS</b> License No. <input type="checkbox"/> Address <b>PRINCE TON KS</b> Signed <b>George H. Swank</b> Date <b>5/31/76</b> Authorized representative	
Blue Lime		7	107	115		
White Lime		12	115	127		
Gray Shale		15	127	142		
Blue Lime		16	142	158		
Gray Shale (Use a second sheet if needed)		12	158	170		
18. Elevation:		19. Remarks:		20. Water well contractor's certification:		
Topography: <input type="checkbox"/> Hill <input checked="" type="checkbox"/> Slope <input type="checkbox"/> Upland <input type="checkbox"/> Valley						

Forward the white, blue and pink copies to the Department of Health and Environment

Form WWC-5

RECEIVED  
OCT 17 2011  
KCC WICHITA

MI-1023



USE TYPEWRITER OR BALL POINT PEN-PRESS FIRMLY, PRINT CLEARLY.

WATER WELL RECORD  
KSA 82a-1201-1215

Kansas Department of Health and Environment-Division of Environment  
(Water well Contractors)  
Topeka, Kansas 66620

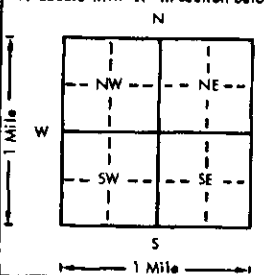
1. Location of well;	County	Fraction 1/4 1/4 1/4	Section number	Township number T S R	Range number E/W
2. Distance and direction from nearest town or city: Street address of well location if in city:			3. Owner of well: <b>H. S. Altman</b> R.R. or street: City, state, zip code: <b>Edgerton, Kansas 66021</b>		
4. Locate with "X" in section below: Sketch map: 			6. Bore hole dia. <u>6 1/4</u> in. Completion date <u>5/30/76</u> Well depth <u>217 1/2</u> ft.		
5. Type and color of material			7. <input checked="" type="checkbox"/> Cable tool <input type="checkbox"/> Rotary <input type="checkbox"/> Driven <input type="checkbox"/> Dug <input type="checkbox"/> Hollow rod <input type="checkbox"/> Jetted <input type="checkbox"/> Bored <input type="checkbox"/> Reverse rotary		
			8. Use: <input checked="" type="checkbox"/> Domestic <input type="checkbox"/> Public supply <input type="checkbox"/> Industry <input type="checkbox"/> Irrigation <input type="checkbox"/> Air conditioning <input type="checkbox"/> Stock <input type="checkbox"/> Lawn <input type="checkbox"/> Oil field water <input type="checkbox"/> Other		
			9. Casing: Material _____ Height: Above or below Threaded _____ Welded _____ Surface _____ in. RMP _____ PVS _____ X _____ Weight _____ lbs./ft. Dia. <u>5</u> in. to <u>217</u> ft. depth Wall Thickness: inches or Dia. _____ in. to _____ ft. depth page No. _____		
			10. Screen: Manufacturer's name _____ Type _____ Dia. _____ Slot/gauze _____ Length _____ Set between _____ ft. and _____ ft. _____ ft. and _____ ft. Gravel pack? _____ Size range of material _____		
			11. Static water level: _____ mo./day/yr. _____ ft. below land surface Date _____		
			12. Pumping level below land surfaces: _____ ft. after _____ hrs. pumping _____ g.p.m. _____ ft. after _____ hrs. pumping _____ g.p.m. Estimated maximum yield _____ g.p.m.		
13. Water sample submitted: _____ mo./day/yr. Yes _____ No _____ Date _____			14. Well head completion: <input checked="" type="checkbox"/> Pitless adapter _____ inches above grade		
15. Well grouted? _____ With: _____ Neat cement <input checked="" type="checkbox"/> Bentonite _____ Concrete _____ Depth: From _____ ft. to _____ ft.			16. Nearest source of possible contamination: ft. _____ Direction _____ Type _____ Well disinfected upon completion? <input checked="" type="checkbox"/> Yes _____ No _____		
17. Pump: Manufacturer's name <u>Red Jacket</u> Not installed Model number _____ HP _____ Volts _____ Length of drop pipe _____ ft. capacity _____ g.p.m. Type: <input type="checkbox"/> Submersible <input type="checkbox"/> Turbine <input type="checkbox"/> Jet <input type="checkbox"/> Reciprocating <input type="checkbox"/> Centrifugal <input type="checkbox"/> Other			20. Water well contractor's certification: This well was drilled under my jurisdiction and this report is true to the best of my knowledge and belief. Business name _____ License No. <u>107</u> Address _____ Signed <u>George H. Lusk</u> Date <u>5/17/76</u> Authorized representative		
18. Elevation:  Topography: <input type="checkbox"/> Hill <input type="checkbox"/> Slope <input type="checkbox"/> Upland <input type="checkbox"/> Valley	19. Remarks:  (Use a second sheet if needed)				

Forward the white, blue and pink copies to the Department of Health and Environment

Form WWC-5

RECEIVED  
OCT 17 2011  
KCC WICHITA