

For KCC Use: 10-24-2011  
 Effective Date: 3  
 District #: 3  
 SGA?  Yes  No

KANSAS CORPORATION COMMISSION  
 OIL & GAS CONSERVATION DIVISION

Form C-1  
 March 2010  
 Form must be Typed  
 Form must be Signed  
 All blanks must be Filled

**NOTICE OF INTENT TO DRILL**

Must be approved by KCC five (5) days prior to commencing well

Form KSONA-1, Certification of Compliance with the Kansas Surface Owner Notification Act, MUST be submitted with this form.

Expected Spud Date: October 21, 2011  
 month day year

OPERATOR: License# 8653  
 Name: Petroleum Technologies, Inc.  
 Address 1: 801 W 47th Street  
 Address 2: Suite 412  
 City: Kansas City State: MO Zip: 64112 + 1253  
 Contact Person: Alan J. Seaton  
 Phone: 816-531-6904

CONTRACTOR: License# 8509  
 Name: Evans Energy Development Inc.

Well Drilled For:	Well Class:	Type Equipment:
<input type="checkbox"/> Oil	<input checked="" type="checkbox"/> Enh Rec	<input checked="" type="checkbox"/> Infield
<input type="checkbox"/> Gas	<input type="checkbox"/> Storage	<input type="checkbox"/> Pool Ext.
	<input type="checkbox"/> Disposal	<input type="checkbox"/> Wildcat
<input type="checkbox"/> Seismic ; # of Holes	<input type="checkbox"/> Other	<input type="checkbox"/> Mud Rotary
<input type="checkbox"/> Other:		<input type="checkbox"/> Air Rotary
		<input type="checkbox"/> Cable

If OWWO: old well information as follows:

Operator: \_\_\_\_\_  
 Well Name: \_\_\_\_\_  
 Original Completion Date: \_\_\_\_\_ Original Total Depth: \_\_\_\_\_

Directional, Deviated or Horizontal wellbore?  Yes  No  
 If Yes, true vertical depth: \_\_\_\_\_  
 Bottom Hole Location: \_\_\_\_\_  
 KCC DKT #: \_\_\_\_\_

Spot Description:  
 NW SE NE NE Sec. 32 Twp. 14 S. R. 22  E  W  
 (Q/Q/Q/Q) 4,448 feet from  N /  S Line of Section  
382 feet from  E /  W Line of Section

Is SECTION:  Regular  Irregular?

(Note: Locate well on the Section Plat on reverse side)  
 County: Johnson

Lease Name: REITZ Well #: 34 i  
 Field Name: Edgerton Northeast

Is this a Prorated / Spaced Field?  Yes  No  
 Target Formation(s): Bartlesville Sand

Nearest Lease or unit boundary line (in footage): 382'  
 Ground Surface Elevation: 987' feet MSL

Water well within one-quarter mile:  Yes  No  
 Public water supply well within one mile:  Yes  No

Depth to bottom of fresh water: 150'  
 Depth to bottom of usable water: 300'

Surface Pipe by Alternate:  I  II  
 Length of Surface Pipe Planned to be set: 20'

Length of Conductor Pipe (if any): N/A  
 Projected Total Depth: 900'

Formation at Total Depth: Cherokee  
 Water Source for Drilling Operations:  
 Well  Farm Pond  Other:

DWR Permit #: \_\_\_\_\_  
 (Note: Apply for Permit with DWR)

Will Cores be taken?  Yes  No  
 If Yes, proposed zone: \_\_\_\_\_

**AFFIDAVIT**

The undersigned hereby affirms that the drilling, completion and eventual plugging of this well will comply with K.S.A. 55 et. seq.  
 It is agreed that the following minimum requirements will be met:

1. Notify the appropriate district office **prior** to spudding of well;
2. A copy of the approved notice of intent to drill **shall be** posted on each drilling rig;
3. The minimum amount of surface pipe as specified below **shall be set** by circulating cement to the top; in all cases surface pipe **shall be set** through all unconsolidated materials plus a minimum of 20 feet into the underlying formation.
4. If the well is dry hole, an agreement between the operator and the district office on plug length and placement is necessary **prior to plugging**;
5. The appropriate district office will be notified before well is either plugged or production casing is cemented in;
6. If an ALTERNATE II COMPLETION, production pipe shall be cemented from below any usable water to surface within **120 DAYS** of spud date. Or pursuant to Appendix "B" - Eastern Kansas surface casing order #133,891-C, which applies to the KCC District 3 area, alternate II cementing must be completed within 30 days of the spud date or the well shall be plugged. **In all cases, NOTIFY district office** prior to any cementing.

I hereby certify that the statements made herein are true and to the best of my knowledge and belief  
 Date: October 14, 2011 Signature of Operator or Agent: \_\_\_\_\_ Title: President

**For KCC Use ONLY**  
 API # 15 - 091-23700-0000  
 Conductor pipe required None feet  
 Minimum surface pipe required 20 feet per ALT.  I  II  
 Approved by: [Signature] 10-19-2011  
 This authorization expires: 10-19-2012  
 (This authorization void if drilling not started within 12 months of approval date.)  
 Spud date: \_\_\_\_\_ Agent: \_\_\_\_\_

**Remember to:**

- File Certification of Compliance with the Kansas Surface Owner Notification Act (KSONA-1) with Intent to Drill;
- File Drill Pit Application (form CDP-1) with Intent to Drill;
- File Completion Form ACO-1 within 120 days of spud date;
- File acreage attribution plat according to field proration orders;
- Notify appropriate district office 48 hours prior to workover or re-entry;
- Submit plugging report (CP-4) after plugging is completed (within 60 days);
- Obtain written approval before disposing or injecting salt water.
- If well will not be drilled or permit has expired (See: authorized expiration date) please check the box below and return to the address below.

Well will not be drilled or Permit Expired Date: \_\_\_\_\_  
 Signature of Operator or Agent: \_\_\_\_\_

Mail to: KCC - Conservation Division,  
 130 S. Market - Room 2078, Wichita, Kansas 67202

KCC WICHITA

32  
 14  
 22  
 E  
 W

RECEIVED  
 OCT 17 2011

For KCC Use ONLY

API # 15 - 091-237000000

**IN ALL CASES PLOT THE INTENDED WELL ON THE PLAT BELOW**

In all cases, please fully complete this side of the form. Include items 1 through 5 at the bottom of this page.

Operator: Petroleum Technologies, Inc.  
 Lease: REITZ  
 Well Number: 34 i  
 Field: Edgerton Northeast  
 Number of Acres attributable to well: 2.6  
 QTR/QTR/QTR/QTR of acreage: NW - SE - NE - NE

Location of Well: County: Johnson  
4,448 feet from  N /  S Line of Section  
382 feet from  E /  W Line of Section  
 Sec. 32 Twp. 14 S. R. 22  E  W

Is Section:  Regular or  Irregular

If Section is Irregular, locate well from nearest corner boundary.

Section corner used:  NE  NW  SE  SW

**PLAT**

Show location of the well. Show footage to the nearest lease or unit boundary line. Show the predicted locations of lease roads, tank batteries, pipelines and electrical lines, as required by the Kansas Surface Owner Notice Act (House Bill 2032).

You may attach a separate plat if desired.

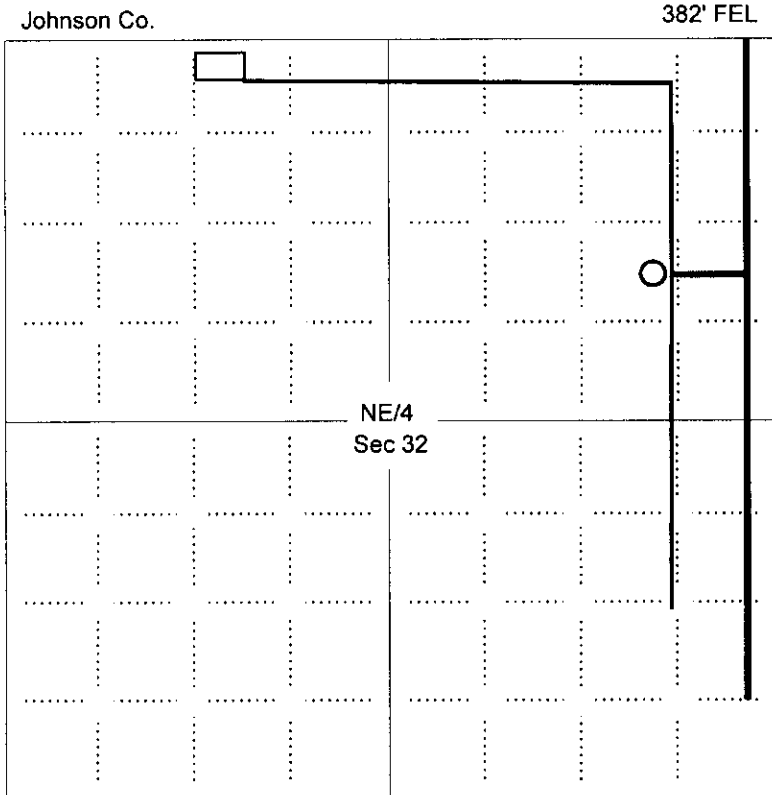

**LEGEND**

- Well Location
- Tank Battery Location
- Pipeline Location
- Electric Line Location
- Lease Road Location

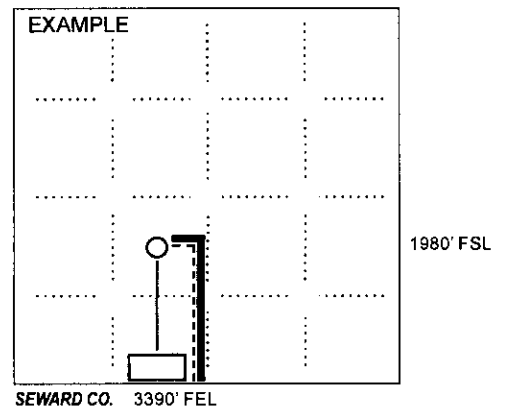

**NOTE: In all cases locate the spot of the proposed drilling location.**

**In plotting the proposed location of the well, you must show:**

1. The manner in which you are using the depicted plat by identifying section lines, i.e. 1 section, 1 section with 8 surrounding sections, 4 sections, etc.
2. The distance of the proposed drilling location from the south / north and east / west outside section lines.
3. The distance to the nearest lease or unit boundary line (in footage).
4. If proposed location is located within a prorated or spaced field a certificate of acreage attribution plat must be attached: (CO-7 for oil wells, CG-8 for gas wells).
5. The predicted locations of lease roads, tank batteries, pipelines, and electrical lines.

RECEIVED  
 OCT 17 2011  
 KCC WICHITA

KANSAS CORPORATION COMMISSION  
OIL & GAS CONSERVATION DIVISION

Form KSONA-1  
July 2010  
Form Must Be Typed  
Form must be Signed  
All blanks must be Filled

**CERTIFICATION OF COMPLIANCE WITH THE  
KANSAS SURFACE OWNER NOTIFICATION ACT**

15-091-23700-0000

This form must be submitted with all Forms C-1 (Notice of Intent to Drill); CB-1 (Cathodic Protection Borehole Intent); T-1 (Request for Change of Operator Transfer of Injection or Surface Pit Permit); and CP-1 (Well Plugging Application). Any such form submitted without an accompanying Form KSONA-1 will be returned.

Select the corresponding form being filed:  C-1 (Intent)  CB-1 (Cathodic Protection Borehole Intent)  T-1 (Transfer)  CP-1 (Plugging Application)

OPERATOR: License # 8653  
Name: Petroleum Technologies, Inc.  
Address 1: 801 W 47th Street  
Address 2: Suite 412  
City: Kansas City State: MO Zip: 64112 + 1253  
Contact Person: Alan J. Seaton  
Phone: ( 816 ) 531-6904 Fax: ( 816 ) 531-6905  
Email Address: ajseaton@swbell.net

Well Location:  
NW SE NE NE Sec. 32 Twp. 14 S. R. 22  East  West  
County: Johnson  
Lease Name: REITZ Well #: 34 i

If filing a Form T-1 for multiple wells on a lease, enter the legal description of the lease below:

Surface Owner Information:

Name: Engelmann Farms LLC  
Address 1: 2000 W. 68th St.  
Address 2: \_\_\_\_\_  
City: Mission Hills State: KS Zip: 66021 + \_\_\_\_\_

When filing a Form T-1 involving multiple surface owners, attach an additional sheet listing all of the information to the left for each surface owner. Surface owner information can be found in the records of the register of deeds for the county, and in the real estate property tax records of the county treasurer.

If this form is being submitted with a Form C-1 (Intent) or CB-1 (Cathodic Protection Borehole Intent), you must supply the surface owners and the KCC with a plat showing the predicted locations of lease roads, tank batteries, pipelines, and electrical lines. The locations shown on the plat are preliminary non-binding estimates. The locations may be entered on the Form C-1 plat, Form CB-1 plat, or a separate plat may be submitted.

Select one of the following:

- I certify that, pursuant to the Kansas Surface Owner Notice Act (House Bill 2032), I have provided the following to the surface owner(s) of the land upon which the subject well is or will be located: 1) a copy of the Form C-1, Form CB-1, Form T-1, or Form CP-1 that I am filing in connection with this form; 2) if the form being filed is a Form C-1 or Form CB-1, the plat(s) required by this form; and 3) my operator name, address, phone number, fax, and email address.
- I have not provided this information to the surface owner(s). I acknowledge that, because I have not provided this information, the KCC will be required to send this information to the surface owner(s). To mitigate the additional cost of the KCC performing this task, I acknowledge that I am being charged a \$30.00 handling fee, payable to the KCC, which is enclosed with this form.

If choosing the second option, submit payment of the \$30.00 handling fee with this form. If the fee is not received with this form, the KSONA-1 form and the associated Form C-1, Form CB-1, Form T-1, or Form CP-1 will be returned.

I hereby certify that the statements made herein are true and correct to the best of my knowledge and belief.

Date: October 14, 2011 Signature of Operator or Agent:  Title: President

RECEIVED  
OCT 17 2011

**KANSAS CORPORATION COMMISSION  
OIL & GAS CONSERVATION DIVISION  
APPLICATION FOR SURFACE PIT**

Form CDP-1  
May 2010  
Form must be Typed

*Submit in Duplicate*

Operator Name: <b>Petroleum Technologies, Inc.</b>		License Number: <b>8653</b>
Operator Address: <b>801 W 47th Street</b>		<b>Suite 412 Kansas City MO 64112</b>
Contact Person: <b>Alan J. Seaton</b>		Phone Number: <b>816-531-6904</b>
Lease Name & Well No.: <b>REITZ 34 i</b>		Pit Location (QQQQ): <b>NW SE NE NE</b>
Type of Pit: <input type="checkbox"/> Emergency Pit <input type="checkbox"/> Burn Pit <input type="checkbox"/> Settling Pit <input checked="" type="checkbox"/> Drilling Pit <input type="checkbox"/> Workover Pit <input type="checkbox"/> Haul-Off Pit <small>(If WP Supply API No. or Year Drilled)</small>	Pit is: <input checked="" type="checkbox"/> Proposed <input type="checkbox"/> Existing If Existing, date constructed: _____ Pit capacity: <b>77</b> (bbls)	Sec. <b>32</b> Twp. <b>14</b> R. <b>22</b> <input checked="" type="checkbox"/> East <input type="checkbox"/> West <b>4,448</b> Feet from <input type="checkbox"/> North / <input checked="" type="checkbox"/> South Line of Section <b>382</b> Feet from <input checked="" type="checkbox"/> East / <input type="checkbox"/> West Line of Section <b>Johnson</b> County
Is the pit located in a Sensitive Ground Water Area? <input type="checkbox"/> Yes <input checked="" type="checkbox"/> No		Chloride concentration: _____ mg/l <small>(For Emergency Pits and Settling Pits only)</small>
Is the bottom below ground level? <input checked="" type="checkbox"/> Yes <input type="checkbox"/> No	Artificial Liner? <input type="checkbox"/> Yes <input checked="" type="checkbox"/> No	How is the pit lined if a plastic liner is not used? <b>Native Clay</b>
Pit dimensions (all but working pits): <b>12</b> Length (feet) <b>6</b> Width (feet) <input type="checkbox"/> N/A: Steel Pits Depth from ground level to deepest point: <b>6</b> (feet) <input type="checkbox"/> No Pit		
If the pit is lined give a brief description of the liner material, thickness and installation procedure.		Describe procedures for periodic maintenance and determining liner integrity, including any special monitoring.
Distance to nearest water well within one-mile of pit: <b>4595</b> feet    Depth of water well <b>149</b> feet		Depth to shallowest fresh water <b>150</b> feet. Source of information: <input type="checkbox"/> measured <input checked="" type="checkbox"/> well owner <input type="checkbox"/> electric log <input type="checkbox"/> KDWR
<b>Emergency, Settling and Burn Pits ONLY:</b> Producing Formation: _____ Number of producing wells on lease: _____ Barrels of fluid produced daily: _____ Does the slope from the tank battery allow all spilled fluids to flow into the pit? <input type="checkbox"/> Yes <input type="checkbox"/> No		<b>Drilling, Workover and Haul-Off Pits ONLY:</b> Type of material utilized in drilling/workover: <b>fresh water</b> Number of working pits to be utilized: <b>1</b> Abandonment procedure: <b>air dry and backfill</b> _____ Drill pits must be closed within 365 days of spud date.
I hereby certify that the above statements are true and correct to the best of my knowledge and belief.		
October 14, 2011 Date		 Signature of Applicant or Agent

15-091-23700-0500

**KCC OFFICE USE ONLY**

Liner     Steel Pit     RFAC     RFAS

Date Received: **10-17-11**    Permit Number: \_\_\_\_\_    Permit Date: **10-18-11**    Lease Inspection:  Yes     No

**RECEIVED**

Mail to: KCC - Conservation Division, 130 S. Market - Room 2078, Wichita, Kansas 67202

**OCT 17 2011**

**KCC WICHITA**

Conservation Division  
Finney State Office Building  
130 S. Market, Rm. 2078  
Wichita, KS 67202-3802



Phone: 316-337-6200  
Fax: 316-337-6211  
<http://kcc.ks.gov/>

Sam Brownback, Governor

Mark Sievers, Chairman  
Ward Loyd, Commissioner  
Thomas E. Wright, Commissioner

October 18, 2011

Petroleum Technologies, Inc.  
801 W 47<sup>th</sup> St Ste 412  
Kansas City, MO 64112-1253

RE: Drilling Pit Application  
Reitz Lease Well No. 34i  
NE/4 Sec. 32-14S-22E  
Johnson County, Kansas

Dear Sir or Madam:

District staff has inspected the above referenced location and has determined that the reserve pit shall be constructed **without slots**, the bottom shall be flat and reasonably level, and the free fluids must be removed. The fluids are to be removed from the reserve pit immediately after drilling operations have ceased.

**If production casing is set all completion fluids shall be removed from the working pits daily. NO completion fluids or non-exempt wastes shall be placed in the reserve pit.**

The fluids should be taken to an authorized disposal well. Please call the District Office at (620) 432-2300 when the fluids have been removed. Please file form CDP-5 (August 2004), Exploration and Production Waste Transfer, within 30 days of fluid removal. Conservation division forms are available through our office and on the KCC web site:  
[www.kcc.state.ks.us/conservation/forms](http://www.kcc.state.ks.us/conservation/forms).

**A copy of this letter should be posted in the doghouse along with the approved Intent to Drill.**

If you have any questions or concerns please feel free to contact the undersigned at the above address.

Sincerely,

Kathy Haynes  
Environmental Protection and Remediation Department

cc: File



# PETROLEUM TECHNOLOGIES, INC.

15-091-23700-0000

October 14, 2011

Kansas Corporation Commission  
Conservation Division  
130 S. Market, Room 2078  
Wichita, Kansas 67202

Rick:

Enclosed please find 11 - Notice of Intent to Drill Forms (C-1's), along with all attachments. Also enclosed are copies of the two closest water well records. The water well record for the NE quarter of section 32 does not exist in this quarter section, according to the farmer no well and no house existed on this property. We used the other water well record enclosed as closest water well within one mile.

Sincerely,  
Petroleum Technologies, Inc.

Alan J. Seaton  
President

Enclosures

RECEIVED  
OCT 17 2011  
KCC WICHITA



Doesn't Exist  
in this quarter H.S.

USE TYPEWRITER OR BALL  
POINT PEN-PRESS FIRMLY,  
PRINT CLEARLY.

WATER WELL RECORD  
KSA 82a-1201-1215

Kansas Department of Health and  
Environment-Division of Environment  
(Water well Contractors)  
Topeka, Kansas 66620

1. Location of well:		County Johnson	Fraction SE 1/4 NE 1/4 1/4	Section number 32	Township number T 14 S	Range number R 22 E/W
2. Distance and direction from nearest town or city: IN, 1/2 E. 3/4 N OF EASTSIDE OF Street address of well location if in city: EDGERTON, KS.			3. Owner of well: H.S. ALTMAN R.R. or street: City, state, zip code: EDGERTON, KS 66021			
4. Locate with "X" in section below: Sketch map: N W E SW SE S 1 Mile			<p>PAGE 1 SEPTIC TANK HOUSE WELL COUNTY ROAD</p>		6. Bore hole dia. 6 in. Completion date 5/31/76 Well depth 217 ft.	
5. Type and color of material					7. <input checked="" type="checkbox"/> Cable tool <input type="checkbox"/> Rotary <input type="checkbox"/> Driven <input type="checkbox"/> Dug <input type="checkbox"/> Hollow rod <input type="checkbox"/> Jetted <input type="checkbox"/> Bored <input type="checkbox"/> Reverse rotary	
Soil & Joint Clay 14 0 14			8. Use: <input checked="" type="checkbox"/> Domestic <input type="checkbox"/> Public supply <input type="checkbox"/> Industry <input type="checkbox"/> Irrigation <input type="checkbox"/> Air conditioning <input type="checkbox"/> Stock <input type="checkbox"/> Lawn <input type="checkbox"/> Oil field water <input type="checkbox"/> Other		9. Casing: Material PLTS Height: Above or below Threaded <input type="checkbox"/> Welded <input type="checkbox"/> Surface <input type="checkbox"/> in. RMP <input type="checkbox"/> PVC <input checked="" type="checkbox"/> Weight <input type="checkbox"/> lbs./ft. Dia. 5 in. to 2 1/2 ft. depth Wall Thickness: inches or Dia. <input type="checkbox"/> in. to <input type="checkbox"/> ft. depth gage No.	
Blue Lime 3 14 17			10. Screen: Manufacturer's name JESS + Type PLASTIC Dia. 5 Slot/gauze 1/4 Holes Length 20' Set between 50 ft. and 70 ft. 190 ft. and 210 ft. Gravel pack? <input checked="" type="checkbox"/> Size range of material		11. Static water level: 50 ft. below land surface Date 5/25/76	
Hard Sandy Gray Shale 6 17 23			12. Pumping level below land surfaces: ft. after hrs. pumping g.p.m. ft. after hrs. pumping g.p.m. Estimated maximum yield 170 g.p.m.		13. Water sample submitted: mo./day/yr. Yes <input checked="" type="checkbox"/> No <input type="checkbox"/> Date	
White Lime 22 23 45			14. Well head completion: <input checked="" type="checkbox"/> Pitless adapter <input type="checkbox"/> inches above grade		15. Well grouted? <input checked="" type="checkbox"/> YES With: <input type="checkbox"/> Neat cement <input checked="" type="checkbox"/> Bentonite <input type="checkbox"/> Concrete Depth: From <input type="checkbox"/> ft. to <input type="checkbox"/> ft.	
Black Slale 5 45 50			16. Nearest source of possible contamination: SEPTIC TANK ft. 100' Direction SW Type TANK Well disinfected upon completion? <input checked="" type="checkbox"/> Yes <input type="checkbox"/> No		17. Pump: Manufacturer's name Red Jacket Not installed Model number HP 3/4 Volt 230 Length of drop pipe 212 ft. capacity 5 g.p.m. Type: <input checked="" type="checkbox"/> Submersible <input type="checkbox"/> Turbine <input type="checkbox"/> Jet <input type="checkbox"/> Reciprocating <input type="checkbox"/> Centrifugal <input type="checkbox"/> Other	
Blue Lime- possible water 8 50 58			18. Elevation:		20. Water well contractor's certification: This well was drilled under my jurisdiction and this report is true to the best of my knowledge and belief. NO SWANKWATER WELL DRILL 107 Business Address PRINCETON KS License No. Signed George H. Swank Date 5/31/76 Authorized representative	
Hard Gray Shale 5 58 63			19. Remarks:		Form WWC-5	
Blue Lime 24 63 87			Topography: <input type="checkbox"/> Hill <input checked="" type="checkbox"/> Slope <input type="checkbox"/> Upland <input type="checkbox"/> Valley		RECEIVED OCT 17 2011 KCC WICHITA	
Gray Shale 1 87 88					M1-1023	
Red Shale 5 88 93						
Gray Sand 14 93 107						
Blue Lime 7 107 115						
White Lime 12 115 127						
Gray Shale 15 127 142						
Blue Lime 16 142 158						
Gray Shale 12 158 170 (Use a second sheet if needed)						

Forward the white, blue and pink copies to the Department of Health and Environment

Form WWC-5

RECEIVED

M1-1023

OCT 17 2011

KCC WICHITA



USE TYPEWRITER OR BALL POINT PEN-PRESS FIRMLY, PRINT CLEARLY.

WATER WELL RECORD  
KSA 82a-1201-1215

Kansas Department of Health and Environment-Division of Environment  
(Water well Contractors)  
Topeka, Kansas 66620

1. Location of well:	County	Fraction 1/4 1/4 1/4	Section number	Township number T S R	Range number E/W
2. Distance and direction from nearest town or city: Street address of well location if in city:			3. Owner of well: <b>H.S. Altman</b> R.R. or street: City, state, zip code: <b>Edgerton, Kansas 66021</b>		
4. Locate with "X" in section below: N W E S 1 Mile			Sketch map:  <b>PAGE 2</b>		
5. Type and color of material			From	To	6. Bore hole dia. <u>5 1/4</u> in. Completion date <u>5/30/76</u> Well depth <u>217</u> ft.
White Lime			6	170 176	7. <input checked="" type="checkbox"/> Cable tool <input type="checkbox"/> Rotary <input type="checkbox"/> Driven <input type="checkbox"/> Dug <input type="checkbox"/> Hollow rod <input type="checkbox"/> Jetted <input type="checkbox"/> Bored <input type="checkbox"/> Reverse rotary
Blue Lime			9	176 185	8. Use: <input checked="" type="checkbox"/> Domestic <input type="checkbox"/> Public supply <input type="checkbox"/> Industry <input type="checkbox"/> Irrigation <input type="checkbox"/> Air conditioning <input type="checkbox"/> Stock <input type="checkbox"/> Lawn <input type="checkbox"/> Oil field water <input type="checkbox"/> Other
White Lime			8	185 193	9. Casing: Material _____ Height: Above or below Threaded _____ Welded _____ Surface _____ in. RMP _____ PVC <input checked="" type="checkbox"/> Weight _____ lbs./ft. Dia. <u>5</u> in. to <u>217</u> ft. depth Wall Thickness: inches or Dia. _____ in. to _____ ft. depth (page No. _____)
Gray Shale			8	193 205	10. Screen: Manufacturer's name _____ Type _____ Dia. _____ Slot/gauze _____ Length _____ Set between _____ ft. and _____ ft. Gravel pack? _____ Size range of material _____
White Lime			12	205 217	11. Static water level: _____ mo./day/yr. _____ ft. below land surface Date _____
Gray Shale			217		12. Pumping level below land surfaces: _____ ft. after _____ hrs. pumping _____ g.p.m. _____ ft. after _____ hrs. pumping _____ g.p.m. Estimated maximum yield _____ g.p.m.
					13. Water sample submitted: _____ mo./day/yr. Yes _____ No _____ Date _____
					14. Well head completion: <input checked="" type="checkbox"/> Pileless adapter _____ inches above grade
					15. Well grouted? _____ With: _____ Neat cement <input checked="" type="checkbox"/> Bentonite _____ Concrete Depth: From _____ ft. to _____ ft.
					16. Nearest source of possible contamination: ft. _____ Direction _____ Type _____ Well disinfected upon completion? <input checked="" type="checkbox"/> Yes _____ No _____
					17. Pump: _____ Not installed Manufacturer's name <b>Red Jacket</b> Model number _____ HP _____ Volts _____ Length of drop pipe _____ ft. capacity _____ g.p.m. Type: _____ Submersible _____ Turbine _____ Jet _____ Reciprocating _____ Centrifugal _____ Other
			(Use a second sheet if needed)		
18. Elevation:  Topography: _____ Hill _____ Slope _____ Upland _____ Valley		19. Remarks:		20. Water well contractor's certification: This well was drilled under my jurisdiction and this report is true to the best of my knowledge and belief.  <b>107</b> Business name _____ License No. _____ Address _____ Signed <b>George D. Swartz</b> Date <b>5/31/76</b> Authorized representative	

Forward the white, blue and pink copies to the Department of Health and Environment

Form WWC-5

RECEIVED  
OCT 17 2011  
KCC WICHITA

Conservation Division  
Finney State Office Building  
130 S. Market, Rm. 2078  
Wichita, KS 67202-3802



Phone: 316-337-6200  
Fax: 316-337-6211  
<http://kcc.ks.gov/>

Sam Brownback, Governor

Mark Sievers, Chairman  
Ward Loyd, Commissioner  
Thomas E. Wright, Commissioner

## **NOTICE TO OPERATORS FILING INTENT TO DRILL FOR DISPOSAL OR ENHANCED RECOVERY INJECTION WELLS, (CLASS II INJECTION WELL)**

The attached approved Notice of Intent to Drill indicates the proposed well is to be used for injection. An approved "Intent to Drill" does not approve injection authority as a Class II Injection Well in Kansas.

Before any well is used for injection purposes, the operator must file an application for injection authority in accordance with K.A.R. 82-3-401 and provide notice in accordance with K.A.R. 82-3-402. The Conservation Division must issue a written permit granting the application before commencement of injection.

The Conservation Division requirements and restrictions associated with Class II Injection are identified in **K.A.R. 82-3-400 et seq** of our regulations. Associated regulations governing drilling, completion and injection applications may be found in K.A.R. 82-3-135, Table I, Table II, in the Cedar Hills Sandstone Moratorium, (Docket #156,397-C), and the Eastern Kansas Surface Casing Order, (Docket #133,891-C).

If you have questions regarding the approval of injection authority, an injection application may be filed as a "Design Approval" before actual drilling and completion of the well occurs. If you have any questions or concerns regarding Class II injection wells or regulations, call the Underground Injection Control Department at 316-337-6200.

Failure to obtain commission approval before beginning injection is punishable by a penalty, shut-in of the well or both.