

STATE CORPORATION COMMISSION OF KANSAS
OIL & GAS CONSERVATION DIVISION
WELL COMPLETION OR RECOMPLETION FORM
ACO-1 WELL HISTORY
DESCRIPTION OF WELL AND LEASE

API NO. 15-171-20,358-0000
County Scott
East
N/2 NW NW Sec. 6 Twp 20 Rge. 32 x West

Operator: License # 5210
Name Lebsack Oil Productions
Address Box 489
City/State/Zip Hays, KS 67601

4950 Ft North from Southeast Corner of Section
4620 Ft West from Southeast Corner of Section
(Note: Locate well in section plat below)

Purchaser
Operator Contact Person Jack L. Partridge
Phone 316 262-1841

Lease Name Stucky
Field Name

Contractor: License # 5422
Name Abercrombie Drilling, Inc.
Wellsite Geologist Wayne Lebsack
Phone 316-938-2396

Producing Formation
Elevation: Ground 2930 KB 2935

Designate Type of Completion
 New Well Re-Entry Workover
 Oil SWD Temp Abd
 Gas Inj Delayed Comp.
 Dry Other (Core, Water Supply etc.)
If ONWO: old well info as follows:
Operator
Well Name
Comp. Date Old Total Depth

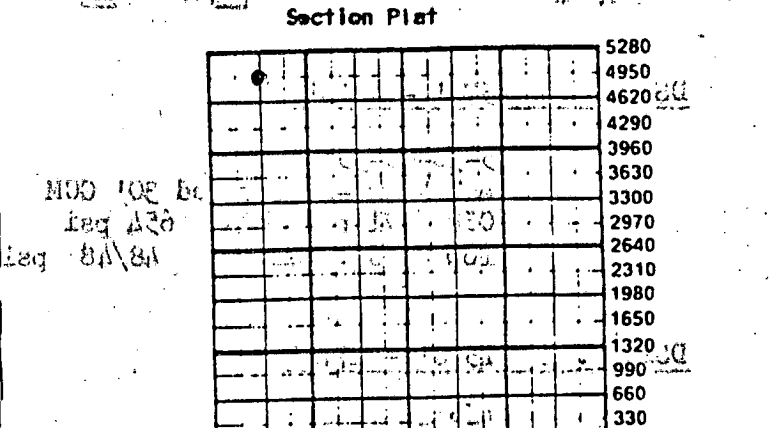

WATER SUPPLY INFORMATION
Disposition of Produced Water: Disposal
Docket # Repressuring

WELL HISTORY

Drilling Method: Mud Rotary Air Rotary Cable
7-7-87 7-15-87 7-15-87
Spud Date Date Reached TD Completion Date
4770'
Total Depth PBD
Amount of Surface Pipe Set and Cemented at 373 feet
Multiple Stage Cementing Collar Used? Yes No
If yes, show depth set feet
If alternate 2 completion, cement circulated from feet depth to w/ SX cmt
Cement Company Name
Invoice #

Questions on this portion of the ACO-1 call:
Water Resources Board (913) 296-3717
Source of Water:
Division of Water Resources Permit #
 Groundwater 4950 Ft North from Southeast Corner
(Well) 4745 Ft West from Southeast Corner of
Sec 6 Twp 20 Rge 32 East x West
Surface Water Ft North from Southeast Corner
(Stream, pond etc) Ft West from Southeast Corner
Sec Twp Rge East West
Other (explain)
(purchased from city, R.W.D. #)

INSTRUCTIONS: This form shall be completed in triplicate and filed with the Kansas Corporation Commission, 200 Colorado Derby Building, Wichita, Kansas 67202, within 120 days of the spud date of any well. Rule 82-3-130, 82-3-107 and 82-3-106 apply. Information on side two of this form will be held confidential for a period of 12 months if requested in writing and submitted with the form. See rule 82-3-107 for confidentiality in excess of 12 months. One copy of all wireline logs and drillers time log shall be attached with this form. Submit CP-4 form with all plugged wells. Submit CP-111 form with all temporarily abandoned wells.

All requirements of the statutes, rules and regulations promulgated to regulate the oil and gas industry have been fully complied with and the statements herein are complete and correct to the best of my knowledge.

Signature Bert Soderblom
Title Agent Date 7/31/87

Subscribed and sworn to before me this 31 day of July 1987
Notary Public D. Rex Curtis
Date Commission Expires

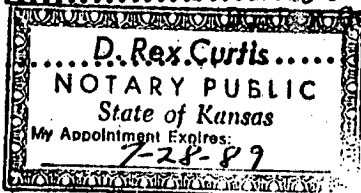

K.C.C. OFFICE USE ONLY
Letter of Confidentiality Attached
 Wireline Log Received
 Drillers Timelog Received
Distribution
 KCC RECEIVED SWD/Rep
STATE CORPORATION COMMISSION NGPA
Other (Specify)
AUG 3 1987
8-3-87
CONSERVATION DIVISION
Wichita, Kansas ACO-1 (5-86)

Sec 6 Twp 20 Rge 32

Operator Name Walsack Oil Productions Lease Name Stucky Well # 1-6

Sec. 6 Twp. 20S Rge. 32 East West County Scott

WELL LOG

INSTRUCTIONS: Show important tops and base of formations penetrated. Detail all cores. Report all drill stem tests giving interval tested, time tool open and closed, flowing and shut-in pressures, whether shut-in pressure reached static level, hydrostatic pressures, bottom hole temperature, fluid recovery, and flow rates if gas to surface during test. Attach extra sheet if more space is needed. Attach copy of log.

Drill Stem Tests Taken Yes No
 Samples Sent to Geological Survey Yes No
 Cores Taken Yes No

DST NO 1 4570' - 4610'

15-30-60-30

Weak blow - recovered 30' GCM
 ICIP 871 psi FCIP 654 psi
 Flow Press: 42/48 48/48 psi

DST NO. 2 4576' - 4770'

15-30-30-30

Weak blow - recovered 35' DM
 ICIP 771 psi FCIP 545 psi
 Flow Press: 116/122 132/132 psi

Formation Description

Name	Top	Bottom
Anhydrite	2170	2184
Krider	2656	
Topeka	3440	
Heebner	3851	
Lansing	3894	
Base of K.G.	4309	
Marmaton	4330	
Cherokee	4453	
Morrow Shale	4589	
Morrow Sand	4602	4655
Mississippi (Ste. Genevieve)	4655	

CASING RECORD New Used

Report all strings set-conductor, surface, intermediate, production, etc.

Purpose of String	Size Hole Drilled	Size Casing Set (In O.D.)	Weight Lbs/Ft.	Setting Depth	Type of Cement	#Sacks Used	Percent Additives
Surface	12 1/4"	8-5/8"	20#	373'	Common	230	3% AC

PERFORATION RECORD

Acid, Fracture, Shot, Cement, Squeeze Record

Shots Per Foot	Specify Footage of Each Interval Perforated	(Amount and Kind of Material Used)	Depth

TUBING RECORD Size Set At Packer at Liner Run Yes No

Date of First Production Producing Method Flowing Pumping Gas Lift Other (explain)

Estimated Production Per 24 Hours	Oil Bbls	Gas MCF	Water Bbls	Gas-Oil Ratio	Gravity

METHOD OF COMPLETION

Production Interval

Disposition of gas: Vented Sold Used on Lease
 Open Hole Perforation Other (Specify)

