

ORIGINAL

SIDE ONE

STATE CORPORATION COMMISSION OF KANSAS
OIL & GAS CONSERVATION DIVISION
WELL COMPLETION OR RECOMPLETION FORM
ACO-1 WELL HISTORY
DESCRIPTION OF WELL AND LEASE

API NO. 15-109-20,477-0000 JAN 29 1991
County Logan FROM CONFIDENTIAL
SE SE NE 29 15 35 East
..... Sec. Twp. Rge. X West

Operator: License # 5140
Name Frontier Oil Company
Address 125 N. Market, Ste. 1720
City/State/Zip Wichita, Kansas 67202

2970
330 Ft North from Southeast Corner of Section
..... Ft West from Southeast Corner of Section
(Note: Locate well in section plat below)

Purchaser National Cooperative Refinery Assn.
McPherson, Kansas

Lease Name Linder Well # J
Field Name Dirks

Operator Contact Person Jean Angle
Phone 316-263-1201

Producing Formation Lansing Kansas City
Elevation: Ground 3208 KB 3213

Contractor: License # 5302
Name Red Tiger Drilling Company

Wellsite Geologist Richard D. Parker
Phone 913-483-5348

Designate Type of Completion
 New Well Re-Entry Workover

Oil SWD Temp Abd
 Gas Inj Delayed Comp.
 Dry Other (Core, Water Supply etc.)

If ONWO: old well info as follows:
Operator
Well Name
Comp. Date Old Total Depth

STATE CORPORATION COMMISSION
RECEIVED
OCT 10 1989
10-10-89
CONSERVATION DIVISION
Wichita, Kansas
OCT 12 1989
KANSAS GEOLOGICAL SURVEY
WICHITA BRANCH

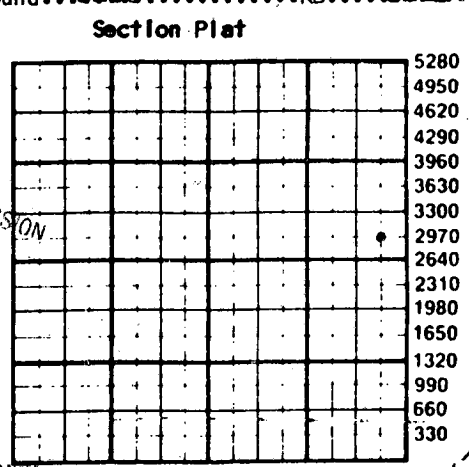

WATER SUPPLY INFORMATION
Disposition of Produced Water: Disposal
Docket # Repressuring

Questions on this portion of the ACO-1 call:
Water Resources Board (913) 296-3717
Source of Water: N/A
Division of Water Resources Permit #
 Groundwater.....Ft North from Southeast Corner
(Well)Ft West from Southeast Corner of
Sec Twp Rge East West
 Surface Water 3200 Ft North from Southeast Corner
.....Ft West from Southeast Corner
60-40poz Sec 7 Twp 16 Rge 35W East X West
3% CC
Other (explain)
(purchased from city, R.W.D. #)

WELL HISTORY

Drilling Method:
 Mud Rotary Air Rotary Cable

7-29-89 Spud Date 8-16-89 Date Reached TD 9-26-89 Completion Date
4740 Total Depth 3850 PBDT

Amount of Surface Pipe Set and Cemented at 374 feet
Multiple Stage Cementing Collar Used? Yes No
If yes, show depth set
If alternate 2 completion, cement circulated 500 sx
from 2490 feet depth to 310' w/75' SX cmt com, 3% CC
Cement Company Name Allied Cementing Co., Inc.
Invoice # 7700 (TICKET ATTACHED)
(Alt. II Cementing approved by Don Butcher)

INSTRUCTIONS: This form shall be completed in triplicate and filed with the Kansas Corporation Commission, 200 Colorado Derby Building, Wichita, Kansas 67202, within 120 days of the spud date of any well. Rule 82-3-130, 82-3-107 and 82-3-106 apply. Information on side two of this form will be held confidential for a period of 12 months if requested in writing and submitted with the form. See rule 82-3-107 for confidentiality in excess of 12 months. One copy of all wireline logs and drillers time log shall be attached with this form. Submit CP-4 form with all plugged wells. Submit CP-111 form with all temporarily abandoned wells.

All requirements of the statutes, rules and regulations promulgated to regulate the oil and gas industry have been fully complied with and the statements herein are complete and correct to the best of my knowledge.

Signature Jean Angle
Agent
Title Date Oct 5, 1989

Subscribed and sworn to before me this 5th day of October, 1989
Notary Public D'Ann Drennan
Date Completion Expires 2-10-90

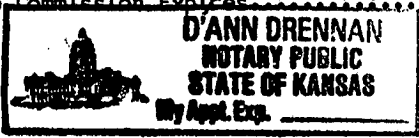

K.C.C. OFFICE USE ONLY
 Letter of Confidentiality Attached
 Wireline Log Received
 Drillers Time Log Received
Distribution
 KCC SWD/Rep NGPA
 KGS Plug Other (Specify)
NP 1902

Sec. Twp. Rge.

Operator Name Frontier Oil Company Lease Name Linder Well #

Sec 29 Twp 15S Rge 35W County Logan

CONFIDENTIAL

RELEASED

WELL LOG

JAN 20 1991

INSTRUCTIONS: Show important tops and base of formations penetrated. Detail all cores. Report all drill stem tests giving interval tested, time tool open and closed, flowing and shut-in pressures, whether shut-in pressure reached static level, hydrostatic pressures, bottom hole temperature, fluid recovery, and flow rates if gas to surface during test. Attach extra sheet if more space is needed. Attach copy of log.

Drill Stem Tests Taken [X] Yes [] No
Samples Sent to Geological Survey [] Yes [X] No
Cores Taken [] Yes [X] No
DST #1 (3932-76) 60-30-60-30 Rec. 5' OCM, 200' WM
160' W IF 50-121 FF 142-213 ISIP 1021 FSIP 976
DST #2 (3972-4000) Strong blo TO. Rec. 983" GO
366' OCWM IF 91-168 FF 598-800 ISIP 1037
FSIP 1043
DST #3 (3999-4030) 60-30-60-30 Rec. 120' WM, 1227'
W, IF 101-578 FF 613-790 ISIP & FSIP 1032
DST #4 (4034-4060) 60-30-60-30 Rec. 10' O, 795'
OCMW, 1193' MW IF 131-151 FF 508-753 ISIP 1055
FSIP 1050
DST #5 (4060-80) 30-30-30-30 REC. 20' M IF 30-30
FF 40-40 ISIP 81 FSIP 60
DST #6 (4060-96) 60-30-60-30 REC. 2068' W W/4% O.
IF 172-760 FF 810-1013 ISIP 7 FSIP 1153
DST #7 (4240-4350) 60-30-60-30 STR BLO TO (CONT'D)

Formation Description table with columns: Name, Top, Bottom. Rows include ANHYDRITE, TOPEKA, HEEBNER, TORONTO, LANSING-KANSAS CITY, BASE OF KANSAS CITY, MARMATON, PAWNEE, FORT SCOTT, CHEROKEE SHALE, MORROW, MISSISSIPPIAN, RTD.

CASING RECORD [] New [] Used
Report all strings set-conductor, surface, intermediate, production, etc.

Table with 8 columns: Purpose of String, Size Hole Drilled, Size Casing Set (in O.D.), Weight Lbs/Ft., Setting Depth, Type of Cement, #Sacks Used, Type and Percent Additives. Rows for SURFACE and PRODUCTION.

PERFORATION RECORD table with columns: Shots Per Foot, Specify Footage of Each Interval Perforated, Acid, Fracture, Shot, Cement Squeeze Record (Amount and Kind of Material Used), Depth. Row for 4 shots at 3982-6' Natural.

TUBING RECORD table with columns: Size, Set At, Packer at, Liner Run. Values: 2-3/8", 4033, N/A, N/A.

Date of First Production 9-26-89 Producing Method [] Flowing [X] Pumping [] Gas Lift [] Other (explain)

Table with 6 columns: Oil, Gas, Water, Gas-Oil Ratio, Gravity. Values: 78 BOPD, N/A, 47 BWPD, N/A, 27.

METHOD OF COMPLETION Production Interval

Disposition of gas: [] Vented [] Sold [] Used on Lease [] Open Hole [X] Perforation [] Other (Specify) ... 3982-6' [] Dually Completed [] Commingled

ORIGINAL

SIDE TWO (Page Two)

ACO-1 WELL HISTORY

OPERATOR FRONTIER OIL COMPANY

LEASE NAME LINDER

* 1 SEC. 29 TWP. 15 RGE. 35W

FILL IN WELL LOG AS REQUIRED:

Show all important zones of porosity and contents thereof; cored intervals, and all drill-stem tests, including depth interval tested, cushion used, time tool open, flowing and shut-in pressures, and recoveries.

SHOW GEOLOGICAL MARKERS, LOGS RUN, OR OTHER DESCRIPTIVE INFORMATION.

FORMATION DESCRIPTION, CONTENTS, ETC.	TOP	BOTTOM	NAME	DEPTH
DST #7 (CONTINUED) REC. 2165' FL. - 180' SOCM, 985' OCWM, 1000' W IF 223-901 FF 941-1113 ISIP & FSIP 1214			RELEASED	
DST #8 (4396-4417) 30-45-30-45 REC. 1' FREE O, 4' MCO IF & FF 50-50 ISIP 101 FSIP 71			JAN 29 1991	
DST #9 (4208-4234) MIS-RUN PKR FAILURE			FROM CONFIDENTIAL	

RECEIVED
STAFF CORPORATION COMMISSION

OCT 10 1989

CONSERVATION DIVISION
Wichita, Kansas

OCT 12 1989

KANSAS GEOLOGICAL SURVEY
WICHITA BRANCH

ORIGINAL

KCC

JAN 11 1991

CONFIDENTIAL

RELEASED

JAN 29 1991

FROM CONFIDENTIAL

GEOLOGICAL REPORT

FRONTIER OIL COMPANY

NO. 1 LINDER

SE. SE. NE 29-15S. 35W

LOGAN COUNTY, KANSAS

DATE COMMENCED: July 29, 1989

DATE OF RTO: August 15, 1989

CONFIDENTIAL

GEOLOGIST

RICHARD D. PARKER

RECEIVED
STATE CORPORATION COMMISSION

OCT 10 1989

CONSERVATION DIVISION
Wichita, Kansas

ORIGINAL

Frontier Oil Company
1720 N. 5. 29. 7 Bldg.
Wichita, Kansas 67202

Re: Frontier Oil Company
No. 1 Linder
SE 29-155-35W
Logan County, Kansas

Dear Sir:

The following is a Geological Report, with a Time Log attached, on the above captioned well.

Drilling was suspended from 3500' to 4740', rotary total depth. Samples were examined from 3500' to rotary total depth.

All formation tops, zones of porosity and staining are based on rotary logging measurements. Any corrections in measurements during the drilling of this well have been incorporated into this report.

Elevation American Elevators

3210 RF - 3213 KB

	SAMPLE TOPS	LOG TOPS
Anhydrite	2475	4738
Topeka	3700 - 487	3706 - 493
Hecbrec	3934 - 721	3934 - 721
Toronto	3954 - 741	3954 - 741
Lansing-Kansas City	3978 - 765	3982 - 769
Base of Kansas City	4368 - 1155	4373 - 1160
Marmaton	4388 - 1175	4388 - 1175
Pewee	4451 - 1238	4451 - 1238
Fort Scott	4506 - 1293	4506 - 1293
Charlton Shale	4533 - 1320	4534 - 1321

ORIGINAL

Marconi	4676 - 1463	4664 - 1451
Mississippi	4716 - 1503	4718 - 1505
RTD	4740 - 1527	4743 - 1530
4 1/2" Pipe A	4492 - 1279	

Structurally, on top of the Texaco the No. 1 Linde
 run the No. 1 Linde run 1' low to the Texaco Dicks No. 1,
 a Marston producer, located one location South. On
 top of the Texaco the No. 1 Linde run 2' low to the
 No. 1 Dicks. On top of the Lansing the No. 1 Linde run
 2' low to the Dicks No. 1. On top of the Marston the
 Linde No. 1 run 2' high to the Dicks No. 1. On top
 of the East Scott the Linde No. 1 run 1' high to
 the Dicks No. 1. On top of the Marston the Linde No. 1
 run 3' low to the Dicks No. 1. On top of the
 Mississippi the Linde run 3' low to the Dicks No. 1

ORIGINAL

ZONES OF INTEREST

TOPENA (Top 3700)

3700 to 3708

White fine crystalline
to slightly waxy lime
with fair regular porosity
no staining

3844 to 3852

White fine crystalline
to chalky lime with
spotted dark ferr stain.

3908 to 3916

White fine crystalline
to chalky lime with
traces of free ferr. oil.
no odor, spotted dark stain

ORIGINAL

TORONTO (Top 3954)

3954 to 3960

white fossiliferous
to waxy lime with
fair fossiliferous porosity,
fair show of free oil,
fair spotted light stain.

DRILL. STEM TEST NO. 1 (WESTERN TESTING)

3932 to 3976

60-30-60-30

First open fair increasing
to good. Second gain
fair increasing to good.
Recovered 5' mud cut oil,
200' waxy mud, 100'
water. Initial flows 50 to 121.
Final flows 142 to 213.
Initial shot in pressure 1012#.
Final shot in pressure 996#.

3980 to 3985

white oolitic lime
with good intr-oolitic
porosity, fair show of
free oil, good odor,
good spotted stain.

ORIGINAL

DRILL STEM TEST NO. 2 (WESTERN TESTING)

3972 to 4000

First open string blow
Second open string blow
Recovered 983' gassy oil,
366' oil cut water mud,
180' muddy water.
Initial flow 91 to 108
Final flow 598 to 800
Initial shut in pressure 1037.
Final shut in pressure 1043.

4018 to 4028

White, cherty to dense
slightly waxy lime
with fair porosity and
irregular porosity. Trace
of free oil, very faint color
trace of iron.

OCT 12 1989
KANSAS GEOLOGICAL SURVEY
WICHITA BRANCH

DRILL STEM TEST NO. 3 (WESTERN TESTING)

3999 to 4030

60-30-60-30
First open string blow,
Second open string blow.
Recovered 120' water mud
1227' water.
Initial flows 101 to 578

ORIGINAL

4039 to 4049

White chalky to
dense slightly
waxy lime with a
fair to good show
of free oil, strong
odor and good spotted
stain.

DRILL STEM TEST NO. 4 (WESTERN TESTING)

4034 to 4060

60-30-60-30

First open string blow
Second open string blow.
Recovered 10' oil, 795'
oil cut muddy water,
1193' muddy water
Initial flows 131 to 151
Final flows 508 to 753
Initial shut in pressure 1055#.
Final shut in pressure 1050#.

4074 to 4080

White fine crystalline
to dense lime with
fair waxy porosity,
fair show of free oil
fair odor, spotted

ORIGINAL

DRILL STEM TEST NO. 5 (WESTERN TESTING)

4060 to 4080

30-30-30-30

First open work blow.

Second open work blow.

Recovery 20' mud.

Initial flow 30 to 30

Final flow 40 to 40

Initial shut in pressure 81.

Final shut in pressure 60.

4082 to 4092

Ten to white cherty
to fine crystalline
to dense lime with
fine wavy to pin
point porosity, few
show of oil, fair color
spotted light stain.

DRILL STEM TEST NO. 6 (WESTERN TESTING)

4060 to 4096

60-30-60-30

First open string blow

Second open string blow

Recovery 20' mud

water with 490 oil.

Initial flow 192 to 760

ORIGINAL

4110 to 4122

white sucrose to
fine crystalline Solanum
lime with a faint odor
trace black berry oil, trace
of stain.

4159 to 4163

white chalky to dense
slightly waxy lime with
traces of black berry oil,
no odor traces black stain.

4196 to 4202

white chalky to fine
crystalline lime with
no show no odor.

4216 to 4226

white chalky to
well developed columbic
lime with a good show
of tree oil, good odor
and good dark oil stain.

ORIGINAL

4258 to 4266

Can not tell it
samples are from same
White cherty to partly
developed calcareous limestone
Poor show of oil, but
show trace of steam.
(Included in DST #7)

4306 to 4312

White cherty to
slightly calcareous limestone
Some show to sandy
limestone with trace of
free oil, few show
trace steam
(Included in DST #7)

4332 to 4338

White cherty to
limestone with
traces of free oil
but no trace steam

ORIGINAL

DAILY STEAM TEST NO. 7 (WESTERN TESTING)

4240 to 4350

60-30-60-30

First open string blow
Second open string blow.
Recovered 216.5' fluid
consisting of: 180' slightly
oil cut mud, 98.5' oil
cut water mud, 1000'
water. Initial flows
223 to 901. Final flows
944 to 1113. Initial
shut in pressure 1214.
Final shut in pressure 1214.

MARATHON (Top 4388)

4388 to 4400

Tan fine crystalline
to fossiliferous lime
slightly cherty with
no show of oil and
no color.

4404 to 4412

Tan fine crystalline
to sacrosic lime
with scattered extremely
light show of oil,
no color, and spotted

ORIGINAL

DRIILL STEM TEST NO. 8 (WESTERN TESTING)

4396 to 4417

30-45-30-45

First open unk blow
for 10 minutes.

Second open no blow
flashed tool no help.

Recoverd 1' of free
oil, 4' mud cut oil.

Initial flow 50 to 50

Final flow 50 to 50

Initial shut in pressure 101#

Final shut in pressure 71#.

PAWNEE (Top 4451)

4451 to 4460

White to tan drilly
to fine crystalline
lime with no show

POST SCOTT (Top 4506)

4506 to 4533

Tan to brown
crystine to fossiliferous
lime with no show,
no odor.

ORIGINAL

MISSISSIPPI (Top 4676)

4676 to 4708

light green and yellow
slightly sandy shale.
No show No odor.

MISSISSIPPI (Top 4916)

4916 to 4940

White extremely
sandy lime with
no show of oil
and no odor.

DRILL STEM TEST NO. 9

4208 to 4234

WESTERN (STRADDLE)

Miss. Pan.
Rocky Fath.

ORIGINAL

4 1/2" used 10'2" casing was set at
4492' with 225 sacks common cement
10% added salt and 5% gilsonite. The
shoe joint is 26-00' long and zero point
is 5' AGL.

Sincerely,

Richard D. Parker

Richard D. Parker

ORIGINAL

ORIGINAL

DRILLING INFORMATION ON THE NO. 1 LINDER

Drilling Company: Red Tiger Drilling Co.
Tool Pushers: Pat Wagoner & Kenneth Lyle

Drillers: Drilling
Lyle
Sherlock

Spud Date: July 29, 1989 Break at RTD: August 15, 1989
Surface Pipe: 8 3/8" @ 374' / 210sx Casing: 4 1/2" @ 4492' / 225sx

TOTAL FOOTAGE DRILLED PER DAY

Under Surface RT 2:38 AM on July 30, 1989

700	Feet	At	7:00 AM	ON	7-30-89
1200	"	"	"	"	7-31-89
2157	"	"	"	"	8-1-89
2942	"	"	"	"	8-2-89
3080	"	"	"	"	8-3-89
3443	"	"	"	"	8-4-89
3834	"	"	"	"	8-5-89
3976	"	"	"	"	8-6-89
4000	"	"	"	"	8-7-89
4030	"	"	"	"	8-8-89
4076	"	"	"	"	8-9-89
4096	"	"	"	"	8-10-89
4260	"	"	"	"	8-11-89
4350	"	"	"	"	8-12-89

ORIGINAL

BIT RECORD

<u>Bits</u>	<u>Type</u>	<u>Footage</u>
No. 1	Smith-Fox	580 to 2805
No. 2	CP-527-B	2805 to 2885
No. 3	CP-537-CM	2885 to 4040

MUD RECORD

MUD COMPANY: Mud Service Inc. Mud Type: CHEMICAL DISPAC

- Surface: 30 sz gal, 5 sz balls, 1 1/2 sz lime
 1943 - (Premix) 20 sz gal
 2585 - 90 sz gal, 5 sz cement, 5 sz soda ash, 7 1/2 sz lignite
 2985 - 3 1/2 sz gal, 1 sz cement, 2 sz soda ash, 1 1/2 sz lignite
 3340 - 53 sz gal, 2 sz cement, 1 sz soda ash, 2 1/2 sz lignite
 3695 - 13 sz gal, 4 sz cement, 3 sz lignite, 1 sz dispac
 3976 - 2 sz cement, 2 sz lignite, 2 sz dispac
 4000 - 2 sz cement, 2 sz lignite, 1/2 sz dispac
 4030 - 20 sz gal, 1 sz cement, 1 sz lignite, 2 sz soda ash
 4060 - 2 sz gal, 1 sz cement, 1 sz lignite, 1 sz soda ash, 1 sz dispac
 4090 - 1 sz cement, 1 sz lignite, 1 sz soda ash
 4200 - 20 sz gal, 1 sz cement, 1 sz lignite, 1 sz soda ash, 1/2 sz dispac

ALLIED CEMENTING CO., INC.

No 7700

Home Office P. O. Box 31

Russell, Kansas 67665

New

ORIGINAL

Date	9-18-89	Sec.	29	Twp.	15S	Range	35W	Called Out	On Location	Job Start	3:00 PM	Finish	7:45 PM
Lease	Linder	Well No.	1	Location	Russell Springs 12S 3W			County	Logan	State	KS		
Contractor	Leons Cable Tools												
Type Job	Squeez (circulate cement)												
Hole Size		T.D.											
Csg.	1/2	Depth											
Tbg. Size	2"	Depth											
Drill Pipe		Depth											
Tool	Brad Oil	Depth	2433										
Cement Left in Csg.		Shoe Joint											
Press Max.		Minimum											
Meas Line		Displace											
Perf.	2490-91												

Owner: *Les Wis*
 To Allied Cementing Co., Inc.
 You are hereby requested to rent cementing equipment and furnish cementer and helper to assist owner or contractor to do work as listed.

RELEASED

SEP 20 1989

Charge To: *Frontier Oil*
 Street: *1437 N. Franklin*
 City: *Russell* State: *Kan 67665*
 The above was done to satisfaction and supervision of owner agent or contractor

FROM CONFIDENTIAL

Purchase Order No. *[Signature]*
 X *[Signature]*

EQUIPMENT

No.	Cementer	<i>Dave</i>
Pumptrk 153	Helper	<i>gerald</i>
No.	Cementer	
Pumptrk 156	Helper	
Bulktrk 155	Driver	<i>ed</i>
Bulktrk 155	Driver	<i>Steve</i>

CEMENT

Amount Ordered: *500 40 6 1/2 gal 75 cam 3 1/2 cc*

Consisting of			
Common	375	SKs @ 5.85	2,193.75
Poz. Mix	200	SKs @ 2.35	470.00
Gel.	26	SKs @ 6.75	175.50
Chloride	2	SKs @ 20.00	40.00
Quickset			

DEPTH of Job

Reference:	<i>Pump tik chg</i>	<i>450.00</i>
	<i>100 per mile</i>	<i>44.00</i>
	Sub Total	
	Tax	
	Total	<i>494.00</i>

Handling	<i>90¢</i>	Sales Tax	
Mileage	<i>3¢</i>		
	<i>44 mil</i>		
		Sub Total	<i>517.50</i>
		Total	<i>759.00</i>
			<i>4,155.75</i>

RECEIVED
 STATE CORPORATE COMMISSION
 OCT 10 1989
 CONSERVATION DIVISION
 Wichita, Kansas

Remarks: *Plug @ 3850 tested @ 1500 PSI set packer @ 2433 Injection Rate @ 4881 Per min @ 500 PSI had good circ, mixed 500sk + 75 cam 3% squeezed @ 1250 PSI cleared tubing & rechecked @ 1250 PSI pulled tubing loaded hole & shut in @ 500 PSI*

ALLIED CEMENTING CO., INC.

No. 6658

Home Office P. O. Box 31

Russell, Kansas 67665

ORIGINAL

New

Date	7-29-89	Sec.	29	Twp.	15	Range	35	Called Out	11:45 AM	On Location	3:30 P.M.	Job Start	5:45 P.M.	Finish	6:15 P.M.
Lease	Under	Well No.	1	Location	Spongs 155-3W-135			County	Logan	State	KS				
Contractor	Red Tiger														
Type Job	Surface														
Hole Size	12 1/4		T.D.	380'											
Csg.	7 5/8" (20')		Depth	378'											
Tbg. Size			Depth												
Drill Pipe			Depth												
Tool			Depth												
Cement Left in Csg.	15'		Shoe Joint												
Press Max.			Minimum												
Meas Line			Displace	23.6											
Perf.															

Owner Same

To Allied Cementing Co., Inc.
 You are hereby requested to rent cementing equipment and furnish cementer and helper to assist owner or contractor to do work as listed.

Charge To Frontier Oil

Street 1437 N Franklin

City Russell State Kan 67666

The above was done to satisfaction and supervision of owner agent or contractor

Purchase Order No. Club Seneca

CEMENT

Amount Ordered	210 60/40223	
Consisting of		
Common	126 @ 6.00	756.00
Poz. Mix	84 @ 2.50	210.00
Gel.	4 @ 67.50	270.00
Chloride	6 @ 20.00	120.00
Quickset	RELEASED	

JAN 29 1991

Handling	FROM CONFIDENTIAL	90	189.00
Mileage	44	0.3	272.2
		Sub Total	1570
		Total	

EQUIPMENT

Pumptrk	No. 46	Cementer	Mike
		Helper	Gary
Pumptrk	No.	Cementer	
		Helper	
Bulktrk	199	Driver	Stewart
Bulktrk		Driver	

DEPTH of Job

Reference:	Pump Jct Chg	360.00
	Pump Jct Mileage	44.00
	TWP	40.00
	78' at 37'	30.42
	Total	444.00

Remarks: Cement Did Circulate

7 Sks Cement

Thank you

Floating Equipment

Bid

ALLIED CEMENTING CO., INC.

No. 6658

Home Office P. O. Box 31

Russell, Kansas 67665

New

ORIGINAL

Date	7-29-89	Sec.	29	Twp.	15	Range	35	Called Out	11:45 AM	On Location	3:30 P.M.	Job Start	5:45 P.M.	Finish	6:15 P.M.
Lease	Under	Well No.	1	Location	Russell Springs 15-30-15			County	Logan	State	KS				
Contractor	Red Tiger														
Type Job	Surface														
Hole Size	12 1/4		T.D. 380'												
Csg.	P5 (20')		Depth 378'												
Tbg. Size			Depth												
Drill Pipe			Depth												
Tool			Depth												
Cement Left in Csg.	15'		Shoe Joint												
Press Max.			Minimum												
Meas Line			Displace 23.6												
Perf.															

Owner Same

To Allied Cementing Co., Inc.
You are hereby requested to rent cementing equipment and furnish cementer and helper to assist owner or contractor to do work as listed.

Charge To Frontier Oil

Street 1437 N Franklin

City Russell State Kan 6766

The above was done to satisfaction and supervision of owner agent or contractor

Purchase Order No. Club Seneca

CEMENT

Amount Ordered	210 60/40223	
Consisting of	756.00	
Common	126 e.g.	126.00
Poz. Mix	84	240 20.60
Gel.	4	675 27.00
Chloride	6	20.00 120.00
Quickset	STATE COMMISSION RECEIVED	
Handling	90	189.00
Mileage	44	272.00
Sales Tax	03	15.70
Sub Total	1570	
Total	1570	

EQUIPMENT

Pumptrk	No.	Cementer	Mike
	46	Helper	
Pumptrk	No.	Cementer	Stewart
		Helper	
		Driver	
Bulktrk	199	Driver	

DEPTH of Job

Reference:	Pump Gel Charge	360.00
	Pump Gel Mileage	44.00
	TWP	40.00
	78' at 37'	30.00
	Total	444.00

Remarks: Cement Did Circulate

7 Sks Cement

Thank you

Floating Equipment

FROM CONFIDENTIAL

DATE 2 9 1991

Wichita, Kansas

RELEASED

10 1 0 1989

Brid

ALLIED CEMENTING CO., INC.

No. 6658

Home Office P. O. Box 31 ORIGINAL Russell, Kansas 67665

New

Date	7-29-89	Sec.	29	Twp.	15	Range	35	Called Out	11:45 AM	On Location	3:30 P.M.	Job Start	5:45 P.M.	Finish	6:15 P.M.
Lease	Under	Well No.	1	Location	Russell Springs 15-30-15			County	Logan	State	KS				
Contractor	Red Tiger														
Type Job	Surface														
Hole Size	12 1/4"		T.D. 380'												
Csg.	PS (20')		Depth 378'												
Tbg. Size			Depth												
Drill Pipe			Depth												
Tool			Depth												
Cement Left in Csg.	15'		Shoe Joint												
Press Max.			Minimum												
Meas Line			Displace 23.6												
Perf.															

EQUIPMENT

Pumptrk	No. 46	Cementer	Mike
		Helper	Gary
Pumptrk	No.	Cementer	
		Helper	
Bulktrk	199	Driver	Stewart
Bulktrk		Driver	

DEPTH of Job

Reference:	Pump Trk Charge	360.00
	Pump Trk Mileage	44.00
	TWP	40.00
	78' at 378'	30.00
	Total	444.00

Remarks: Cement Did Circulate
7 Sks Cement
Thank you

Owner: Same

To Allied Cementing Co., Inc. You are hereby requested to rent cementing equipment and furnish cementer and helper to assist owner or contractor to do work as listed.

Charge To: Frontier Oil

Street: 1437 N Franklin

City: Russell State: Kan 67666

The above was done to satisfaction and supervision of owner agent or contractor

Purchase Order No. X Club Seneca

CEMENT

Amount Ordered: 210 60/40 223

Consisting of		756.00
Common	126 e.6"	
Poz. Mix	84	240 20.60
Gel.	4	675 27.00
Chloride	6	20.00 120.00
Quickset		
Handling	RELEASED	90 189.00
Mileage	44	03 272.00
		Sub Total 1570
	FROM COMPANY	Total

Floating Equipment

Bid

Phone 316-793-5861, Great Bend, Kansas

New
ALLIED CEMENTING CO., INC. No. 7692
Home Office P. O. Box 31 **ORIGINAL** Russell, Kansas 67665

Date	Sec.	Twp.	Range	Called Out	On Location	Job Start	Finish
8-17-89	29	15	35		SW 1/4	3 PM	3:30 PM
Lease	Well No.	Location		County	State		
Linder	1	Russell Springs 1123		Logan	Kan		
Contractor				Owner			
Red Tiger #2				JW 145			
Type Job				To Allied Cementing Co., Inc.			
Prod 3 Tring				You are hereby requested to rent cementing equipment and furnish cementer and helper to assist owner or contractor to do work as listed.			
Hole Size	T.D.	Charge To		Street			
7 7/8	4740	Frontier Oil Co.		1437 N. Franklin 67665			
Csg.	Depth	City		State			
4 1/2	4492	Russell		Kan			
Tbg. Size	Depth	The above was done to satisfaction and supervision of owner agent or contractor					
		Purchase Order No.		X <i>[Signature]</i>			
Drill Pipe	Depth	CEMENT					
		Amount Ordered					
Tool	Depth	225 Com 10% Salt					
Cement Left in Csg.	Shoe Joint	Consisting of					
26'	26'	5% Grit					
Press Max.	Minimum	Common					
		225 SKs 26.00					
Meas Line	Displace	Poz. Mix					
		Salt 21 SKs 21.75					
Perf.		Gritside 6.1 1,055 LBS @ 29¢					
		Quickset					
		Sales Tax					
		Handling					
		90¢ RELEASED					
		Mileage					
		3¢					
		44 mils					
		JAN 29 1991					
		Sub Total					
		297.00					
		Total					
		2,255.00					

EQUIPMENT

No.	Cementer	<i>McAdoo</i>
Pumptrk 153	Helper	
No.	Cementer	<i>Gerald K.</i>
Pumptrk	Helper	
	Driver:	<i>ED K.</i>
Bulktrk	Driver	

DEPTH of Job

Reference:		838.00
	Pump Truck	
	Plug	31.00
	100 Per mile	44.00
	Sub Total	
	Tax	
	Total	913.00

Remarks: Mixed 15 sx in Rat Hole
Float Held.

FROM CONFIDENTIAL
JAN 29 1991
FROM CONFIDENTIAL

Phone 316-793-5861, Great Bend, Kansas

Phone NESS City 313-750-0070

ALLIED CEMENTING CO., INC. NO 7692

Home Office P. O. Box 31 Russell, Kansas 67665

ORIGINAL

Date	8-17-89	Sec.	29	Twp.	15	Range	35	Called Out		On Location	3 PM	Job Start	3 PM	Finish	3:30 PM
Lease	Linder	Well No.	1	Location	Russell Springs 1125			County	Logan	State	Kan				
Contractor	Red Tiger #2														
Type Job	Prod String														
Hole Size	7 7/8	T.D.	4740												
Csg.	4 1/2	Depth	4492												
Tbg. Size		Depth													
Drill Pipe		Depth													
Tool		Depth													
Cement Left in Csg.	26'	Shoe Joint	26'												
Press Max.		Minimum													
Meas Line	✓	Displace													
Perf.															
EQUIPMENT															
Pumptrk	No. 153	Cementer	McAdoo												
		Helper	Gerald K.												
Pumptrk	No.	Cementer													
		Helper													
		Driver	E D K.												
Bulktrk		Driver													
DEPTH of Job															
Reference:	Pump Truck		838.00												
	Plug		31.00												
	100 Per mile		44.00												
			Sub Total												
			Tax												
			Total 913.00												
Remarks:	Mixed 15 sx in Rat Hole Float Held.														

To Allied Cementing Co., Inc.
You are hereby requested to rent cementing equipment and furnish cementer and helper to assist owner or contractor to do work as listed.

Charge To Frontier Oil Co.
Street 1437 N. Franklin 67665
City Russell State Kan

The above was done to satisfaction and supervision of owner agent or contractor

Purchase Order No. *[Signature]*

Amount Ordered 225 Com 10% Salt

Consisting of	5% Oil	1,350.00
Common	225 SKs @ 26.00	5850.00
Poz. Mix	Salt 21 SKs @ 4.75	99.75
Quickset	6.1 1,055 lbs @ 29¢	305.93

Handling	90¢	202.50
Mileage	3¢	297.00
	44 miles	
		Sub Total
		Total 2,255.00

Floating Equipment RELEASED

1991 2 9 1991

FROM CONFIDENTIAL

ALLIED CEMENTING CO., INC.

No. 7700

Home Office P. O. Box 31

Russell, Kansas 67665

New

Date	9-18-89	Sec.	29	Twp.	155	Range	35W
Lease	Linder	Well No.	1	Location	Russell Sp		
Contractor	Leons Cable Tools						
Type Job	Squeez (Circulate Cement)						
Hole Size	T.D.						
Csg.	Depth						
Tbg. Size	Depth						
Drill Pipe	Depth						
Tool	Depth 2433						
Cement Left in Csg.	Shoe Joint						
Press Max.	Minimum						
Meas Line	Displace						
Perf.	2490-91						

Attach a copy of
 cert ticket # 7700
 TO our copy of
 ACO-1

Job Start *OPM 7:45 PM*
 County *29th*
 State *Ks*

To You cementing equipment and furnish tractor to do work as listed.

Charge To *Frontier Oil*

Street *1437 N. Franklin*

City *Russell* State *Kan 67665*

The above was done to satisfaction and supervision of owner agent or contractor

Purchase Order No. *[Signature]*

X *[Signature]*

CEMENT

Amount Ordered	<i>500 40 6 1/2 gal 75 cam 3% CC</i>		
Consisting of			
Common	<i>375</i>	<i>SKs @ 5.85</i>	<i>2,193.75</i>
Poz. Mix	<i>200</i>	<i>SKs @ 2.35</i>	<i>470.00</i>
Gel.	<i>76</i>	<i>SKs @ 6.75</i>	<i>1,175.00</i>
Chloride	<i>2</i>	<i>SKs @ 20.00</i>	<i>40.00</i>
Quickset			

EQUIPMENT

No.	Cementer	<i>Dave</i>
Pumptrk <i>153</i>	Helper	<i>Gerald</i>
No.	Cementer	
Pumptrk	Helper	
<i>156</i>	Driver	<i>Ed</i>
Bulktrk <i>155</i>	Driver	<i>Steve</i>

Handling	<i>90¢</i>	
Mileage	<i>3¢</i>	
	<i>44 mil.</i>	
Sales Tax		<i>517.50</i>
Sub Total		<i>759.00</i>
Total		<i>4,155.25</i>
Floating Equipment		

DEPTH of Job

Reference:	<i>Pump trk chg 450.00</i>
	<i>100 per mile 44.00</i>
Sub Total	
Tax	
Total	<i>494.00</i>

Remarks: Plug @ 3850 tested @ 1500 PSI set packer @ 2433 Injection Rate @ 4 BBL Per min @ 500 PSI pack good circ, mixed 500 SK + 75 cam 3% squeezed @ 4250 PSI cleared tubing & rechecked @ 1250 PSI pulled tubing loaded hole & shut in @ 500 PSI

Phone 913-483-2627, Russell, Kansas
 Phone 316-793-5861, Great Bend, Kansas

Phone Plainville 913-434-2812
 Phone Ness City 913-798-3843

ALLIED CEMENTING CO., INC. NO 7700

Home Office P. O. Box 31 Russell, Kansas 67665

New

Date	9-18-89	Sec.	29	Twp.	15S	Range	35W	Called Out	On Location	Job Start	Finish
Lease	Linder	Well No.	1	Location	Russell Springs 12S 3W			County	Logan	State	KS
Contractor	Leans Cable Tools										
Type Job	Squeez (Circulate Cement)										
Hole Size	T.D.										
Csg.	4 1/2										
Tbg. Size	2"										
Drill Pipe	Depth										
Tool	Brad Oil										
Cement Left in Csg.	Shoe Joint										
Press Max.	Minimum										
Meas Line	Displace										
Perf.	2490-91										

Owner *Les W. S.*

To Allied Cementing Co., Inc.
 You are hereby requested to rent cementing equipment and furnish cementer and helper to assist owner or contractor to do work as listed.

Charge To *Frontier Oil*

Street *1437 N. Franklin*

City *Russell* State *Kan 67665*

The above was done to satisfaction and supervision of owner agent or contractor

Purchase Order No. *[Signature]*

X *[Signature]*

EQUIPMENT

Pumptrk	153	Cementer	Dave
		Helper	Gerald
Pumptrk		Cementer	
		Helper	
Bulktrk	156	Driver	Ed
Bulktrk	155	Driver	Steve

CEMENT

Amount Ordered	<i>500 40 6 1/2 gal 75 com 3 1/2 cc</i>		
Consisting of			
Common	<i>375</i>	<i>SKS @ 5.85</i>	<i>2,193.75</i>
Poz. Mix	<i>200</i>	<i>SKS @ 2.35</i>	<i>470.00</i>
Gel.	<i>26</i>	<i>SKS @ 6.75</i>	<i>175.50</i>
Chloride	<i>2</i>	<i>SKS @ 20.00</i>	<i>40.00</i>
Quickset			
Handling	<i>90¢</i>	<i>517.50</i>	
Mileage	<i>3¢</i>	<i>759.00</i>	
	<i>44 mil.</i>	Sub Total	
		Total <i>4,155.75</i>	

DEPTH of Job

Reference:	Pump tik. chg	<i>450.00</i>
	<i>100 per mile</i>	<i>44.00</i>
	Sub Total	
	Tax	
	Total	<i>494.00</i>

Remarks:

Plug @ 3850 tested @ 1500 PSI set packer @ 3433 Injection Rate @ 4 BBL Per min @ 500 PSI had good circ, mixed 500 sk + 75 com 3 1/2 squeez @ 1250 PSI cleared tubing, pulled tubing loaded hole & shut in @ 500 PSI

RECEIVED
 CONSERVATION DIVISION
 SEP 21 1989

Phone 913-483-2627, Russell, Kansas
 Phone 316-793-5861, Great Bend, Kansas

Phone Plainville 913-434-2812
 Phone Ness City 913-798-3843

New
ALLIED CEMENTING CO., INC. No. 7692

Home Office P. O. Box 31

Russell, Kansas 67665

Date	8-17-89	Sec.	29	Twp.	15	Range	35	Called Out	On Location	Job Start	Finish
Lease	Linder	Well No.	1	Location	Russell Springs 11 1/2 S			County	Logan	State	Kan
Contractor	Red Tiger #2										
Type Job	Prod String										
Hole Size	7 7/8	I.D.	4740								
Csg.	4 1/2	Depth	4492								
Tbg. Size		Depth									
Drill Pipe		Depth									
Tool		Depth									
Cement Left in Csg.	26'	Shoe Joint	26'								
Press Max.		Minimum									
Meas Line	✓	Displace									
Perf.											

Owner
 To Allied Cementing Co., Inc.
 You are hereby requested to rent cementing equipment and furnish cement and helper to assist owner or contractor to do work as listed.

Charge To
 Frontier Oil Co.
 Street 1437 N. Franklin 67665
 City Russell State Kan

The above was done to satisfaction and supervision of owner agent or contractor
 Purchase Order No.
 X *[Signature]*

CEMENT

Amount Ordered 225 Com 10% Salt
 Consisting of 5% Oil 1,350.00
 Common 225 SKS @ 6.00 ~~1,350.00~~
 Poz. Mix Salt 21 SKS @ 4.75 99.75
 Chloride 61 1,055 lbs @ 2.94 305.98
 Quickset

EQUIPMENT

Pumptrk	No.	Cementer	Meadow Gerald K.
	153	Helper	
Pumptrk	No.	Cementer	E.D. K.
		Helper	
		Driver	
Bulktrk		Driver	

Handling 90¢ 202.50
 Mileage 3¢ 297.00
 44 miles
 Sub Total
 Total 2255.00

DEPTH of Job

Reference:	Pump Truck	838.00
	Plug	31.00
	100 Per mile	44.00
	Sub Total	
	Tax	
	Total	913.00

Remarks: Mixed 15 sx in Rat Hole
 Float Held.

RECEIVED
 STATE CORPORATION COMMISSION

SEP 21 1990

CONSERVATION DIVISION
 Wichita, Kansas

Phone 913-483-2627, Russell, Kansas
 Phone 316-793-5861, Great Bend, Kansas

Phone Plainville 913-434-2812
 Phone Ness City 913-798-3843

ALLIED CEMENTING CO., INC.

NO. 6658

Home Office P. O. Box 31 Russell, Kansas 67665

New

Date	7-29-89	Sec.	29	Twp.	15	Range	35	Called Out	11:45 AM	On Location	3:30 P.M.	Job Start	5:45 P.M.	Finish	6:15 P.M.
Lease	Under	Well No.	1	Location	Russell	Location	Spring Springs	County	Logan	State	KS				
Contractor	Red Tiger														
Type Job	Surface														
Hole Size	12 1/4"		T.D. 380'												
Csg.	P3 (20')		Depth 378'												
Tbg. Size	Depth														
Drill Pipe	Depth														
Tool	Depth														
Cement Left in Csg.	15'		Shoe Joint												
Press Max.	Minimum														
Meas Line	Displace 23.6														
Perf.															

Owner *Same*

To Allied Cementing Co., Inc.
 You are hereby requested to rent cementing equipment and furnish cementer and helper to assist owner or contractor to do work as listed.

Charge To *Frontier Oil*

Street *1437 N Franklin*

City *Russell* State *Kan 67665*

The above was done to satisfaction and supervision of owner agent or contractor

Purchase Order No. *Elab Senesac*

CEMENT

EQUIPMENT

No.	Cementor	<i>Mike</i>
Pumptrk <i>46</i>	Helper	<i>Gary</i>
No.	Cementor	
Pumptrk	Helper	
	Driver	<i>Steve T</i>
Bulktrk <i>199</i>	Driver	

Amount Ordered	<i>210 60/40223</i>	
Consisting of		
Common	<i>126 e.6.00</i>	<i>756.00</i>
Poz. Mix	<i>84</i>	<i>240</i>
Gel.	<i>4</i>	<i>675</i>
Chloride	<i>6</i>	<i>20.00</i>
Quickset		<i>120.00</i>
Handling	<i>90</i>	<i>189.00</i>
Mileage <i>44</i>	<i>0.3</i>	<i>272.20</i>
	Sub Total	<i>1570.80</i>
	Total	

DEPTH of Job		
Reference:	<i>Pump Jck Chg</i>	<i>360.00</i>
	<i>Pump Jck Mileage</i>	<i>44.00</i>
	<i>TWP</i>	<i>40.00</i>
	<i>78 at 39</i>	<i>30.42</i>
	Total	<i>444.00</i>

Remarks: *Cement Did Circulate*

7 Sks Cement

Thank you

RECEIVED
 SEP 21 1990
 CONSERVATION DIVISION
 WICHITA, KANSAS