

EFFECTIVE DATE: 6-16-90 15-071-20516-00-00

FORM MUST BE TYPED  
FORM C-1 4/90

State of Kansas  
NOTICE OF INTENTION TO DRILL

FORM MUST BE SIGNED  
ALL BLANKS MUST BE FILLED

Must be approved by the K.C.C. five (5) days prior to commencing well

Expected Spud Date June 15, 1990 <sup>APP</sup> NW NE NW Sec 36 Twp 18 S, Rg 43 — East  
month day year  West

OPERATOR: License # 5952  
Name: Amoco Production Company  
Address: P.O. Box 800, Rm. 1833  
City/State/Zip: Denver, CO 80201  
Contact Person: J.A. Victor  
Phone: 303/830-4009

4770 feet from South line of Section  
3630 feet from East line of Section  
(Note: Locate well on Section Plat on Reverse Side)

CONTRACTOR: License #: 3098  
Name: Exeter Drilling

County: Greeley  
Lease Name: Donald Schmidt Well #: 1  
Field Name: Moore-Johnson

Well Drilled For: Well Class: Type Equipment:  
 Oil ... Inj ... Infield  Mud Rotary  
... Gas ... Storage ... Pool Ext. ... Air Rotary  
... OWWO ... Disposal  Wildcat ... Cable  
... Seismic; ... # of Holes

Is this a Prorated Field? #  yes  no  
Target Formation(s): Basal Upper Morrow  
Nearest lease or unit boundary: 510'  
Ground Surface Elevation: 3860 feet MSL

If OWWO: old well information as follows:  
Operator: N/A  
Well Name: \_\_\_\_\_  
Comp. Date: \_\_\_\_\_ Old Total Depth \_\_\_\_\_

Domestic well within 330 feet: ...  yes  no  
Municipal well within one mile: ...  yes  no  
Depth to bottom of fresh water: 200'  
Depth to bottom of usable water: 1650'

Directional, Deviated or Horizontal wellbore? ...  yes  no  
If yes, total depth location: \_\_\_\_\_

Surface Pipe by Alternate: ...  1  2  
Length of Surface Pipe Planned to be set: 500'  
Length of Conductor pipe required: NONE

Projected Total Depth: 5300'  
Formation at Total Depth: Mississippian  
Water Source for Drilling Operations:  
... well ... farm pond  other

DWR Permit #: \_\_\_\_\_  
Will Cores Be Taken?: ...  yes  no  
If yes, proposed zone: \_\_\_\_\_

**AFFIDAVIT**

The undersigned hereby affirms that the drilling, completion and eventual plugging of this well will comply with K.S.A. 55-101, et. seq.

It is agreed that the following minimum requirements will be met:

1. The appropriate district office shall be notified before setting surface pipe;
2. The minimum amount of surface pipe as specified above shall be set by circulating cement to the top; in all cases surface pipe shall be set through all unconsolidated materials plus a minimum of 20 feet into the underlying formation;
3. If the well is dry, a plugging proposal shall be submitted to the district office. An agreement between the operator and the district office on plug length and placement is necessary prior to plugging;
4. The appropriate district office will be notified before well is either plugged or production casing is cemented in;
5. If an Alternate II completion, production pipe shall be cemented from below any usable water to surface within 120 days of spud date. In all cases, notify district office prior to any cementing.

I hereby certify that the statements made herein are true and to the best of my knowledge and belief.

Date: 6/7/90 Signature of Operator or Agent: J. L. Hampton Title: Sr. Staff Admin. Supv.

**FOR KCC USE:**

API # 15- 071-20516-0000  
Conductor pipe required NONE feet  
Minimum surface pipe required 200 feet per Alt. ● (2)  
Approved by: meu 6-11-90  
EFFECTIVE DATE: 6-16-90  
This authorization expires: 12-11-90  
(This authorization void if drilling not started within 6 months of effective date.)  
Spud date: \_\_\_\_\_ Agent: \_\_\_\_\_

RECEIVED  
STATE CORPORATION  
JUN 11 1990  
6-11-90  
CONSERVATION DIVISION  
Wichita, Kansas

**REMEMBER TO:**

- File Drill Pit Application (form CDP-1) with Intent to Drill;
- File Completion Form ACO-1 within 120 days of spud date;
- File acreage attribution plat according to field prorations orders;
- Notify appropriate district office 48 hours prior to workover or re-entry;
- Submit plugging report (CP-4) after plugging is completed;
- Obtain written approval before disposing or injecting salt water.

36  
18  
4360

PLAT OF ACREAGE ATTRIBUTABLE TO A WELL

State Corporation Commission, Conservation Division  
200 Colorado Derby Bldg. Wichita, Kansas 67202

OPERATOR Amoco Production Company LOCATION OF WELL:  
 LEASE Donald-Schmidt 4770 feet north of SE corner  
 WELL NUMBER 1 3630 feet west of SE corner  
 FIELD Moore-Johnson Sec. 36 T 18 R 43 E/W  
 COUNTY Greeley  
 NO. OF ACRES ATTRIBUTABLE TO WELL 80 IS SECTION X REGULAR     IRREGULAR?  
 DESCRIPTION OF ACREAGE E/2 NW/4 IF IRREGULAR, LOCATE WELL FROM NEAREST  
 CORNER BOUNDARY.

NOTE: If plat depicted is insufficient for your circumstances, you may attach your own scaled or surveyed plat.

PLAT

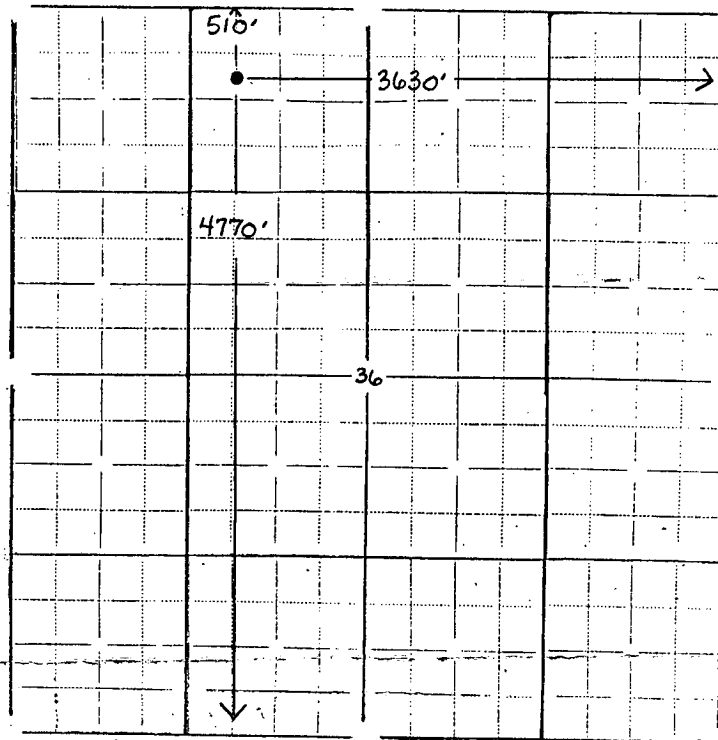

In plotting the proposed location of the well, you must show:

- 1) The manner in which you are using the depicted plat by identifying section lines, i.e. 1 section, 1 section with 8 surrounding partial sections, 4 sections, 16 sections, etc.;
- 2) the well's location relative to the location of other wells producing from the same common source of supply in adjoining drilling units, pursuant to K.A.R. 82-3-108, 82-3-207, 82-3-312, or special orders of the Commission; See attached plat.
- 3) the distance of the proposed drilling location from the section's east and south lines; and
- 4) the distance to the nearest lease or unit boundary line.

I hereby certify that the statements made herein are true and to the best of my knowledge and belief.

Signature of Operator or Agent J. L. Hampton jr  
 Date 6/7/90 Title Sr. Staff Admin. Supv.