

15-171-20235-00-01

FOR KCC USE:

EFFECTIVE DATE: 6-23-97

DISTRICT # 1

SGA? . . . Yes No

State of Kansas

NOTICE OF INTENTION TO DRILL

Must be approved by the K.C.C. five (5) days prior to commencing well

FORM C-1 7/91
FORM MUST BE TYPED
FORM MUST BE SIGNED
ALL BLANKS MUST BE FILLED

Expected Spud Date 7 5 1997
month day year

OPERATOR License#: 5011
Name: Viking Resources, Inc.
Address: 105 S. Broadway, Ste 1040
City/State/Zip: Wichita, KS 67202
Contact Person: Shawn P. Devlin
Phone: (316) 262-2502

CONTRACTOR: License #: 4958
Name: Mallard, JV, Inc.

Well Drilled For:	Well Class:	Type Equipment
<input checked="" type="checkbox"/> Oil	<input type="checkbox"/> Enh Rec	<input type="checkbox"/> Infield
<input type="checkbox"/> Gas	<input type="checkbox"/> Storage	<input type="checkbox"/> Pool Ext.
<input type="checkbox"/> OWWO	<input type="checkbox"/> Disposal	<input checked="" type="checkbox"/> Wildcat
<input type="checkbox"/> Seismic	<input type="checkbox"/> # of holes	<input type="checkbox"/> Other
<input type="checkbox"/> Other		

If OWWO: old well information as follows:
Operator: _____
Well Name: _____
Comp. Date: _____ Old Total Depth: _____

Directional, Deviated or Horizontal wellbore?: yes no
If yes, true vertical depth: _____
Bottom Hole Location: _____

Spot 50' N OF
NW - SW - NE Sec 32 Twp 16S Rg 31W

3680 feet from South line of Section
2310 feet from East line of Section
IS SECTION REGULAR IRREGULAR?
(Note: Locate well on the Section Plat on Reverse Side)

County: Scott
Lease Name: Harper Well #: 10
Field Name: Wilcat

Is this a Prorated/Spaced Field? yes no
Target Formation(s) LKC
Nearest lease or unit boundary: 330

Ground Surface Elevation: 2934 feet MSL
Water well within one-quarter mile: yes no
Public water supply well within one mil yes no

Depth to bottom of fresh water: 200
Depth to bottom of usable water: 1250 1500
Surface Pipe by Alternate: 1 2

Length of Surface Pipe planned to be set: 326
Length of Conductor pipe required: none
Projected Total Depth: 4400

Formation at Total Depth: LKC
Water Source for Drilling Operations: _____
 well farm pond other

DWR Permit #: _____
Will cores be taken? yes no
If yes, proposed zone: _____

CORRECTION 6-20-97 JK

AFFIDAVIT

The undersigned hereby confirms that the drilling, completion and eventual plugging of this well will comply with K.S.A. 55-101, et. seq.

It is agreed that the following minimum requirements will be met:

- 1 Notify the appropriate district office prior to spudding of well;
- 2 A copy of the approved notice of intent to drill shall be posted on each drilling rig;
- 3 The minimum amount of surface pipe as specified below shall be set by circulating cement to the top; in all cases the surface pipe shall be set through all unconsolidated materials plus a minimum of 20 feet into the underlying formation;
- 4 If the well is dry hole, an agreement between the operator and the district office on plug length and placement is necessary prior to plugging;
- 5 The appropriate district office will be notified before well is either plugged or production casing is cemented in;
- 6 IF AN ALTERNATE II COMPLETION, PRODUCTION PIPE SHALL BE CEMENTED FROM BELOW ANY USABLE WATER TO SURFACE WITHIN 120 DAYS OF SPUD DATE. IN ALL CASES, NOTIFY THE DISTRICT OFFICE PRIOR TO ANY CEMENTING.

I hereby certify that the statements made herein are true and to the best of my knowledge and belief.

Date: 6/17/97 Signature of Operator or Agent: [Signature] Title: Vice President

RECEIVED
KANSAS CORPORATION COMMISSION
JUN 17 1997
6-17-97
CONSERVATION DIVISION
WICHITA, KS

FOR KCC USE:
API # <u>15-171-205130000-202350001</u>
Conductor pipe required <u>NONE</u> feet
Minimum surface pipe required <u>220'</u> feet per Alt. <u>X(2)</u>
Approved by: <u>JK 6-18-97</u>
This authorization expires: <u>12-18-97</u> (This authorization void if drilling not started within 6 months of effective date.)
Spud date: _____ Agent: _____

- File Drill Pit Application (form CDP-1) with Intent to Drill;
- File Completion Form ACO-1 within 120 days of spud date;
- File acreage attribution plat according to field prorated orders;
- Notify appropriate district office 48 hours prior to workover or re-entry;
- Submit plugging report (CP-4) after plugging is completed;
- Obtain written approval before disposing or injecting salt water.

Mail to: Conservation Division, 130 S. Market #2078, Wichita, KS 67202-3802

32 16 310

10-2-1987 111-21

IN ALL CASES PLOT THE INTENDED WELL ON THE PLAT BELOW

PLAT OF ACREAGE ATTRIBUTABLE TO A WELL IN A PRORATED OR SPACED FIELD

If the intended well is in a prorated or spaced field, please fully complete this side of the form. If the intended well is in a prorated or spaced field complete the plat below showing that the well will be properly located in relationship to other wells producing from the common source of supply. Please show all the wells within 1 mile of the boundaries of the proposed acreage attribution unit for gas wells and within 1/2 mile of the boundaries of the proposed acreage attribution unit for oil wells.

API NO. 15-
OPERATOR Viking Resources, Inc.
LEASE Harper
WELL NUMBER 1 OWWO
FIELD Wilcat

LOCATION OF WELL: COUNTY Scott
3680 feet from SOUTH line of section
2310 feet from EAST line of section
SECTION 32 TWP 16S RG 31W

NUMBER OF ACRES ATTRIBUTABLE TO WELL _____
QTR/QTR/QTR OF ACREAGE NW - SW - NE

IS SECTION X REGULAR or _____ IRREGULAR
IF SECTION IS IRREGULAR LOCATE WELL FROM NEAREST
CORNER BOUNDARY.
Section corner used _____ NE _____ NW X SE _____ SW

PLAT

(Show location of the well and shade attributable acreage for prorated or spaced wells.)
(Show footage to the nearest lease or unit boundary line.)

RANGE 31W

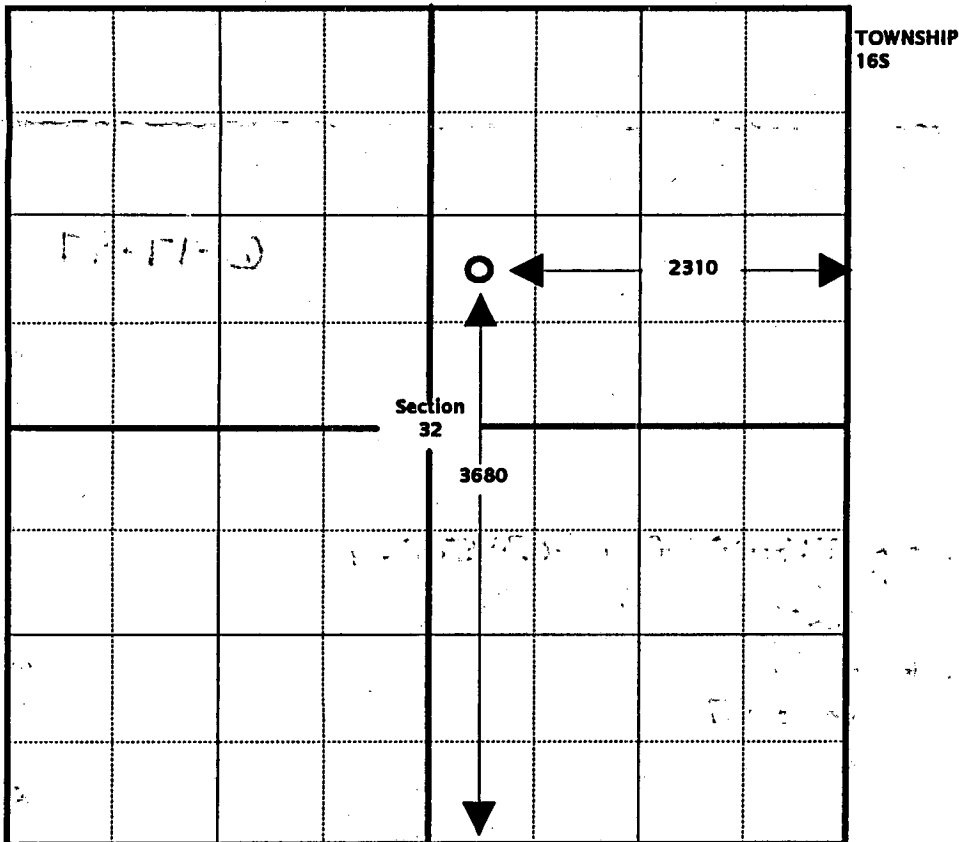

In plotting the proposed location of the well, you must show:

- 1) The manner in which you are using the depicted plat by identifying section lines, i.e. 1 section, 1 section with 8 surrounding sections, 4 sections, etc.;
- 2) the distance of the proposed drilling location from the section's south/north and east/west lines; and
- 3) the distance to the nearest lease or unit boundary line.