

15-199-20299-0000

RECEIVED  
AUG 18 2003

For KCC Use: 8-24-03  
Effective Date: 4  
District #: 4  
SGA?  Yes  No

KANSAS CORPORATION COMMISSION  
OIL & GAS CONSERVATION DIVISION

Form C-1  
December 2002  
Form must be Typed  
Form must be Signed  
Blanks must be Filled

NOTICE OF INTENT TO DRILL

Must be approved by KCC five (5) days prior to commencing well

API 501 & 120'E KCC WICHITA

Expected Spud Date 08/26/03  
month / day / year

Spot NW NE SE Sec. 17 Twp. 15 S. R. 41  
2630 feet from  N /  S Line of Section  
870 feet from  E /  W Line of Section  
Is SECTION  Regular  Irregular?

OPERATOR: License# 31120  
Name: Pelican Hill Oil and Gas, Inc.  
Address: 1401 N. El Camino Real, Ste. 207  
City/State/Zip: San Clemente, CA 92672  
Contact Person: Al Gross  
Phone: 949-498-2101

(Note: Locate well on the Section Plat on reverse side)

County: Wallice  
Lease Name: Lundblade Well #: 1-17  
Field Name: Wildcat

CONTRACTOR: License# 30606  
Name: Murfin Drilling Company, Inc.

Is this a Prorated / Spaced Field?  Yes  No

Well Drilled For:  Oil  Gas  OWWO  Seismic; # of Holes  Other  
Well Class:  Enh Rec  Storage  Disposal  Other  
Type Equipment:  Mud Rotary  Air Rotary  Cable

Target Information(s): Mississippian  
Nearest Lease or unit boundary: 870' (Unit see Att)

Ground Surface Elevation: 3789.2 feet MSL

Water well within one-quarter mile:  Yes  No

Public water supply well within one mile:  Yes  No

Depth to bottom of fresh water: 300 350 (43450')

Depth to bottom of usable water: 1900

Surface Pipe by Alternate:  1  2

Length of Surface Pipe Planned to be set: 400

Length of Conductor Pipe required: none

Projected Total Depth: 5175

Formation at Total Depth: Mississippian

Water Source for Drilling Operations:  Well  Farm:Pond  Other

If OWWO: old well information as follows:  
Operator: \_\_\_\_\_  
Well Name: \_\_\_\_\_  
Original Completion Date: \_\_\_\_\_ Original Total Depth: \_\_\_\_\_

DWR Permit #: \_\_\_\_\_

(Note: Apply for Permit with DWR )

Directional, Deviated or Horizontal wellbore?  Yes  No  
If Yes, true vertical depth: \_\_\_\_\_  
Bottom Hole Location: \_\_\_\_\_  
KCC DKT #: \_\_\_\_\_

Will Cores be taken?  Yes  No

If Yes, proposed zone: \_\_\_\_\_

AFFIDAVIT

The undersigned hereby affirms that the drilling, completion and eventual plugging of this well will comply with K.S.A. 55 et. seq.

It is agreed that the following minimum requirements will be met:

1. Notify the appropriate district office **prior** to spudding of well;
2. A copy of the approved notice of intent to drill **shall be posted** on each drilling rig;
3. The minimum amount of surface pipe as specified below **shall be set** by circulating cement to the top; in all cases surface pipe **shall be set** through all unconsolidated materials plus a minimum of 20 feet into the underlying formation.
4. If the well is dry hole, an agreement between the operator and the district office on plug length and placement is necessary **prior to plugging**;
5. The appropriate district office will be notified before well is either plugged or production casing is cemented in;
6. If an ALTERNATE II COMPLETION, production pipe shall be cemented from below any usable water to surface within **120 days** of spud date. Or pursuant to Appendix "B" - Eastern Kansas surface casing order #133,891-C, which applies to the KCC District 3 area, alternate II cementing must be completed within 30 days of the spud date or the well shall be plugged. **In all cases, NOTIFY district office** prior to any cementing.

I hereby certify that the statements made herein are true and to the best of my knowledge and belief.

Date: 08/15/03 Signature of Operator or Agent: Melissa Thieme Title: Agent

For KCC Use ONLY  
API # 15 - 199-20299-00-00  
Conductor pipe required NONE feet  
Minimum surface pipe required 400 feet per Alt. • (2)  
Approved by: RJP 8-19-03  
This authorization expires: 2-19-04  
(This authorization void if drilling not started within 6 months of effective date.)  
Spud date: \_\_\_\_\_ Agent: \_\_\_\_\_

Remember to:

- File Drill Pit Application (form CDP-1) with Intent to Drill;
- File Completion Form ACO-1 within 120 days of spud date;
- File acreage attribution plat according to field proration orders;
- Notify appropriate district office 48 hours prior to workover or re-entry;
- Submit plugging report (CP-4) after plugging is completed;
- Obtain written approval before disposing or injecting salt water.
- If this permit has expired (See: authorized expiration date) please check the box below and return to the address below.

Well Not Drilled - Permit Expired  
Signature of Operator or Agent: \_\_\_\_\_  
Date: \_\_\_\_\_

17 15 41 W

2003-11-13 3:17:10

Side Two

RECEIVED

AUG 18 2003

KCC WICHITA

IN ALL CASES PLOT THE INTENDED WELL ON THE PLAT BELOW

Plat of acreage attributable to a well in a prorated or spaced field

If the intended well is in a prorated or spaced field, please fully complete this side of the form. If the intended well is in a prorated or spaced field complete the plat below showing that the well will be properly located in relationship to other wells producing from the common source of supply. Please show all the wells and within 1 mile of the boundaries of the proposed acreage attribution unit for gas wells and within 1/2 mile of the boundaries of the proposed acreage attribution unit for oil wells.

API No. 15 - \_\_\_\_\_  
Operator: Pelican Hill Oil and Gas, Inc.  
Lease: ~~Schemm~~ Lundblade  
Well Number: 1-17  
Field: Wildcat

Location of Well: County: Greeley  
2630 feet from  N /  S Line of Section  
870 feet from  E /  W Line of Section  
Sec. 17 Twp. 15 S. R. 41  East  West

Number of Acres attributable to well: \_\_\_\_\_  
QTR / QTR / QTR of acreage: NW NE SE

Is Section:  Regular or  Irregular

If Section is irregular, locate well from nearest corner boundary.

Section corner used:  NE  NW  SE  SW

PLAT

(Show location of the well and shade acreage for prorated or spaced wells.)  
(Show footage to the nearest lease or unit boundary line.)

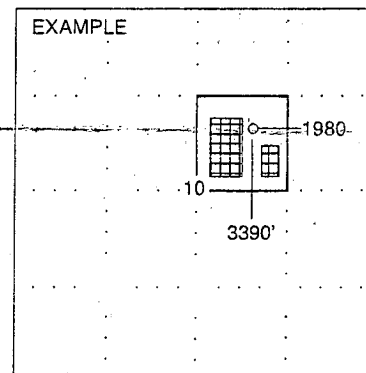
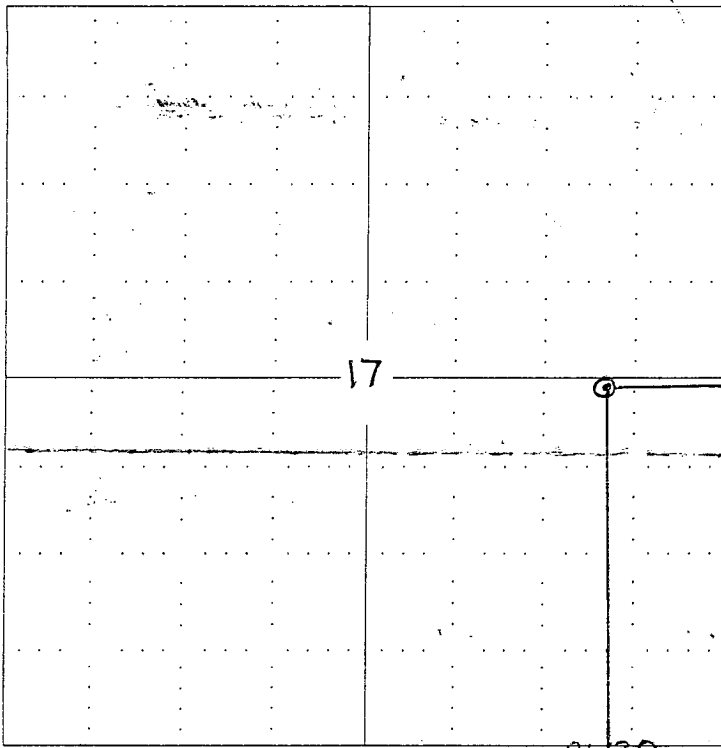

NOTE: In all cases locate the spot of the proposed drilling location.

In plotting the proposed location of the well, you must show:

1. The manner in which you are using the depicted plat by identifying section lines, i.e. 1 section, 1 section with 8 surrounding sections, 4 sections, etc.
2. The distance of the proposed drilling location from the section's south / north and east / west.
3. The distance to the nearest lease or unit boundary line.
4. If proposed location is located within a prorated or spaced field a certificate of acreage attribution plat must be attached: (CO-7 for oil wells; CG-8 for gas wells).

15-199-20299-00-00

BOOK 138 PAGE 471

FORM 88 - (PRODUCER'S SPECIAL) (PAID-UP)

63U (Rev. 1993)

OIL AND GAS LEASE

Reorder No. 09-115



AGREEMENT, Made and entered into the 14th day of January 2001 by and between John E. Lundblade and Ruth E. Lundblade, Trustees of the Lundblade Family Trust, dated November 1, 1991 17200 W. Bell Road #1691 Surprise, AZ 85374 whose mailing address is hereinafter called Lessor (whether one or more) and J. Fred Hambright, Inc. - 125 N. Market, #1415 - Wichita, KS 67202 hereinafter called Lessee:

Lessor, in consideration of Ten and More Dollars (\$10.00) in hand paid, receipt of which is here acknowledged and of the royalties herein provided and of the agreements of the lessee herein contained, hereby grants, leases and lets exclusively unto lessee for the purpose of investigating, exploring by geophysical and other means, prospecting, drilling, mining and operating for and producing oil, liquid hydrocarbons, all gases, and their respective constituent products, injecting gas, water, other fluids, and air into subsurface strata, laying pipe lines, storing oil, building tanks, power stations, telephone lines, and other structures and things thereon to produce, save, take care of, treat, manufacture, process, store and transport said oil, liquid hydrocarbons, gases and their respective constituent products and other products manufactured therefrom, and housing and otherwise caring for its employees, the following described land, together with any reversionary rights and after-acquired interest, therein situated in County of Wallace State of Kansas described as follows to-wit:

Township 15 South, Range 41 West Section 17: E/2

In Section Township Range and containing 320 acres, more or less, and all accretions thereto.

Subject to the provisions herein contained, this lease shall remain in force for a term of three (3) years from this date (called "primary term"), and as long thereafter as oil, liquid hydrocarbons, gas or other respective constituent products, or any of them, is produced from said land or land with which said land is pooled.

In consideration of the premises the said lessee covenants and agrees: 1st. To deliver to the credit of lessor, free of cost, in the pipe line to which lessee may connect wells on said land, the equal one-eighth (1/8) part of all oil produced and saved from the leased premises.

2nd. To pay lessor for gas of whatsoever nature or kind produced and sold, or used off the premises, or used in the manufacture of any products therefrom, one-eighth (1/8) at the market price at the well, but, as to gas sold by lessee, in no event more than one-eighth (1/8) of the proceeds received by lessee from such sales, for the gas sold, used off the premises, or in the manufacture of products therefrom, said payments to be made monthly. Where gas from a well producing gas only is not sold or used, lessee may pay or tender as royalty One Dollar (\$1.00) per year per net mineral acre retained hereunder, and if such payment or tender is made it will be considered that gas is being produced within the meaning of the preceding paragraph.

This lease may be maintained during the primary term hereof without further payment or drilling operations. If the lessee shall commence to drill a well within the term of this lease or any extension thereof, the lessee shall have the right to drill such well to completion with reasonable diligence and dispatch, and if oil or gas, or either of them, be found in paying quantities, this lease shall continue and be in force with like effect as if such well had been completed within the term of years first mentioned.

If said lessor owns a less interest in the above described land than the entire and undivided fee simple estate therein, then the royalties herein provided for shall be paid the said lessor only in the proportion which lessor's interest bears to the whole and undivided fee.

Lessee shall have the right to use, free of cost, gas, oil and water produced on said land for lessee's operation thereon, except water from the wells of lessor.

When requested by lessor, lessee shall bury lessee's pipe lines below plow depth.

No well shall be drilled nearer than 200 feet to the house or barn now on said premises without written consent of lessor.

Lessee shall pay for damages caused by lessee's operations to growing crops on said land.

Lessee shall have the right at any time to remove all machinery and fixtures placed on said premises, including the right to draw and remove casing.

If the estate of either party hereto is assigned, and the privilege of assigning in whole or in part is expressly allowed, the covenants hereof shall extend to their heirs, executors, administrators, successors or assigns, but no change in the ownership of the land or assignment of rentals or royalties shall be binding on the lessee until after the lessee has been furnished with a written transfer or assignment or a true copy thereof. In case lessee assigns this lease, in whole or in part, lessee shall be relieved of all obligations with respect to the assigned portion or portions arising subsequent to the date of assignment.

Lessee may at any time execute and deliver to lessor or place of record a release or releases covering any portion or portions of the above described premises and thereby surrender this lease as to such portion or portions and be relieved of all obligations as to the acreage surrendered.

All express or implied covenants of this lease shall be subject to all Federal and State Laws, Executive Orders, Rules or Regulations, and this lease shall not be terminated, in whole or in part, nor lessee held liable in damages, for failure to comply therewith, if compliance is prevented by, or if such failure is the result of, any such Law, Order, Rule or Regulation.

Lessor hereby warrants and agrees to defend the title to the lands herein described, and agrees that the lessee shall have the right at any time to redeem for lessor, by payment any mortgages, taxes or other liens on the above described lands, in the event of default of payment by lessor, and be subrogated to the rights of the holder thereof, and the undersigned lessors, for themselves and their heirs, successors and assigns, hereby surrender and release all right of dower and homestead in the premises described herein, in so far as said right of dower and homestead may in any way affect the purposes for which this lease is made, as recited herein.

Lessee, at its option, is hereby given the right and power to pool or combine the acreage covered by this lease or any portion thereof with other land, less or leases in the immediate vicinity thereof, when in lessee's judgment it is necessary or advisable to do so in order to properly develop and operate said lease premises so as to promote the conservation of oil, gas or other minerals in and under and that may be produced from said premises, such pooling to be of tracts contiguous to one another and to be into a unit or units not exceeding 40 acres each in the event of an oil well, or into a unit or units not exceeding 160 acres each in the event of a gas well. Lessee shall execute in writing and record in the conveyance records of the county in which the land herein leased is situated an instrument identifying and describing the pooled acreage. The entire acreage so pooled into a tract or unit shall be treated, for all purposes except the payment of royalties on production from the pooled unit, as if it were included in this lease. If production is found on the pooled acreage, it shall be treated as if production is had from this lease, whether the well or wells be located on the premises covered by this lease or not. In lieu of the royalties elsewhere herein specified, lessor shall receive on production from a unit so pooled only such portion of the royalty stipulated herein as the amount of his acreage placed in the unit or his royalty interest therein on an acreage basis bears to the total acreage so pooled in the particular unit involved.

RECEIVED KANSAS CORPORATION COMMISSION

AUG 19 2003

CONSERVATION DIVISION

IN WITNESS WHEREOF, the undersigned execute this instrument as of the day and year first above written.

Witness: John E. Lundblade, Trustee of the Lundblade Family Trust

Witness: Ruth E. Lundblade, Trustee of the Lundblade Family Trust

TAX ID# 511-26-1317

511-30-6909