

15-199-20293-0000

For KCC Use: 7-2-02
Effective Date: 7-2-02
District #: 4
SGA? Yes No

KANSAS CORPORATION COMMISSION
OIL & GAS CONSERVATION DIVISION
NOTICE OF INTENT TO DRILL

RECEIVED
JUN 27 2002
KCC WICHITA
06-27-02
Form C-1
September 1999
Form must be Typed
Form must be Signed
All blanks must be Filled

Must be approved by KCC five (5) days prior to commencing well

Expected Spud Date 6/28/02
month day year

OPERATOR: License# 31120
Name: Pelican Hill Oil & Gas, Inc.
Address: 1401 N El Camino Real, Suite 207
City/State/Zip: San Clemente, CA 92672
Contact Person: Allen J. Gross
Phone: 949-498-2101

CONTRACTOR: License# 30606
Name: Murfin Drilling Company, Inc.

Well Drilled For: Oil Enh Rec. Gas OWWO Seismic; Other
Well Class: Infield Pool Ext. Wildcat Other
Type Equipment: Mud Rotary Air Rotary Cable

If OWWO: old well information as follows:
Operator: _____
Well Name: _____
Original Completion Date: _____ Original Total Depth: _____

Directional, Deviated or Horizontal wellbore? Yes No
If Yes, true vertical depth: _____
Bottom Hole Location: _____
KCC DKT #: _____

Spot 180' N & 50' W of C
N/2 N/2 SE Sec. 6 Twp. 15 S. R. 41 East West
2490 feet from S (circle one) Line of Section
1370 feet from E (circle one) Line of Section

Is SECTION Regular Irregular?
(Note: Locate well on the Section Plat on reverse side)

County: Wallace
Lease Name: Blaesi Well #: 1-6
Field Name: Wildcat

Is this a Prorated / Spaced Field? Yes No
Target Formation(s): Morrow

Nearest Lease or unit boundary: 510' to Unit Boundary.
Ground Surface Elevation: 3772 feet MSL

Water well within one-quarter mile: Yes No
Public water supply well within one mile: Yes No

Depth to bottom of fresh water: 250
Depth to bottom of usable water: 1600

Surface Pipe by Alternate: 1 X 2
Length of Surface Pipe Planned to be set: 300'

Length of Conductor Pipe required: none
Projected Total Depth: 5250'

Formation at Total Depth: Morrow
Water Source for Drilling Operations:
Well _____ Farm Pond _____ Other X

DWR Permit #: _____
(Note: Apply for Permit with DWR)
Will Cores be taken? Yes No
If Yes, proposed zone: _____

AFFIDAVIT

The undersigned hereby affirms that the drilling, completion and eventual plugging of this well will comply with K.S.A. 55-101, et. seq.
It is agreed that the following minimum requirements will be met:

1. Notify the appropriate district office **prior** to spudding of well;
2. A copy of the approved notice of intent to drill **shall be** posted on each drilling rig;
3. The minimum amount of surface pipe as specified below **shall be set** by circulating cement to the top; in all cases surface pipe **shall be set** through all unconsolidated materials plus a minimum of 20 feet into the underlying formation.
4. If the well is dry hole, an agreement between the operator and the district office on plug length and placement is necessary **prior to plugging**;
5. The appropriate district office will be notified before well is either plugged or production casing is cemented in;
6. If an ALTERNATE II COMPLETION, production pipe shall be cemented from below any usable water to surface within **120 days** of spud date. **In all cases, NOTIFY district office** prior to any cementing.

I hereby certify that the statements made herein are true and to the best of my knowledge and belief.

Date: June 26, 2002 Signature of Operator or Agent: Shauna Burdman Title: Agent for Operator

For KCC Use ONLY
API # 15 - 199-20293-00-00
Conductor pipe required NONE feet
Minimum surface pipe required 300 feet per Alt. X 2
Approved by: RJP 6-27-02
This authorization expires: 12-27-02
(This authorization void if drilling not started within 6 months of effective date.)
Spud date: _____ Agent: _____

- Remember to:
- File Drill Pit Application (form CDP-1) with Intent to Drill;
 - File Completion Form ACO-1 within 120 days of spud date;
 - File acreage attribution plat according to field proration orders;
 - Notify appropriate district office 48 hours prior to workover or re-entry;
 - Submit plugging report (CP-4) after plugging is completed;
 - Obtain written approval before disposing or injecting salt water.

Mail to: KCC - Conservation Division, 130 S. Market - Room 2078, Wichita, Kansas 67202

6
15
M/H

IN ALL CASES PLOT THE INTENDED WELL ON THE PLAT BELOW

Plat of acreage attributable to a well in a prorated or spaced field

If the intended well is in a prorated or spaced field, please fully complete this side of the form. If the intended well is in a prorated or spaced field complete the plat below showing that the well will be properly located in relationship to other wells producing from the common source of supply. Please show all the wells and within 1 mile of the boundaries of the proposed acreage attribution unit for gas wells and within 1/2 mile of the boundaries of the proposed acreage attribution unit for oil wells.

API No. 15 - _____
 Operator: _____
 Lease: _____
 Well Number: _____
 Field: _____
 Number of Acres attributable to well: _____
 QTR / QTR / QTR of acreage: _____

Location of Well: County: Wallace
 2490 _____ feet from S / N (circle one) Line of Section
 1370 _____ feet from E / W (circle one) Line of Section
 Sec. 6 Twp. 15 S. R. 41 East West
 Is Section Regular or Irregular
 If Section is Irregular, locate well from nearest corner boundary.
 Section corner used: ___ NE ___ NW ___ SE ___ SW

PLAT

*(Show location of the well and shade attributable acreage for prorated or spaced wells.)
 (Show footage to the nearest lease or unit boundary line.)*

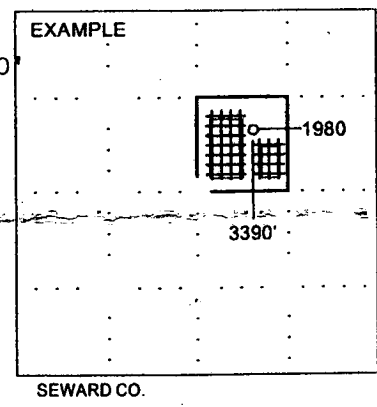
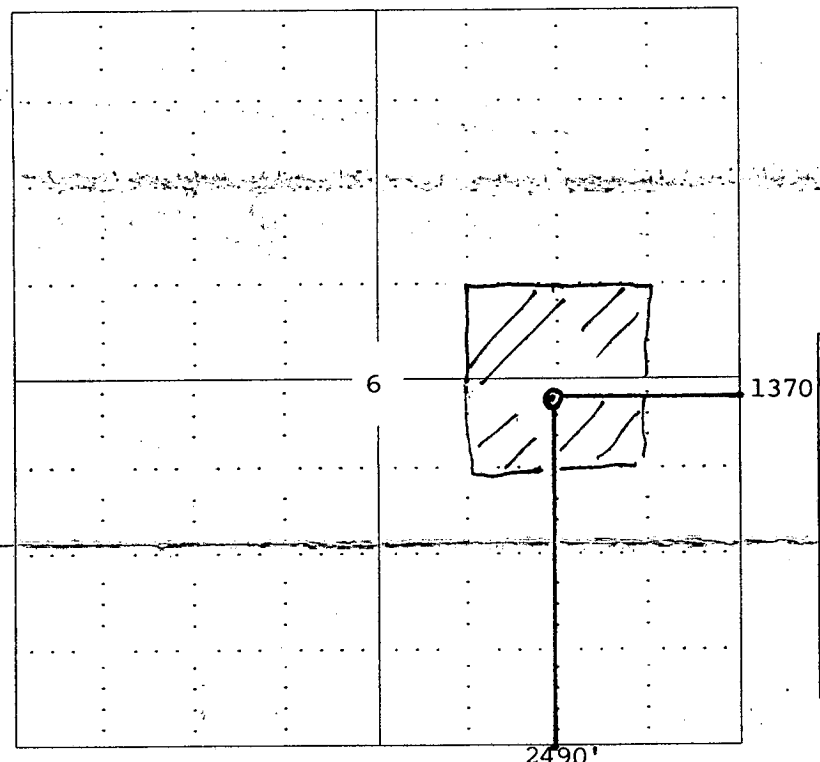

NOTE: In all cases locate the spot of the proposed drilling location.

In plotting the proposed location of the well, you must show:

1. The manner in which you are using the depicted plat by identifying section lines, i.e. 1 section, 1 section with 8 surrounding sections, 4 sections, etc.
2. The distance of the proposed drilling location from the section's south / north and east / west.
3. The distance to the nearest lease or unit boundary line.
4. If proposed location is located within a prorated or spaced field a certificate of acreage attribution plat must be attached: (C0-7 for oil wells; CG-8 for gas wells).

15-199-20293-00-00

DECLARATION OF POOLING FOR OIL

KNOW ALL MEN BY THESE PRESENTS:

WHEREAS, under date of January 27, 2001, Dwight D. Blaesi and Vlasta Blaesi, Co-Trustees of the Dwight D. Blaesi Trust, and the Vlasta Blaesi Trust, both dated June 23, 1994, Lessor, executed and delivered to J. Fred Hambright, Inc., Lessee, that certain Oil & Gas Lease, which is recorded in Book 138 at Pages 455-457, covering the Southeast Quarter (SE/4) of Section 6, Township 15 South, Range 41 West, Wallace County, Kansas; and

WHEREAS, under date of January 18, 2001, James Gebhards and Shelia, his wife, Lessors, executed and delivered to J. Fred Hambright, Inc., Lessee, that certain Oil & Gas Lease, which is recorded in Book 138 at Pages 316-318, covering Lots 1(39.76ac.), 2(39.82ac.), S/2 NE/4, a/d/a Northeast Quarter (NE/4) of Section 6, Township 15 South, Range 41 West, Wallace County, Kansas; and

WHEREAS, the primary terms of each of the above described Oil and Gas Leases are current, of record, and said Oil and Gas Leases are valid and subsisting; and

WHEREAS, each of said Oil and Gas Leases grants Lessee the right to pool and combine the acreage or any portion thereof covered by said Leases, with other land and leases, in the immediate vicinity thereof, into a unit of not more than 40 acres for oil, in which event the entire acreage so pooled shall be treated, for all purposes, as if it were included in each of said Leases; and

NOW, THEREFORE, L. Scott Banks, pursuant to the terms and provisions contained in said Oil and Gas Leases, pools, consolidates, and unitizes said Oil and Gas Leases, to form a consolidated oil leasehold estate consisting of and to the extent that said Oil and Gas Leases cover the following described real property located in Wallace County, Kansas, to wit:

Southeast Quarter (SE/4) of the Southwest Quarter (SW/4) of the Northeast Quarter (NE/4) of Section 6, Township 15 South, Range 41 West

Southwest Quarter (SW/4) of the Southeast Quarter (SE/4) of the Northeast Quarter (NE/4) of Section 6, Township 15 South, Range 41 West

Northeast Quarter (NE/4) of the Northwest Quarter (NW/4) of the Southeast Quarter (SE/4) of Section 6, Township 15 South, Range 41 West

Northwest Quarter (NW/4) of the Northeast Quarter (NE/4) of the Southeast Quarter (SE/4) of Section 6, Township 15 South, Range 41 West



15-199-20293-00-00

Declaration of Pooling for Oil
SE/4 Sec. 6-15S-41W, Wallace County, Kansas
NE/4 Sec. 6-15S-41W, Wallace County, Kansas
June 26, 2002
Page 2 of 2

EXECUTED this 26 day of June, 2002, with an EFFECTIVE DATE of June 26, 2002.

L. Scott Banks

L. Scott Banks

ACKNOWLEDGMENT

STATE OF KANSAS)
) ss.
COUNTY OF SEDGWICK)

This instrument was acknowledged before me on the 26th day of June, 2002, by L. Scott Banks.

My Commission Expires:

April 28, 2004

Becky L. Holeman

Notary Public

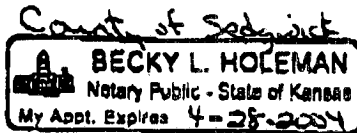

State of Kansas } Fee 2.60
Wallace County }
Filed for Record 6-27 2002 AS
at 9:00 a.m. Book 142 Page 542-543

William F. Swartz

Register of Deeds

Numerical
Direct Index
Indirect Index
Microfilm
Computer

