

CARD MUST BE TYPED

State of Kansas

CARD MUST BE SIGNED

NOTICE OF INTENTION TO DRILL

(see rules on reverse side)

199-20,114-00-00 ✓

Expected Spud Date. 09 22 87
month day year

API Number 15— 4950
NW NW NE Sec. 32 Twp. 15S S, Rg. 42 X West
2310 Ft. from South Line of Section
Ft. from East Line of Section

OPERATOR: License # 8458
Name Trans-Western Operating Co.
Address P. O. Box 276
City/State/Zip Golden, CO 80202
Contact Person Doug Isern
Phone 303-279-2995

(Note: Locate well on Section Plat on reverse side)
Nearest lease or unit boundary line 330 feet
County Wallace

CONTRACTOR: License # 6033
Name Murfin Drilling Company
City/State Wichita, KS

Lease Name Bergquist Well # 4
Ground surface elevation feet MSL
Domestic well within 330 feet: yes X no
Municipal well within one mile: yes X no

Well Drilled For: Well Class: Type Equipment:
X Oil Storage Infield X Mud Rotary
Gas Inj X Pool Ext. Air Rotary
OWWO Expl Wildcat Cable

Depth to bottom of fresh water 150-275
Depth to bottom of usable water 1850
Surface pipe by Alternate: 1 2 X
Surface pipe planned to be set 390
Conductor pipe required N/A
Projected Total Depth 5300 feet
Formation Miss.

If OWWO: old well info as follows:

Operator
Well Name
Comp Date Old Total Depth

I certify that well will comply with K.S.A. 55-101, et seq., plus eventually plugging hole to KCC specifications.

Date 9-18-87 Signature of Operator or Agent Rob Ramsey, Agent for Operator Ass't. Drilg. Mgr.

For KCC Use:

Conductor Pipe Required feet; Minimum Surface Pipe Required 300 feet per Alt. X 2
This Authorization Expires 3-18-88 Effective 9-23-87 Approved By Pat 9-18-87

Must be filed with the K.C.C. five (5) days prior to commencing well
 This card void if drilling not started within six (6) months of date received by K.C.C.

Important procedures to follow:

1. Notify District office before setting surface casing.
2. Set surface casing by circulating cement to the top.
3. File completion forms ACO-1 with K.C.C. within 120 days of well spud date, following instructions on ACO-1, side 1, and including copies of wireline logs.
4. Notify District office 48 hours prior to old well workover or re-entry.
5. Prior to filing Intent, prepare a proposed plugging plan in case well is D & A, then obtain approval of plan when calling district office prior to setting surface pipe.
6. Submit plugging report (CP-4) to K.C.C. after plugging is completed.
7. Obtain an approved injection docket number before disposing of salt water.
8. Notify K.C.C. within 10 days when injection commences or terminates.
9. If an alternate 2 completion, cement in the production pipe from below any usable water to surface within 120 days of spud date.

A Regular Section of Land
 1 Mile = 5,280 Ft.

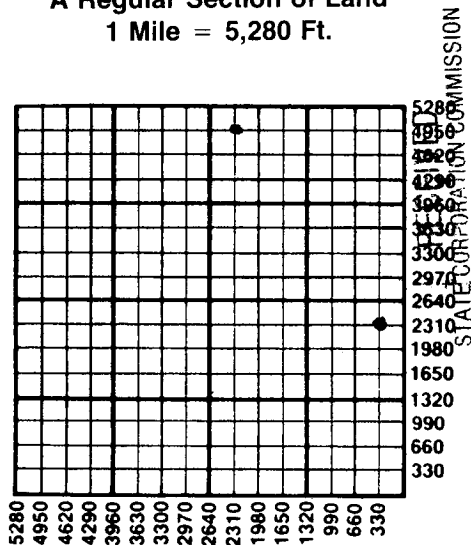

SEP 18 1987

CONSERVATION DIVISION
 Wichita, Kansas

State Corporation Commission of Kansas
 Conservation Division
 200 Colorado Derby Building
 Wichita, Kansas 67202-1212
 (316) 263-3238