

FOR KCC USE:

EFFECTIVE DATE: 10-21-91

DISTRICT # 4

SSA? Yes X No

State of Kansas

NOTICE OF INTENTION TO DRILL

Must be approved by the K.C.C. five (5) days prior to commencing well

Spot NE/4 NW/4 NE/4 Sec 36.. Twp 15.. S. Rg 42.. x East West

Expected Spud Date 11 month 02 day 91 year

OPERATOR: License # 6593 Name: Coastal Oil & Gas Corporation Address: 211 N. Robinson, Suite 1700 City/State/Zip: Oklahoma City, OK 73102 Contact Person: John D. Perry Phone: (405) 239-7031

CONTRACTOR: License #: To Be Determined Name:

Well Drilled For: Well Class: Type Equipment: X Oil Enh Rec Infield X Mud Rotary Gas Storage X Pool Ext Air Rotary OWWO Disposal Wildcat Cable Seismic # of Holes Other If OWWO: old well information as follows: Operator: Well Name: Comp. Date: Old Total Depth

Directional, Deviated or Horizontal wellbore? yes X no If yes, true vertical depth: Bottom Hole Location:

990 feet from South / North line of Section 1650 feet from East / West line of Section IS SECTION X REGULAR IRREGULAR? (NOTE: Locate well on the Section Plat on Reverse Side) County: Wallace Lease Name: Nickelson Well #: 2-36 Field Name: Mt. Sunflower Is this a Prorated/Spaced Field? yes X no Target Formation(s): Marrow Nearest lease or unit boundary: 990' Ground Surface Elevation: 379.8' feet MSL Water well within one-quarter mile: yes X no Public water supply well within one mile: yes X no Depth to bottom of fresh water: 200' Depth to bottom of usable water: 1600' Surface Pipe by Alternate: 1 X 2 Length of Surface Pipe Planned to be set: 300* Length of Conductor pipe required: None Projected Total Depth: 5,300' Formation at Total Depth: Mississippi Water Source for Drilling Operations: well X farm pond other DUR Permit #: Farm Pond Will Cores Be Taken?: yes X no If yes, proposed zone: * DV tool to be set @ 1860'

AFFIDAVIT

The undersigned hereby affirms that the drilling, completion and eventual plugging of this well will comply with K.S.A. 55-101, et. seq. It is agreed that the following minimum requirements will be met:

- 1. Notify the appropriate district office prior to spudding of well;
2. A copy of the approved notice of intent to drill shall be posted on each drilling rig;
3. The minimum amount of surface pipe as specified below shall be set by circulating cement to the top; in all cases surface pipe shall be set through all unconsolidated materials plus a minimum of 20 feet into the underlying formation;
4. If the well is dry hole, an agreement between the operator and the district office on plug length and placement is necessary prior to plugging;
5. The appropriate district office will be notified before well is either plugged or production casing is cemented in;
6. IF AN ALTERNATE II COMPLETION, PRODUCTION PIPE SHALL BE CEMENTED FROM BELOW ANY USABLE WATER TO SURFACE WITHIN 120 DAYS OF SPUD DATE. IN ALL CASES, NOTIFY DISTRICT OFFICE PRIOR TO ANY CEMENTING.

I hereby certify that the statements made herein are true and to the best of my knowledge and belief.

Date: 10-14-91 Signature of Operator or Agent: Title Dist... Oper... Supt...

FOR KCC USE: API # 15- 199-20,204-00-00 Conductor pipe required None feet Minimum surface pipe required 250 feet per Alt. (2) Approved by: 10-16-91 This authorization expires: 4-16-92 (This authorization void if drilling not started within 6 months of effective date.) Spud date: Agent:

REMEMBER TO:

- File Drill Pit Application (form CDP-1) with Intent to Drill;
- File Completion Form ACO-1 within 120 days of spud date;
- File acreage attribution plat according to field proration orders;
- Notify appropriate district office 48 hours prior to workover or re-entry;
- Submit plugging report (CP-4) after plugging is completed;
- Obtain written approval before disposing or injecting salt water.

Mail to: Conservation Division, 200 Colorado Derby Building, 202 W. First St., Wichita, Kansas 67202-1286.

RECEIVED KANSAS CORPORATION COMMISSION OCT 16 1991 CONSERVATION DIVISION WICHITA, KS 10-16-91

36 15 482

15-199-20204-0000

FORM C-1 7/91 FORM MUST BE TYPED FORM MUST BE SIGNED ALL BLANKS MUST BE FILLED

IN ALL CASES PLOT THE INTENDED WELL ON THE PLAT BELOW

PLAT OF ACREAGE ATTRIBUTABLE TO A WELL IN A PRORATED OR SPACED FIELD

If the intended well is in a prorated or spaced field, please fully complete this side of the form. If the intended well is in a prorated or spaced field complete the plat below showing that the well will be properly located in relationship to other wells producing from the common source of supply. Please show all the wells within 1 mile of the boundaries of the proposed acreage attribution unit for gas wells and within 1/2 mile of the boundaries of the proposed acreage attribution unit for oil wells.

API NO. 15- _____
 OPERATOR Coastal Oil & Gas Corporation LOCATION OF WELL: COUNTY Wallace
 LEASE Nickelson _____ 990 feet from ~~south~~/north line of section
 WELL NUMBER 2-36 _____ 1650 feet from east/~~west~~ line of section
 FIELD Mt. Sunflower _____ SECTION 36 TWP 15S RG 42W

NUMBER OF ACRES ATTRIBUTABLE TO WELL 10 IS SECTION X REGULAR or _____ IRREGULAR
 QTR/QTR/QTR OF ACREAGE NE/4 - NW/4 - NE/4 IF SECTION IS IRREGULAR, LOCATE WELL FROM NEAREST
CORNER BOUNDARY.

Section corner used: _____ NE _____ NW _____ SE _____ SW

PLAT

(Show location of the well and shade attributable acreage for prorated or spaced wells.)
 (Show footage to the nearest lease or unit boundary line.)

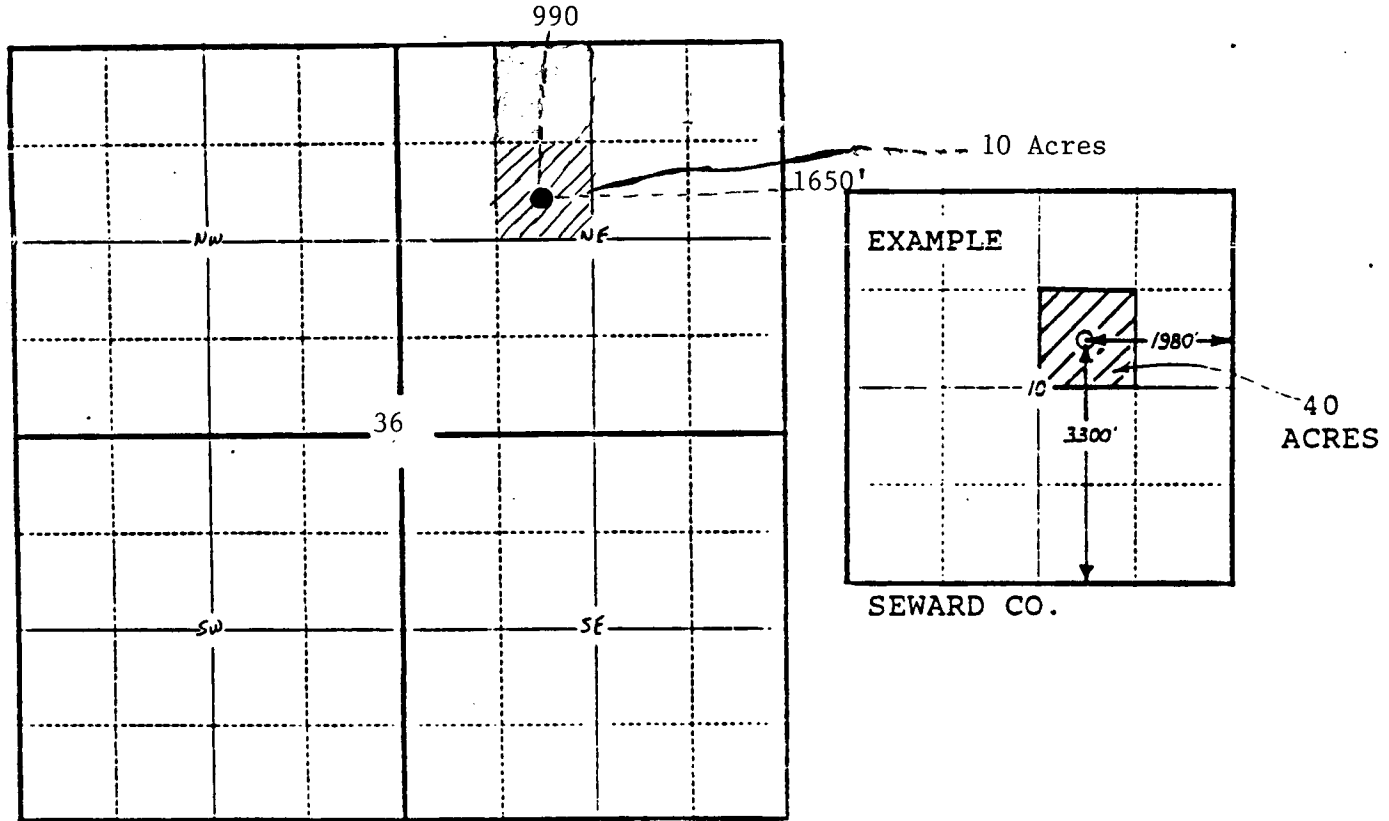

Wallace Co.

In plotting the proposed location of the well, you must show:

- 1) The manner in which you are using the depicted plat by identifying section lines, i.e. 1 section, 1 section with 8 surrounding sections, 4 sections, etc.;
- 2) the distance of the proposed drilling location from the section's south/north and east/west lines; and
- 3) the distance to the nearest lease or unit boundary line.