

NOTICE OF INTENTION TO DRILL

(see rules on reverse side)

Expected Spud Date: January 30, 1988
month day year

API Number 15-199-20,136-00-00
Irregular Section
SW Sec. 1 Twp. 15 S, Rg. 43 XX West
2515' Ft. from South Line of Section
+1340' Ft. from East Line of Section

OPERATOR: License # 5171
Name TXO Production Corp.
Address 155 N. Market, Suite 1000
City/State/Zip Wichita, Kansas 67202
Contact Person Cory West
Phone (316) 269-7655

(Note: Locate well on Section Plat on reverse side)
Nearest lease or unit boundary line 460' feet
County Wallace
Lease Name HIBBERT 'A' Well # 4

CONTRACTOR: License # 6033
Name Murfin Drilling Co.
City/State Wichita, Kansas

Ground surface elevation TBD feet MSL
Domestic well within 330 feet: yes XX no
Municipal well within one mile: yes XX no

Well Drilled For: Well Class: Type Equipment:
X Oil Storage Infield X Mud Rotary
Gas Inj X Pool-Ext Air Rotary
OWWO Expl Wildcat Cable

Depth to bottom of fresh water 350'
Depth to bottom of usable water 1800'
Surface pipe by Alternate: 1 2 XX
Surface pipe planned to be set 650'
Conductor pipe required none
Projected Total Depth 5300' feet
Formation Morrow Sand

If OWWO: old well info as follows:

Operator
Well Name
Comp Date Old Total Depth

I certify that well will comply with K.S.A. 55-101, et seq., plus eventually plugging hole to KCC specifications.

Date 1-04-88 Signature of Operator or Agent Cory West Title Drlg. & Prod. Engineer.

For KCC Use:

Conductor Pipe Required feet; Minimum Surface Pipe Required 400 feet per Alt. (X) 2
This Authorization Expires 7-11-88 Approved By RCH 1-11-88

EFFECTIVE DATE: 1-16-88

Must be filed with the K.C.C. five (5) days prior to commencing well  
 This card void if drilling not started within six (6) months of date received by K.C.C.

Important procedures to follow:

1. Notify District office before setting surface casing.
  2. Set surface casing by circulating cement to the top.
  3. File completion forms ACO-1 with K.C.C. within 120 days of well spud date, following instructions on ACO-1, side 1, and including copies of wireline logs.
  4. Notify District office 48 hours prior to old well workover or re-entry.
  5. Prior to filing Intent, prepare a proposed plugging plan in case well is D & A, then obtain approval of plan when calling district office prior to setting surface pipe.
  6. Submit plugging report (CP-4) to K.C.C. after plugging is completed.
  7. Obtain an approved injection docket number before disposing of salt water.
  8. Notify K.C.C. within 10 days when injection commences or terminates.
- If an alternate 2 completion, cement in the production pipe from below any usable water to surface within 120 days of spud date.

A Regular Section of Land  
 1 Mile = 5,280 Ft.

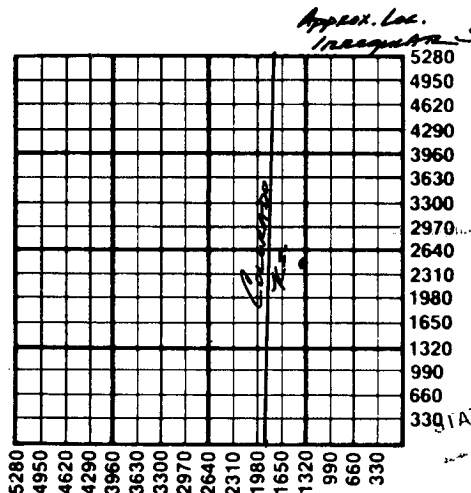

RECEIVED  
 STATE CORPORATION COMMISSION  
 WICHITA, KANSAS  
 JAN 19 1988

01-11-88

State Corporation Commission of Kansas  
 Conservation Division  
 200 Colorado Derby Building  
 Wichita, Kansas 67202-1212  
 (316) 263-3238