

THE APPLICANT:

EFFECTIVE DATE: 11-24-99

DISTRICT # 1

SEAT...Y...X...R...

State of Kansas

NOTICE OF INTENTION TO DRILL

Must be approved by the K.C.C. five (5) days prior to commencing well

15-071-20718-0000

Expected Spud Date November 23 1999

East 60' E of E/2 NW NW Sec 26.. Twp 16. S. Rg 42.. East West

OPERATOR: License # 3581 Red Oak Energy, Inc. Address: 7701 E. Kellom, Suite 710 Wichita KS 67207 Contact Person: Kevin Davis Phone: (316) 652-7373

660 1050 feet from South North line of Section East West line of Section

IS SECTION X REGULAR IRREGULAR (NOTE: Locate well on the Section Plat on Reverse Side)

County: Greeley Well #: 3A-26

Lease Name: KRISS Field Name: (UN-NAMED)

Is this a Protected/Spaced Field? yes X no

Target Formation(s): Morrow

Nearest lease or unit boundary: 660'

Ground Surface Elevation: 3803 feet MSL

Water well within one-quarter mile: yes X no

Public water supply well within one mile: yes X no

Depth to bottom of fresh water: 280'

Depth to bottom of usable water: 1880'

Surface Pipe by Alternate: 1 X 2

Length of Surface Pipe Planned to be set: 300'

Length of Conductor pipe required: N/A

Projected Total Depth: 5250'

Formation at Total Depth: Mississippian

Water Source for Drilling Operations: X well farm pond other

DKR Permit #: APPROV FOR FROM NWR

Will Cores Be Taken?: yes X no

If yes, proposed zone:

CONTRACTOR: License #: 30606 Name: Hurfin Drilling Company

Well Drilled For: Well Class: Type Equipment:

X Oil ... Enh Rec ... Infield ... Mud Rotary ... Gas ... Storage ... Pool Ext. ... Air Rotary ... OWD ... Disposal ... Wildcat ... Cable ... Solonic: ... # of Holes ... Other

If OWD: old well information as follows:

Operator: Well Name: Comp. Date: Old Total Depth

Directional, Deviated or Horizontal wellbore? yes X no

If yes, true vertical depth:

Bottom Hole Location:

AFFIDAVIT

The undersigned hereby affirms that the drilling, completion and eventual plugging of this well will comply with K.S.A. 55-101, et. seq.

It is agreed that the following minimum requirements will be met:

- 1. Notify the appropriate district office prior to spudding of well;
2. A copy of the approved notice of intent to drill shall be posted on each drilling rig;
3. The minimum amount of surface pipe as specified below shall be set by circulating cement to the top; in all cases surface pipe shall be set through all unconsolidated materials plus a minimum of 28 feet into the underlying formation;
4. If the well is dry hole, an agreement between the operator and the district office on plug length and placement is necessary prior to plugging;
5. The appropriate district office will be notified before well is either plugged or production casing is cemented in;
6. IF AN ALTERNATE IS COMPLETION, PRODUCTION PIPE SHALL BE CEMENTED FROM BELOW ANY USABLE WATER TO SURFACE WITHIN 120 DAYS OF SPUD DATE. IN ALL CASES, NOTIFY DISTRICT OFFICE PRIOR TO ANY CEMENTING.

I hereby certify that the statements made herein are true and to the best of my knowledge and belief.

Date: 11/19/99 Signature of Operator or Agent: Kevin Davis Title: President

RCW 11-19-99

FOR KCC USE: API # 15- 071-207180000 Conductor pipe required NONE feet Minimum surface pipe required 300 feet per Alt. X(2) Approved by: K 11-19-99 This authorization expires: 5-19-2000 (This authorization void if drilling not started within 6 months of effective date.) Spud date: Agent:

REMEMBER TO:

- File Drill Pit Application (form CDP-1) with intent to drill;
- File Completion Form ACO-1 within 120 days of spud date;
- File acreage attribution plat according to field protection orders;
- Notify appropriate district office 48 hours prior to workover or re-entry;
- Submit plugging report (CP-4) after plugging is completed;
- Obtain written approval before disposing or injecting salt water.

Mail to: Conservation Division, 208 Colorado Derby Building, 202 W. First St., Wichita, Kansas 67202-1286.

216 16 42W

3-100-24501-110-21

**IN ALL CASES PLOT THE INTENDED WELL ON THE PLAT BELOW**

**PLAT OF ACREAGE ATTRIBUTABLE TO A WELL IN A PRORATED OR SPACED FIELD**

If the intended well is in a prorated or spaced field, please fully complete this side of the form. If the intended well is in a prorated or spaced field complete the plat below showing that the well will be properly located in relationship to other wells producing from the common source of supply. Please show all the wells within 1 mile of the boundaries of the proposed acreage attribution unit for gas wells and within 1/2 mile of the boundaries of the proposed acreage attribution unit for oil wells.

API NO. 15- \_\_\_\_\_  
OPERATOR Red Oak Energy, Inc.  
LEASE Krtss  
WELL NUMBER 3A-26  
FIELD \_\_\_\_\_

LOCATION OF WELL: COUNTY Greeley  
660 feet from south/north line of section  
1050 feet from east/west line of section  
SECTION 26 TWP 16 RG 42

NUMBER OF ACRES ATTRIBUTABLE TO WELL \_\_\_\_\_  
QTR/QTR/QTR OF ACREAGE \_\_\_\_\_

IS SECTION X REGULAR or IRREGULAR  
IF SECTION IS IRREGULAR, LOCATE WELL FROM NEAREST CORNER BOUNDARY

Section corner used: NE NW SE SW

(Show location of the well and shade attributable acreage for prorated or spaced wells.)  
(Show footage to the nearest lease or unit boundary line.)

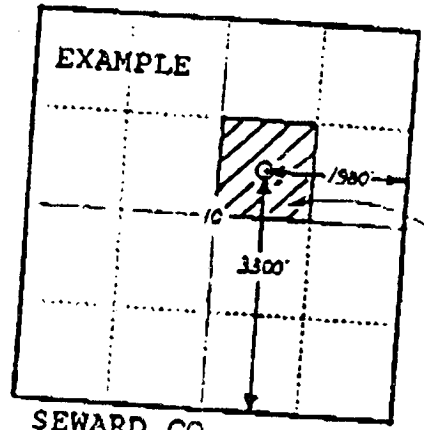
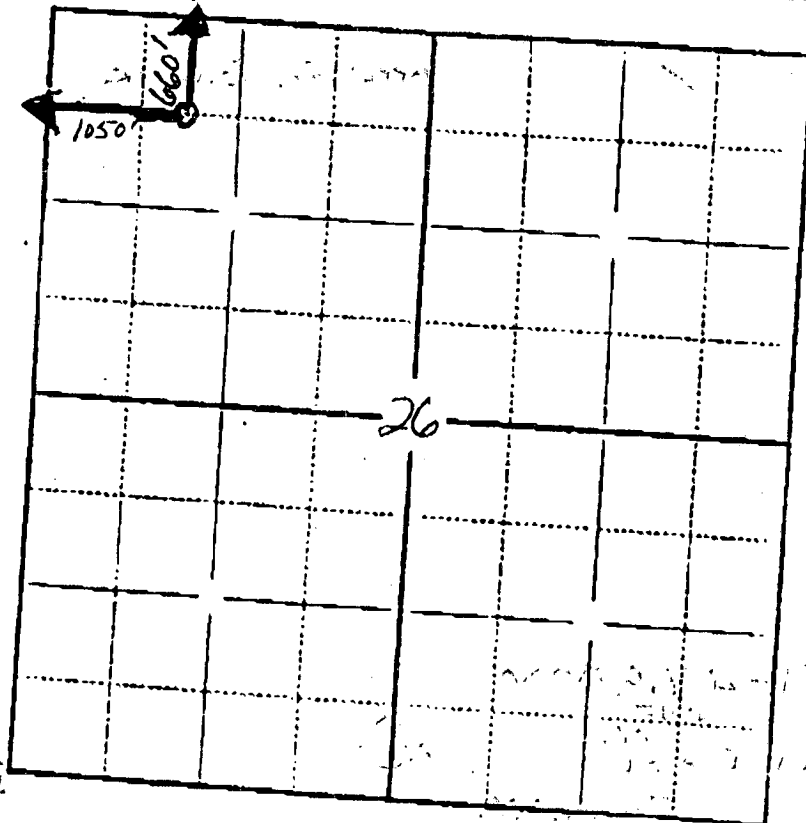

40 ACRES

SEWARD CO.

In plotting the proposed location of the well, you must show:

- 1) The manner in which you are using the depicted plat by identifying section lines, i.e. 1 section, 1 section with 8 surrounding sections, 4 sections, etc.;
- 2) the distance of the proposed drilling location from the section's south/north and east/west lines; and
- 3) the distance to the nearest lease or unit boundary line.