

FOR KCC USE:

FORM C-1 7/91

EFFECTIVE DATE: 6-22-92

State of Kansas

FORM MUST BE TYPED

DISTRICT # 11

NOTICE OF INTENTION TO DRILL

FORM MUST BE SIGNED

SEAT Yes No

Must be approved by the K.C.C. five (5) days prior to commencing well

ALL BLANKS MUST BE FILLED

Expected Spud Date June 27 1992  
month day year

Spot NE 4 17 42 East West

OPERATOR: License # 3317  
Name: Beard Oil Company  
Address: 5600 N. May Ave. Suite 200  
City/State/Zip: Oklahoma City, OK 73112  
Contact Person: Ivan D. Allred, Jr.  
Phone: (405) 842-2333

7.04 feet from XXXX North line of Section  
1995 feet from East / XXXX line of Section  
IS SECTION REGULAR X IRREGULAR?

CONTRACTOR: License # 30606  
Name: Murfin Drilling Company, Inc.

(NOTE: Locate well on the Section Plat on Reverse Side)  
County: Greeley  
Lease Name: Steele Well #: 1-4  
Field Name: Wildcat

Well Drilled For: Well Class: Type Equipment:  
X Oil ... Enh Rec ... Infield X Mud Rotary  
... Gas ... Storage ... Pool Ext. ... Air Rotary  
... OWMO ... Disposal X Wildcat ... Cable  
... Seismic; ... # of Holes ... Other  
... Other

Is this a Prorated/Spaced Field? ... yes X no  
Target Formation(s): Marrow  
Nearest lease or unit boundary: 660'  
Ground Surface Elevation: 3845' (Est.) ... feet MSL

If OWMO: old well information as follows:  
Operator: \_\_\_\_\_  
Well Name: \_\_\_\_\_  
Comp. Date: \_\_\_\_\_ Old Total Depth \_\_\_\_\_

Water well within one-quarter mile: ... yes X no  
Public water supply well within one mile: ... yes X no  
Depth to bottom of fresh water: 240-220  
Depth to bottom of usable water: 1900-1995  
Surface Pipe by Alternate: ... 1 X 2  
Length of Surface Pipe Planned to be set: 350'

Directional, Deviated or Horizontal wellbore? ... yes X no  
If yes, true vertical depth: \_\_\_\_\_  
Bottom Hole Location: \_\_\_\_\_

Length of Conductor pipe required: ... NA  
Projected Total Depth: 5300  
Formation at Total Depth: Mississippi Lime

Water Source for Drilling Operations:  
... well ... farm pond X other  
DWR Permit #: \_\_\_\_\_  
Will Cores Be Taken?: ... yes X no  
If yes, proposed zone: \_\_\_\_\_

**AFFIDAVIT**

The undersigned hereby affirms that the drilling, completion and eventual plugging of this well will comply with K.S.A. 55-101, et. seq.  
It is agreed that the following minimum requirements will be met:

1. Notify the appropriate district office prior to spudding of well;
2. A copy of the approved notice of intent to drill shall be posted on each drilling rig;
3. The minimum amount of surface pipe as specified below shall be set by circulating cement to the top; in all cases surface pipe shall be set through all unconsolidated materials plus a minimum of 20 feet into the underlying formation;
4. If the well is dry hole, an agreement between the operator and the district office on plug length and placement is necessary prior to plugging;
5. The appropriate district office will be notified before well is either plugged or production casing is cemented in;
6. IF AN ALTERNATE IS COMPLETION, PRODUCTION PIPE SHALL BE CEMENTED FROM BELOW ANY USABLE WATER TO SURFACE WITHIN 120 DAYS OF SPUD DATE. IN ALL CASES, NOTIFY DISTRICT OFFICE PRIOR TO ANY CEMENTING.

I hereby certify that the statements made herein are true and to the best of my knowledge and belief.  
Date: 6-15-92 Signature of Operator or Agent: Ivan D. Allred, Jr. Title: Vice President

FOR KCC USE:  
API # 15- 071-20563-00-00  
Conductor pipe required None feet  
Minimum surface pipe required 240 feet per Alt. Y(2)  
Approved by: C.B. 6-17-92  
This authorization expires: 12-17-92  
(This authorization void if drilling not started within 6 months of effective date.)  
Spud date: \_\_\_\_\_ Agent: \_\_\_\_\_

RECEIVED  
STATE CONSERVATION COMMISSION  
JUN 17 1992  
06-17-1992  
CONSERVATION DIVISION  
Wichita, Kansas

**REMEMBER TO:**

- File Drill Pit Application (form CDP-1) with Intent to Drill;
- File Completion Form ACO-1 within 120 days of spud date;
- File acreage attribution plat according to field proration orders;
- Notify appropriate district office 48 hours prior to workover or re-entry;
- Submit plugging report (CP-4) after plugging is completed;
- Obtain written approval before disposing or injecting salt water.

Mail to: Conservation Division, 200 Colorado Derby Building, 202 W. First St., Wichita, Kansas 67202-1286.

IN ALL CASES PLOT THE INTENDED WELL ON THE PLAT BELOW

**PLAT OF ACREAGE ATTRIBUTABLE TO A WELL IN A PRORATED OR SPACED FIELD**

If the intended well is in a prorated or spaced field, please fully complete this side of the form. If the intended well is in a prorated or spaced field complete the plat below showing that the well will be properly located in relationship to other wells producing from the common source of supply. Please show all the wells within 1 mile of the boundaries of the proposed acreage attribution unit for gas wells and within 1/2 mile of the boundaries of the proposed acreage attribution unit for oil wells.

API NO. 15- \_\_\_\_\_  
 OPERATOR Beard Oil Company LOCATION OF WELL: COUNTY Greeley  
 LEASE Steele 704 feet from ~~XXXXX~~ north line of section  
 WELL NUMBER 1-4 1995 feet from east/~~WEST~~ line of section  
 FIELD Wildcat SECTION 4 TWP 17S RG 42W

NUMBER OF ACRES ATTRIBUTABLE TO WELL 40 IS SECTION \_\_\_\_\_ REGULAR or X IRREGULAR  
 QTR/QTR/QTR OF ACREAGE C - NW - NE IF SECTION IS IRREGULAR, LOCATE WELL FROM NEAREST  
CORNER BOUNDARY.

Section corner used: X NE \_\_\_\_\_ NW \_\_\_\_\_ SE \_\_\_\_\_ SW

**PLAT**

(Show location of the well and shade attributable acreage for prorated or spaced wells.)

(Show footage to the nearest lease or unit boundary line.)

42 West

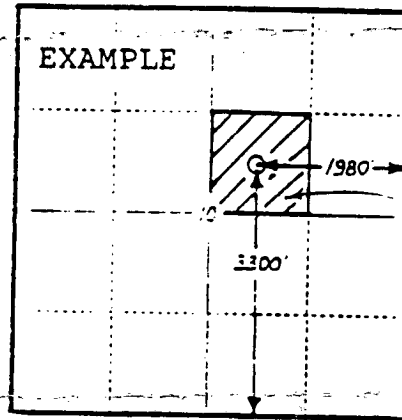
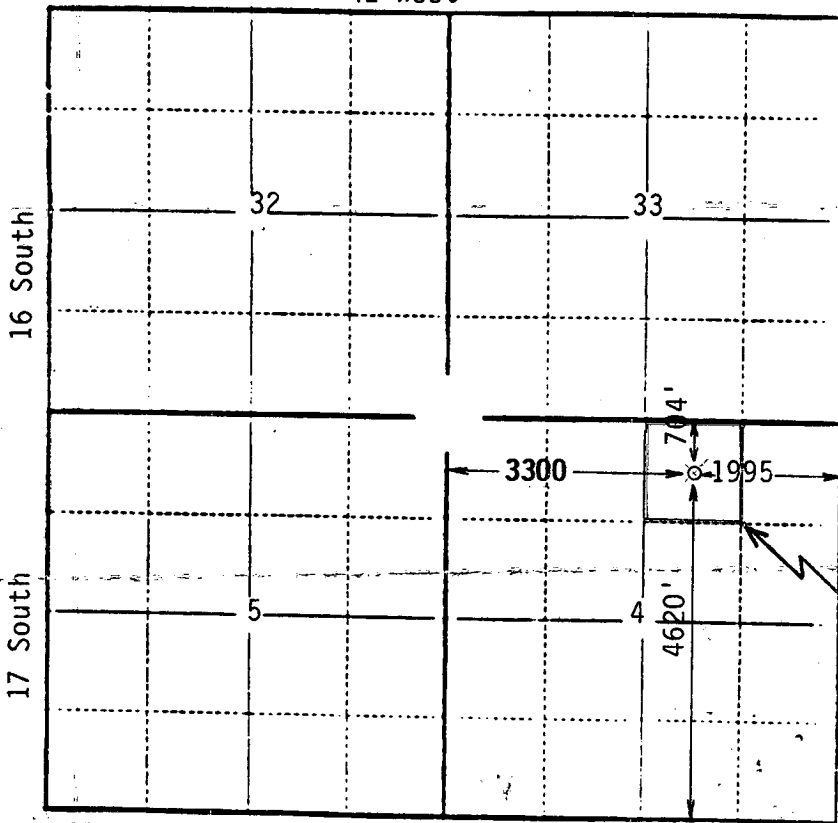

40 ACRES

SEWARD CO.  
40-Acre Outline

GREELEY CO.

**4-SECTION PLAT**

In plotting the proposed location of the well, you must show:

- 1) The manner in which you are using the depicted plat by identifying section lines, i.e. 1 section, 1 section with 8 surrounding sections, 4 sections, etc.;
- 2) the distance of the proposed drilling location from the section's south/north and east/west lines; and
- 3) the distance to the nearest lease or unit boundary line.