

FOR KCC USE:

15-071-20548-0000

FORM C-1 7/91

FORM MUST BE TYPED

FORM MUST BE SIGNED

ALL BLANKS MUST BE FILLED

EFFECTIVE DATE: 8-28-91

State of Kansas

NOTICE OF INTENTION TO DRILL

Must be approved by the K.C.C. five (5) days prior to commencing well

DISTRICT # 1
SEA? Yes X No

Expected Spud Date August 29 1991
month day year

Spot NE NE SW Sec 19 Twp 17 S, Rg 42 East West

OPERATOR: License # 30775
Name: Savant Resources, Inc.
Address: 216 16th Street, Suite 1250
City/State/Zip: Denver, Colorado 80202
Contact Person: Patterson Shaw
Phone: 303-592-1905

2310 feet from South / North line of Section
2970 feet from East / West line of Section
IS SECTION REGULAR X IRREGULAR?

(NOTE: Locate well on the Section Plat on Reverse Side)

County: Greeley
Lease Name: Myers Well #: 1-19
Field Name: Wildcat

CONTRACTOR: License #: unknown at this time
Name:

Is this a Prorated/Spaced Field? yes X no
Target Formation(s): Morrow, Spergen
Nearest lease or unit boundary: 330 feet

Well Drilled For: Well Class: Type Equipment:

Ground Surface Elevation: 3857 feet MSL
Water well within one-quarter mile: yes X no

X Oil ... Enh Rec ... Infield X Mud Rotary
... Gas ... Storage ... Pool Ext. ... Air Rotary
... OWWO ... Disposal X Wildcat ... Cable
... Seismic: ... # of Holes ... Other

Public water supply well within one mile: yes X no
Depth to bottom of fresh water: 250

If OWWO: old well information as follows:

Depth to bottom of usable water: 1960 1760
Surface Pipe by Alternate: 1 X 2

Operator:
Well Name:
Comp. Date: Old Total Depth

Length of Surface Pipe Planned to be set: 350 ft
Length of Conductor pipe required: None

Directional, Deviated or Horizontal wellbore? yes X no

Projected Total Depth: 5400
Formation at Total Depth: Spergen

If yes, true vertical depth:

Water Source for Drilling Operations:
... well X farm pond ... other

Bottom Hole Location:

DWR Permit #:
Will Cores Be Taken?: yes X no

If yes, proposed zone:

AFFIDAVIT

The undersigned hereby affirms that the drilling, completion and eventual plugging of this well will comply with K.S.A. 55-101, et. seq.

It is agreed that the following minimum requirements will be met:

- 1. Notify the appropriate district office prior to spudding of well;
- 2. A copy of the approved notice of intent to drill shall be posted on each drilling rig;
- 3. The minimum amount of surface pipe as specified below shall be set by circulating cement to the top; in all cases surface pipe shall be set through all unconsolidated materials plus a minimum of 20 feet into the underlying formation;
- 4. If the well is dry hole, an agreement between the operator and the district office on plug length and placement is necessary prior to plugging;
- 5. The appropriate district office will be notified before well is either plugged or production casing is cemented in;
- 6. IF AN ALTERNATE II COMPLETION, PRODUCTION PIPE SHALL BE CEMENTED FROM BELOW ANY USABLE WATER TO SURFACE WITHIN 120 DAYS OF SPUD DATE. IN ALL CASES, NOTIFY DISTRICT OFFICE PRIOR TO ANY CEMENTING.

I hereby certify that the statements made herein are true and to the best of my knowledge and belief.

Date: Signature of Operator or Agent: Title: President

RECEIVED STATE CONSERVATION COMMISSION

AUG 23 1991 08-23-1991
Conservation Commission
Wichita Kansas

FOR KCC USE:
API # 15- 071-20548-00-00
Conductor pipe required 1200 feet
Minimum surface pipe required 200 feet per Alt. 2
Approved by: MAW 8-23-91
This authorization expires: 2-23-92
(This authorization void if drilling not started within 6 months of effective date.)
Spud date: Agent:

REMEMBER TO:

- File Drill Pit Application (form CDP-1) with Intent to Drill;
- File Completion Form ACO-1 within 120 days of spud date;
- File acreage attribution plat according to field proration orders;
- Notify appropriate district office 48 hours prior to workover or re-entry;
- Submit plugging report (CP-4) after plugging is completed;
- Obtain written approval before disposing or injecting salt water.

Mail to: Conservation Division, 200 Colorado Derby Building, 202 W. First St., Wichita, Kansas 67202-1286.

15 17 126

IN ALL CASES PLOT THE INTENDED WELL ON THE PLAT BELOW

PLAT OF ACREAGE ATTRIBUTABLE TO A WELL IN A PRORATED OR SPACED FIELD

If the intended well is in a prorated or spaced field, please fully complete this side of the form. If the intended well is in a prorated or spaced field complete the plat below showing that the well will be properly located in relationship to other wells producing from the common source of supply. Please show all the wells within 1 mile of the boundaries of the proposed acreage attribution unit for gas wells and within 1/2 mile of the boundaries of the proposed acreage attribution unit for oil wells.

API NO. 15- _____
 OPERATOR _____
 LEASE _____
 WELL NUMBER _____
 FIELD _____

LOCATION OF WELL: COUNTY _____
 _____ feet from south/north line of section
 _____ feet from east/west line of section
 SECTION _____ TWP _____ RG _____

NUMBER OF ACRES ATTRIBUTABLE TO WELL _____
 QTR/QTR/QTR OF ACREAGE _____

IS SECTION _____ REGULAR or _____ IRREGULAR
IF SECTION IS IRREGULAR, LOCATE WELL FROM NEAREST CORNER BOUNDARY.

Section corner used: _____ NE _____ NW SE _____ SW
PLAT

(Show location of the well and shade attributable acreage for prorated or spaced wells.)
 (Show footage to the nearest lease or unit boundary line.)

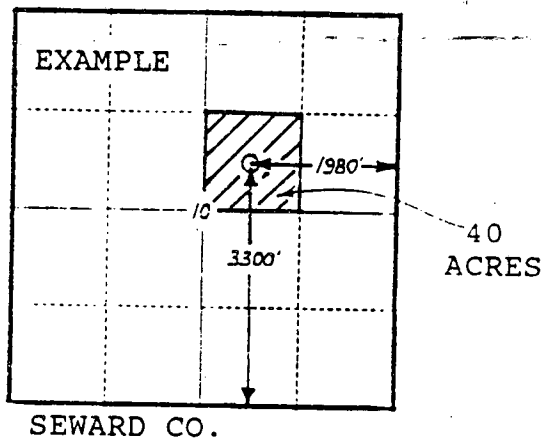
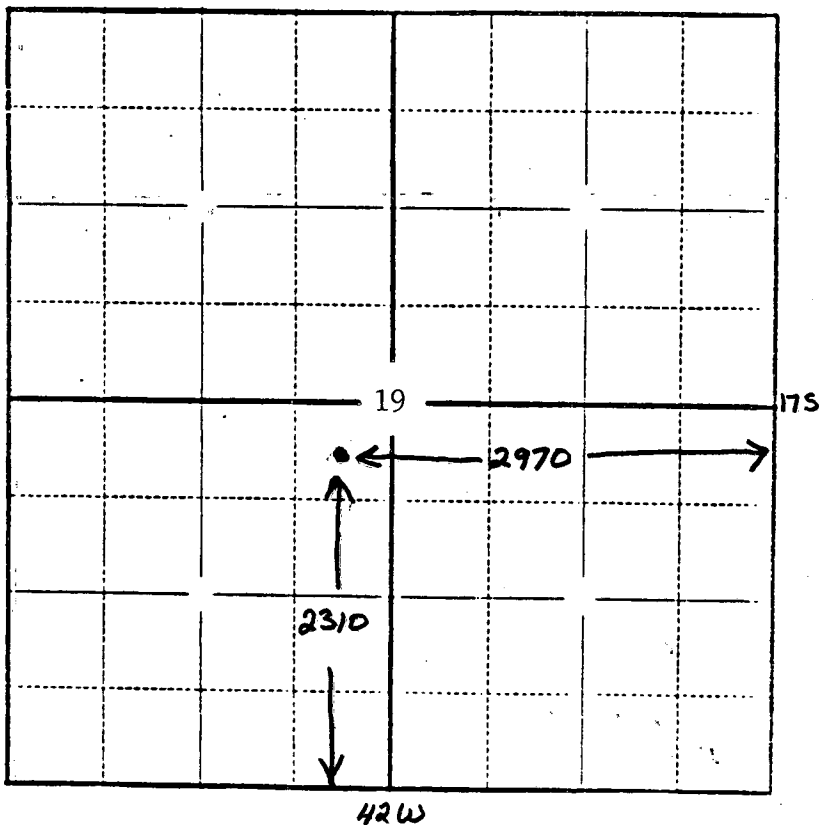

In plotting the proposed location of the well, you must show:

- 1) The manner in which you are using the depicted plat by identifying section lines, i.e. 1 section, 1 section with 8 surrounding sections, 4 sections, etc.;
- 2) the distance of the proposed drilling location from the section's south/north and east/west lines; and
- 3) the distance to the nearest lease or unit boundary line.