

FOR KCC USE:

15-071-20553-0000

FORM C-1 7/91

EFFECTIVE DATE: 11-24-91

State of Kansas

FORM MUST BE TYPED

DISTRICT #

NOTICE OF INTENTION TO DRILL

FORM MUST BE SIGNED

SGA? Yes X No

Must be approved by the K.C.C. five (5) days prior to commencing well

ALL BLANKS MUST BE FILLED

Expected Spud Date November 25 1991 month day year

Spot NW SE NW Sec 19 Twp 17 S, Rg 42 East West

OPERATOR: License # 30775 Name: Savant Resources, Inc. Address: 216 16th Street, Suite 1250 City/State/Zip: Denver, CO 80202 Contact Person: Patterson Shaw Phone: (303) 592-1905

1450 feet from South / North line of Section 1450 feet from East West line of Section

IS SECTION REGULAR X IRREGULAR? (NOTE: Locate well on the Section Plat on Reverse Side)

CONTRACTOR: License #: unknown at this time Name:

County: Greeley

Lease Name: Kohn Well #: 1-19

Field Name: Wilcat

Is this a Prorated/Spaced Field? yes X no

Target Formation(s): Morrow

Nearlest lease or unit boundary: 975

Ground Surface Elevation: 3837 feet MSL

Water well within one-quarter mile: yes X no

Public water supply well within one mile: yes X no

Depth to bottom of fresh water: 250

Depth to bottom of usable water: 1760

Surface Pipe by Alternate: 1 X 2

Length of Surface Pipe Planned to be set: 350 ft

Length of Conductor pipe required: None

Projected Total Depth: 5200 ft

Formation at Total Depth: Mississippian Keyes

Water Source for Drilling Operations: well X farm pond other

DWR Permit #:

Will Cores Be Taken?: yes X no

If yes, proposed zone:

Well Drilled For: Well Class: Type Equipment: X Oil Enh Rec Infield Mud Rotary Gas Storage Pool Ext Air Rotary OWD Disposal X Wildcat Cable Seismic # of Holes Other If OWD: old well information as follows: Operator: Well Name: Comp. Date: Old Total Depth

Directional, Deviated or Horizontal wellbore? yes X no

If yes, true vertical depth:

Bottom Hole Location:

AFFIDAVIT

The undersigned hereby affirms that the drilling, completion and eventual plugging of this well will comply with K.S.A. 55-101, et. seq.

It is agreed that the following minimum requirements will be met:

- 1. Notify the appropriate district office prior to spudding of well;
2. A copy of the approved notice of intent to drill shall be posted on each drilling rig;
3. The minimum amount of surface pipe as specified below shall be set by circulating cement to the top; in all cases surface pipe shall be set through all unconsolidated materials plus a minimum of 20 feet into the underlying formation;
4. If the well is dry hole, an agreement between the operator and the district office on plug length and placement is necessary prior to plugging;
5. The appropriate district office will be notified before well is either plugged or production casing is cemented in;
6. IF AN ALTERNATE II COMPLETION, PRODUCTION PIPE SHALL BE CEMENTED FROM BELOW ANY USABLE WATER TO SURFACE WITHIN 120 DAYS OF SPUD DATE. IN ALL CASES, NOTIFY DISTRICT OFFICE PRIOR TO ANY CEMENTING.

I hereby certify that the statements made herein are true and to the best of my knowledge and belief.

Date: 11-18-91 Signature of Operator or Agent: Title: President

FOR KCC USE: API # 15-071-20553-00-00 Conductor pipe required None feet Minimum surface pipe required 270 feet per Alt. X(2) Approved by: DA 11-19-91 This authorization expires: 5-19-92 (This authorization void if drilling not started within 6 months of effective date.) Spud date: Agent:

RECEIVED KANSAS CORPORATION COMMISSION NOV 19 1991 CONSERVATION DIVISION WICHITA, KS

REMEMBER TO:

- File Drill Pit Application (form CDP-1) with Intent to Drill;
- File Completion Form ACO-1 within 120 days of spud date;
- File acreage attribution plat according to field proration orders;
- Notify appropriate district office 48 hours prior to workover or re-entry;
- Submit plugging report (CP-4) after plugging is completed;
- Obtain written approval before disposing or injecting salt water.

Mail to: Conservation Division, 200 Colorado Derby Building, 202 W. First St., Wichita, Kansas 67202-1286.

19 17 42

IN ALL CASES PLOT THE INTENDED WELL ON THE PLAT BELOW

**PLAT OF ACREAGE ATTRIBUTABLE TO A WELL IN A PRORATED OR SPACED FIELD**

If the intended well is in a prorated or spaced field, please fully complete this side of the form. If the intended well is in a prorated or spaced field complete the plat below showing that the well will be properly located in relationship to other wells producing from the common source of supply. Please show all the wells within 1 mile of the boundaries of the proposed acreage attribution unit for gas wells and within 1/2 mile of the boundaries of the proposed acreage attribution unit for oil wells.

API NO. 15- \_\_\_\_\_  
 OPERATOR Savant Resources, Inc.  
 LEASE Kohn  
 WELL NUMBER 1-19  
 FIELD Wildcat

LOCATION OF WELL: COUNTY Greeley  
1450 feet from ~~south~~/north line of section  
1450 feet from ~~east~~/west line of section  
 SECTION 19 TWP 17S RG 42W

NUMBER OF ACRES ATTRIBUTABLE TO WELL \_\_\_\_\_  
 QTR/QTR/QTR OF ACREAGE \_\_\_\_\_

IS SECTION \_\_\_\_\_ REGULAR or X IRREGULAR  
IF SECTION IS IRREGULAR, LOCATE WELL FROM NEAREST CORNER BOUNDARY.

Section corner used: \_\_\_\_\_ NE \* NW X \_\_\_\_\_ SE \_\_\_\_\_ SW  
**PLAT**

(Show location of the well and shade attributable acreage for prorated or spaced wells.)  
 (Show footage to the nearest lease or unit boundary line.)

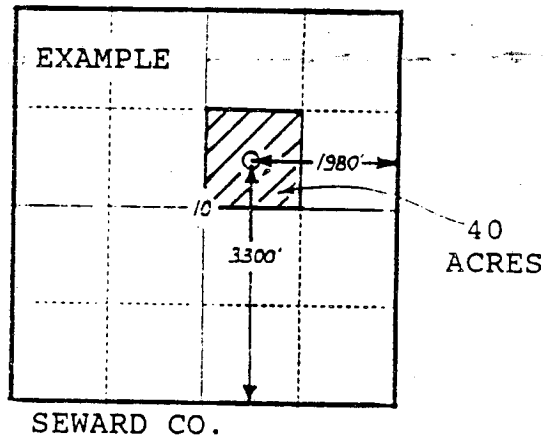
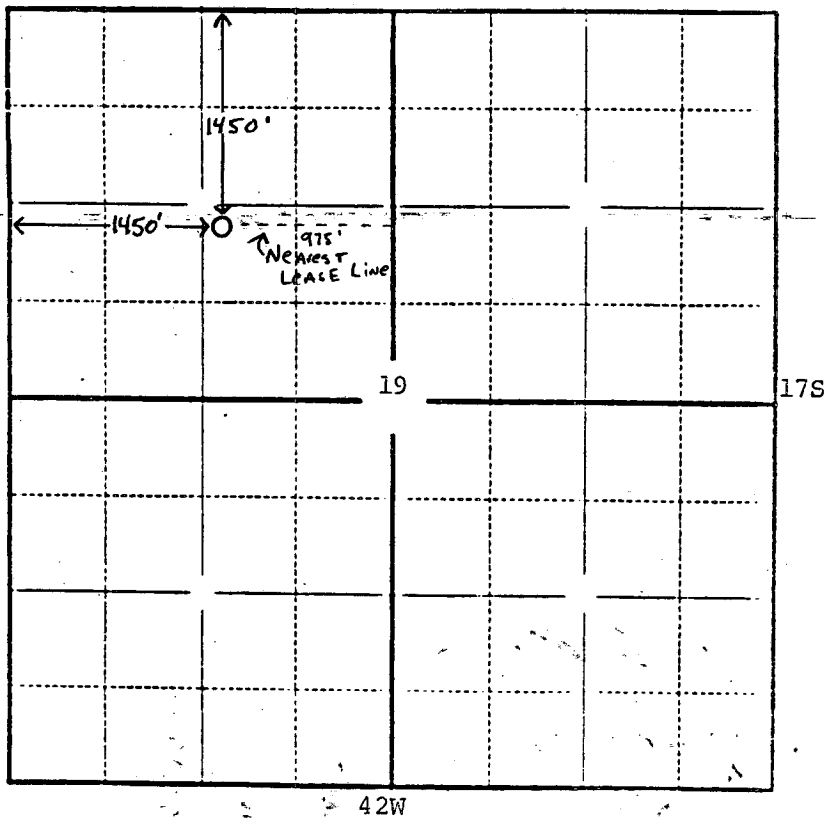

In plotting the proposed location of the well, you must show:

- 1) The manner in which you are using the depicted plat by identifying section lines, i.e. 1 section, 1 section with 8 surrounding sections, 4 sections, etc.;
- 2) the distance of the proposed drilling location from the section's south/north and east/west lines; and
- 3) the distance to the nearest lease or unit boundary line.