

STATE CORPORATION COMMISSION OF KANSAS  
OIL & GAS CONSERVATION DIVISION  
WELL COMPLETION OR RECOMPLETION FORM  
ACO-1 WELL HISTORY  
DESCRIPTION OF WELL AND LEASE

5

API No. 15-.....  
County..... Wallace  
SW/4 ..... Sec. 36 Twp. 14 Rge. 43 East  
..... West

Operator: License # 5171  
Name TXO PRODUCTION CORP.  
Address 1660 Lincoln St.  
Suite 1800  
City/State/Zip Denver, CO 80264

1780 ..... Ft North from Southeast Corner of Section  
1340 ..... Ft West from Southeast Corner of Section  
(Note: Locate well in section plat below)

Purchaser..... None

Lease Name..... Purvis Farms Well #..... 3

Operator Contact Person .. Russ Gillis  
Phone (303) 861-4246

Field Name..... Arapahoekan

Producing Formation..... Morrow Sand

Contractor: License # 6033  
Name .. Murfin Drilling Co.

Elevation: Ground..... 3903' ..... 3908' KB.....

Wellsite Geologist..... None  
Phone.....

RECEIVED  
STATE CORPORATION COMMISSION

Designate Type of Completion  
 New Well  Re-Entry  Workover  
 Oil  SWD  Temp Abd  
 Gas  Inj  Delayed Comp  
 Dry  Other (Core, Water Supply etc.)

FEB 15 1989  
02-15-89  
CONSERVATION DIVISION  
Wichita, Kansas

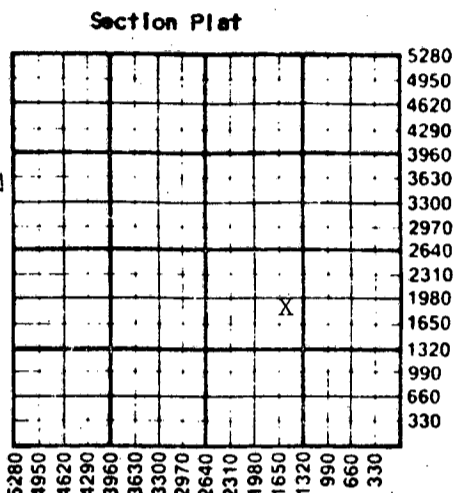

If OWN: old well info as follows:  
Operator .....  
Well Name .....  
Comp. Date ..... Old Total Depth.....

WATER SUPPLY INFORMATION

Disposition of Produced Water:  Disposal  
Docket # .....  Repressuring  
N/A

WELL HISTORY  
Drilling Method:  
 Mud Rotary  Air Rotary  Cable  
1-26-88 ..... 2-4-88 ..... 2-23-88 .....  
Spud Date Date Reached TD Completion Date  
5300' ..... 5285' .....  
Total Depth PBTD

Questions on this portion of the ACO-1 call:  
Water Resources Board (913) 296-3717  
Source of Water:  
Division of Water Resources Permit #.....  
 Groundwater..... Ft North from Southeast Corner  
(Well) ..... Ft West from Southeast Corner of  
Sec Twp Rge East West  
 Surface Water..... Ft North from Southeast Corner  
(Stream, pond etc)..... Ft West from Southeast Corner  
Sec Twp Rge East West  
 Other (explain).....  
(purchased from city, R.W.D. #)

Amount of Surface Pipe Set and Cemented at 688 feet  
Multiple Stage Cementing Collar Used?  Yes  No  
If yes, show depth set..... 1987 ..... feet  
If alternate 2 completion, cement circulated  
from..... 1987 ..... feet depth to Surface, 360 SX cmt  
Cement Company Name .. Halliburton  
Invoice # ..... 646094  
2-28-89

INSTRUCTIONS: This form shall be completed in triplicate and filed with the Kansas Corporation Commission, 200 Colorado Derby Building, Wichita, Kansas 67202, within 120 days of the spud date of any well. Rule 82-3-130, 82-3-107 and 82-3-106 apply. Information on side two of this form will be held confidential for a period of 12 months if requested in writing and submitted with the form. See rule 82-3-107 for confidentiality in excess of 12 months. One copy of all wireline logs and drillers time log shall be attached with this form. Submit CP-4 form with all plugged wells. Submit CP-111 form with all temporarily abandoned wells.

All requirements of the statutes, rules and regulations promulgated to regulate the oil and gas industry have been fully complied with and the statements herein are complete and correct to the best of my knowledge.

Signature ..... Russ E. Gillis  
Title..... Petroleum Engineer Date 2-8-89

K.C.C. OFFICE USE ONLY  
F Letter of Confidentiality Attached  
C Wireline Log Received  
C Drillers Timelog Received  
Distribution  
 KCC  SWD/Rep  NGPA  
 KGS  Plug  Other  
(Specify)  
2-15-89  
Form ACO-1 (5-86)

Subscribed and sworn to before me this 8th day of February, 1989.  
Notary Public  
Date Commission Expires Sept 30, 1990

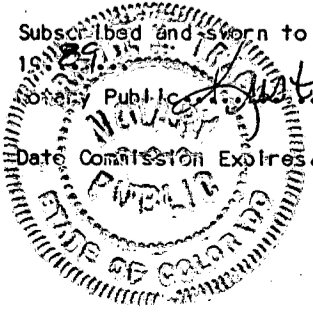

Sec 36 Twp 14 Rge 43

SIDE TWO

Operator Name TXO PRODUCTION CORP. Lease Name Purvis Farms Well # 3

Sec. 36 Twp. 14 Rge. 43  East  West County Wallace

WELL LOG

INSTRUCTIONS: Show important tops and base of formations penetrated. Detail all cores. Report all drill stem tests giving interval tested, time tool open and closed, flowing and shut-in pressures, whether shut-in pressure reached static level, hydrostatic pressures, bottom hole temperature, fluid recovery, and flow rates if gas to surface during test. Attach extra sheet if more space is needed. Attach copy of log.

Drill Stem Tests Taken  Yes  No  
 Samples Sent to Geological Survey  Yes  No  
 Cores Taken  Yes  No

Formation Description  
 Log  Sample

DST #1 5125-85 Morrow  
 IFP, weakblow inc to 4" in bucket.  
 FFP, weakblow inc to 6" in bucket.  
 30" IFP, 104-120 psi; 60" ISIP 798 psi  
 45" FFP, 141-141 psi; 90' FSIP 831 psi  
 Rec 230' total fluid (130' SOCM (10% oil)  
 90' HOGCM (25% oil), 10' free oil)

Name	Top	Bottom
Morrow	5044'	5120'

CASING RECORD <input checked="" type="checkbox"/> New <input type="checkbox"/> Used							
Report all strings set-conductor, surface, intermediate, production, etc.							
Purpose of String	Size Hole Drilled	Size Casing Set (in O.D.)	Weight Lbs/Ft.	Setting Depth	Type of Cement	#Sacks Used	Type and Percent Additives
Surface	12-1/4	8-5/8	24	688'	Common	200	3% CaCl <sub>2</sub>
Production	7-7/8	4-1/2	10.5	5295'	Cl" H"	150	1/4#/sx floeal
PERFORATION RECORD				Acid, Fracture, Shot, Cement Squeeze Record			
Shots Per Foot	Specify Footage of Each Interval Perforated			(Amount and Kind of Material Used)			Depth
4	5132' - 5137'			250 gal 7-1/2% FE acid 11,000 gal gelled diesel & 5,250# 12-20 sd			5132' 5132'
TUBING RECORD				Liner Run <input type="checkbox"/> Yes <input checked="" type="checkbox"/> No			
Date of First Production		Size 2-3/8"		Set At 5088'		Packer at	
N/A		Producing Method <input type="checkbox"/> Flowing <input type="checkbox"/> Pumping <input type="checkbox"/> Gas Lift <input checked="" type="checkbox"/> Other (explain) Swabbing					
Estimated Production Per 24 Hours		Oil	Gas	Water	Gas-Oil Ratio	Gravity	
2 Bbls		0 MCF	0 Bbls	-	CFPB	N/A	

METHOD OF COMPLETION

Production Interval

Disposition of gas:  Vented  Sold  Used on Lease  
 Open Hole  Perforation  
 Other (Specify) .....  
 Dually Completed  Commingled

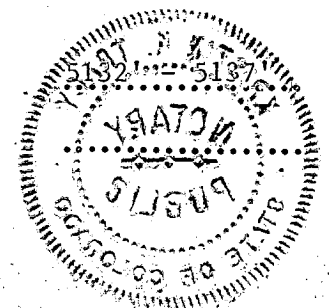

DISTRICT COPY  
**INVOICE**  
 INVOICE



REMIT TO:  
 P.O. BOX 651046  
 DALLAS, TX 75265

15-199-20137-00-00

INVOICE NO. 646094	DATE 02/11/19
--------------------	---------------

A DIVISION OF HALLIBURTON COMPANY

WELL LEASE NO. PURVIS FARMS 3		WELL LOCATION WALLACE		STATE KS	WELL OWNER SAME
SERVICE LOCATION LAMAR		CONTRACTOR GIBSON	JOB PURPOSE TOP OUTSIDE PRODUCTION CASING		TICKET DATE 02/11/1988
ACCT. NO. 882417	CUSTOMER AGENT ALLEN F. DICK	VENDOR NO.	CUSTOMER P.O. NUMBER	SHIPPED VIA COMPANY TRUCK	FILE NO. 5371

T X O PRODUCTION CORP  
 RURAL ROUTE 1  
 BOX 125B  
 MEDICINE LODGE, KS 67104

DIRECT CORRESPONDENCE TO:  
 SUITE 600  
 COLORADO DERBY BUILDING  
 WICHITA, KS 67202-0000

PRICE REF. NO.	DESCRIPTION	QUANTITY	U/M	UNIT PRICE	AMOUNT
000-117	MILEAGE	55	MI	2.10	115.50
009-134	SQUEEZING CEMENT	1987	FT	879.00	879.00
009-019		1	UNT		
116-436	FO CMTR OPEN/CLOSE POSITIONER	1	EA	155.00	155.00
504-120	HALL. LIGHT MADE WITH PREMIUM	360	SK	6.29	2,264.40
500-207	BULK SERVICE CHARGE	360	CFT	.95	342.00
500-306	MILEAGE	912.78	TMI	.70	638.95
INVOICE SUBTOTAL					4,394.85
DISCOUNT-(BID)					878.97-
INVOICE BID AMOUNT					3,515.88
*-KANSAS STATE SALES TAX					EXEMPT
INVOICE TOTAL - PLEASE PAY THIS AMOUNT					\$3,515.88

RECEIVED  
 STATE CORPORATION COMMISSION

FEB 15 1989

CONSERVATION DIVISION  
 Wichita, Kansas

FORM 1900 - B1

TERMS

INVOICES PAYABLE NET BY THE 20TH OF THE FOLLOWING MONTH AFTER DATE OF INVOICE. UPON CUSTOMER'S DEFAULT IN PAYMENT OF CUSTOMER'S ACCOUNT BY THE LAST DAY OF THE MONTH FOLLOWING THE MONTH IN WHICH THE INVOICE IS DATED, CUSTOMER AGREES TO PAY INTEREST THEREON AFTER DEFAULT AT THE HIGHEST LAWFUL CONTRACT RATE APPLICABLE BUT NEVER TO EXCEED 18% PER ANNUM. IN THE EVENT IT BECOMES NECESSARY TO EMPLOY AN ATTORNEY TO ENFORCE COLLECTION OF SAID ACCOUNT, CUSTOMER AGREES TO PAY ALL COLLECTION COSTS AND

**HALLIBURTON SERVICES**  
Duncan, Oklahoma 73536

A Division of Halliburton Company

TICKET NO. **646094-9**

FORM 1906 R-11

15-199-20137-00.00

WELL NO. - FARM OR LEASE NAME <b>3 PURVIS FARMS</b>		COUNTY <b>WALLACE</b>	STATE <b>KS</b>	CITY / OFFSHORE LOCATION	DATE <b>2-11-88</b>
CHARGE TO <b>T X O</b>		OWNER		TICKET TYPE (CHECK ONE) SERVICE <input checked="" type="checkbox"/> SALES <input type="checkbox"/>	NITROGEN JOB YES <input type="checkbox"/> NO <input checked="" type="checkbox"/>
ADDRESS		CONTRACTOR <b>GILSON</b>		LOCATION <b>1 LAMAR CO</b>	CODE <b>50411-</b>
CITY, STATE, ZIP		SHIPPED VIA	FREIGHT CHARGES <input type="checkbox"/> PPD <input type="checkbox"/> COLLECT	LOCATION <b>2</b>	CODE
WELL TYPE <b>01</b>	WELL CATEGORY <b>01</b>	WELL PERMIT NO.	DELIVERED TO	LOCATION <b>3</b>	CODE
TYPE AND PURPOSE OF JOB <b>030</b>		ORDER NO. <b>B-544823</b>	REFERRAL LOCATION		

As consideration, the above-named Customer agrees to pay Halliburton in accord with the rates and terms stated in Halliburton's current price lists. Invoices payable NET by the 20th of the following month after date of invoice. Upon Customer's default in payment of Customer's account by the last day of the month following the month in which the invoice is dated, Customer agrees to pay interest thereon after default at the highest lawful contract rate applicable, but never to exceed 18% per annum. In the event it becomes necessary to employ an attorney to enforce collection of said account, Customer agrees to pay all collection costs and attorney fees in the amount of 20% of the amount of the unpaid account. These terms and conditions shall be governed by the law of the state where services are performed or equipment or materials are furnished. Halliburton warrants only title to the products, supplies and materials and that the same are free from defects in workmanship and materials. THERE ARE NO WARRANTIES, EXPRESS OR IMPLIED, OF MERCHANTABILITY, FITNESS FOR A PARTICULAR PURPOSE OR OTHERWISE WHICH EXTEND BEYOND THOSE STATED IN THE IMMEDIATELY PRECEDING SENTENCE. Halliburton's liability and customer's exclusive remedy in any cause of action (whether in contract, tort, product liability, breach of warranty or otherwise) arising out of the sale or use of any products, supplies or materials is expressly limited to the replacement of such products, supplies or materials on their return to Halliburton or, at Halliburton's option, to the allowance to the customer of credit for the cost of such items. In no event shall Halliburton be liable for special, incidental, indirect, punitive or consequential damages.

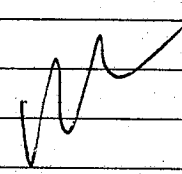
PRICE REFERENCE	SECONDARY REF OR PART NO.	L O C.	ACCOUNT	DESCRIPTION	UNITS 1		UNITS 2		UNIT PRICE	AMOUNT	
					QTY	MEAS	QTY	MEAS			
000-117				MILEAGE	55				210	115	50
009-134				PUMP CHANGE	1987					879	00
116-436				OPENING 1/2" GOLF FINISH	1	50				155	00
											

RECEIVED  
STATE CORPORATION COMMISSION  
FEB 15 1988  
CONSERVATION DIVISION  
Wichita, Kansas

AS PER ATTACHED BULK MATERIAL DELIVERY TICKET NO.

**B-544823**

**3245 35**

WAS JOB SATISFACTORILY COMPLETED? \_\_\_\_\_

WAS OPERATION OF EQUIPMENT SATISFACTORY? \_\_\_\_\_

WAS PERFORMANCE OF PERSONNEL SATISFACTORY? \_\_\_\_\_

X **Allen E Dick**  
CUSTOMER OR HIS AGENT (PLEASE PRINT)

X **[Signature]**  
CUSTOMER OR HIS AGENT (SIGNATURE)

WE CERTIFY THAT THE FAIR LABOR STANDARDS ACT OF 1938, AS AMENDED HAS BEEN COMPLIED WITH IN THE PRODUCTION OF GOODS AND OR WITH RESPECT TO SERVICES FURNISHED UNDER THIS CONTRACT.

**[Signature]**  
HALLIBURTON OPERATOR

HALLIBURTON APPROVAL \_\_\_\_\_

FIELD OFFICE

SUB TOTAL **4394 85**  
APPLICABLE TAXES WILL BE ADDED ON INVOICE.



WORK ORDER CONTRACT  
AND PRE-TREATMENT DATA

ATTACH TO  
INVOICE & TICKET NO. **646094**

DISTRICT LIBERAL KS DATE 2-11-88

TO: HALLIBURTON SERVICES YOU ARE HEREBY REQUESTED TO FURNISH EQUIPMENT AND SERVICEMEN TO DELIVER AND OPERATE

THE SAME AS AN INDEPENDENT CONTRACTOR TO: T.X.O. (CUSTOMER)  
AND DELIVER AND SELL PRODUCTS, SUPPLIES, AND MATERIALS FOR THE PURPOSE OF SERVICING

WELL NO. 3 LEASE PUMPKIN FARMS SEC. 36 TWP. 14 RANGE 43

FIELD \_\_\_\_\_ COUNTY WALLACE STATE KS OWNED BY \_\_\_\_\_

THE FOLLOWING INFORMATION WAS FURNISHED BY THE CUSTOMER OR HIS AGENT

FORMATION NAME	TYPE	NEW USED	WEIGHT	SIZE	FROM	TO	MAX. ALLOW. P.S.I.
FORMATION THICKNESS	FROM TO						
PACKER: TYPE	SET AT						
TOTAL DEPTH	MUD WEIGHT						
BORE HOLE							SHOTS/FT.
INITIAL PROD: OIL _____ BPD, H <sub>2</sub> O _____ BPD, GAS _____ MCF							
PRESENT PROD: OIL _____ BPD, H <sub>2</sub> O _____ BPD, GAS _____ MCF							

PREVIOUS TREATMENT: DATE \_\_\_\_\_ TYPE \_\_\_\_\_ MATERIALS \_\_\_\_\_

TREATMENT INSTRUCTIONS: TREAT THRU TUBING  ANNULUS  CASING  TUBING/ANNULUS  HYDRAULIC FRACTURING  POWER OPERATED \_\_\_\_\_

Cont 2nd STAGE

RECEIVED  
STATE CORPORATION COMMISSION  
FEB 15 1988

CUSTOMER OR HIS AGENT WARRANTS THE WELL IS IN PROPER CONDITION TO RECEIVE THE PRODUCTS, SUPPLIES, MATERIALS AND SERVICES

THIS CONTRACT MUST BE SIGNED BEFORE WORK IS COMMENCED

- As consideration, the above-named Customer agrees:
- (a) To pay Halliburton in accord with the rates and terms stated in Halliburton's current price lists.
  - (b) Halliburton shall not be responsible for and Customer shall secure Halliburton against any liability for damage to property of Customer and of the well owner (if different from Customer), unless caused by the willful misconduct or gross negligence of Halliburton, this provision applying to but not limited to subsurface damage and surface damage arising from subsurface damage.
  - (c) Customer shall be responsible for and secure Halliburton against any liability for reservoir loss or damage, or property damage resulting from subsurface pressure, losing control of the well and/or a well blowout, unless such loss or damage is caused by the willful misconduct or gross negligence of Halliburton.
  - (d) Customer shall be responsible for and secure Halliburton against any and all liability of whatsoever nature for damages as a result of subsurface trespass, or an action in the nature thereof, arising from a service operation performed by Halliburton hereunder.
  - (e) Customer shall be responsible for and secure Halliburton against any liability for injury to or death of persons, other than employees of Halliburton, or damage to property (including, but not limited to, injury to the well), or any damages whatsoever, irrespective of cause, growing out of or in any way connected with the use of radioactive material in the well hole, unless such damage shall be caused by the willful misconduct or gross negligence of Halliburton.
  - (f) Halliburton makes no guarantee of the effectiveness of the products, supplies or materials, nor of the results of any treatment or service.
  - (g) Customer shall, at its risk and expense, attempt to recover any Halliburton equipment, tools or instruments which are lost in the well and if such equipment, tools or instruments are not recovered, Customer shall pay Halliburton its replacement cost unless such loss is due to the sole negligence of Halliburton. If Halliburton equipment, tools or instruments are damaged in the well, Customer shall pay Halliburton the lesser of its replacement cost or the cost of repairs unless such damage is caused by the sole negligence of Halliburton. In the case of equipment, tools or instruments for marine operations, Customer shall, in addition to the foregoing, be fully responsible for loss of or damage to any of Halliburton's equipment, tools or instruments which occurs at any time after delivery to Customer at the landing until returned to the landing, unless such loss or damage is caused by the sole negligence of Halliburton.
  - (h) Because of the uncertainty of variable well conditions and the necessity of relying on facts and supporting services furnished by others, Halliburton is unable to guarantee the accuracy of any chart interpretation, research analysis, job recommendation or other data furnished by Halliburton. Halliburton personnel will use their best efforts in gathering such information and their best judgment in interpreting it, but Customer agrees that Halliburton shall not be responsible for any damages arising from the use of such information except where due to Halliburton's gross negligence or willful misconduct in the preparation or furnishing of it.
  - (i) Halliburton warrants only title to the products, supplies and materials and that the same are free from defects in workmanship and materials. THERE ARE NO WARRANTIES, EXPRESS OR IMPLIED, OF MERCHANTABILITY, FITNESS OR OTHERWISE WHICH EXTEND BEYOND THOSE STATED IN THE IMMEDIATELY PRECEDING SENTENCE. Halliburton's liability and Customer's exclusive remedy in any cause of action (whether in contract, tort, breach of warranty or otherwise) arising out of the sale or use of any products, supplies or materials is expressly limited to the replacement of such products, supplies or materials on their return to Halliburton or, at Halliburton's option, to the allowance to the Customer of credit for the cost of such items. In no event shall Halliburton be liable for special, incidental, indirect, punitive or consequential damages.
  - (j) Invoices payable NET by the 20th of the following month after date of invoice. Upon Customer's default in payment of Customer's account by the last day of the month following the month in which the invoice is dated, Customer agrees to pay interest thereon after default at the highest lawful contract rate applicable but never to exceed 18% per annum. In the event it becomes necessary to employ an attorney to enforce collection of said account, Customer agrees to pay all collection costs and attorney fees in the amount of 20% of the amount of the unpaid account.
  - (k) This contract shall be governed by the law of the state where services are performed or equipment or materials are furnished.
  - (l) Halliburton shall not be bound by any changes or modifications in this contract, except where such change or modification is made in writing by a duly authorized executive officer of Halliburton.

I HAVE READ AND UNDERSTAND THIS CONTRACT AND REPRESENT THAT I AM AUTHORIZED TO SIGN THE SAME AS CUSTOMER'S AGENT.

SIGNED \_\_\_\_\_ CUSTOMER  
DATE 2-11-88  
TIME 5:00 A.M. P.M.

# HALLIBURTON SERVICES JOB SUMMARY

HALLIBURTON  
DIVISION

WICITA KS 15-199-20137-00-00

HALLIBURTON  
LOCATION

LAMAN CO

BILLED ON  
TICKET NO.

646094

FORM 2025

WELL DATA

FIELD \_\_\_\_\_ SEC. 36 TWP. 14 RNO. 47 COUNTY WALLACE STATE KS

FORMATION NAME	TYPE	NEW USED	WEIGHT	SIZE	FROM	TO	MAXIMUM PSI ALLOWABLE
FORMATION THICKNESS	FROM TO	CASING	U	105	4 1/2	KB	5300
INITIAL PROD: OIL	BPD. WATER	BPD. GAS	MCFD	LINER			
PRESENT PROD: OIL	BPD. WATER	BPD. GAS	MCFD	TUBING	U	47	2 3/4 KB 1987
COMPLETION DATE	MUD TYPE	MUD WT.	OPEN HOLE				SHOTS/FT.
PACKER TYPE	SET AT		PERFORATIONS				
BOTTOM HOLE TEMP.	PRESSURE		PERFORATIONS				
MISC. DATA	TOTAL DEPTH		PERFORATIONS				

TOOLS AND ACCESSORIES

TYPE AND SIZE	QTY.	MAKE
FLOAT COLLAR		
FLOAT SHOE		
GUIDE SHOE		
CENTRALIZERS		
BOTTOM PLUG		
TOP PLUG		
HEAD		
PACKER		
OTHER		

JOB DATA

CALLED OUT	ON LOCATION	JOB STARTED	JOB COMPLETED
DATE 2-11-88	DATE 2-11-88	DATE 2-11-88	DATE 2-11-88
TIME 4:00	TIME 7:30	TIME 8:57	TIME 12:00

RECEIVED  
STATE CORPORATION COMMISSION  
FEB 15 1988  
CONSERVATION DIVISION  
M-1112 KANSAS

MATERIALS

TREAT. FLUID	DENSITY	LB/GAL. API
DISPL. FLUID	DENSITY	LB/GAL. API
PROP. TYPE	SIZE	LB.
PROP. TYPE	SIZE	LB.
ACID TYPE	GAL.	%
ACID TYPE	GAL.	%
ACID TYPE	GAL.	%
SURFACTANT TYPE	GAL.	IN
NE AGENT TYPE	GAL.	IN
FLUID LOSS ADD. TYPE	GAL.-LB.	IN
GELLING AGENT TYPE	GAL.-LB.	IN
FRIC. RED. AGENT TYPE	GAL.-LB.	IN
BREAKER TYPE	GAL.-LB.	IN
BLOCKING AGENT TYPE	GAL.-LB.	
PERFPAC BALLS TYPE	QTY.	
OTHER		
OTHER		

PERSONNEL AND SERVICE UNITS

NAME	UNIT NO. & TYPE	LOCATION
G MOORE	4664	LAMAN CO
B PALMER	1020	
C ASLEY	3369	

DEPARTMENT WT

DESCRIPTION OF JOB 2nd STAGE

JOB DONE THRU: TUBING  CASING  ANNULUS  TBC./ANN.

CUSTOMER REPRESENTATIVE X All

HALLIBURTON OPERATOR \_\_\_\_\_ COPIES REQUESTED \_\_\_\_\_

CEMENT DATA

STAGE	NUMBER OF SACKS	TYPE	API CLASS	BRAND	BULK SACKED	ADDITIVES	YIELD CU.FT./SK.	MIXED LBS./GAL.
1	350	H6C					2.11	125

PRESSURES IN PSI SUMMARY VOLUMES

CIRCULATING \_\_\_\_\_ DISPLACEMENT \_\_\_\_\_ PRESLUSH: BBL.-GAL. \_\_\_\_\_ TYPE \_\_\_\_\_

BREAKDOWN \_\_\_\_\_ MAXIMUM \_\_\_\_\_ LOAD & BKON: BBL.-GAL. \_\_\_\_\_ PAD: BBL.-GAL. \_\_\_\_\_

AVERAGE \_\_\_\_\_ FRACTURE GRADIENT \_\_\_\_\_ TREATMENT: BBL.-GAL. \_\_\_\_\_ DISPL: BBL.-GAL. 7

SHUT-IN: INSTANT \_\_\_\_\_ 5-MIN. \_\_\_\_\_ 15-MIN. \_\_\_\_\_ CEMENT SLURRY: BBL.-GAL. 131

HYDRAULIC HORSEPOWER TOTAL VOLUME: BBL.-GAL. \_\_\_\_\_

ORDERED \_\_\_\_\_ AVAILABLE \_\_\_\_\_ USED \_\_\_\_\_ REMARKS \_\_\_\_\_

AVERAGE RATES IN BPM

TREATING \_\_\_\_\_ DISPL. \_\_\_\_\_ OVERALL \_\_\_\_\_

CEMENT LEFT IN PIPE

FEET \_\_\_\_\_ REASON \_\_\_\_\_

CUSTOMER T-X-O  
LEASE PURVIS FORMS WELL NO. 3  
JOB TYPE 2nd STAGE  
DATE 2-11-88

HALLIBURTON SERVICES  
JOB LOG

WELL NO. 3 LEASE PUBLIS FARM TICKET NO. 646094  
 CUSTOMER T.X.O. PAGE NO. 15-199-20137-00-00  
 JOB TYPE 2nd STAGE DATE 2-11-84

FORM 2013 R-2

CHART NO.	TIME	RATE (BPM)	VOLUME (BBL) (GAL)	PUMPS		PRESSURE (PSI)		DESCRIPTION OF OPERATION AND MATERIALS
				T	C	TUBING	CASING	
								36, 14, 43
								WALLACE KS
	7:30							BEG ON LOC
	7:30							ON LOC
	8:53							RUN TOOLS
1	11:00						500	TEST SLEEVE
2								OPEN II
3			2				500	LIN HOLF
							500	START CRT
4		6	131				1500	FINISH LIN
							1500	START DISP
5		5	7				1500	FINISH II
6								CLOSE SLEEVE
7						400	900	TEST II
8	11:40	5	25				750	REV OUT

RECEIVED  
STATE CORPORATION COMMISSION

FEB 15 1984

CONSERVATION DIVISION  
Wichita, Kansas



15-199-20137-00-00

RECEIVED  
STATE CORPORATION COMMISSION

FEB 15 1989

CONSERVATION DIVISION  
Wichita, Kansas

TICKET NUMBER 646094

COMPANY TXO

