

SIDE ONE

STATE CORPORATION COMMISSION OF KANSAS  
OIL & GAS CONSERVATION DIVISION  
WELL COMPLETION FORM  
ACO-1 WELL HISTORY  
DESCRIPTION OF WELL AND LEASE

API NO. 15- 071-20, 544-00-00

County Greeley  
Approx NE NE NE Sec. 22 Twp. 16S Rge. 42W East West

Operator: License # 3317

4800 Ft. North from Southeast Corner of Section

Name: Beard Oil Company

480 Ft. West from Southeast Corner of Section  
(NOTE: Locate well in section plat below.)

Address 5600 N. May Avenue

Lease Name Young Cattle Company Well # 1-22

Suite 200

Field Name Wildcat

City/State/Zip Oklahoma City, OK 73112

Producing Formation None

Purchaser: \_\_\_\_\_

Elevation: Ground 3803 KB 3812

Operator Contact Person: Ivan D. Allred, Jr.

Total Depth 5210 PBTD ----

Phone (405) 842-2333

Contractor: Name: Murfin Drilling Company, Inc.

License: 30606

Wellsite Geologist: \_\_\_\_\_

Designate Type of Completion

New Well  Re-Entry  Workover

Oil  SWD  Temp. Abd.

Gas  Inj  Delayed Comp.

Dry  Other (Core, Water Supply, etc.)

If OMO: old well info as follows:

Operator: \_\_\_\_\_

Well Name: \_\_\_\_\_

Comp. Date \_\_\_\_\_ Old Total Depth \_\_\_\_\_

Drilling Method:

Mud Rotary  Air Rotary  Cable

07-13-91 07-20-91 07-21-91

Spud Date Date Reached TD Completion Date

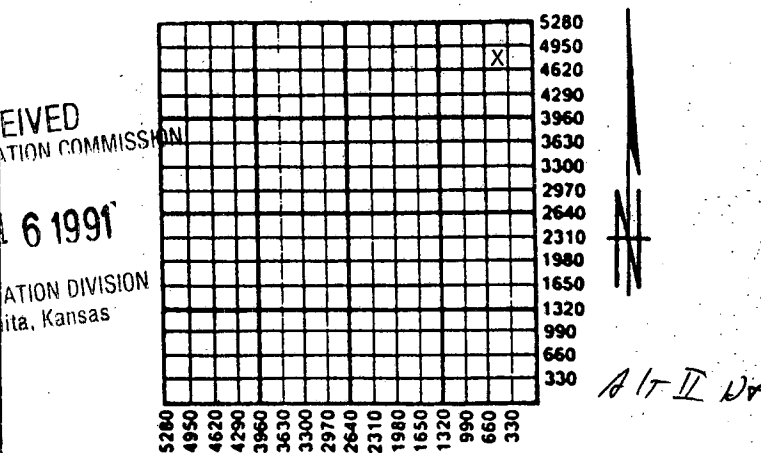

Amount of Surface Pipe Set and Cemented at 360 Feet

Multiple Stage Cementing Collar Used?  Yes  No

If yes, show depth set \_\_\_\_\_ Feet

If Alternate II completion, cement circulated from \_\_\_\_\_

feet depth to \_\_\_\_\_ w/ \_\_\_\_\_ sx cmt.

RECEIVED  
STATE CORPORATION COMMISSION

AUG 16 1991

CONSERVATION DIVISION  
Wichita, Kansas

AIT II DVA

INSTRUCTIONS: This form shall be completed in triplicate and filed with the Kansas Corporation Commission, 200 Colorado Derby Building, Wichita, Kansas 67202, within 120 days of the spud date of any well. Rule 82-3-130, 82-3-107 and 82-3-106 apply. Information on side two of this form will be held confidential for a period of 12 months if requested in writing and submitted with the form. See rule 82-3-107 for confidentiality in excess of 12 months. One copy of all wireline logs and drillers time log shall be attached with this form. ALL CEMENTING TICKETS MUST BE ATTACHED. Submit CP-4 form with all plugged wells. Submit CP-111 form with all temporarily abandoned wells. Any recompletion, workover or conversion of a well requires filing of ACO-2 within 120 days from commencement date of such work.

All requirements of the statutes, rules and regulations promulgated to regulate the oil and gas industry have been fully complied with and the statements herein are complete and correct to the best of my knowledge.

Signature Ivan D. Allred, Jr.  
Title Vice President Date 8-14-91

Subscribed and sworn to before me this 14th day of August,  
Notary Public Thomas L. Garrett  
Date Commission Expires December 7, 1994

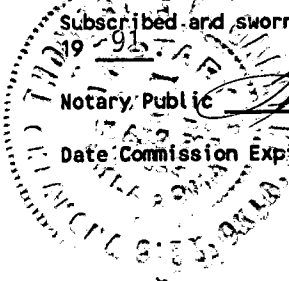

K.C.C. OFFICE USE ONLY

F  Letter of Confidentiality Attached

C  Wireline Log Received

C  Drillers Timelog Received

Distribution

KCC  SWD/Rep  NGPA

KGS  Plug  Other (Specify)

PI

**SIDE TWO**

Operator Name Beard Oil Company Lease Name Young Cattle Company Well # 1-22  
 East County Greeley  
 Sec. 22 Twp. 16S Rge. 42W  West

**INSTRUCTIONS:** Show important tops and base of formations penetrated. Detail all cores. Report all drill stem tests giving interval tested, time tool open and closed, flowing and shut-in pressures, whether shut-in pressure reached static level, hydrostatic pressures, bottom hole temperature, fluid recovery, and flow rates if gas to surface during test. Attach extra sheet if more space is needed. Attach copy of log.

Drill Stem Tests Taken  Yes  No  
 (Attach Additional Sheets.)  
 Samples Sent to Geological Survey  Yes  No  
 Cores Taken  Yes  No  
 Electric Log Run  Yes  No  
 (Submit Copy.)

Formation Description		
Name	Top	Bottom
Lansing	4184	
Marmaton	4504	
Cherokee	4710	
Atoka	4826	
Morrow	4978	
Morrow Lime	5070	
Mississippi	5130	

CASING RECORD <input checked="" type="checkbox"/> New <input type="checkbox"/> Used							
Report all strings set-conductor, surface, intermediate, production, etc.							
Purpose of String	Size Hole Drilled	Size Casing Set (in O.D.)	Weight Lbs./Ft.	Setting Depth	Type of Cement	# Sacks Used	Type and Percent Additives
surface	12 1/4"	8-5/8"	20#	360'	60/40 Poz	225	2% gel, 3% cc

PERFORATION RECORD		Acid, Fracture, Shot, Cement Squeeze Record	
Shots Per Foot	Specify Footage of Each Interval Perforated	(Amount and Kind of Material Used)	Depth

TUBING RECORD				Liner Run <input type="checkbox"/> Yes <input type="checkbox"/> No	
Size	Set At	Packer At			

Date of First Production	Producing Method <input type="checkbox"/> Flowing <input type="checkbox"/> Pumping <input type="checkbox"/> Gas Lift <input type="checkbox"/> Other (Explain)				
None					
Estimated Production Per 24 Hours	Oil Bbls.	Gas Mcf	Water Bbls.	Gas-Oil-Ratio	Gravity

Disposition of Gas:  Vented  Sold  Used on Lease (If vented, submit ACO-18.)

METHOD OF COMPLETION:  Open Hole  Perforation  Dually Completed  Other (Specify) \_\_\_\_\_

Production Interval: \_\_\_\_\_

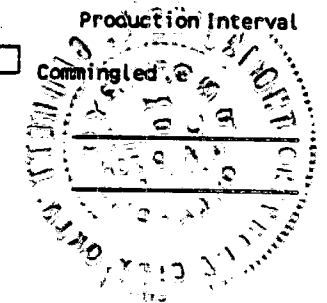

# FORMATION TEST REPORT

RECEIVED  
JUL 29 1991  
Beard Oil

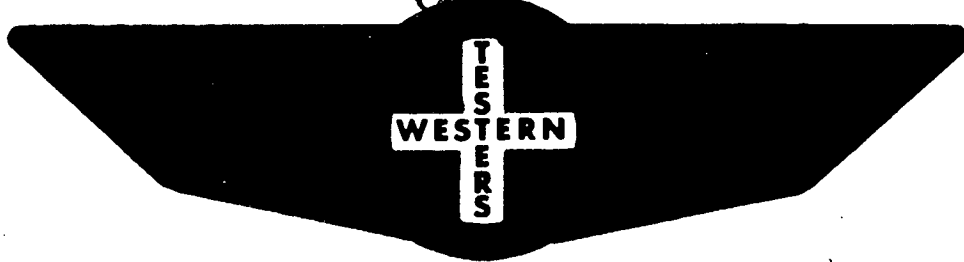

Home Office:

Wichita, Kansas 67201

P.O. Box 1599

Phone (316) 262-5861

RECEIVED  
STATE CORRECTION COMMISSION

AUG 16 1991

... numbers

15-071-20544-00-00

13/33

KT 18017 - 7

I

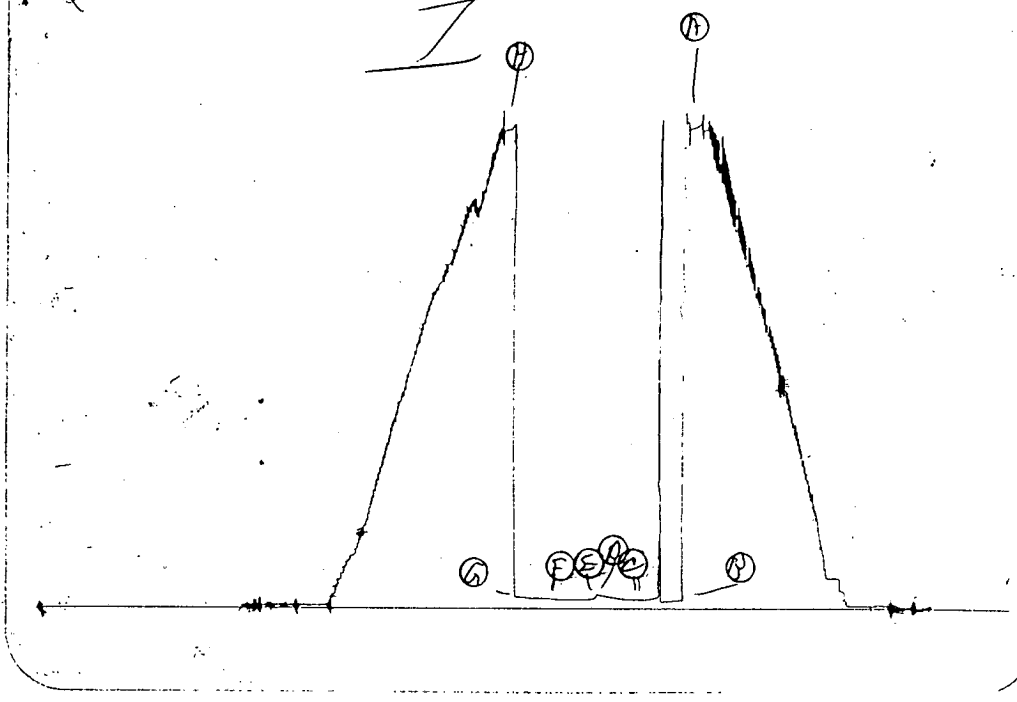

Inside Recorder

13/33

KT 18017 - 7

0

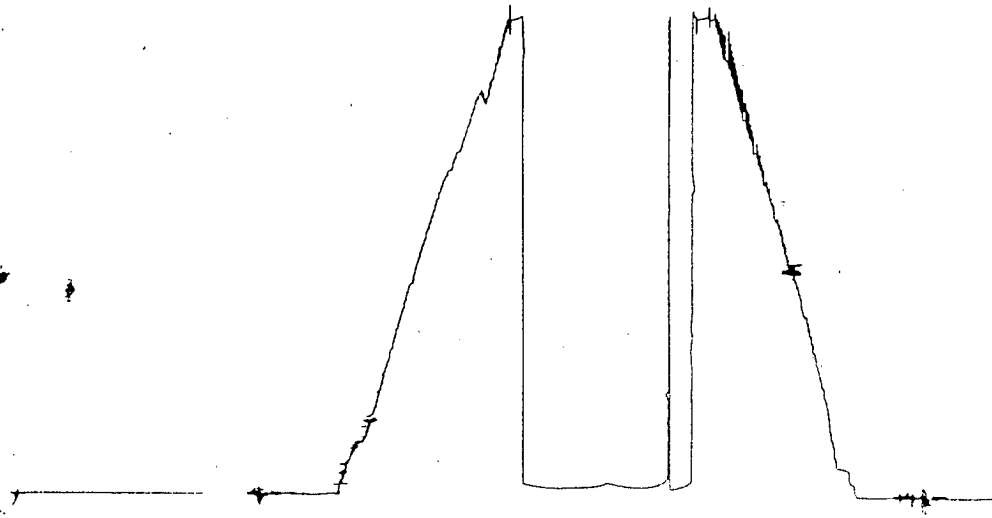

Outside Recorder

ORIGINAL

15-071-20544-00-00

# FORMATION TEST REPORT

COMPANY BEARD OIL COMPANY

LEASE & WELL NO. YOUNG CATTLE CO  
#1-22

SEC. 22 TWP. 16S RGE. 42W TEST NO. 1 DATE 7/19/91

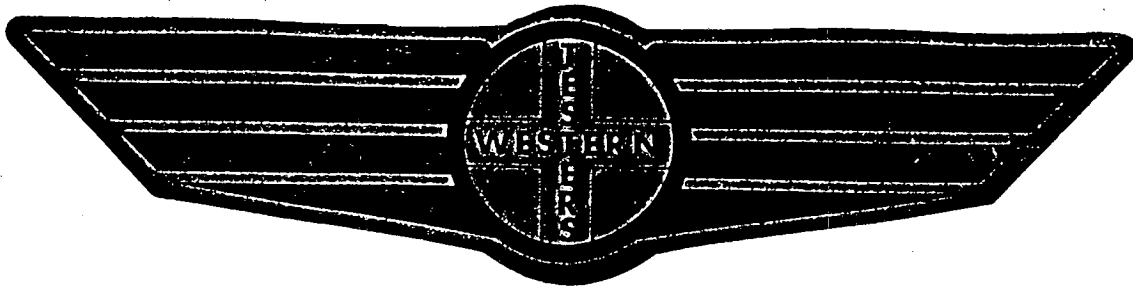

Home Office:

Wichita, Kansas 67201

P.O. Box 1599

Phone 1 - 800 - 688 - 7021

15-071-20544-00-00

WESTERN TESTING CO. INC.  
SUBSURFACE PRESSURE SURVEY

DATE : 7-19-91  
 CUSTOMER : BEARD OIL COMPANY  
 WELL : 1-22 TEST: 1  
 ELEVATION : 3812 KB  
 SECTION : 22  
 RANGE : 42W COUNTY : GREELEY  
 GAUGE SN# : 6233 RANGE : 4000

TICKET : 18017  
 LEASE : YOUNG CATTLE CO.  
 GEOLOGIST : BANKS  
 FORMATION : MORROW  
 TOWNSHIP : 16S  
 STATE : KANSAS  
 CLOCK : 12

INTERVAL FROM : 4968 TO : 4990 TOTAL DEPTH : 4990  
 DEPTH OF SELECTIVE ZONE :  
 PACKER DEPTH : 4963 SIZE : 6.75  
 PACKER DEPTH : 4968 SIZE : 6.75  
 PACKER DEPTH : SIZE :  
 PACKER DEPTH : SIZE :

DRILLING CON. : MURFIN RIG 24  
 MUD TYPE : CHEMICAL VISCOSITY : 47  
 WEIGHT : 9.2 WATER LOSS (CC) : 9.6  
 CHLORIDES (PPM) : 3000  
 JARS-MAKE : W.T.C. SERIAL NUMBER : 415  
 DID WELL FLOW ? : NO REVERSED OUT ? : NO

DRILL COLLAR LENGTH : 533 FT I.D. inch : 2.20  
 WEIGHT PIPE LENGTH : 64 FT I.D. inch : 3.20  
 DRILL PIPE LENGTH : 4339 FT I.D. inch : 3.80  
 TEST TOOL LENGTH : 32 FT TOOL SIZE : 5.50  
 ANCHOR LENGTH : 22 FT ANCHOR SIZE : 5.50  
 SURFACE CHOKE SIZE : .75 IN BOTTOM CHOKE SIZE : .75  
 MAIN HOLE SIZE : 7.875 IN TOOL JOINT SIZE : 4.5XH

BLOW COMMENT #1 : INITIAL FLOW PERIOD WEAK BLOW - 1/4" IN WATER.  
 BLOW COMMENT #2 : FINAL FLOW PERIOD NO BLOW.  
 BLOW COMMENT #3 :  
 BLOW COMMENT #4 :

ORIGINAL

RECOVERED : 40 FT OF: MUD

15-071-20544-00-60

Total Barrels Fluid = 0.19  
Total Fluid Prod Rate = 4.51 BFPD  
Indicated Wtr Rate = 0.45 BWPD

REMARK 1 :  
REMARK 2 : FLUSHED TOOL ON INITIAL FLOW PERIOD  
REMARK 3 :  
REMARK 4 :

SET PACKER(S) :	5:40 P.M.	TIME STARTED OFF BOTTOM :	7:40 P.M.
WELL TEMPERATURE :	137		
INITIAL HYDROSTATIC PRESSURE		(A)	2450
INITIAL FLOW PERIOD MIN:	30	(B)	44 PSI TO (C) : 48
INITIAL CLOSED IN PERIOD MIN:	33	(D)	74
FINAL FLOW PERIOD MIN:	30	(E)	50 PSI TO (F) : 50
FINAL CLOSED IN PERIOD MIN:	30	(G)	64
FINAL HYDROSTATIC PRESSURE		(H)	2414

ORIGINAL

15-071-20544-00-00

WESTERN TESTING CO. INC.  
WICHITA-KANSAS

Pressure Transient Report

COMPANY : BEARD OIL COMPANY  
RIG : GREELEY-KANSAS  
FIELD : YOUNG CATTLE CO.  
WELL : 1-22  
DATE : 7-19-91  
GAUGE NO : 6233

OPERATIONAL COMMENTS

FLUSHED TOOL ON INITIAL FLOW PERIOD



COMPANY : BEARD OIL COMPANY  
 WELL : 1-22  
 GAUGE # : 6233  
 DATE : 19/ 7/91

FIELD : YOUNG CATTLE CO.  
 JOB # : 18017  
 DEPTH : 4990  
 TEST :

15-071-20544-00-00

DATA No.	REAL TIME HR:MN:SS	ELAPSE TIME DELTA HOURS	PRESSURE PSIG	TEMP DEG F	DELTA P Pi-P(i-1)
INITIAL FLOW PERIOD					
2	5:40: 0	0.000	44.000	137.00	0.000
3	5:44:59	0.083	43.000	137.00	-1.000
4	5:50: 0	0.167	41.000	137.00	-2.000
5	5:55: 0	0.250	38.000	137.00	-3.000
6	5:59:59	0.333	58.000	137.00	20.000
7	6: 5: 0	0.417	50.000	137.00	-8.000
8	6:10: 0	0.500	48.000	137.00	-2.000
INITIAL SHUT-IN PERIOD					
9	6:13: 0	0.550	49.000	137.00	1.000
10	6:16: 0	0.600	49.000	137.00	0.000
11	6:19: 0	0.650	50.000	137.00	1.000
12	6:22: 0	0.700	50.000	137.00	0.000
13	6:25: 0	0.750	51.000	137.00	1.000
14	6:28: 0	0.800	55.000	137.00	4.000
15	6:31: 0	0.850	58.000	137.00	3.000
16	6:34: 0	0.900	61.000	137.00	3.000
17	6:37: 0	0.950	66.000	137.00	5.000
18	6:40: 0	1.000	70.000	137.00	4.000
19	6:43: 0	1.050	74.000	137.00	4.000
FINAL FLOW PERIOD					
20	6:44: 0	1.067	50.000	137.00	-24.000
21	6:47:59	1.133	50.000	137.00	0.000
22	6:53: 0	1.217	50.000	137.00	0.000
23	6:58: 0	1.300	50.000	137.00	0.000
24	7: 2:59	1.383	50.000	137.00	0.000
25	7: 8: 0	1.467	50.000	137.00	0.000
26	7:13: 0	1.550	50.000	137.00	0.000
FINAL SHUT-IN PERIOD					
27	7:16: 0	1.600	52.000	137.00	2.000
28	7:19: 0	1.650	55.000	137.00	3.000
29	7:22: 0	1.700	56.000	137.00	1.000
30	7:25: 0	1.750	57.000	137.00	1.000
31	7:28: 0	1.800	58.000	137.00	1.000
32	7:31: 0	1.850	59.000	137.00	1.000
33	7:34: 0	1.900	60.000	137.00	1.000
34	7:37: 0	1.950	61.000	137.00	1.000
35	7:40: 0	2.000	62.000	137.00	1.000
36	7:43: 0	2.050	64.000	137.00	2.000

WESTERN TESTING CO. INC.

15-071-20544-00-00

FLUID SAMPLE REPORT

Date : 7-19-91 Ticket No. : 18017  
 Company : BEARD OIL COMPANY  
 Well Name & No. : YOUNG CATTLE CO. 1-22  
 DST No. 1  
 County : GREELEY State : KANSAS  
 Sampler No. : 2 Test Interval : 4968-4990

=====  
 Pressure in Sampler 20 PSIG BHT 137 Deg F  
 Total Volume of Sampler : 3150 cc  
 Total Volume of Sample : 3000 cc  
     Oil: cc  
     Water: cc  
     Mud: 3000 cc  
     Gas: cu ft  
     Other: cc  
 =====

RESITIVITY

Drilling Mud @ F Chloride Content ppm  
 Mud Pit Sample @ F Chloride Content ppm  
 Gas/Oil Ratio Gravity API @ Deg F

Where was sample drained

Remarks: