

RECEIVED 15-071-20766-0000

JUL 21 2003

KCC WICHITA

For KCC Use: Effective Date: 7-27-03 District #: SGA? Yes No

KANSAS CORPORATION COMMISSION OIL & GAS CONSERVATION DIVISION

NOTICE OF INTENT TO DRILL

Must be approved by KCC five (5) days prior to commencing well

Form C-1 September 1999 Form must be Typed Form must be Signed All blanks must be Filled

Expected Spud Date August 15 2003 month day year

Spot C SE NE Sec. 34 Twp. 17S S. R. 40 1980 feet from N (circle one) Line of Section 660 feet from E (circle one) Line of Section Is SECTION Regular Irregular?

OPERATOR: License# 32621 Name: Key Production Co., Inc. Address: 15 W 5th, Ste 1000 City/State/Zip: Tulsa, OK 74103 Contact Person: Michelle Farrell Phone: 918-585-1100

(Note: Locate well on the Section Plat on reverse side) County: Greeley Lease Name: Burgardt Well #: 2 Field Name: Is this a Prorated / Spaced Field? Yes No Target Formation(s): Towanda

CONTRACTOR: License# 5382 Name: Cheyenne Drilling

Well Drilled For: Oil Gas OWWO Seismic; # of Holes Other Well Class: Enh Rec Storage Disposal Pool Ext Wildcat Other Well Class: Infield Pool Ext Wildcat Other Type Equipment: Mud Rotary Air Rotary Cable

Nearest Lease or unit boundary: 1320' Ground Surface Elevation: 3572.4 feet MSL Water well within one-quarter mile: Yes No Public water supply well within one mile: Yes No Depth to bottom of fresh water: 200' Depth to bottom of usable water: 1000' 1650'

If OWWO: old well information as follows: Operator: Well Name: Original Completion Date: Original Total Depth:

Surface Pipe by Alternate: 1 X 2 Length of Surface Pipe Planned to be set: 250' Length of Conductor Pipe required: NA NONE Projected Total Depth: 3000' Formation at Total Depth: Towanda

Directional, Deviated or Horizontal wellbore? Yes No If Yes, true vertical depth: Bottom Hole Location: KCC DKT #:

Water Source for Drilling Operations: Well Farm Pond Other X DWR Permit #: Will Cores be taken? Yes No If Yes, proposed zone:

AFFIDAVIT

The undersigned hereby affirms that the drilling, completion and eventual plugging of this well will comply with K.S.A. 55-101, et. seq. It is agreed that the following minimum requirements will be met:

- 1. Notify the appropriate district office prior to spudding of well;
2. A copy of the approved notice of intent to drill shall be posted on each drilling rig;
3. The minimum amount of surface pipe as specified below shall be set by circulating cement to the top;
4. If the well is dry hole, an agreement between the operator and the district office on plug length and placement is necessary prior to plugging;
5. The appropriate district office will be notified before well is either plugged or production casing is cemented in;
6. If an ALTERNATE II COMPLETION, production pipe shall be cemented from below any usable water to surface within 120 days of spud date.

I hereby certify that the statements made herein are true and to the best of my knowledge and belief.

Date: 7-15-03 Signature of Operator or Agent: Michelle Farrell Title: Drilling Technician

For KCC Use ONLY API # 15 - 071-20766-0000 Conductor pipe required None feet Minimum surface pipe required 220 feet per Alt. Approved by: RJP 7-2203 This authorization expires: 1-22-04 Spud date: Agent:

- Remember to: File Drill Pit Application (form CDP-1) with Intent to Drill; File Completion Form ACO-1 within 120 days of spud date; File acreage attribution plat according to field proration orders; Notify appropriate district office 48 hours prior to workover or re-entry; Submit plugging report (CP-4) after plugging is completed; Obtain written approval before disposing or injecting salt water.

34 17 40W

2004-21705-150-71

RECEIVED

Side Two

JUL 21 2003

IN ALL CASES PLOT THE INTENDED WELL ON THE PLAT BELOW

KCC WICHITA

Plat of acreage attributable to a well in a prorated or spaced field

If the intended well is in a prorated or spaced field, please fully complete this side of the form. If the intended well is in a prorated or spaced field complete the plat below showing that the well will be properly located in relationship to other wells producing from the common source of supply. Please show all the wells and within 1 mile of the boundaries of the proposed acreage attribution unit for gas wells and within 1/2 mile of the boundaries of the proposed acreage attribution unit for oil wells.

API No. 15 - _____
Operator: Key Production Co., Inc.
Lease: Burgardt
Well Number: 2
Field: Byerly

Location of Well: County: Greeley
1980 _____ feet from S (N) (circle one) Line of Section
660 _____ feet from (E) / W (circle one) Line of Section
Sec. 34 Twp. 17S S. R. 40 East West

Number of Acres attributable to well: 640
QTR / QTR / QTR of acreage: C - SW - NE

Is Section Regular or _____ Irregular

If Section is Irregular, locate well from nearest corner boundary.
Section corner used: ___ NE ___ NW ___ SE ___ SW

PLAT

(Show location of the well and shade attributable acreage for prorated or spaced wells.)
(Show footage to the nearest lease or unit boundary line.)

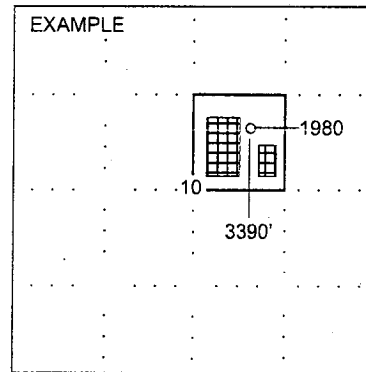
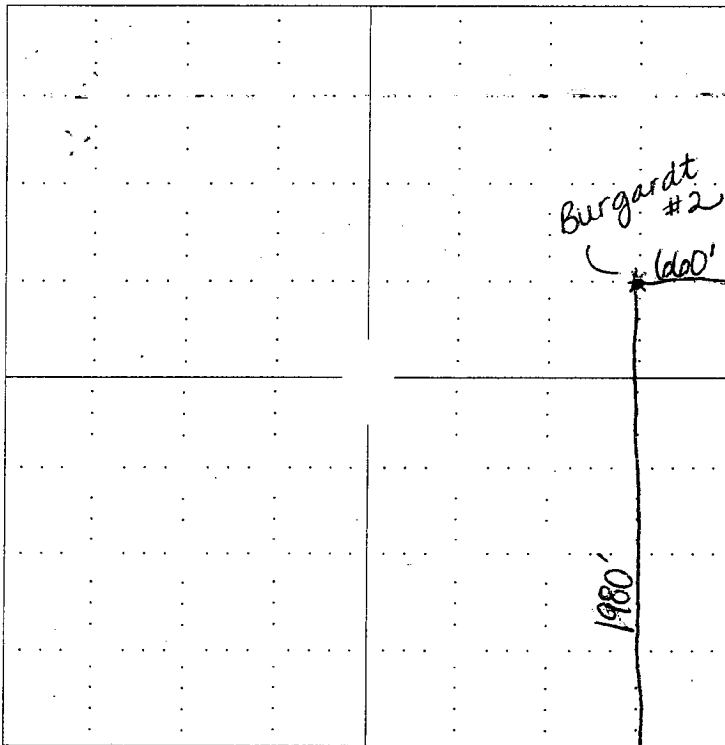

NOTE: In all cases locate the spot of the proposed drilling location.

In plotting the proposed location of the well, you must show:

1. The manner in which you are using the depicted plat by identifying section lines, i.e. 1 section, 1 section with 8 surrounding sections, 4 sections, etc.
2. The distance of the proposed drilling location from the section's south / north and east / west.
3. The distance to the nearest lease or unit boundary line.
4. If proposed location is located within a prorated or spaced field a certificate of acreage attribution plat must be attached: (CO-7 for oil wells; CG-8 for gas wells).