

FOR KCC USE:

FORM C-1 7/91

EFFECTIVE DATE: 4-25-94

State of Kansas

15-071-20625-0000

FORM MUST BE TYPED  
FORM MUST BE SIGNED  
ALL BLANKS MUST BE FILLED

DISTRICT #

NOTICE OF INTENTION TO DRILL

SEAT Yes No

Must be approved by the K.C.C. five (5) days prior to commencing well

Expected Spud Date MAY 1 1994  
month day year

Spot W/25 SE - SE. Sec 30 Twp 19 S. Rg 39 West

OPERATOR: License # 5263  
Name: MIDWESTERN EXPLORATION CO.  
Address: PO BOX 1884  
City/State/Zip: LIBERAL KS 67905-1884  
Contact Person: DALE J LOLLAR  
Phone: (316) 624-3534

660 feet from South / North line of Section  
990 feet from East / West line of Section  
IS SECTION X REGULAR IRREGULAR?

CONTRACTOR: License #: 30684  
Name: ABERCROMBIE RTD INC

(NOTE: Locate well on the Section Plat on Reverse Side)  
County: GREELEY  
Lease Name: BUEHNE TRUST Well #: 1-30  
Field Name: NORTH BRADSHAW

Well Drilled For: Well Class: Type Equipment:  
Oil Enh Rec X Infield X Mud Rotary  
X Gas Storage Pool Ext. Air Rotary  
OWWO Disposal Wildcat Cable  
Seismic: # of Holes Other

Is this a Prorated/Spaced Field? yes X no  
Target Formation(s): UPPER WINFIELD  
Nearest lease or unit boundary: 660'  
Ground Surface Elevation: N/A feet MSL  
Water well within one-quarter mile: yes X no  
Public water supply well within one mile: yes X no  
Depth to bottom of fresh water: 180'  
Depth to bottom of usable water: 220-1400'  
Surface Pipe by Alternate: 1 X 2  
Length of Surface Pipe Planned to be set: (350) 300  
Length of Conductor pipe required: 0  
Projected Total Depth: 2850  
Formation at Total Depth: UPPER WINFIELD  
Water Source for Drilling Operations: X well farm pond other

If OWWO: old well information as follows:  
Operator: N/A  
Well Name: N/A  
Comp. Date: N/A Old Total Depth N/A

DWR Permit #:   
Will Cores Be Taken?:   
If yes, proposed zone: N/A

Directional, Deviated or Horizontal wellbore? yes X no  
If yes, true vertical depth: N/A  
Bottom Hole Location: N/A

AFFIDAVIT

The undersigned hereby affirms that the drilling, completion and eventual plugging of this well will comply with Conservation Commission 101, et. seq.  
It is agreed that the following minimum requirements will be met:

RECEIVED  
STATE CORPORATION COMMISSION  
APR 20 1994  
04-20-94  
CONSERVATION DIVISION

- 1. Notify the appropriate district office prior to spudding of well;
- 2. A copy of the approved notice of intent to drill shall be posted on each drilling rig;
- 3. The minimum amount of surface pipe as specified below shall be set by circulating cement to the top of all casing; surface pipe shall be set through all unconsolidated materials plus a minimum of 20 feet into the underlying formation;
- 4. If the well is dry hole, an agreement between the operator and the district office on plug length and placement is necessary prior to plugging;
- 5. The appropriate district office will be notified before well is either plugged or production casing is cemented in;
- 6. IF AN ALTERNATE II COMPLETION, PRODUCTION PIPE SHALL BE CEMENTED FROM BELOW ANY USABLE WATER TO SURFACE WITHIN 120 DAYS OF SPUD DATE. IN ALL CASES, NOTIFY DISTRICT OFFICE PRIOR TO ANY CEMENTING.

I hereby certify that the statements made herein are true and to the best of my knowledge and belief. DALE J. LOLLAR  
Date: 4/18/94 Signature of Operator or Agent: Dale J. Lollar Title: VICE-PRESIDENT

FOR KCC USE:  
API # 15- 071-20625-00-00  
Conductor pipe required N/A feet  
Minimum surface pipe required 300 feet per Alt. X 2  
Approved by: CB 4-20-94  
This authorization expires: 10-20-94  
(This authorization void if drilling not started within 6 months of effective date.)  
Spud date: Agent:

REMEMBER TO:

- File Drill Pit Application (form CDP-1) with Intent to Drill;
- File Completion Form ACO-1 within 120 days of spud date;
- File acreage attribution plat according to field proration orders;
- Notify appropriate district office 48 hours prior to workover or re-entry;
- Submit plugging report (CP-4) after plugging is completed;
- Obtain written approval before disposing or injecting salt water.

Mail to: Conservation Division, 200 Colorado Derby Building, 202 W. First St., Wichita, Kansas 67202-1286.

30  
19  
39

**IN ALL CASES PLOT THE INTENDED WELL ON THE PLAT BELOW**

**PLAT OF ACREAGE ATTRIBUTABLE TO A WELL IN A PRORATED OR SPACED FIELD**

If the intended well is in a prorated or spaced field, please fully complete this side of the form. If the intended well is in a prorated or spaced field complete the plat below showing that the well will be properly located in relationship to other wells producing from the common source of supply. Please show all the wells within 1 mile of the boundaries of the proposed acreage attribution unit for gas wells and within 1/2 mile of the boundaries of the proposed acreage attribution unit for oil wells.

API NO. 15- \_\_\_\_\_  
 OPERATOR \_\_\_\_\_ LOCATION OF WELL: COUNTY \_\_\_\_\_  
 LEASE \_\_\_\_\_ feet from south/north line of section  
 WELL NUMBER \_\_\_\_\_ feet from east/west line of section  
 FIELD \_\_\_\_\_ SECTION \_\_\_\_\_ TWP \_\_\_\_\_ RG \_\_\_\_\_

NUMBER OF ACRES ATTRIBUTABLE TO WELL \_\_\_\_\_ IS SECTION \_\_\_\_\_ REGULAR or \_\_\_\_\_ IRREGULAR  
 QTR/QTR/QTR OF ACREAGE \_\_\_\_\_ - \_\_\_\_\_ - \_\_\_\_\_ **IF SECTION IS IRREGULAR, LOCATE WELL FROM NEAREST CORNER BOUNDARY.**

Section corner used: \_\_\_\_\_ NE \_\_\_\_\_ NW \_\_\_\_\_ SE \_\_\_\_\_ SW

**PLAT**

(Show location of the well and shade attributable acreage for prorated or spaced wells.)  
 (Show footage to the nearest lease or unit boundary line.)

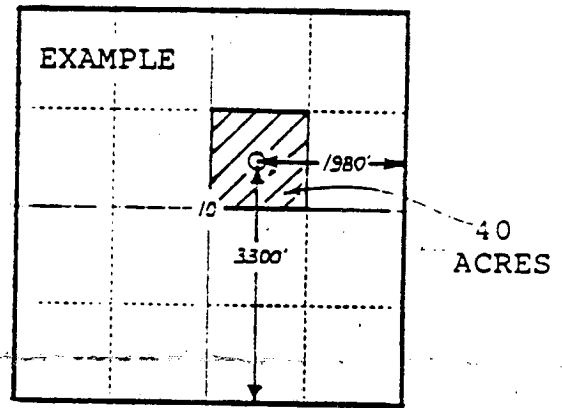
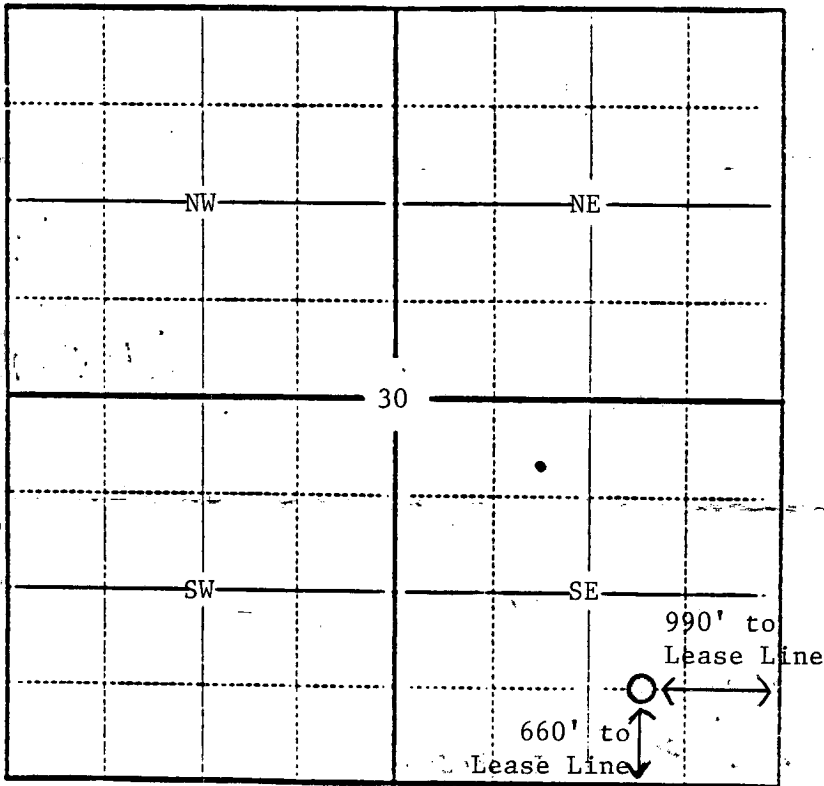

**In plotting the proposed location of the well, you must show:**

- 1) The manner in which you are using the depicted plat by identifying section lines, i.e. 1 section, 1 section with 8 surrounding sections, 4 sections, etc.;
- 2) the distance of the proposed drilling location from the section's south/north and east/west lines; and
- 3) the distance to the nearest lease or unit boundary line.