

15-199-20253-0000
CORRECTION

FORM C-1 7/91

FORM MUST BE TYPED

FORM MUST BE SIGNED

ALL BLANKS MUST BE FILLED

FOR KCC USE:

EFFECTIVE DATE: 8-31-97

DISTRICT # 4

SEAT Yes No

State of Kansas

NOTICE OF INTENTION TO DRILL

Must be approved by the K.C.C. file (5) days prior to commencing well

Expected Spud Date September 25 1997
month day year

Spot 90' E. of C. NE. NW sec 31 Twp 15. S. Rg 41. West

OPERATOR: License # 30425
Name: DNR Oil & Gas Inc.
Address: 655 Broadway, Suite 525
City/State/Zip: Denver, Colorado 80203
Contact Person: Charles R. Davis
Phone: (303) 825-8956

660' feet from South line of Section
3260' 3310' feet from East line of Section
IS SECTION REGULAR X IRREGULAR?

(NOTE: Locate well on the Section Plat on Reverse Side)

County: Wallace

Lease Name: Nickelson Well #: 3-31

Field Name: S.E. Mt. Sunflower

Is this a Prorated/Spaced Field? yes X no

Target Formation(s): Mississippian Morrow

Nearest lease or unit boundary: 620' 660'

Ground Surface Elevation: 3787 feet MSL

Water well within one-quarter mile: yes X no

Public water supply well within one mile: yes X no

Depth to bottom of fresh water: 260' +/-

Depth to bottom of usable water: 1600' +/- 1700'

Surface Pipe by Alternate: 1 X 2

Length of Surface Pipe Planned to be set: 340' +/-

Length of Conductor pipe required: N/A

Projected Total Depth: 5300' +/-

Formation at Total Depth: Mississippian

Water Source for Drilling Operations:
... well ... farm pond ... other

DWR Permit #: _____

Will Cores Be Taken? yes X no

If yes, proposed zone: _____

CONTRACTOR: License #: 30606
Name: Murrfin Drilling Company

Well Drilled For: Well Class: Type Equipment:
X Oil ... Enh Rec X Infield X Mud Rotary
... Gas ... Storage ... Pool Ext. ... Air Rotary
... OWWO ... Disposal ... Wildcat ... Cable
... Seismic; ... # of Holes ... Other
... Other

If OWWO: old well information as follows:
Operator: _____
Well Name: _____
Comp. Date: _____ Old Total Depth _____

Directional, Deviated or Horizontal wellbore? yes no X
If yes, true vertical depth: _____
Bottom Hole Location: _____

AFFIDAVIT

The undersigned hereby affirms that the drilling, completion and eventual plugging of this well will comply with K.S.A. 55-101, et. seq.

It is agreed that the following minimum requirements will be met:

1. Notify the appropriate district office prior to spudding of well;
2. A copy of the approved notice of intent to drill shall be posted on each drilling rig;
3. The minimum amount of surface pipe as specified below shall be set by circulating cement to the top; in all cases surface pipe shall be set through all unconsolidated materials plus a minimum of 20 feet into the underlying formation;
4. If the well is dry hole, an agreement between the operator and the district office on plug length and placement is necessary prior to plugging;
5. The appropriate district office will be notified before well is either plugged or production casing is cemented in;
6. IF AN ALTERNATE II COMPLETION, PRODUCTION PIPE SHALL BE CEMENTED FROM BELOW ANY USABLE WATER TO SURFACE WITHIN 120 DAYS OF SPUD DATE. IN ALL CASES, NOTIFY DISTRICT OFFICE PRIOR TO ANY CEMENTING.

I hereby certify that the statements made herein are true and to the best of my knowledge and belief.

Date: _____ Signature of Operator or Agent: Charles R. Davis Title: President

FOR KCC USE:
 API # 15-199-20253-0000
 Conductor pipe required NONE feet
 Minimum surface pipe required 200 feet per Alt. X(2)
 Approved by: DPW 8-26-97
 This authorization expires: 2-26-98
 (This authorization void if drilling not started within 6 months of effective date.)
 Spud date: _____ Agent: _____

API WAS: 15-199-202520000

API IS:

15-199-202530000

REMEMBER TO:

- File Drill Pit Application (form CDP-1) with Intent to Drill;
- File completion Form A-0-1 within 120 days of spud date;
- File acreage attribution plat according to field proration orders;
- Notify appropriate district office 48 hours prior to workover or re-entry;
- Submit plugging report (CP-4) after plugging is completed;
- Obtain written approval before disposing or injecting salt water.

Mail to: Conservation Division, 200 Colorado Derby Building, 202 W. First St., Wichita, Kansas 67202-1286.

12
15
17

IN ALL CASES PLOT THE INTENDED WELL ON THE PLAT BELOW

PLAT OF ACREAGE ATTRIBUTABLE TO A WELL IN A PRORATED OR SPACED FIELD

If the intended well is in a prorated or spaced field, please fully complete this side of the form. If the intended well is in a prorated or spaced field complete the plat below showing that the well will be properly located in relationship to other wells producing from the common source of supply. Please show all the wells within 1 mile of the boundaries of the proposed acreage attribution unit for gas wells and within 1/2 mile of the boundaries of the proposed acreage attribution unit for oil wells.

API NO. 15- _____
 OPERATOR _____
 LEASE _____
 WELL NUMBER _____
 FIELD _____

LOCATION OF WELL: COUNTY _____
 _____ feet from south/north line of section
 _____ feet from east/west line of section
 SECTION _____ TWP _____ RG _____

NUMBER OF ACRES ATTRIBUTABLE TO WELL _____
 QTR/QTR/QTR OF ACREAGE _____

IS SECTION _____ REGULAR or _____ IRREGULAR
IF SECTION IS IRREGULAR, LOCATE WELL FROM NEAREST CORNER BOUNDARY.

Section corner used: _____ NE _____ NW _____ SE _____ SW

PLAT

(Show location of the well and shade attributable acreage for prorated or spaced wells.)
 (Show footage to the nearest lease or unit boundary line.)

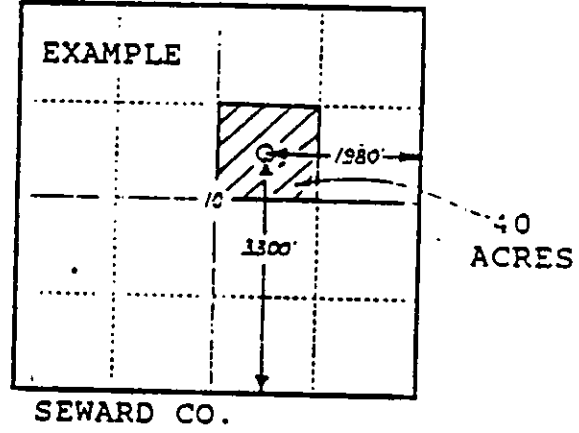
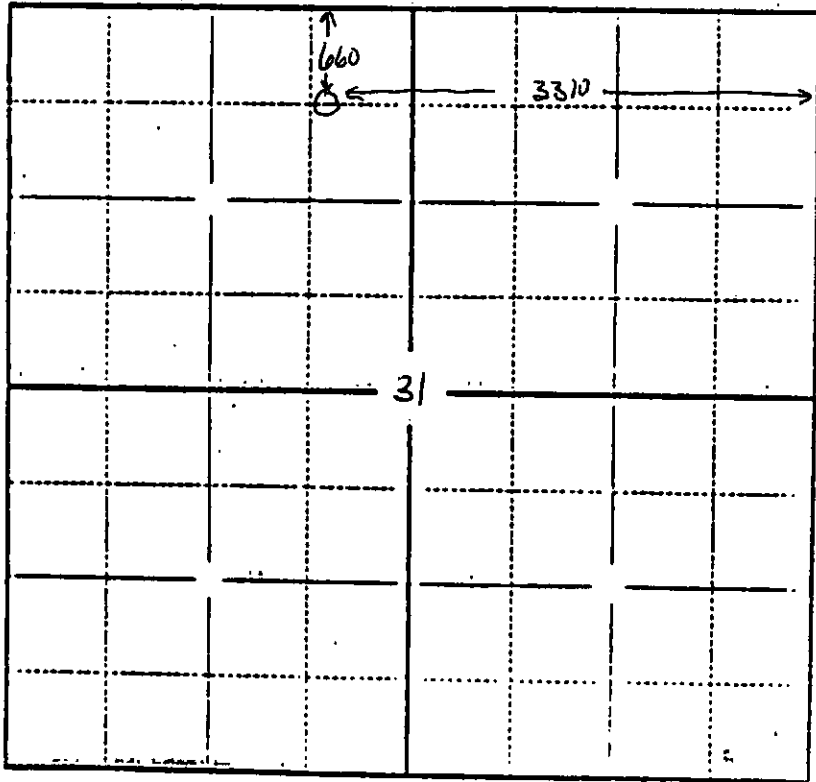

In plotting the proposed location of the well, you must show:

- 1) The manner in which you are using the depicted plat by identifying section lines, i.e. 1 section 1 section with 8 surrounding sections, 4 sections, etc.;
- 2) the distance of the proposed drilling location from the section's south/north and east/west lines; and
- 3) the distance to the nearest lease or unit boundary line.