

EFFECTIVE DATE: 3-17-97

DISTRICT # 4

State of Kansas
NOTICE OF INTENTION TO DRILL

15-199-20246-0000

FORM MUST BE SIGNED
ALL BLANKS MUST BE FILLED

SEAT: Yes No

Must be approved by the K.C.C. five (5) days prior to commencing well

Expected Spud Date: March 10 1997
month day year

Sec 15 Twp 31 S, Rg 41 East
E 2 SE NE 31 15 41 X West

OPERATOR: License # 3581
Name: Red Oak Energy, Inc.
Address: 200 W. Douglas, #510
City/State/Zip: Wichita, KS 67202
Contact Person: Kevin C. Davis
Phone: (316) 265-9925

1884 feet from South North line of Section
200 feet from East West line of Section
IS SECTION X REGULAR IRREGULAR?

(NOTE: Locate well on the Section Plat on Reverse Side)
County: Wallace
Lease Name: O.F.L. Well #: 3-31
Field Name: SE Mt. Sunflower

CONTRACTOR: License #: ADVISE ON ACO-1
Name:

Is this a Prorated/Spaced Field? yes X no
Target Formation(s): Marrow - Miss.
Nearest lease or unit boundary: 200'

Well Drilled For: Well Class: Type Equipment:
X Oil ... Enh Rec X Infield X Mud Rotary
... Gas ... Storage ... Pool Ext. ... Air Rotary
... OWMO ... Disposal ... Wildcat ... Cable
... Seismic; ... # of Holes ... Other
... Other

Ground Surface Elevation: 3786 feet MSL
Water well within one-quarter mile: yes X no
Public water supply well within one mile: yes X no

If OWMO, old well information as follows:
Operator:
Well Name:
Comp. Date: Old Total Depth

Depth to bottom of fresh water: 280' 250'
Depth to bottom of usable water: 1600'
Surface Pipe by Alternate: 1 X 2
Length of Surface Pipe Planned to be set: 330'

Directional, Deviated or Horizontal wellbore? yes X no
If yes, true vertical depth:
Bottom Hole Location:

Length of Conductor pipe required: N/A
Projected Total Depth: 5200'
Formation at Total Depth: Mississippian
Water Source for Drilling Operations:
... well ... farm pond X other

DWR Permit #:
Will Cores Be Taken? yes X no
If yes, proposed zone:

AFFIDAVIT

The undersigned hereby affirms that the drilling, completion and eventual plugging of this well will comply with K.S.A. 55-101, et. seq.

It is agreed that the following minimum requirements will be met:

1. Notify the appropriate district office prior to spudding of well;
2. A copy of the approved notice of intent to drill shall be posted on each drilling rig;
3. The minimum amount of surface pipe as specified below shall be set by circulating cement to the top; in all cases surface pipe shall be set through all unconsolidated materials plus a minimum of 20 feet into the underlying formation;
4. If the well is dry hole, an agreement between the operator and the district office on plug length and placement is necessary prior to plugging;
5. The appropriate district office will be notified before well is either plugged or production casing is cemented in;
6. IF AN ALTERNATE IS COMPLETION, PRODUCTION PIPE SHALL BE CEMENTED FROM BELOW ANY USABLE WATER TO SURFACE WITHIN 120 DAYS OF SPUD DATE. IN ALL CASES, NOTIFY DISTRICT OFFICE PRIOR TO ANY CEMENTING.

I hereby certify that the statements made herein are true and to the best of my knowledge and belief.

Date: 3/4/97 Signature of Operator or Agent: Kevin C. Davis Title: President

FOR KCC USE:
 API # 15- 199-202460000
 Conductor pipe required NONE feet
 Minimum surface pipe required 310 feet per Alt. X(2)
 Approved by: JK 3-7-97
 This authorization expires: 9-7-97
 (This authorization void if drilling not started within 6 months of effective date.)
 Spud date: Agent:

REMEMBER TO:

- File Drill Pit Application (form CDP-1) with Intent to Drill;
- File Completion Form ACO-1 within 120 days of spud date;
- File acreage attribution plat according to field proration orders;
- Notify appropriate district office 48 hours prior to workover or re-entry;
- Submit plugging report (CP-4) after plugging is completed;
- Obtain written approval before disposing or injecting salt water.

Mail to: Conservation Division, 200 Colorado Derby Building, 202 W. First St., Wichita, Kansas 67202-1286.

RECEIVED
KANSAS CORP COMM
1997 MAR -6 P 1:45

15
41W

IN ALL CASES PLOT THE INTENDED WELL ON THE PLAT BELOW
PLAT OF ACREAGE ATTRIBUTABLE TO A WELL IN A PRORATED OR SPACED FIELD.

If the intended well is in a prorated or spaced field, please fully complete this side of the form. If the intended well is in a prorated or spaced field complete the plat below showing that the well will be properly located in relationship to other wells producing from the common source of supply. Please show all the wells within 1 mile of the boundaries of the proposed acreage attribution unit for gas wells and within 1/2 mile of the boundaries of the proposed acreage attribution unit for oil wells.

API NO. 15- _____
 OPERATOR Red Oak Energy, Inc.
 LEASE O.F.L.
 WELL NUMBER #3-31
 FIELD SE Mt. Sunflower

LOCATION OF WELL: COUNTY Wallace
1884 feet from south/north line of section
200 feet from east/west line of section
 SECTION 31 TWP 15 RG 41

NUMBER OF ACRES ATTRIBUTABLE TO WELL _____
 QTR/QTR/QTR OF ACREAGE _____

IS SECTION X REGULAR or _____ IRREGULAR
IF SECTION IS IRREGULAR, LOCATE WELL FROM NEAREST CORNER BOUNDARY.

Section corner used: X NE _____ NW _____ SE _____ SW
PLAT

(Show location of the well and shade acreage attributable to well for prorated or spaced wells.)
 (Show footage to the nearest lease or unit boundary line.)

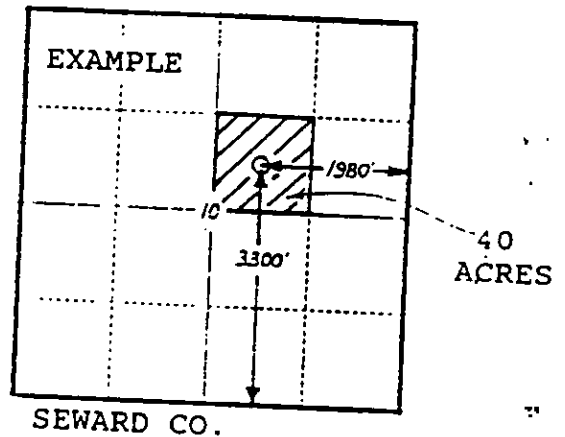
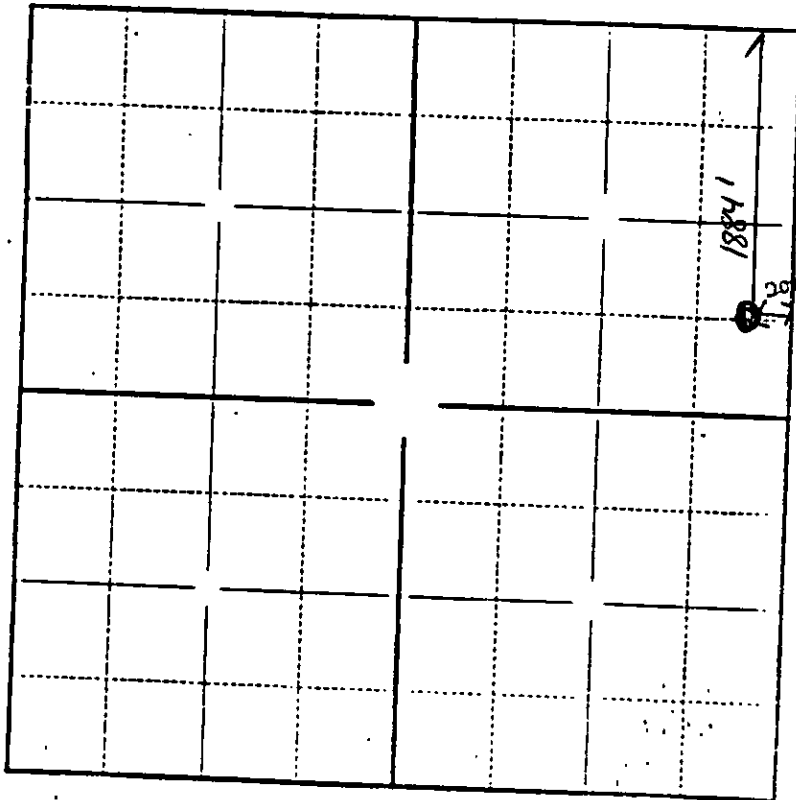

In plotting the proposed location of the well, you must show:

- 1) The manner in which you are using the depicted plat by identifying section lines, i.e. 1 section, 1 section with 8 surrounding sections, 4 sections, etc.;
- 2) the distance of the proposed drilling location from the section's south/north and east/west lines; and
- 3) the distance to the nearest lease or unit boundary line.